

PROPOSED LOT 1
 114,762 SF
 ±2.63 ACRES
 EXISTING ZONING: R1
 PROPOSED ZONING: R1

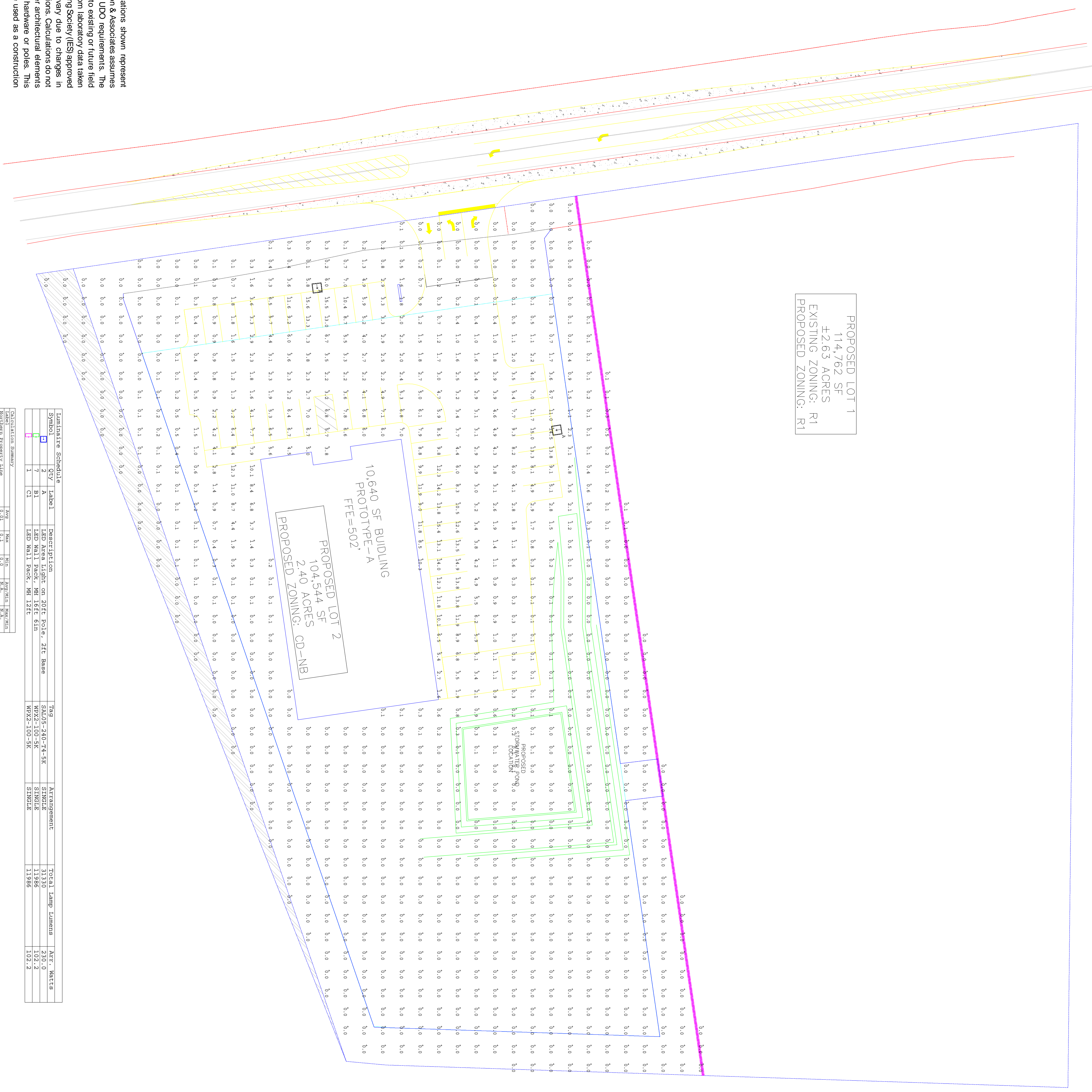

Symbol	Qty	Label	Description	Tag	Arrangement	Total Lamp Lumens	Arr. Watts	
1	7	R1	LED AREA LIGHT ON 20TC POLE, ZTC Base	SA105-260-74-5K	SINGLE	31330	230.0	
2	1	CS	LED WALL PACK, NH 15TC 6IN	W22-110-5K	SINGLE	11366	102.2	
3	1	CS	LED WALL PACK, NH 12TC	W22-110-5K	SINGLE	11352	102.2	
Calculation Summary								
Area	1.37	15.6	0.0	N/A	N/A			
Property	1.37	15.6	0.0	N/A	N/A			
Lighting	1.37	15.6	0.0	N/A	N/A			

PHOTOMETRIC EVALUATION NOT FOR CONSTRUCTION

Based on the information provided, all dimensions and luminaire locations shown represent recommended positions. By providing this information document, Shannon & Associates assumes no liability in the accuracy of the data provided or compliance to any UDC requirements. The engineer and/or architect must determine the applicability of the layout to existing or future field conditions. This lighting plan represents illumination levels calculated from laboratory data taken under controlled conditions in accordance with The Illuminating Engineering Society (IES) approved methods. Actual performance of any manufacturer's luminaires may vary due to changes in electrical voltage, tolerance in lamps/LEDs and other variable field conditions. Calculations do not include obstructions such as buildings, curbs, landscaping, or any other architectural elements unless noted. Fixture nomenclature noted does not include mounting hardware or poles. This drawing is for photometric evaluation purposes only and should not be used as a construction document or as a final document for ordering product.

PURCHASING INFORMATION
 Tom Fulton
 (704) 640-6134
 t.fulton@shannonandassoc.com

JOB NAME:	Dollar General	1	Updated Site Base Plan	SA	09/30
JOB LOCATION:	Pittsboro, NC	2	Changed Area Light Fixtures to Type 4	SA	10/02
DRAWN BY:	SA	-	-	-	-
DRAWING STATUS:	REVIEW	-	-	-	-
DATE:	09/10/24	-	-	-	-
DWG#	SA-090524	-	-	-	-

Shannon & Associates
 (704) 640-6134
 www.shannonandassoc.com