

PIN: 9775-01-45-4512
 PID: 0018750
 PIN: 9775-03-44-4270
 PID: 0018896
 PIN: 9775-04-54-0411
 PID: 0018897



Qunity

CIVIL ENGINEERING | LANDSCAPE ARCHITECTURE

14 CONSULTANT PLACE, SUITE 201
 DURHAM, NORTH CAROLINA 27707

P 919.490.4990
 www.qunity.com

NORTH CAROLINA BOARD OF EXAMINERS FOR ENGINEERS AND SURVEYORS LICENSE NO.: C-0676

**SUMMIT CHURCH
 CHATHAM COUNTY**

9780 US 15-501 N.
 CHAPEL HILL, NC 27517

**SITE PLAN
 NORTH**

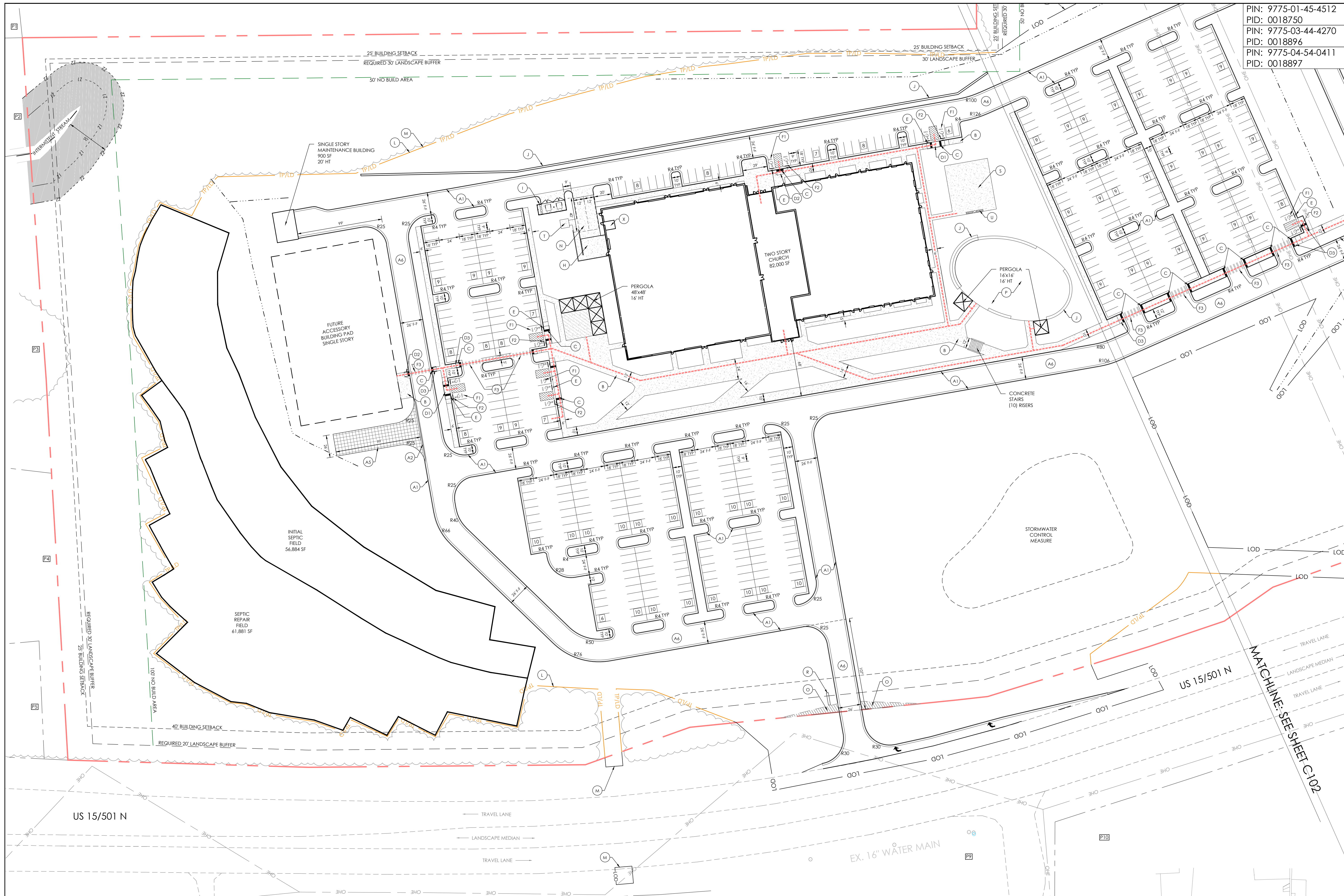
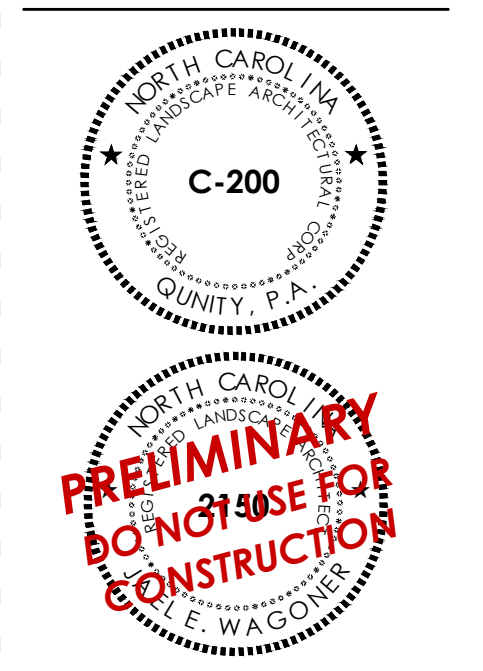

SITE CALLOUTS			
(A1) 24" STANDING CURB	(C) DETECTABLE WARNING DOMES	(F3) CROSSWALK STRIPING	(M) LIMITS OF DISTURBANCE
(A2) 24" ROLLED CURB	(D1) CURB RAMP - PARALLEL	(G) INTENTIONALLY OMITTED	(N) LOADING AREA
(A3) INTENTIONALLY OMITTED	(D2) CURB RAMP - DIRECTIONAL W FLARE	(H) LOADING DOCK	(O) 10' X 70' SIGHT TRIANGLE
(A4) INTENTIONALLY OMITTED	(D3) CURB RAMP - DIRECTIONAL W CURB	(I) DUMPSTER ENCLOSURE	(P) PLAY AREA
(A5) GRASS PAVER FIRE LANE	(E) ADA PARKING SIGN	(J) RETAINING WALL	(Q) MULTIPURPOSE FIELD (GRASS)
(A6) PAVEMENT SECTION	(F1) ADA PARKING AREA	(K) FIRE LANE / SIGN	(R) MONUMENT SIGN (SEE SHEET AP202)
(B) CONCRETE SIDEWALK	(F2) CONCRETE WHEELSTOP	(L) TREE PROTECTION FENCE	(S) SPORT COURT
			(T) 10x10' TRANSFORMER PAD
			(U) BENCH & WASTE RECEPTACLE
			(X) RISER ROOM

LEGEND (PROPOSED CONDITIONS)	
[Line Style]	LIMITS OF DISTURBANCE
[Line Style]	TREE PROTECTION FENCE
[Line Style]	LIMITS OF DISTURBANCE/ TREE PROTECTION FENCE
[Line Style]	RIPARIAN BUFFER - ZONE 1 (30')
[Line Style]	RIPARIAN BUFFER - ZONE 2 (20')
[Line Style]	ADA PATH OF TRAVEL
[Line Style]	BUILDING SETBACK
[Line Style]	REQUIRED LANDSCAPE BUFFER
[Line Style]	PROPOSED LANDSCAPE BUFFER
[Line Style]	50' STREAM BUFFER
[Line Style]	MULTIPURPOSE FIELD (GRASS)

1 SITE PLAN NORTH
 SCALE: 1"=50'

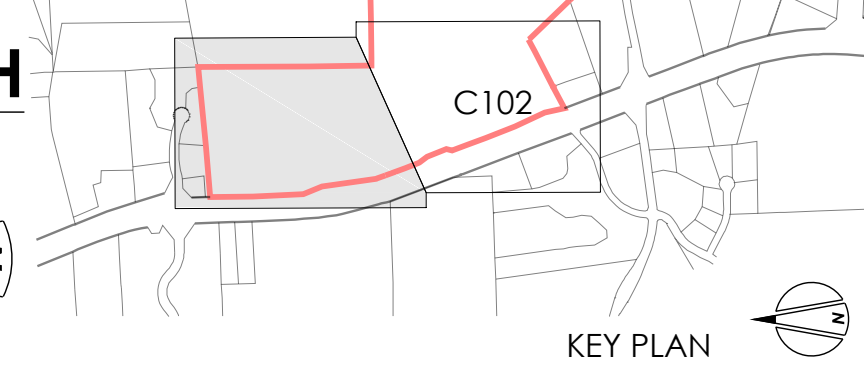

©COPYRIGHT 2024 THIS DOCUMENT AND THE DESIGN ARE THE PROPERTY OF QUNITY, P.A. ANY REPRODUCTION WITHOUT PRIOR WRITTEN CONSENT IS PROHIBITED

811 - CALL BEFORE YOU DIG
 DRAWN BY: SBM | CHECKED BY: JEW
 DATE: 05/31/2024
 PROJECT NO.: 2339
 SHEET NO.: **C101**
 CONDITIONAL REZONING