

CONTRACT ROUTING FORM

1. Complete the information below BEFORE printing and completing items 2 through 7. Items in red are required.

Department: Environmental Quality

Department contract file name (use effective date): DukeEnergy_EnvironmentalQuality_20240501

Project Code: Click here to enter text.

Contract type: Agreement

Contracted Services/Goods: Outdoor Lighting

Contract Component: Choose an item.

Change Order Number/Addendum Number: Click here to enter text.

Vendor Name: Duke Energy

Effective Date: 05/01/2024

Approved by: County Manager

Date approved by the BOC: Click here to enter text.

Ending Date: Click here to enter a date.

Total Amount: \$59.76/monthly

Please Return Contract to:

Name: Sonya Gilliland

Email: sonya.gilliland@chathamcountync.gov

Special Instructions for Clerks Office:

2. Department Head or his/her designee has read the contract in its entirety.

By: [Signature] (Department Head signature required)

3. County Attorney has reviewed and approved the contract

County Attorney has reviewed and rejects the contract Reason: _____

This is an automatic renewal and does not require approval from the County Attorney: Yes No



If this box is checked the County Attorney's Office has reviewed the contract but has not made needed changes to protect the County because the contract is a sole source contract and the services required by the County are not available from another vendor.

4. Technical/MIS Advisor has reviewed the contract if applicable. Yes No

5. Vendor has signed the contract. Yes No

6. A budget amendment is necessary before approval. Yes No
If budget amendment is necessary, please attach to this form.

7. Approval

Requires approval by the BOC - contracts over \$100,000.00. Follow Board submission guidelines.

Requires approval by the Manager – contracts \$100,000 or less.

8. Submit to Clerk.

Clerk's Office Only

Finance Officer has signed the contract

The Finance Officer is not required to sign the contract



CHATHAM COUNTY
COLLECTION CTR-MARTHA'S CHAPEL
PO BOX 608
PITTSBORO NC 27312-0608

April 5, 2024

Your outdoor lighting agreement

Dear CHATHAM COUNTY,

Thank you for your interest in our outdoor lighting solutions. We are pleased to offer you this easy, affordable way to keep your outdoor spaces brighter for years to come.

We have enclosed your outdoor lighting agreement, including the costs, terms and conditions.

Once we receive the signed agreement from you, we will complete the agreement and send you a final copy. Please note that the agreement is not effective until you receive the final, completed version.

If you have questions, please contact the Lighting Expert listed on the front page of the agreement. Thank you for your business and we look forward to serving you.

Para español, visite duke-energy.com/español o bien, llame al 800.452.2777 para hablar con un representante que habla español.

Sincerely,

Duke Energy Progress

Account Number: 9100 8940 6243



Summary of Estimated Charges					
Minimum Service Term	Initial Monthly Cost	Total Early Termination Charges	Total One Time Charges	Total Cost for Initial term	Ongoing Monthly Charge post Term
5 Years (60) Months	59.76	0.00	0.00	3585.60	59.76

Monthly Base Charges							
Service Required	Quantity	Product Description Fixtures and Poles	Equipment Rental**	Maintenance	Energy	Unit Total	Sub-Total
R	002	Light Fixture Flood High Pressure Sodium 250W Gray Priv	0.00	0.00	0.00	0.00	0.00
I	002	Light Fixture Flood LED 130W Gray 3000K Private	0.00	0.00	0.00	25.49	50.98
I	001	Light Fixture Roadway LED 50W Gray Type III 3000K Priva	0.00	0.00	0.00	8.78	8.78
Rental, Maintenance, F&E Totals:			\$0	\$0	\$0		
Estimated Change to Base Monthly Charge Total							\$59.76

THIS IS NOT A BILL. PLEASE DO NOT SEND A PAYMENT IN RESPONSE TO THIS COMMUNICATION.

Electric Service Installation Provisions

WR# 52620614
(Internal Use Only)

I, Sonya Gilliland, have requested that Duke Energy Progress install above ground or underground electric service conductors at my home/business located at 24 GARDNER RD. APEX, NC 27502. In making this request, I agree to the following checked provisions:

- 1. While Duke Energy Progress is responsible for locating publicly owned underground utility lines (telephone, CATV, gas) I am responsible for identifying for Duke Energy or its agent the correct location of all privately-owned underground objects that might be damaged by or cause damage to Duke Energy's equipment or its contractor's equipment in the process of installation. Underground objects include, but are not limited to: **geogrid, septic tanks, drain lines, drain fields, designated repair areas, water lines, irrigation lines and electrical lines not owned by Duke Energy Progress or other publicly owned utilities.**
- 2. Once I have physically marked the privately-owned underground objects, within + or - 24 inches, using paint, flags, or stakes, Duke Energy Progress or its contractor will assume responsibility for avoiding damage to said objects.
- 3. I assume full responsibility for any damage to privately-owned underground objects caused by my failure to notify or incorrectly notify Duke Energy Progress of the location of the underground objects.
- 4. Duke Energy Progress or its contractor will assume responsibility for performing said installation in a professional manner by avoiding damage to obvious above ground objects such as curbs, gutters, shrubbery, sidewalks, and buildings.
- 5. I understand the specific route of the proposed above ground or underground conductors and location of poles and/or apparatus as described by the Duke Energy Progress representative.
- 6. In the course of installing underground lines and equipment in areas with landscape trees, there is the probability of some root damage and I will not hold Duke Energy Progress or its contractor responsible for damage to or the health of any trees.
- 7. Equipment tracks and ground disturbance will result from the use of equipment necessary for the installation of above ground or underground facilities.
- 8. Duke Energy Progress or its contractor **will not** be responsible for providing non-standard erosion control measures, reseeding or replacing gravel in the area(s) disturbed due to the installation of poles, apparatus (such as transformers or pedestals) or underground facilities.
- 9. I understand that I am responsible for complying with any state or federal requirements related to stormwater discharge including any site stabilization measures.
- 10. I may be required to pay a contribution in aid of construction if rock or other abnormal conditions are encountered. Refer to the Line Extension Plan (copy available upon request). These conditions include but are not limited to the following examples:

Examples of Charges

Trench Rock, Non-blast
Place clean sand/clay backfill in a standard trench
Provide clean sand/clay backfill from on-site or offsite
Provide conduit in trench
Bore one cable under roads/driveways/sidewalk, >5' - 40'
Mechanical tamping to avoid settling of trench
Rock hole for pole
Rock hole for anchor
Crew delay due to customer or site conditions
Engineering costs
Other: _____

Unit Cost

\$ 15.41 per cu ft of rock removed
\$ 1.70 per linear foot
\$ Actual Cost plus 15%
\$ 9.43 per linear foot
\$ 28.90 per linear foot
\$ 2.48 per linear foot
\$ 295.53 per pole
\$ 309.25 per anchor
\$ 125.00 per hour (\$125 min)
\$ 65.00 per hour
\$ _____

- 11. To meet National Electric Safety Codes, work site grading, and landscaping must be __ at final grade or __ within 6 inches of final grade (Duke Representative to initial appropriate item) before installation of underground facilities. Refer to the Line Extension Plan (copy available upon request).
- 12. I have requested that Duke Energy Progress install underground facilities on the property listed above. In making this request, I agree to be the single point of contact for Duke Energy Progress and agree that I may be financially responsible to Duke Energy Progress for any damage to Duke Energy Progress' equipment that is caused by a contractor retained by me who is uninsured or otherwise does not have the financial ability to pay for said damages.
- 13. I have provided Duke Energy Progress with the correct load information to size the electrical facilities required by this request for service. I understand that there may be charges if the actual load requires Duke Energy Progress to alter electrical facilities installed for this request for service.
- 14. I assume full responsibility to determine if any lighting ordinances or restrictions that would prohibit the installation of the service requested.
- 15. I agree to allow Duke Energy Progress or its contractor to drive vehicles/equipment on my concrete drive or walkway and I will not hold Duke Energy Progress or its contractor responsible for damage to my concrete drive or walkway.
- 16. Duke Energy or its contractor will not be responsible for providing remediation or environmental control measures for preexisting environmental hazards or contaminants discovered during the installation of poles, apparatus (such as transformers or pedestals) or underground facilities. Environmental issues not disclosed during project initiation may delay the completion of construction.
- 17. These provisions have been explained to me and I have received a copy of this document.

By signing, I acknowledge that I am the Owner/Customer or Agent of the Owner/Customer with authority to execute this document.

Kennedy Lopez
Owner / Customer / Authorized Representative Signature
Kennedy Lopez
Kennedy Lopez
Duke Energy Progress Representative (919) 916-0768 @Duke-Energy.com
Duke Energy Progress Representative Phone Number Email Address

5/8/2024
Date
Date

****CUSTOMER SIGNATURE**

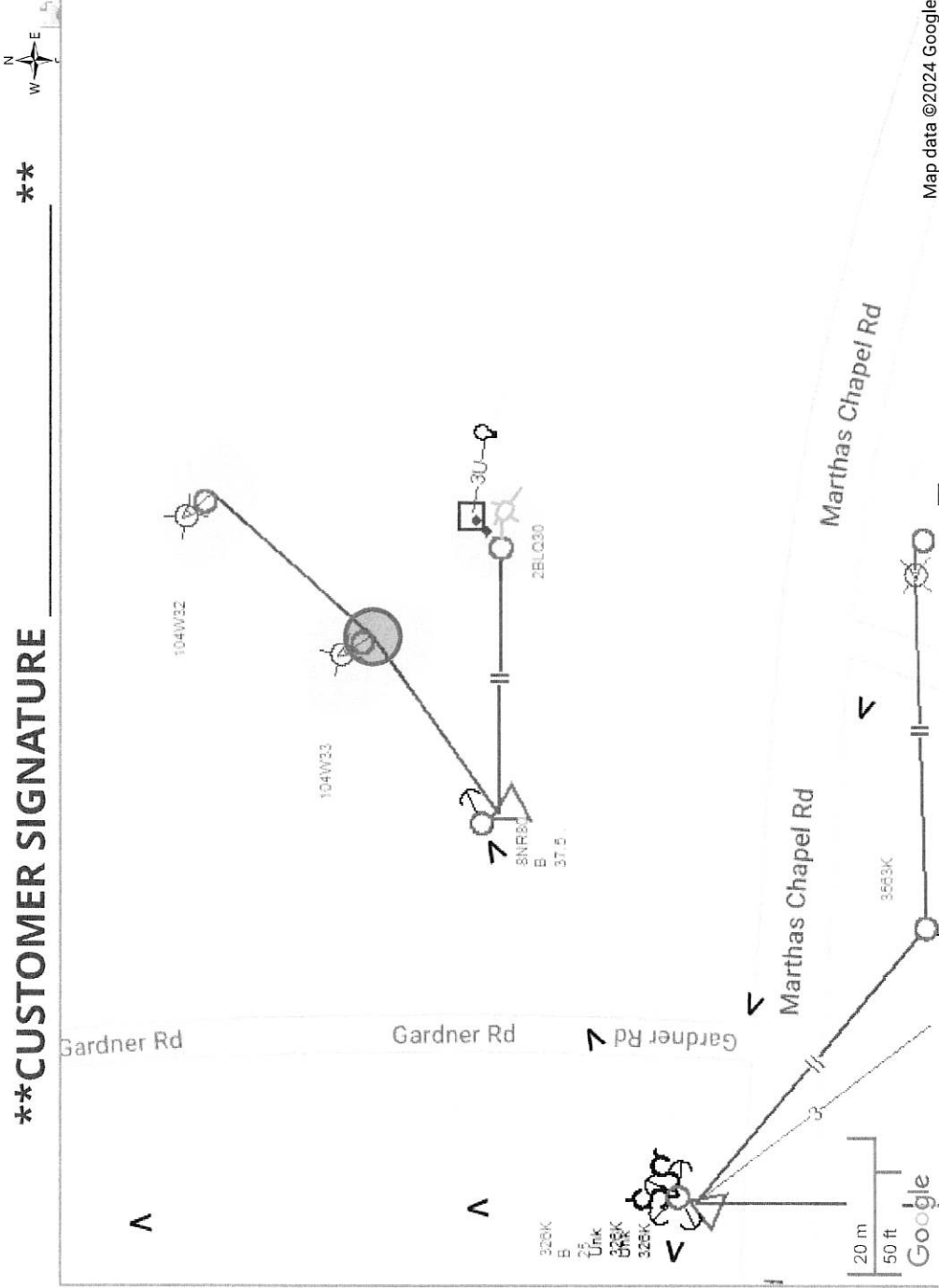

DESIGNER:
KENNEDY LOPEZ
(919) 916-0768

SITE CONTACT:
SONYA GILLILAND
(919) 545-7872

Page:
User: KLopez6
Date: Fri Apr 05 2024
Time: 08:19:16 AM

- SCOPE:**
- EXISTING 30C6 WD POLE (104W33 & 104W32)
 - REMOVE 250W HPS FL & INSTALL 130W LED FL AT 104W33 & 104W32
 - EXISTING 40C5 WD POLE AT 8NR80
 - INSTALL 50W LED RW & 30" LBKT AT 8NR80
 - FACE LFIX WEST

This document was prepared for internal Duke Energy purposes only and was not prepared by a land surveyor. All facility, cable and equipment locations are approximate; and this information may not be accurate or complete. It should not be used for any survey, engineering, or legal purposes.