

SITE DATA SUMMARY

PARCEL NO.(S): 12278; 60108; 81567
 ZONING: R-1
 TOTAL SITE AREA: 161.8 AC
 DEVELOPMENT TYPE: SINGLE-FAMILY
 MINIMUM REQUIRED LOT AREA: 40,000 SQ.FT.
 MINIMUM REQUIRED LOT WIDTH: 100 FT
 MINIMUM REQUIRED FRONT SETBACK: 40 FT
 MINIMUM REQUIRED SIDE SETBACK: 25 FT
 MINIMUM REQUIRED REAR SETBACK: 25 FT
 MAXIMUM BUILDING HEIGHT: 60 FT
 TOTAL UNITS: 88 UNITS
 NET DENSITY: 88 UNITS / 161.8 AC = 0.543 UNITS/AC
 WATER: PUBLIC
 WASTEWATER: INDIVIDUAL ONSITE
 WATERSHED DISTRICT: LOCAL WATERSHED

FOR REVIEW ONLY
 NOT RELEASED FOR
 CONSTRUCTION

NOTES

LEGEND

- 110 --- INDEX CONTOUR
- 108 --- INTERMEDIATE CONTOUR
- --- PROPERTY LINE
- --- ADJOINING PROPERTIES
- x --- FENCE
- --- RIGHT-OF-WAY
- --- CREEK
- ss --- EX. SANITARY SEWER
- w --- EX. WATER LINE
- ss --- NEW SANITARY SEWER
- --- NEW WATER LINE
- --- RIPARIAN BUFFER
- --- PRELIMINARY SUITABLE SOILS

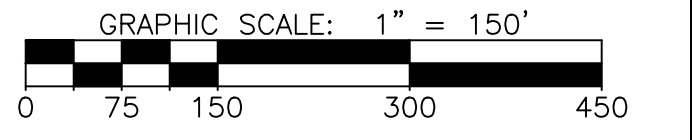

REVISIONS		
NO.	DATE	DESCRIPTION

PROJECT MANAGER: DCB	PROJECT ENGINEER: SR
DRAWN BY: SR	CHECKED BY: DCB

DATE: MARCH 27, 2024

PRELIMINARY
 NOT FOR REVIEW ONLY
 NOT RELEASED FOR CONSTRUCTION

MacCONNELL & Associates, P. C.
 501 CASCADE POINTE LANE, SUITE 103
 CARY, NORTH CAROLINA 27513
 P.O. BOX 129
 MORRISVILLE, NORTH CAROLINA 27560
 LICENSE No. C-1039 TEL: (919) 467-1239 FAX: (919) 319-6510

**KOPF TRACTS
 MJM GROUP**
CONCEPT PLAN

CHATHAM COUNTY, NC

**REGULAR SUBDIVISION
 LAYOUT**

PROJECT NUMBER C17402.00	DRAWING NUMBER EX-01
------------------------------------	--------------------------------

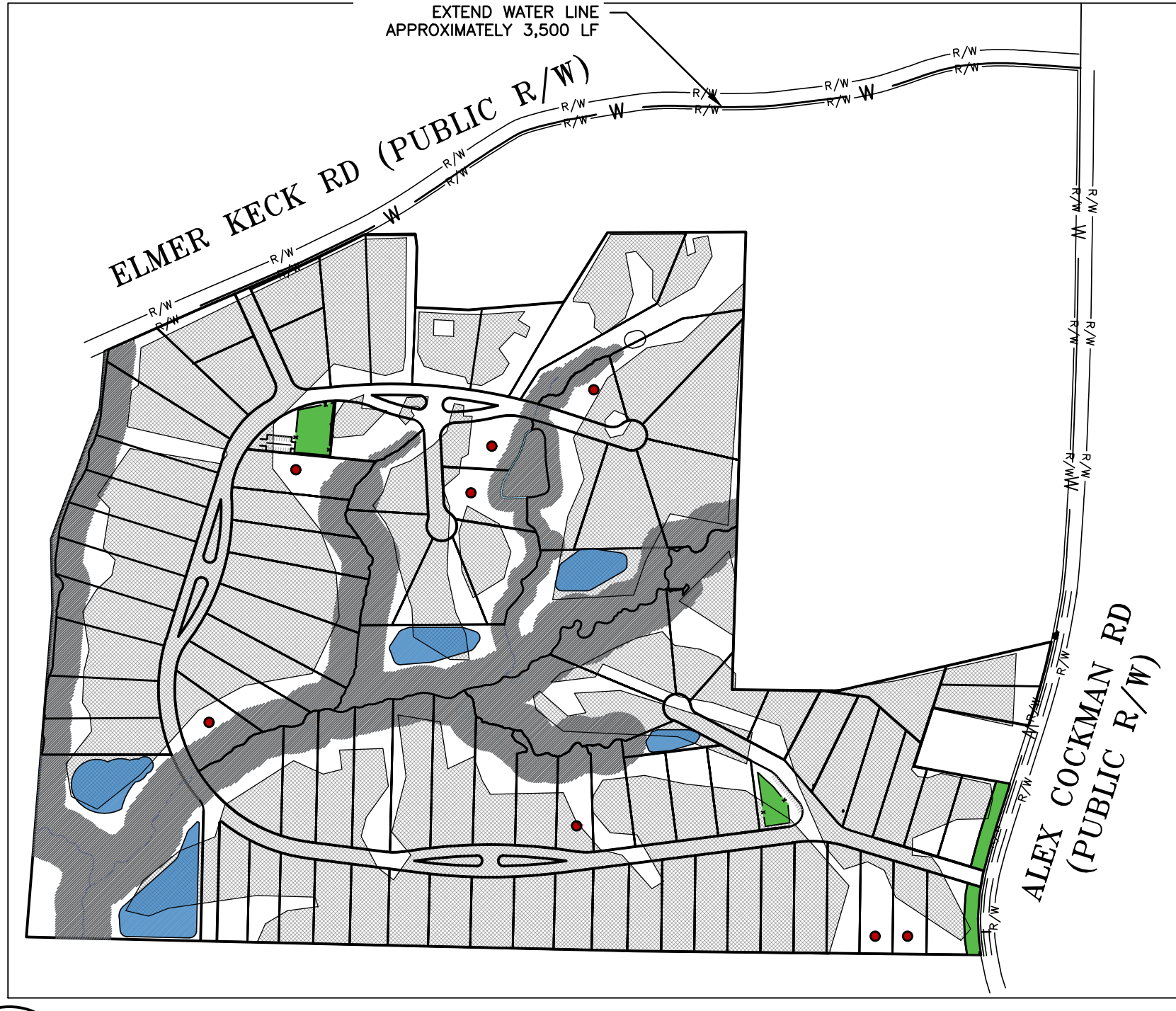

1 WATER MAIN EXTENSION
 EX-01 1"=500'

Z:\Projects\Projects\C17402.00 - MJM Group (Aria Onn, LLC) - Kopf Tracts - Chatham County - Data\Digital\Drawings\C17402.00 - Base\Conventional - SD.dwg Apr 02, 2024 4:13pm

C17402.00 - KOPF TRACTS - MJM GROUP - CONCEPT PLAN LAYOUT

COPYRIGHT © 2023