

# VICINITY MAP

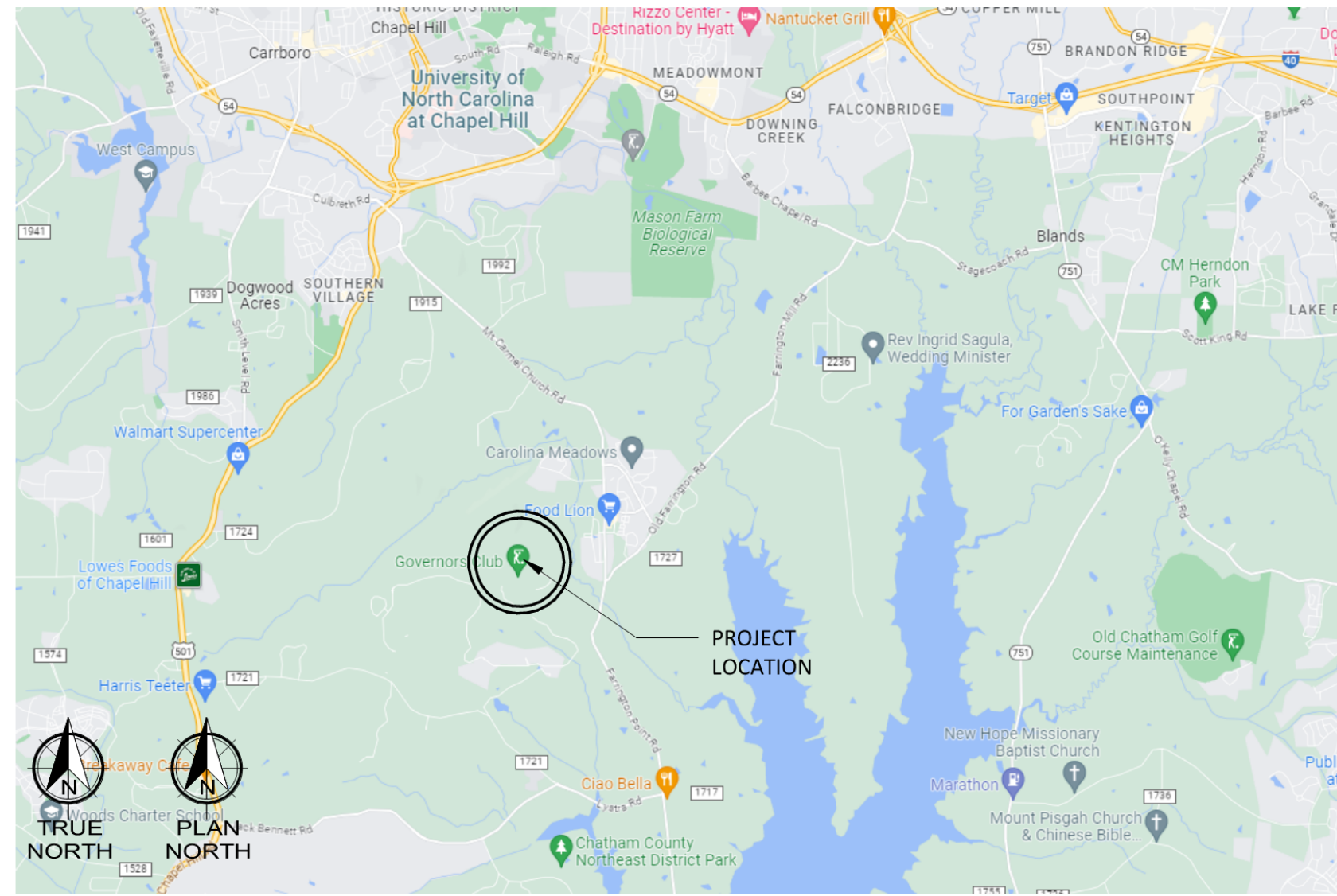

NOT TO SCALE

**SITE DATA**  
 PARCEL ID: 72802  
 CURRENT ZONING: R-1  
 PROPOSED ZONING: R-1 (NO CHANGE)  
 LAND USE: COMMERCIAL (CLUBHOUSE AMENITY)

## PLANT SCHEDULE

SHRUBS	CODE	QTY	COMMON NAME	BOTANICAL NAME	CONT	HEIGHT	SPREAD
	CHDG	24	Duke Gardens Plum Yew	Cephalotaxus harringtonia 'Duke Gardens'	-	24" - 36"	24" - 36"
	DVID	14	First Editions® Vintage Jade Distylium	Distylium x 'Vintage Jade'	-	24" - 36"	24" - 36"
EVERGREEN SHRUBS	CODE	QTY	COMMON NAME	BOTANICAL NAME	CONT	HEIGHT	SPREAD
	IGNN	34	Nigra Inkberry	Ilex glabra 'Nigra'	-	24" - 36"	24" - 36"
	IVND	27	Dwarf Yaupon	Ilex vomitoria 'Nana'	-	18" - 24"	18" - 24"
GRASSES	CODE	QTY	COMMON NAME	BOTANICAL NAME	CONT	HEIGHT	SPREAD
	BGVG	90	Blue Grama Grass	Bouteloua gracilis	7 gal		
	NSTG	62	Mexican Feather Grass	Nassella tenuisima	7 gal		
	PAHH	24	Hamel Dwarf Fountain Grass	Pennisetum alopecuroides 'Hamel'	7 gal		

## LANDSCAPE CALCULATIONS

BUFFERS: N/A  
 SCREENING: N/A

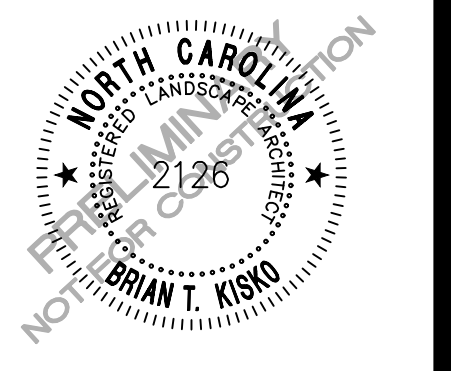
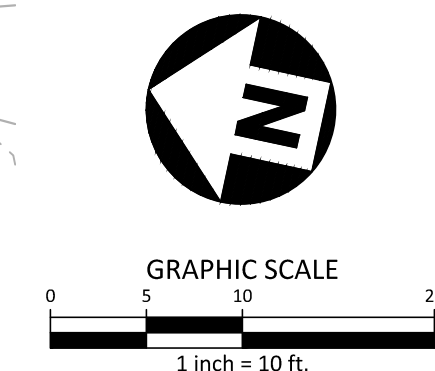
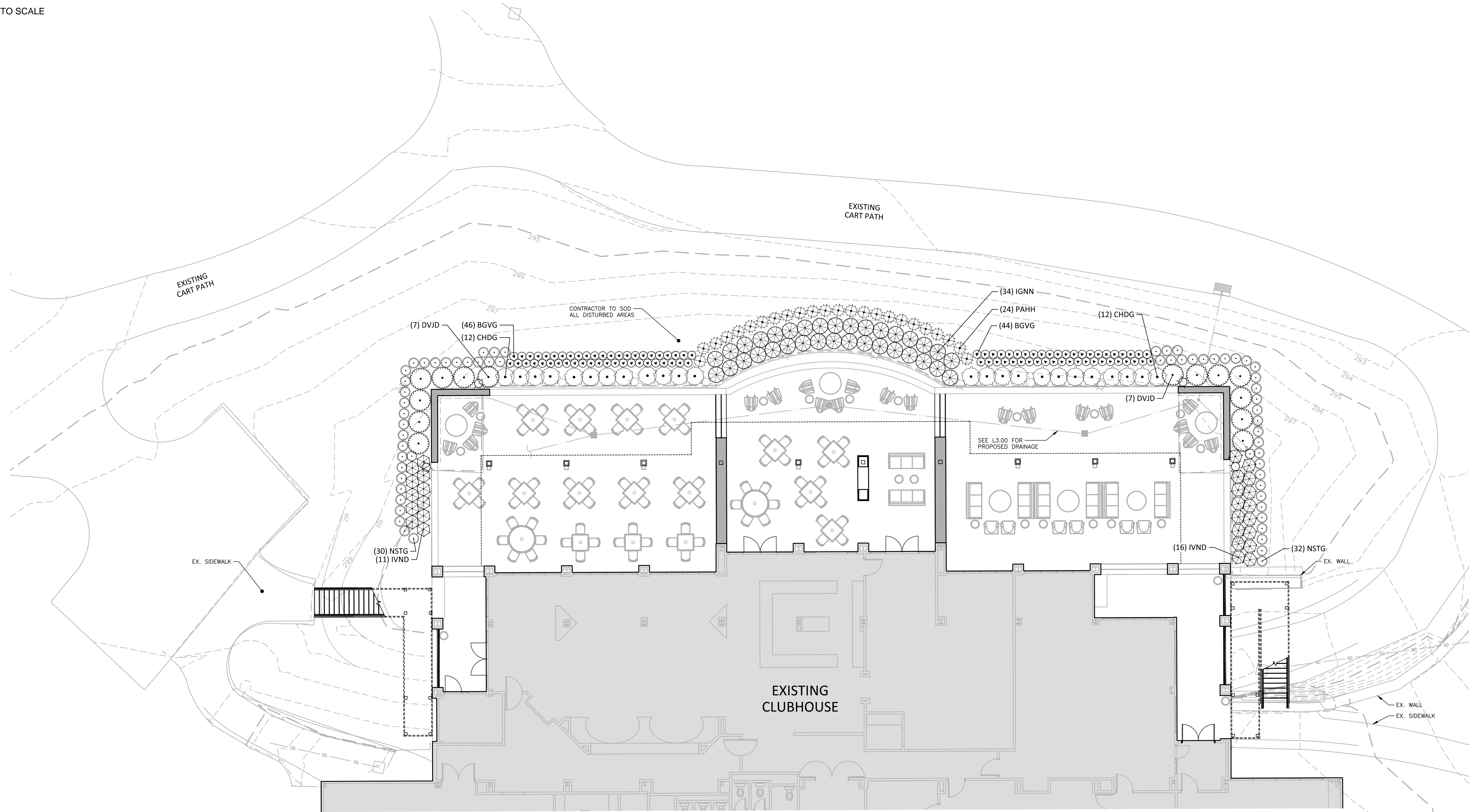

DATE	ISSUE
08/31/2023	100% DD
01/15/2024	50% CD
02/20/2024	Chatham Co. AC

Date : 01/15/2024

Job No.: SPEC23434

Sheet Title  
 PLANTING PLAN

Sheet Number

**L5.00**

DO NOT REPRODUCE THIS DOCUMENT. CONTAINS CONFIDENTIAL INFORMATION. IS AN INSTRUMENT OF PROFESSIONAL SERVICE, AND THE PROPERTY OF CHAMBERS. IT SHALL NOT BE USED ON OTHER PROJECTS OR FOR THE EXTENSION OF THIS PROJECT WITHOUT CHAMBERS'S WRITTEN APPROVAL. THE USE OF ELECTRONIC FILES OR REPRODUCTIONS OF THESE CONTRACT DOCUMENTS BY ANY CONTRACTOR, SUBCONTRACTOR, DIRECTOR, FABRICATOR OR MATERIAL SUPPLIER IN LIEU OF PREPARATION OF SHOP DRAWINGS SHALL NOT BE PERMITTED. © COPYRIGHT 2018



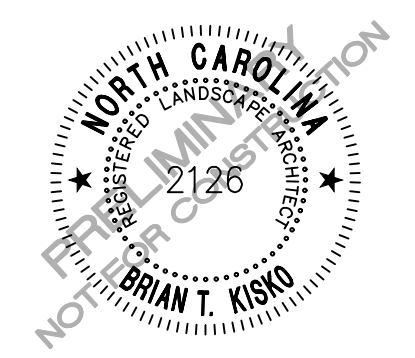

**LANDSCAPE NOTES**

- MATERIALS AND METHODS OF CONSTRUCTION SHALL BE IN ACCORDANCE WITH CURRENT APPLICABLE CHATHAM COUNTY AND THE STATE OF NC STANDARDS AND SPECIFICATIONS.
- CONTRACTOR IS RESPONSIBLE FOR INSPECTING THE SITE BEFORE LANDSCAPE CONSTRUCTION AND INSTALLATION IN ORDER TO BECOME FAMILIAR WITH THE EXISTING CONDITIONS.
- CONTRACTOR IS RESPONSIBLE FOR LOCATING UNDERGROUND UTILITIES, NEW AND PRIOR EXISTING, BEFORE BEGINNING LANDSCAPE INSTALLATION. DAMAGE TO UTILITIES SHALL BE REPAIRED AT THE CONTRACTOR'S EXPENSE.
- THE LANDSCAPE PLAN IS FOR PLANTING PURPOSES ONLY. FOR INFORMATION REGARDING BUILDINGS, GRADING, WALLS, ETC., REFER TO ARCHITECTURE, SITE, GRADING DRAWINGS, ETC.
- CONTRACTOR SHALL FULLY REVIEW PLANS AND SPECIFICATIONS PRIOR TO INSTALLATION AND SHALL NOTIFY OWNER'S REPRESENTATIVE AND LANDSCAPE ARCHITECT OF DISCREPANCIES BETWEEN THE NOTES, SPECIFICATIONS, DRAWINGS, OR SITE CONDITIONS FOR RESOLUTION PRIOR TO INSTALLATION.
- VERIFICATION OF TOTAL PLANT QUANTITIES AS SHOWN IN THE PLANT SCHEDULE SHALL BE THE RESPONSIBILITY OF THE CONTRACTOR. DISCREPANCIES BETWEEN THE PLANT SCHEDULE AND LANDSCAPE PLAN SHALL BE BROUGHT TO THE ATTENTION OF THE LANDSCAPE ARCHITECT PRIOR TO SUBMITTING THE BID/PROPOSAL.
- CONTRACTOR IS RESPONSIBLE FOR VERIFYING THAT PLANT MATERIAL IS AVAILABLE AS SPECIFIED WHEN BID/PROPOSAL IS SUBMITTED AND RESERVING / SECURING PLANT MATERIAL AS NECESSARY TO MEET THE REQUIREMENTS OF THE LANDSCAPE PLAN.
- PLANTS TO MEET MINIMUM REQUIREMENTS AS SPECIFIED IN THE PLANT SCHEDULE. ROOT TYPE MAY BE FREELY SUBSTITUTED FOR BALLED OR BURLAPPED OR CONTAINER GROWN TREES, WITH OTHER SPECIFICATIONS REMAINING UNCHANGED. OTHER CHANGES OR SUBSTITUTIONS SHALL BE APPROVED BY THE LANDSCAPE ARCHITECT AND GOVERNING JURISDICTION PRIOR TO PROCUREMENT OF PLANT MATERIAL.
- DEVIATION FROM THESE PLANS MUST BE SPECIFICALLY APPROVED BY LANDSCAPE ARCHITECT. THE CONTRACTOR SHALL NOT MAKE SUBSTITUTIONS WITHOUT APPROVAL.
- CONTRACTOR TO COORDINATE WITH LANDSCAPE ARCHITECT TO ESTABLISH THE EXTENTS OF MULCH/SEED/SOD IF NOT SPECIFICALLY SHOWN ON PLANS.
- CONTRACTOR SHALL VERIFY CONDITIONS AND ELEVATIONS OF EXISTING TREES TO REMAIN ADJACENT TO OR WITHIN LIMITS OF DISTURBANCE PRIOR TO INSTALLATION OF NEW PLANT MATERIAL. CONTRACTOR SHALL NOTIFY LANDSCAPE ARCHITECT OF DISCREPANCIES.
- CONTRACTOR SHALL BE RESPONSIBLE FOR THE TESTING, AMENDING AND SPREADING OF TOPSOIL PRIOR TO PLANT INSTALLATION, SUPPLEMENTING WITH AMENDMENTS TO ADJUST PH AND FERTILITY AS NECESSARY BASED ON THE TEST RESULTS. SEE SPECIFICATIONS FOR SOIL TEST REPORT SUBMITTAL REQUIREMENTS.
- CONTRACTOR SHALL PREPARE PLANTING BEDS BY TILLING SOIL TO A 12" DEPTH PRIOR TO INSTALLING PLANT MATERIAL. CONTRACTOR SHALL ENSURE THAT SHALLOW BEDROCK WILL NOT INHIBIT THE ROOT GROWTH OF PLANT MATERIAL. PLANTING BEDS SHALL NOT BE BACKFILLED WITH ANY MATERIAL OTHER THAN AMENDED OR IMPORTED PLANTING SOIL IN ACCORDANCE WITH THE SPECIFICATIONS FOR PLANTING SOIL.
- FINE GRADE PLANTING AREAS TO A SMOOTH, UNIFORM SURFACE PLANE WITH LOOSE, UNIFORMLY FINE TEXTURE. GRADE TO WITHIN PLUS OR MINUS 1/2 INCH OF FINISH ELEVATION. HAND ROLL AND RAKE, REMOVE RIDGES AND DEBRIS, AND FILL DEPRESSIONS TO MEET FINISH GRADES. LIMIT FINISHED GRADING TO AREAS THAT CAN BE PLANTED IN THE IMMEDIATE FUTURE.
- CONTRACTOR SHALL PROVIDE POSITIVE DRAINAGE IN PLANTING AREAS.
- AFTER TREE PLANTING HOLES HAVE BEEN DUG AND PRIOR TO INSTALLATION OF TREES, CONTRACTOR TO CONFIRM THAT WATER DRAINS OUT OF THE SOIL. USE LOWERED PLANTING HOLE DEPTH AND INSTALL ALTERNATIVE DRAINAGE AND AERATION SYSTEMS AS REQUIRED.
- PERFORM PERCOLATION TEST FOR EACH TREE PIT. PROVIDE GRAVEL SUMP FILTER FABRIC & VENT PIPE IF DRAINAGE DOES NOT OCCUR WITHIN 24 HOURS. INCLUDE ALL SUMPS IN BASE BID. SHOULD SUMPS NOT BE NECESSARY AFTER PERCOLATION TEST, PROVIDE CHANGE ORDER DEDUCT TO OWNER.
- IF PLANTING HOLES ARE DUG WITH A LARGE AUGER, BREAK DOWN THE SIDES OF THE HOLE WITH A SHOVEL TO ELIMINATE GLAZING AND TO CREATE THE SPECIFIED SIDE SLOPE ON THE INSIDE OF THE PLANTING HOLE.
- CONTRACTOR SHALL KEEP AREAS OF WORK CLEAN, NEAT, AND ORDERLY. PAVED SURFACES ARE TO BE CLEANED OF SOIL AND DEBRIS AT THE CLOSE OF EACH WORKDAY.
- LANDSCAPE MATERIAL SHALL BE WELL FORMED, VIGOROUS, GROWING SPECIMENS WITH GROWTH TYPICAL OF VARIETIES SPECIFIED AND SHALL BE FREE FROM DAMAGE, INSECTS, AND DISEASES. MATERIAL SHALL EQUAL OR SURPASS #1 QUALITY AS DEFINED IN THE CURRENT ISSUE OF "AMERICAN STANDARD FOR NURSERY STOCK" AS PUBLISHED BY THE AMERICANHORT (F.K.A. AMERICAN NURSERY & LANDSCAPE ASSOCIATION).
- PLANT MATERIAL IS TO BE WELL ROOTED, NOT ROOT BOUND, SUCH THAT THE ROOT BALL REMAINS INTACT THROUGHOUT THE PLANTING PROCESS. DEFICIENT PLANT MATERIAL SHALL BE REJECTED BY THE LANDSCAPE ARCHITECT.
- CONTAINER GROWN STOCK SHALL HAVE BEEN GROWN IN A CONTAINER LONG ENOUGH FOR THE ROOT SYSTEM TO HAVE DEVELOPED SUFFICIENTLY TO HOLD THE SOIL TOGETHER FIRMLY, BUT NOT SO LONG AS TO HAVE BECOME POT BOUND. CONTAINER GROWN STOCK SHALL HAVE A WELL-ESTABLISHED ROOT SYSTEM REACHING THE SIDES OF THE CONTAINER TO MAINTAIN A FIRM BALL BUT SHALL NOT HAVE EXCESSIVE ROOT GROWTH ENCIRCLING THE INSIDE OF THE CONTAINER.
- PLANT MATERIAL IS TO BE CAREFULLY HANDLED BY THE ROOT BALL, NOT THE TRUNK, BRANCHES, AND/OR FOLIAGE OF THE PLANT. MISHANDLED PLANT MATERIAL SHALL BE REJECTED BY THE LANDSCAPE ARCHITECT. PLANTS WITH BROKEN ROOT BALLS OR SUBSTANTIAL DAMAGE SHALL BE REPLACED PRIOR TO PLANTING.
- CONTRACTOR SHALL STAKE TREE LOCATIONS FOR APPROVAL PRIOR TO INSTALLATION. CONFLICTS OR DISCREPANCIES SHALL BE FIELD ADJUSTED AND APPROVED BY LANDSCAPE ARCHITECT PRIOR TO INSTALLATION. NOTIFY THE GOVERNING JURISDICTION AND OWNER'S REPRESENTATIVE OR LANDSCAPE ARCHITECT OF SIGNS, POWER LINES, OR OTHER CONFLICTS BEFORE PLANTING TREES.
- NO TREE PLANTING SHALL OCCUR WITHIN SIGHT DISTANCE TRIANGLE AREAS INDICATED ON THE PLAN SET. CONTRACTOR SHALL STAKE THE LOCATION OF TREE PLANTING IN THE RIGHT-OF-WAY IN THE FIELD PRIOR TO INSTALLATION FOR REVIEW AND APPROVAL BY LANDSCAPE ARCHITECT AND AUTHORITIES HAVING JURISDICTION. OWNER SHALL AGREE TO MAINTAIN THE STRUCTURE OF TREE PLANTING IN THE RIGHT-OF-WAY TO ELIMINATE SIGHT DISTANCE CONFLICTS.
- CONTRACTOR SHALL LAY OUT ON THE GROUND SHRUBS, ORNAMENTAL GRASSES, AND GROUNDCOVERS FOR APPROVAL BY LANDSCAPE ARCHITECT PRIOR TO INSTALLATION. CONTRACTOR SHALL ANTICIPATE THAT SOME REARRANGEMENT OF MATERIAL WILL OCCUR.
- MULCH SHALL BE ORGANIC, FREE OF TRASH, AND MAINTAINED WEED FREE. MULCH SHALL BE APPLIED IMMEDIATELY AFTER COMPLETION OF PLANTING OPERATIONS. SEE SPECIFICATIONS FOR MORE INFORMATION.
- CONTRACTOR TO SUPPLY AUTOMATIC IRRIGATION SYSTEM, COMPLETE AND INSTALLED. SYSTEM TO INCLUDE VALVES, PIPE, HEADS, FITTINGS, CONTROLLER, AND BACKFLOW PREVENTOR, AND PROVIDE 100% COVERAGE OF SOD, SEED, AND PLANTING BEDS. (SEE IRRIGATION DRAWINGS).
- CONTRACTOR IS RESPONSIBLE FOR WATERING PLANTED AREAS IN ADDITION TO IRRIGATED AREAS THROUGHOUT THE WARRANTY PERIOD TO ENSURE PLANT ESTABLISHMENT.
- REPAIR OR REPLACE, IN A MANNER APPROVED BY OWNER'S REPRESENTATIVE, NEW PLANTS THAT ARE DAMAGED AFTER INSTALLATION BY CONSTRUCTION OPERATIONS.
- IT SHALL BE THE CONTRACTOR'S RESPONSIBILITY TO MONITOR THE PROJECT DURING THE GUARANTEE PERIOD AND INFORM THE OWNER IF PROBLEMS DEVELOP WITH THE PLANT MATERIAL. CONTRACTOR SHALL REMOVE DEAD AND UNHEALTHY PLANT MATERIAL AS DEFINED IN THE SPECIFICATIONS AND IMMEDIATELY REPLACE AT THE CONTRACTOR'S EXPENSE.
- REFER TO SPECIFICATIONS FOR MORE INFORMATION ON DELIVERY, STORAGE AND HANDLING OF PLANT MATERIAL, QUALITY ASSURANCE, PRODUCTS AND MATERIALS, SOIL TESTING AND AMENDMENTS, INSTALLATION, MAINTENANCE AND WARRANTIES, AND ADDITIONAL PLANTING REQUIREMENTS.
- LANDSCAPE WORK SHALL INCLUDE THE FURNISHING, INSTALLATION, AND WARRANTY OF ALL PLANTING MATERIALS WITHIN THE PROJECT AREA.

**PLANTING INSTALLATION:**

**EXAMINATION AND PREPARATION:**

- INSTALLER TO EXAMINE AREAS TO RECEIVE EXTERIOR PLANTS FOR COMPLIANCE WITH REQUIREMENTS AND CONDITIONS AFFECTING INSTALLATION AND PERFORMANCE. PROCEED WITH INSTALLATION ONLY AFTER UNSATISFACTORY CONDITIONS HAVE BEEN CORRECTED.
- PROTECT STRUCTURES, UTILITIES, SIDEWALKS, PAVEMENTS, AND OTHER FACILITIES, AND LAWNS AND EXISTING PLANTINGS FROM DAMAGE CAUSED BY PLANTING OPERATIONS REFER TO CIVIL DRAWINGS FOR EROSION AND SEDIMENT CONTROL MEASURES.
- LAY OUT INDIVIDUAL TREE AND SHRUB LOCATIONS PER PLANTING PLAN. OBTAIN LANDSCAPE ARCHITECT'S ACCEPTANCE OF LAYOUT BEFORE PLANTING AND MAKE MINOR ADJUSTMENTS AS NEEDED.

**PLANTING BED ESTABLISHMENT:**

- VERIFY SITE GRADING PRIOR TO DIGGING. LOOSEN SUBGRADE TO A MINIMUM DEPTH OF 8 INCHES. REMOVE STONES LARGER THAN 1 INCH IN ANY DIMENSION AND STICKS, ROOTS, RUBBISH AND OTHER EXTRANEOUS MATTER. APPLY TOP SOIL, FERTILIZER, LIME AND SOIL AMENDMENTS AND THOROUGHLY BLEND PLANTING SOIL MIX TO CREATE ACCEPTABLE PLANTING SOIL AS DESCRIBED THROUGH ANLA.
- EXCAVATE CIRCULAR PITS AND TRENCHES WITH SIDES SLOPED INWARD, LEAVING THE CENTER AREA RAISED SLIGHTLY TO SUPPORT THE ROOT BALL AND ASSIST IN DRAINAGE. EXCAVATE APPROXIMATELY THREE TIMES AS WIDE AS BALL DIAMETER FOR BALLED AND BURLAPPED AND CONTAINER-GROWN STOCK. SCARIFY PIT OR TRENCH WALLS.

**TREE, SHRUB, VINE, ORNAMENTAL GRASS AND GROUNDCOVER PLANTING:**

- SET BALLED AND BURLAPPED OR CONTAINER-GROWN STOCK PLUMB AND CENTER OF PIT OR TRENCH WITH ROOT BALL 1 INCH ABOVE ADJACENT FINISHED GRADES.
- REMOVE WIRE AND PALLETS ENTIRELY FROM ROOT BALL. REMOVE BURLAP FROM TOPS OF ROOT BALLS AND PARTIALLY FROM SIDES BUT DO NOT REMOVE FROM UNDER ROOT BALL.
- PLACE PLANTING SOIL MIX AROUND ROOT BALL IN LAYERS, TAMPING TO SETTLE MIX AND ELIMINATE VOIDS AND AIR POCKETS. WHEN PIT IS APPROXIMATELY ONE-HALF BACKFILLED, WATER THOROUGHLY BEFORE PLACING REMAINDER OF BACKFILL. WATER AGAIN AFTER PLACING AND TAMPING FINAL LAYER OF PLANTING SOIL MIX.
- APPLY 1-INCH MINIMUM AVERAGE THICKNESS OF ORGANIC MULCH EXTENDING 12 INCHES BEFORE EDGE OF PLANTING PIT OR TRENCH OR TO EDGE OF BEDLINE. DO NOT PLACE MULCH WITH 3 INCHES OF ROOT FLARE, TRUNK OR STEMS.
- PRUNE, THIN AND SHAPE TREES AND SHRUBS ACCORDING TO STANDARD HORTICULTURAL PRACTICE AND TO RETAIN NATURAL CHARACTER. DO NOT CUT TREE LEADERS. REMOVE ONLY INJURED OR DEAD BRANCHES FROM FLOWERING TREES.
- INSTALL GUYING AND STAKING PER MANUFACTURER'S SPECIFICATIONS. REMOVE GUY WIRES AND STAKES AFTER TWO PLANTING ESTABLISHMENT SEASONS.
- DISPOSAL: REMOVE SURPLUS SOIL AND WASTE MATERIAL, INCLUDING EXCESS SUBSOIL, UNSUITABLE SOIL, TRASH, AND DEBRIS, AND LEGALLY DISPOSE OF THEM OFF OWNER'S PROPERTY.

**WARRANTY AND MAINTENANCE:**

**WARRANTY:**

INSTALLER SHALL REPAIR OR REPLACE ANY PLANTINGS THAT FAIL IN MATERIALS, WORKMANSHIP, OR GROWTH WITHIN ONE YEAR AFTER THE DATE OF SUBSTANTIAL COMPLETION. FAILURES INCLUDE BUT ARE NOT LIMITED TO:

- DEATH AND UNSATISFACTORY GROWTH, EXCEPT FOR DEFECTS RESULTING FROM LACK OF ADEQUATE MAINTENANCE, NEGLIGENCE OR ABUSE BY OWNER, OR INCIDENTS THAT ARE BEYOND THE CONTRACTOR'S CONTROL.
- STRUCTURAL FAILURES INCLUDING PLANTINGS FALLING OR BLOWING OVER.

PLANTS THAT DO NOT MEET THESE REQUIREMENTS SHALL BE DEFINED AS DEFECTIVE. ANY DEFECTIVE PLANTS SHALL BE REMOVED IMMEDIATELY UPON NOTIFICATION BY THE LANDSCAPE ARCHITECT AND REPLACED WITHOUT COST TO THE OWNER AS SOON AS WEATHER CONDITIONS PERMIT AND WITHIN THE SPECIFIED PLANTING PERIOD.

**MAINTENANCE:**

INITIAL MAINTENANCE SHALL BE PROVIDED IMMEDIATELY AFTER EACH AREA IS PLANTED AND CONTINUE UNTIL SUBSTANTIAL COMPLETION. UPON SUBSTANTIAL COMPLETION, MAINTENANCE FOR ALL PLANT MATERIAL SHALL BE PROVIDED FOR ONE YEAR AT A MINIMUM AND SHALL INCLUDE:

- TREE AND SHRUB MAINTENANCE: MAINTAIN PLANTINGS BY PRUNING, CULTIVATING, WATERING, WEEDING, FERTILIZING, RESTORING PLANTING SAUCERS, AND RESETTling TO PROPER GRADES OR VERTICAL POSITION AS REQUIRED TO ESTABLISH HEALTHY, VIABLE PLANTINGS. SPRAY OR TREAT AS REQUIRED TO KEEP TREES AND SHRUBS FREE TO INSECTS AND DISEASE. TREES AND SHRUBS TO BE PRUNED TO RESTORE NATURAL SHAPE TYPICAL OF THEIR SPECIES OR VARIETY IN ACCORDANCE WITH STANDARD HORTICULTURAL PRACTICES AND APPLICABLE REQUIREMENTS IN ANSI Z60.1 "AMERICAN STANDARD FOR NURSERY STOCK".
- GROUNDCOVER AND PLANT MAINTENANCE: MAINTAIN AND ESTABLISH PLANTINGS BY WATERING, WEEDING, FERTILIZING, MULCHING, AND OTHER OPERATIONS AS REQUIRED TO ESTABLISH HEALTHY, VIABLE PLANTINGS.
- PROTECT EXTERIOR PLANTS FROM DAMAGE DUE TO LANDSCAPE OPERATIONS, OPERATIONS BY OTHER CONTRACTORS AND TRADES, AND OTHERS. MAINTAIN PROTECTION DURING INSTALLATION AND MAINTENANCE PERIODS. TREAT, REPAIR OR REPLACE DAMAGED PLANTINGS.

**01 SHRUB INSTALLATION**  
SCALE: 3/8"=1'-0"

