

THE CONSERVANCY AT JORDAN LAKE

AUGUST 17, 2023
FIRST PLAT AMENDMENT

ROAD NAME PLAN
US 15-501
Chatham County, NC

Road	Proposed Road Name	Road Length
A	The Conservancy Parkway	± 9,067 LF
B	Adelaide Circle	± 784 LF
C	Ellerston Place	± 415 LF
D	Crystal Downs Lane	± 415 LF
E	Oakland Hills Avenue	± 2,350 LF
F	Starmount Forest Drive	± 1,430 LF
G	Lahinch Lane	± 470 LF
H	Somerset Hills Court	± 895 LF
I	Bakers Bay Lane	± 2,962 LF
J	Ballyneal Drive	± 4,598 LF
K	Ganton Circle	± 467 LF
L	Carnoustie Court	± 572 LF
M	Saint Andrews Loop	± 596 LF
N	Rock Barn Circle	± 582 LF
O	Sand Hill Court	± 696 LF
P	Muirfield Circle	± 423 LF
Q	Kingsbarns Court	± 417 LF
R	Kingston Heath	± 518 LF
S	Pine Needles Lane	± 385 LF
T	Melbourne Trail	± 417 LF
U	Hope Valley Circle	± 742 LF
V	Winged Foot Drive	± 1,894 LF
W	Sunningdale Circle	± 1,195 LF
X	Myers Park Trail	± 1,882 LF
Y	Kiawah Circle	± 472 LF
Z	Prairie Dunes	± 1,184 LF
AA	Riviera Place	± 1,175 LF
BB	Bandon Dunes Trail	± 858 LF
CC	Valderrama Drive	± 3,494 LF
DD	W. Sussex Place	± 374 LF
EE	Sawgrass Pond Lane	± 493 LF
FF	Royal Birkdale Lane	± 487 LF
GG	Mid Pines Place	± 613 LF
HH	Swinley Forest Drive	± 3,948 LF
II	Bethpage Circle	± 1,979 LF
JJ	Old Town Court	± 1,567 LF
KK	Wintergreen Court	± 540 LF
LL	Victoria Pines Drive	± 2,355 LF
MM	Pine Valley Lane	± 536 LF
NN	Woodhall Lane	± 529 LF
OO	Cabot Links	± 486 LF
PP	Friars Head Place	± 472 LF
QQ	Shoreacres Drive	± 5,790 LF
RR	Winding Bay Drive	± 4,063 LF
SS	Whistling Straits Way	± 480 LF

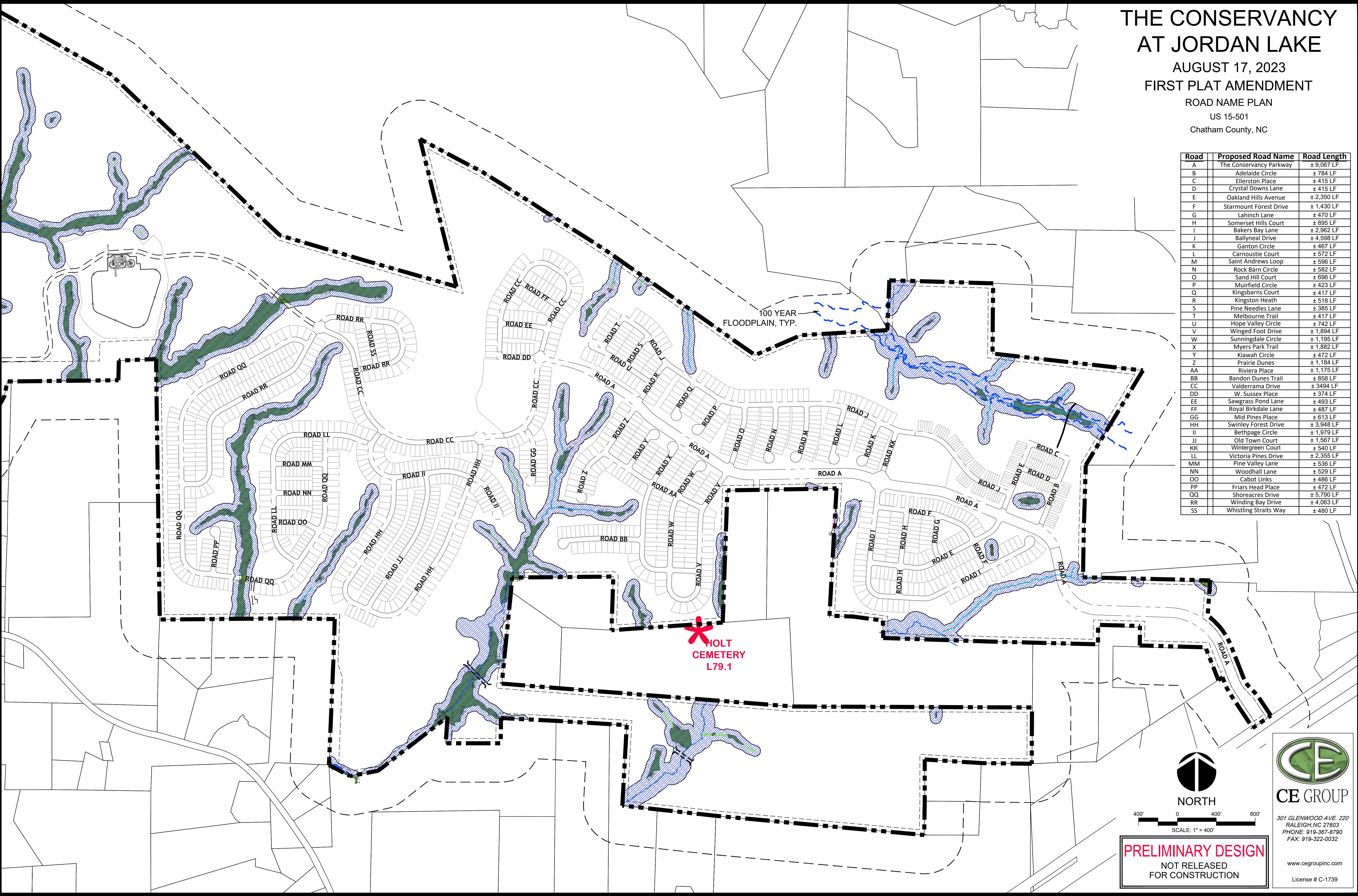

100 YEAR
FLOODPLAIN, TYP.

HOLT
CEMETERY
L79.1



NORTH

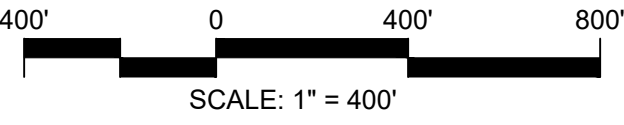

SCALE: 1" = 400'

PRELIMINARY DESIGN
NOT RELEASED
FOR CONSTRUCTION

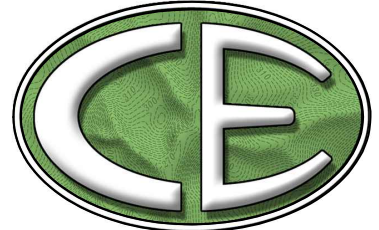

CE GROUP

301 GLENWOOD AVE. 220
RALEIGH, NC 27603
PHONE: 919-367-8790
FAX: 919-322-0032

www.cegroupinc.com
License # C-1739