

Sheet List Table		
Sheet Number	Sheet Title	Sheet Number
C-1	COVER SHEET	C-1
C-3	SITE PLAN	C-3
LS-1	LANDSCAPE PLAN	LS-1
LS-2	LANDSCAPE PLAN	LS-2

SITE PLAN DRAWINGS
FOR
FARRINGTON POINT ROAD
1780 FARRINGTON POINT RD.
CHATHAM COUNTY, NC

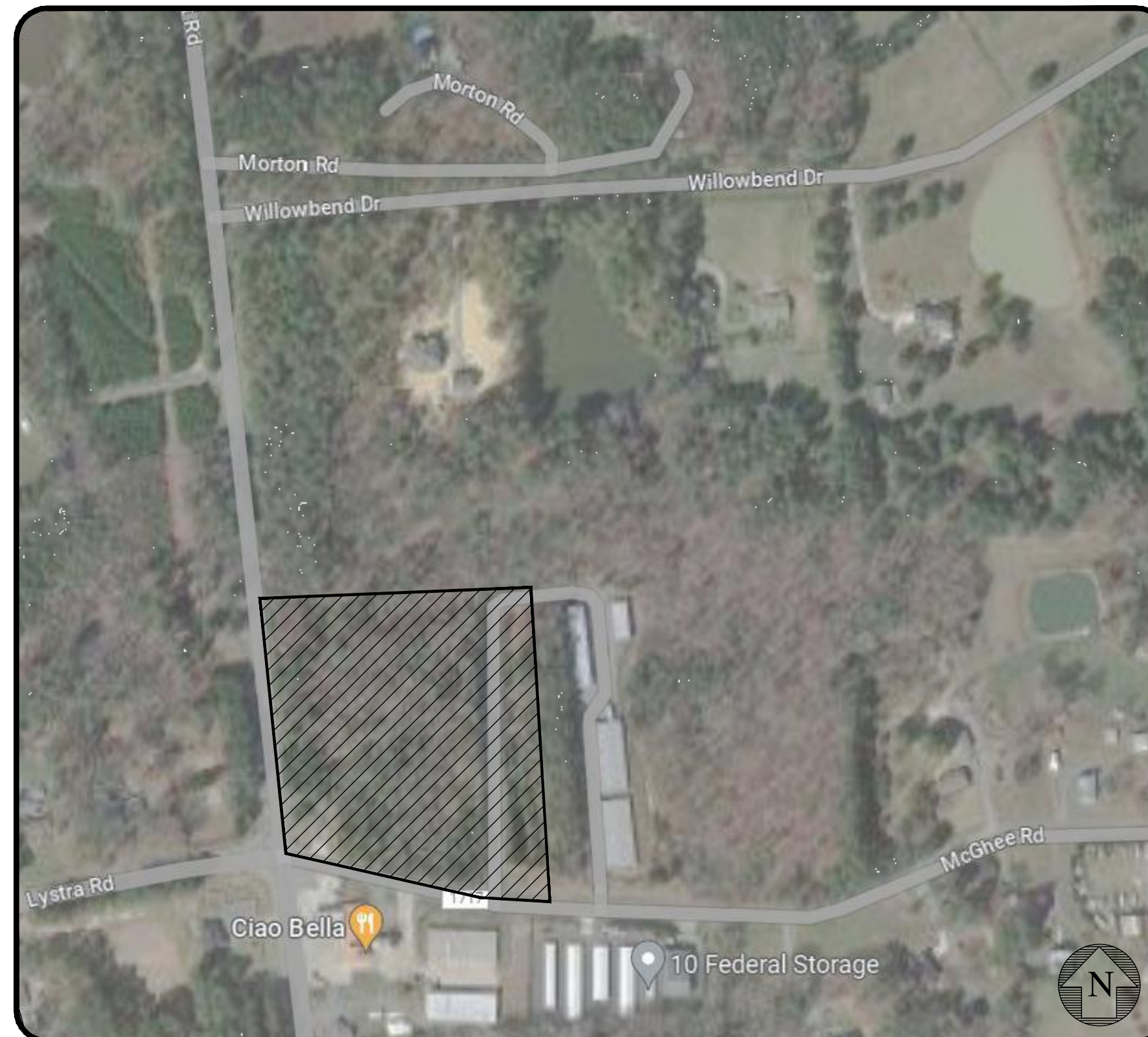
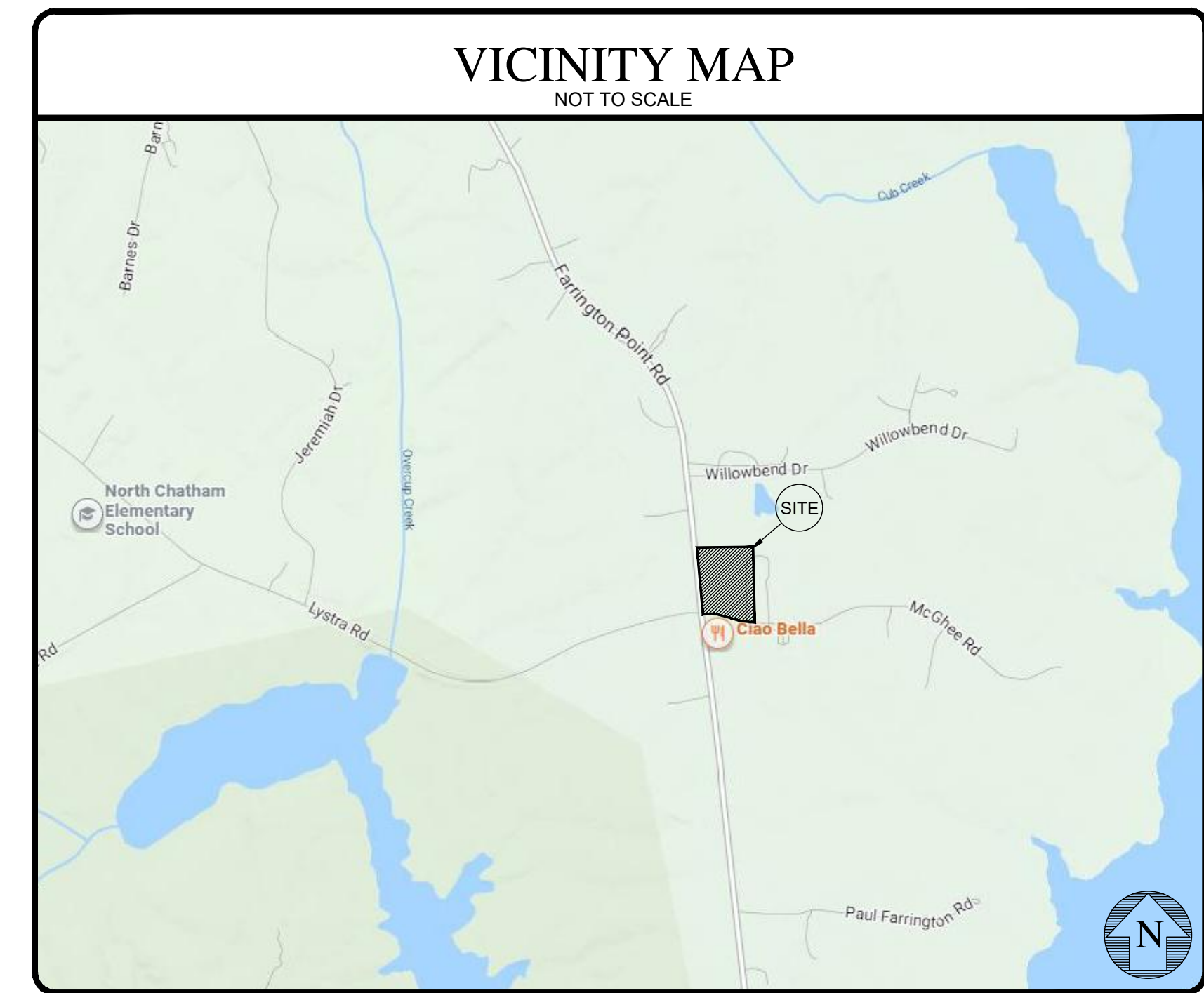

PUBLIC SERVICE CONTACTS :

WATER:	CHATHAM COUNTY CONTACT: BLAKE MILLS DIRECTOR OF PUBLIC UTILITIES 12 EAST STREET P.O. BOX 1809 PITTSBORO, NC 27312 (919) 542-8238	STATE ROADWAYS: NCDOT - DIVISION 8, DISTRICT 1 300 DOT Drive PO BOX 1154 ASHEBORO, NC 27204 (336) 318-4025
SEWER:	CHATHAM COUNTY CONTACT: BLAKE MILLS DIRECTOR OF PUBLIC UTILITIES 12 EAST STREET P.O. BOX 1809 PITTSBORO, NC 27312 (919) 542-8238	PLANNING: CITY OF MEBANE CY STOBER, AICP DEVELOPMENT DIRECTOR 102 S. 5TH STREET MEBANE, NC 27302 (919) 563-9990
FIRE:	TOWN OF PITTSBORO CONTACT: DARYL GRIFFIN P.O. BOX 573 PITTSBORO, NC 27312 (919) 542-4101	SOLID WASTE: CHATHAM COUNTY OFFICES 28 COUNTY SERVICES ROAD PITTSBORO, NC 27312 (919) 542-0058 RECYCLE@CHATHAMNC.ORG
GAS:	DOMINION ENERGY BRIAN SMITH COMMERCIAL SALES-DURHAM REASON (919) 596-7454 (919) 519-9938 BRIAN.SMITH@SCANA.COM	RECYCLING: CHATHAM COUNTY OFFICES 28 COUNTY SERVICES ROAD PITTSBORO, NC 27312 (919) 542-0058 RECYCLE@CHATHAMNC.ORG
ELECTRIC:	PROGRESS ENERGY CAROLINAS (800) 452-2777	STORM DRAINAGE: CHATHAM COUNTY OFFICES WATERSHED PROTECTION 12 EAST STREET P.O. BOX 1809 PITTSBORO, NC 27312 RACHEL THORN, CPESC, DIRECTOR (919) 545-8343 RACHEL.THORN@CHATHAMCOUNTYNC.GOV
TELEPHONE:	AT&T (803) 929-1925	
PLANNING:	JASON SULLIVAN (919) 542-8233 JASON.SULLIVAN@CHATHAMCOUNTYNC.GOV	

ENGINEER CONTACT	OWNERS:	DEVELOPER:
SUMMIT DESIGN & ENGINEERING SERVICES WILLIAM WIRT, PE 320 EXECUTIVE COURT HILLSBOROUGH, NC 27278 (919) 732-3883 (PHONE) (919) 732-8676 (FAX) WILLIAM.WIRT@SUMMITDE.COM	KUNAL ENTERPRISES, LLC 210 JOSEPH POND LANE CARY, NC 27519 PHONE (919) 417-1417 GRFARRJRS9@GMAIL.COM	KUNAL ENTERPRISES, LLC 210 JOSEPH POND LANE CARY, NC 27519 PHONE (919) 417-1417 GRFARRJRS9@GMAIL.COM

NO.	REVISIONS	DATE	BY

COPYRIGHT © 2015 SUMMIT DESIGN AND ENGINEERING SERVICES
DRAWING ALTERATION
IT IS A VIOLATION OF LAW FOR ANY PERSON, FIRM OR CORPORATION TO REPRODUCE OR TRANSMIT THIS DOCUMENT IN ANY MANNER, OR TO USE ANY INFORMATION CONTAINED HEREIN, WITHOUT THE WRITTEN PERMISSION OF SUMMIT DESIGN AND ENGINEERING SERVICES. THIS DOCUMENT IS THE PROPERTY OF SUMMIT DESIGN AND ENGINEERING SERVICES AND IS TO BE USED ONLY FOR THE PROJECT AND SITE SPECIFICALLY IDENTIFIED HEREIN.

PROJECT ENGINEER/ARCHITECT: MARY WILLIAM WIRT@SUMMITDE.COM
PROJECT MANAGER: MWP (MICK PARKER@SUMMITDE.COM)
DRAWN BY: FEW (FRANKIE WINN@SUMMITDE.COM)
FIRST ISSUE DATE: _____
DATE OF SUBMITTAL: _____

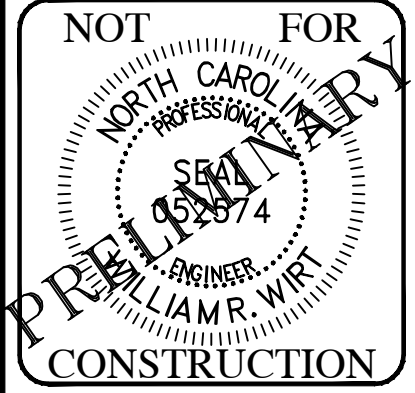

SUMMIT DESIGN AND ENGINEERING SERVICES
State License #: 150839
320 Executive Court
Hillsborough, NC 27278
Voice: (919) 732-3883 Fax: (919) 732-4676
www.summitde.com

**SITE SUBMISSION PLANS
FARRINGTON POINT ROAD
1780 FARRINGTON POINT RD
CHATHAM COUNTY, NC**

COVER SHEET

PROJECT NO.: **23-0070**
DRAWING NAME: **23-0070_cs.dwg**
SHEET NO.: **C-1**



CONTRACTOR SHALL NOTIFY "811" (811) OR (1-800-632-4949) AT LEAST 3 FULL BUSINESS DAYS PRIOR TO BEGINNING CONSTRUCTION OR EXCAVATION TO HAVE EXISTING UTILITIES LOCATED. CONTRACTOR SHALL CONTACT ANY LOCAL UTILITIES THAT PROVIDE THEIR OWN LOCATOR SERVICES INDEPENDENT OF "811". REPORT ANY DISCREPANCIES TO THE ENGINEER IMMEDIATELY.

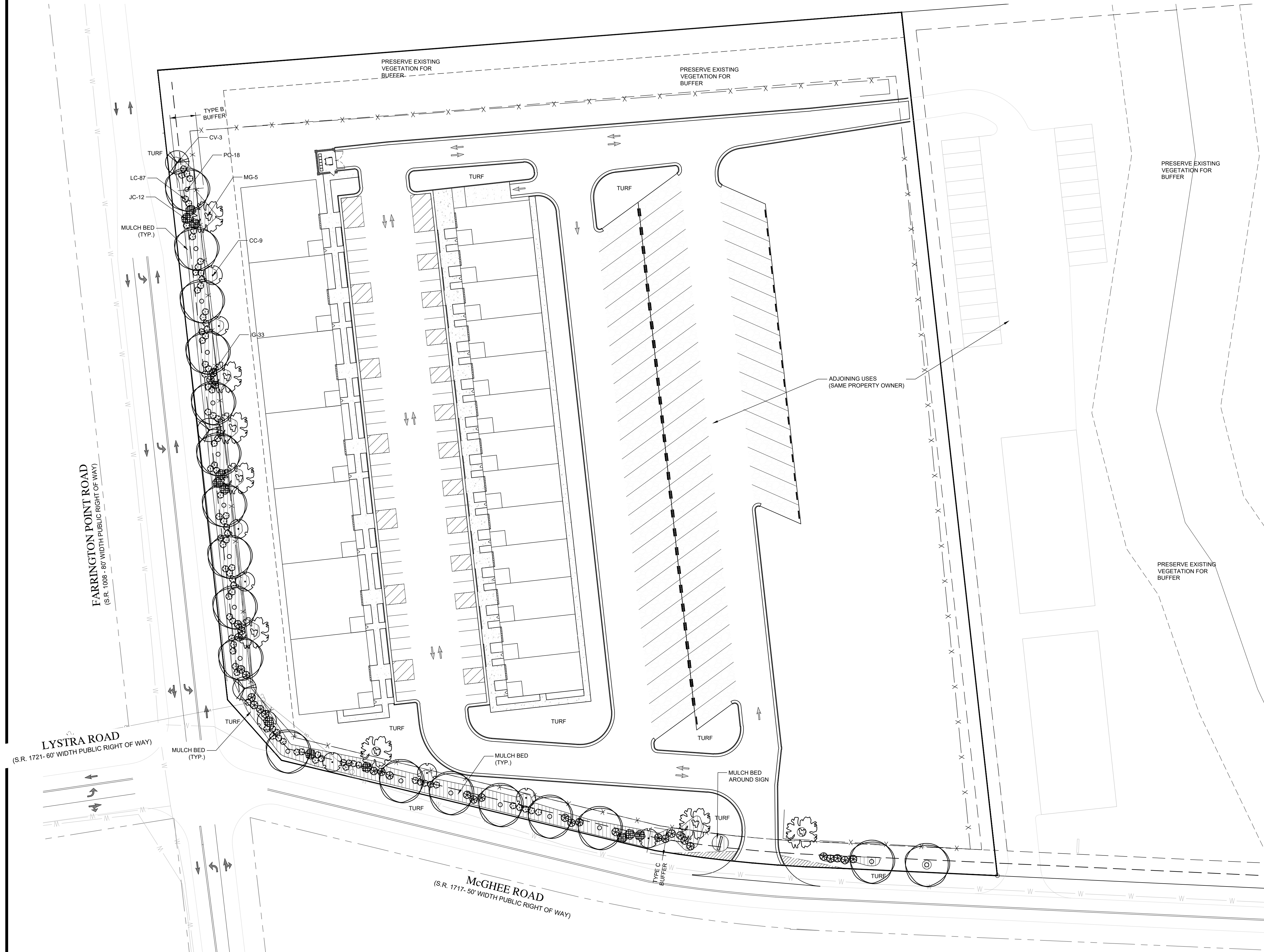

CHATHAM COUNTY LANDSCAPING REQUIREMENTS:

LANDSCAPING PLANTS SHALL BE SELECTED FROM THE CHATHAM COUNTY DESIGN GUIDELINES THAT ARE, FOR THE MOST PART, A NATURALLY OCCURRING SPECIES AND ARRANGEMENT FOR THE AREA. THE USE OF NON-NATURALLY OCCURRING AND RARE PLANTINGS IS NOT DISCOURAGED FOR "SPECIMEN" AND "CONTRAST" PLANTINGS.

- A LANDSCAPING PLAN MUST BE SUBMITTED TO THE COUNTY WITH EVERY NON-RESIDENTIAL APPLICATION. LANDSCAPING REFERS TO TOPOGRAPHY, TREES, SHRUBS, GRASS, AND VEGETATION. THE LANDSCAPING PLAN SHALL INDICATE WHERE EXISTING TREES AND VEGETATION ARE PRESERVED.
- A BUFFER IS A STRIP OF LAND WITH THE SCREENING REQUIRED THEREON. SCREENING MAY INCLUDE LANDSCAPING, WALLS, FENCES, HEDGES, BERMS, AND EXISTING VEGETATION. STREET TREES SHALL BE REQUIRED ALONG STREETS AT INTERVALS OF 40 FT. EACH TREE SHALL BE OF AT LEAST 2-1/2 INCH CALIPER WHEN INSTALLED AND BE A HEIGHT OF 30 FT. AT MATURITY.
- CHAIN LINK FENCES ARE TO BE DISCOURAGED UNLESS SCREENED BY VEGETATION. PLANTINGS ADJACENT TO BUILDING WALLS SHOULD BE INCLUDED ALONG SIDES OF BUILDINGS WHERE DEVOID OF ARCHITECTURAL INTEREST.
- THE BUFFER WIDTH, HEIGHT, AND APPROPRIATE SCREENING FOR COMMERCIAL USES ADJACENT TO OTHER COMMERCIAL USES, ADJACENT TO RESIDENTIAL/RURAL USE, OR TO LAND ZONED AS SUCH SHALL BE IN ACCORDANCE WITH TABLE 2.

LANDSCAPE BUFFER B REQUIREMENTS:

THIS SCREEN BREAKS UP THE VIEW SUCH THAT SOME ELEMENTS OF THE PROPERTY CAN BE SEEN FROM SOME VIEWS AND/OR DURING SOME SEASONS. 25 - 35% DECIDUOUS PLANTS MAY BE ALLOWED. MINIMUM SPACING SHALL GENERALLY BE NO WIDER THAN 30 FEET BETWEEN TREE TRUNKS (BUT MAY BE WIDER DEPENDING ON TREE TYPE), WITH EVERGREEN SHRUBS SPACING RANGING FROM FIVE TO EIGHT FEET ON CENTER.

LANDSCAPE BUFFER C REQUIREMENTS:

THIS BUFFER AREA SIMPLY PRESERVES EXISTING VEGETATION. IT IS INTENDED LESS AS A VISUAL BARRIER AND MORE FOR A SPECIFIC PURPOSE. EXAMPLES COULD INCLUDE, BUT ARE NOT LIMITED TO EROSION CONTROL, PROVIDING CONTINUITY WITH NEARBY WOODED AREAS, PROVIDING WILDLIFE HABITAT, PROTECTING EXISTING VEGETATION, PROVIDING SHADE, AND/OR FOR AESTHETIC PURPOSES. MINIMUM SPACING SHALL GENERALLY BE NO WIDER THAN 40 FEET BETWEEN CANOPY TREE TRUNKS AND NO WIDER THAN 20 FEET BETWEEN ORNAMENTAL TREE TRUNKS.

UTILITIES LEGEND:

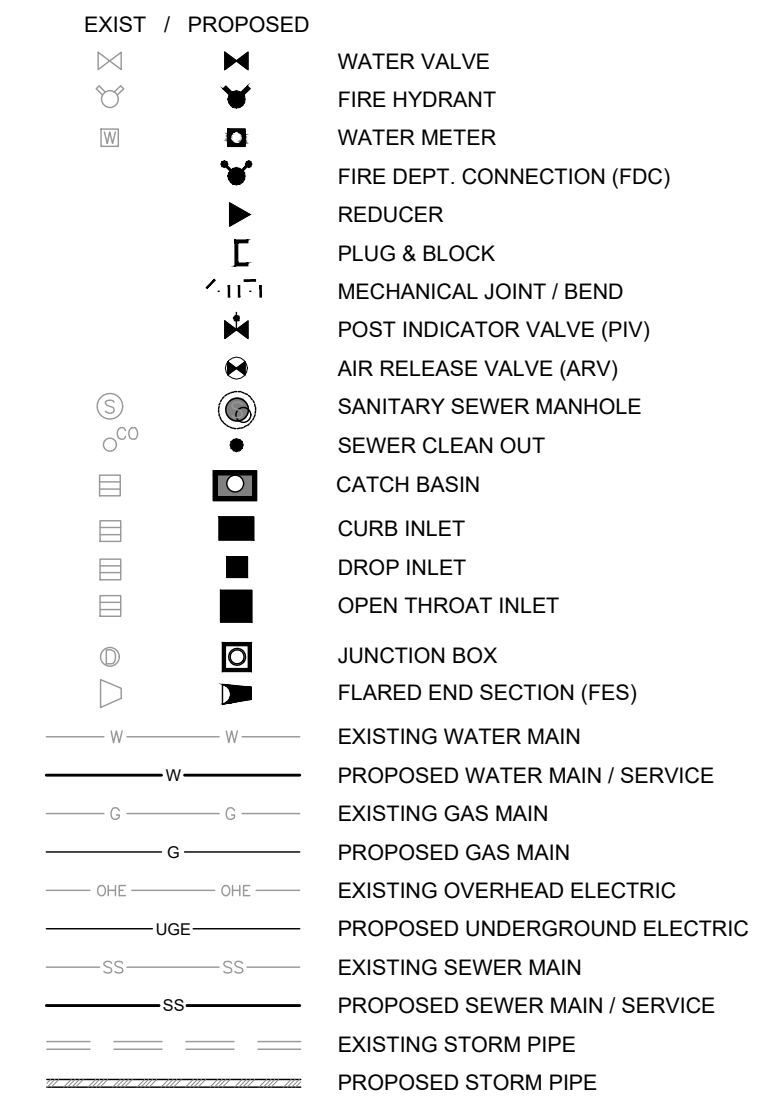

KEY	BOTANICAL NAME	COMMON NAME	SIZE	ROOT	HT.	QTY.	USE CATEGORY	EVERGREEN	COMMENTS
TREES									
CC	CERCIS CANADENSIS	EASTERN REDBUD	1-1/2" CAL	B&B	6' MIN.	9	DEC. TREE		FULL
CV	CHIONANTHUS VIRGINICUS	FRINGETREE	1-1/2" CAL	B&B	6' MIN.	3	DEC. TREE		2-3 STEM, FULL
MG	MAGNOLIA GRANDIFLORA	SOUTHERN MAGNOLIA	2-1/2" CAL	B&B	10' MIN.	3	STREET TREE	X	FULL
PO	PLATANUS OCCIDENTALIS	SYCAMORE	2-1/2" CAL	B&B	10' MIN.	18	STREET TREE		FULL
						TOTAL			33
SHRUBS									
IG	ILEX GLABRA	INKBERRY	18-24"	#3 CONT.	18-24"	33	BUFFER	X	FULL
JC	JUNIPERUS CHINENSIS 'TORULOSA'	HOLLYWOOD JUNIPER	24-30"	#5 CONT.	30"	12	BUFFER	X	FULL
LC	LOROPETALUM CHINENSE 'RUBY'	RUBY LOROPETALUM	18-24"	#5 CONT.	18-24"	87	BUFFER	X	FULL
						TOTAL			132

ALL PLANTS SHALL MEET ASNS (AMERICAN STANDARDS FOR NURSERY STOCK) STANDARDS

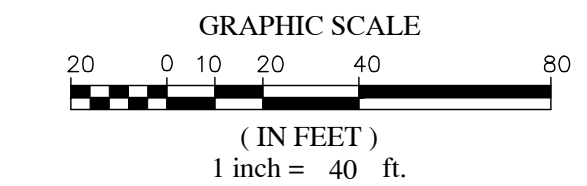

NO.	REVISIONS	DATE	BY
7			
6			
5			
4			
3			
2			
1			

COMPRIETE O'NST
SUMMIT DESIGN AND
ENGINEERING SERVICES
DRAWING ALTERATION
IT IS A VIOLATION OF LAW FOR ANY PERSON,
ENGINEER, LANDSCAPE ARCHITECT, OR OTHER
PROFESSIONAL TO REPRODUCE OR TRANSMIT
THIS DOCUMENT IN ANY MANNER, OR TO
REPRODUCE OR TRANSMIT THIS DOCUMENT
ON THE BASIS OF THE ORIGINAL OR ANY
DERIVATIVE THEREOF.

PROJECT ENGINEER/ARCHITECT
MRV WILLIAM WIRT@SUMMITDE.COM
PROJECT MANAGER
MMP (MCK.PARKER@SUMMITDE.COM)
DRAWN BY
FEW (FRANKIE.WINGS@SUMMITDE.COM)
FIRST ISSUE DATE
DATE OF SUBMITAL

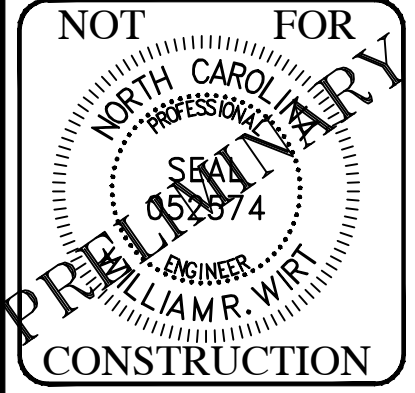

SUMMIT
DESIGN AND ENGINEERING SERVICES
State License #: 10-0339
320 Executive Court
Fayetteville, NC 27278
Voice: (919) 732-8883 Fax: (919) 732-4676
www.summitde.com

SITE SUBMISSION PLANS
FARRINGTON POINT ROAD
1780 FARRINGTON POINT RD
CHATHAM COUNTY, NC
LANDSCAPE PLAN

PROJECT NO.
23-0070
DRAWING NAME:
23-0070_ls.dwg
SHEET NO.
LS-1

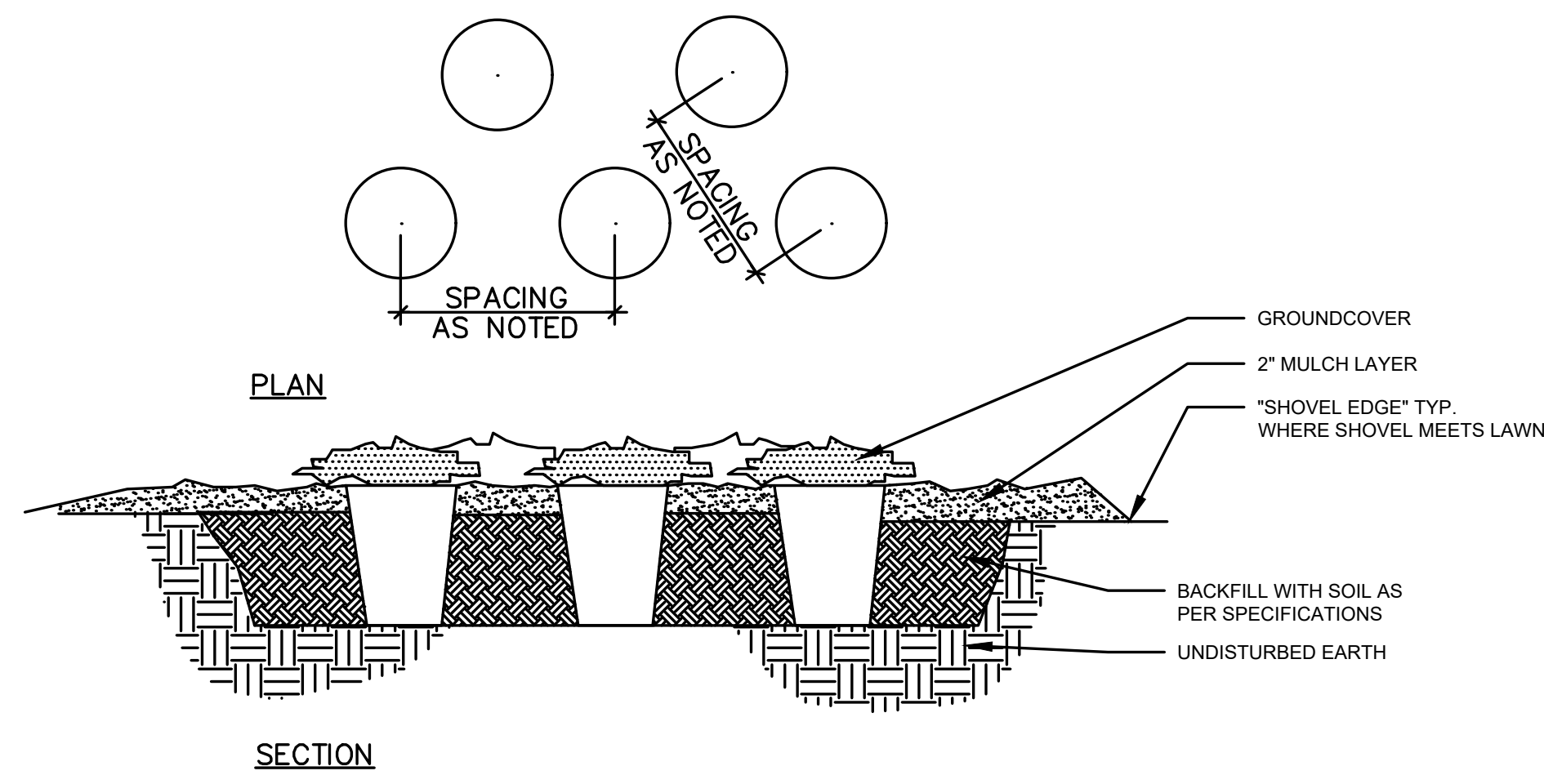

1 GROUNDCOVER PLANTING DETAIL
NTS

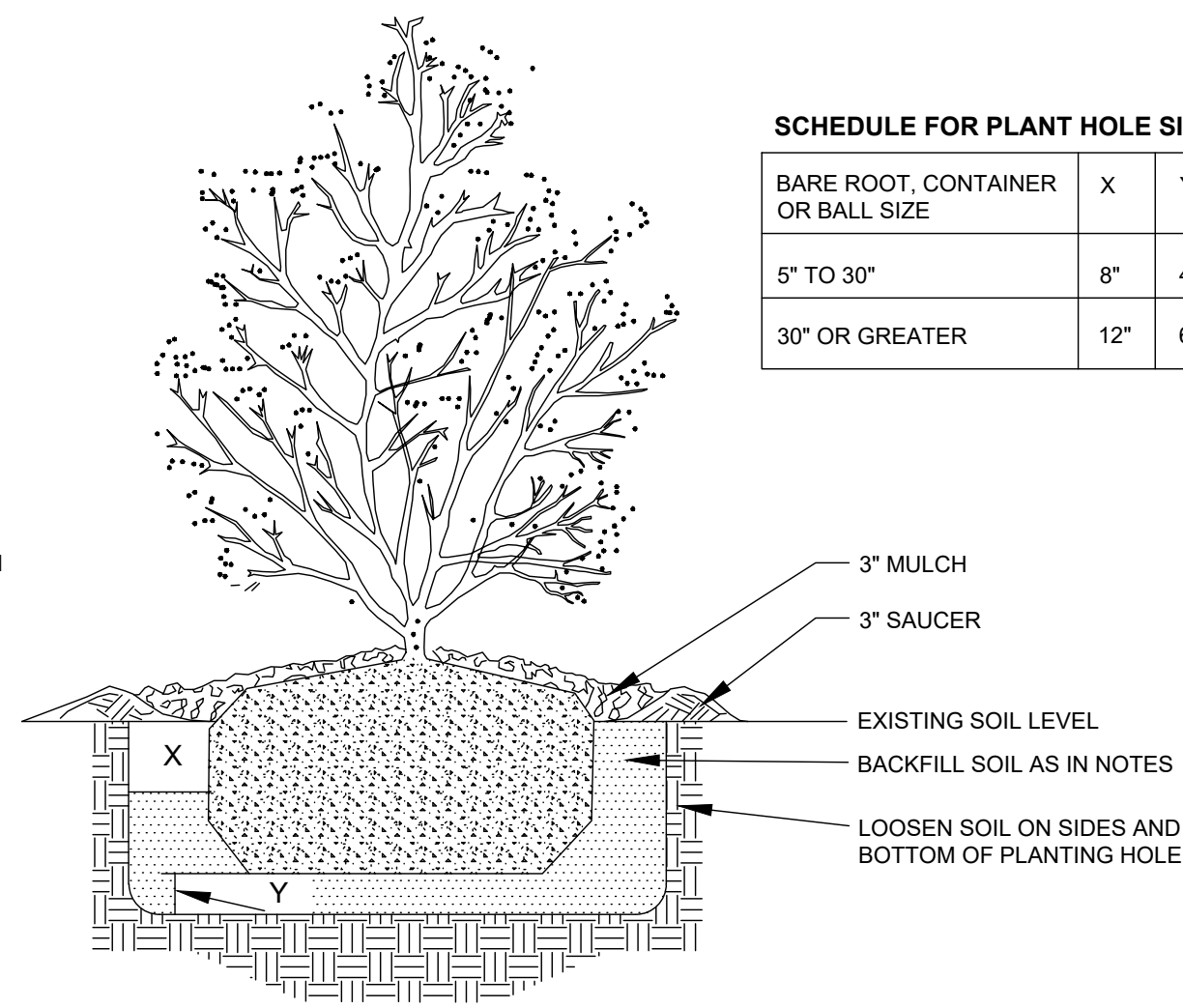

2 SHRUB PLANTING DETAIL
NTS

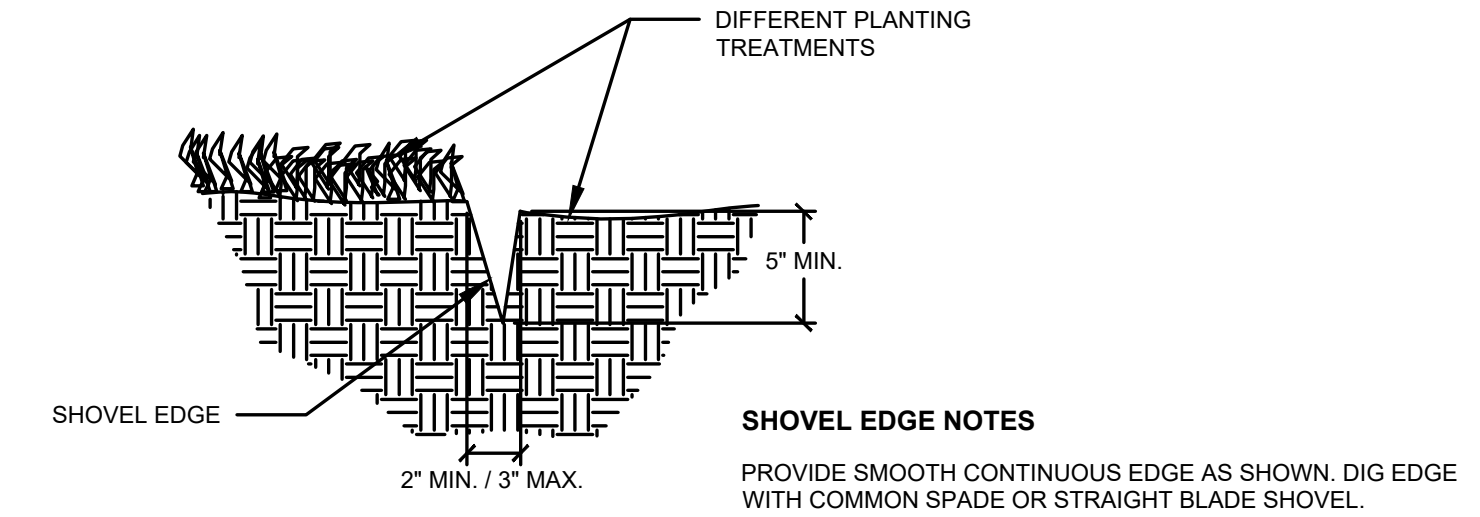

3 SHOVEL EDGE DETAIL
NTS

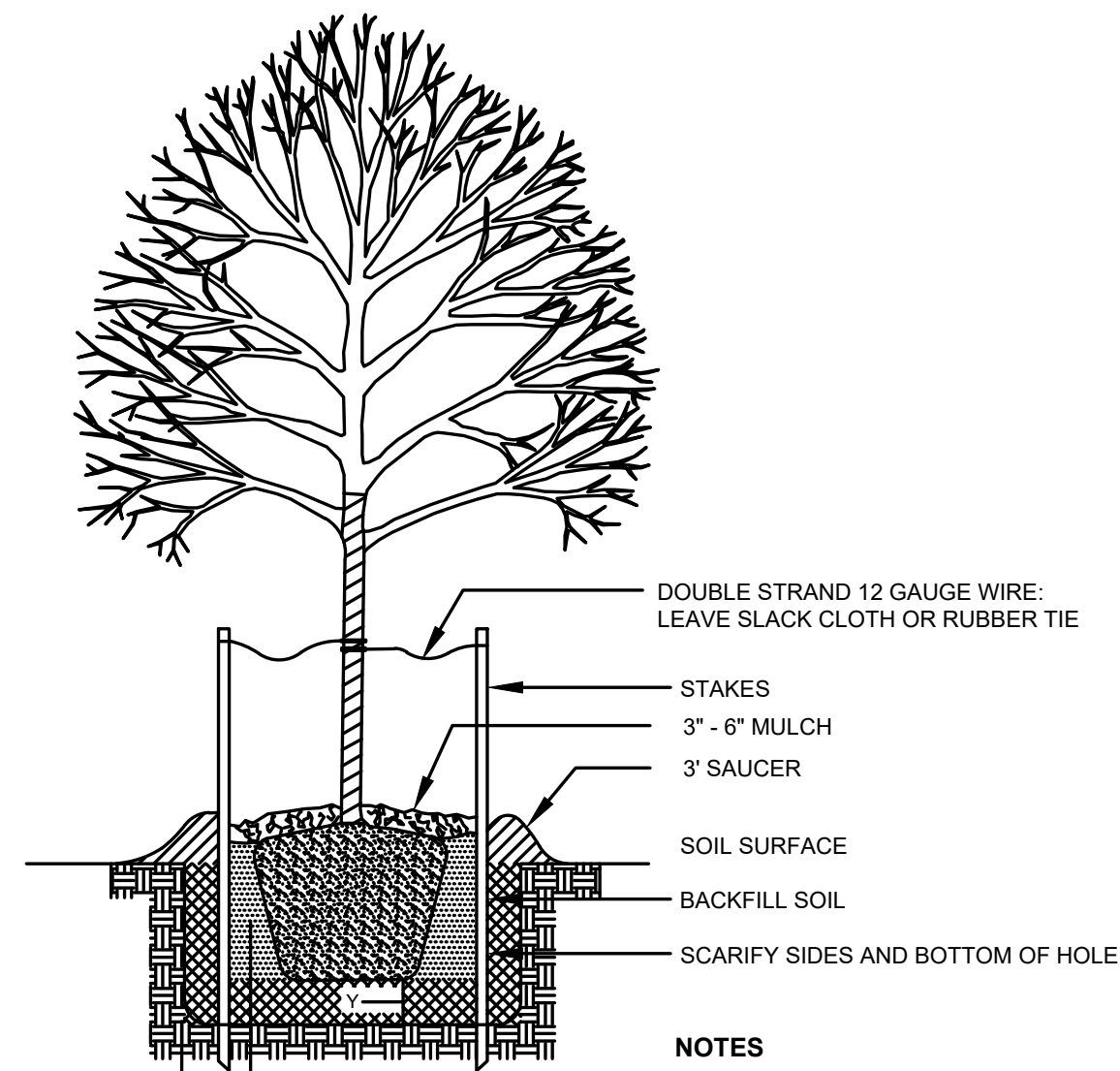

TREE PLANTING AND STAKING

STAKING - TREES WILL BECOME STRONGER FASTER WHEN THE TOP 2/3 OF THE TREE IS FREE TO SWAY. TIE THE TRUNK LOOSELY WITH WIDE STRIPS OF RUBBER OR CLOTH ABOUT 1/3 UP THE TRUNK AND TIE TO THREE STAKES POSITIONED EVENLY AROUND THE TRUNK. STAKES SHOULD BE DRIVEN DEEPLY INTO THE GROUND TO PREVENT DISLODGING. CHECK AT LEAST EVERY THREE MONTHS FOR BINDING OR OTHER PROBLEMS. STAKES AND TIES SHOULD BE REMOVED SIX MONTHS TO ONE YEAR AFTER PLANTING.

WRAPPING - WRAP ONLY THIN BARKED TREES IF THEY HAVE BEEN REMOVED FROM SHADE TO WHERE THE TRUNK IS EXPOSED TO DIRECT SUNLIGHT DURING THE DAY. WRAPPING SHOULD BEGIN AT THE BOTTOM AND WORK UP. WRAPPING MATERIAL SHOULD NOT TRAP OR HOLD WATER.

PRUNING - CLEANLY PRUNE DAMAGED BRANCHES AND ROOTS AT THIS TIME. ADDITIONAL PRUNING SHOULD BE ONLY FOR SHAPING PURPOSES.

PLANTING - ALL SYNTHETIC MATERIALS SHALL BE CLEARED FROM THE ROOTS, TRUNK AND CROWN OF THE PLANT. THE ROOT BALL MEDIUM SHOULD BE SHAKEN GENTLY FROM THE ROOT BALL IF IT IS A SOILLESS MIXTURE. LOOSEN AND SPREAD THE ROOTS IN THE PLANTING HOLE. DAMAGED ROOTS AND ROOTS WHICH ENCIRCLE THE TRUNK SHOULD BE CLEANLY PRUNED. SET THE PLANT SO THAT IT WILL BE AT ITS ORIGINAL DEPTH OR SLIGHTLY ABOVE EXISTING GRADE. BACKFILL WITH SOIL FROM THE HOLE. TAMP AND WATER THE SOIL TO PREVENT AIR POCKETS. DO NOT AMEND THE SOIL AT THIS POINT EXCEPT TO AMEND THE PH.

WATERING - THE BACKFILL AND ROOTS OF ALL NEWLY SET PLANTS SHOULD BE WATERED AS BACKFILLING IS BEING DONE SO THAT THE SOIL AND ROOTS ARE THOROUGHLY SOAKED.

SCHEDULE FOR PLANT HOLE SIZE

BARE ROOT, CONTAINER OR BALL SIZE	X	Y
5" TO 30"	8"	4"
30" OR GREATER	12"	6"

NOTES

REMOVE BURLAP FROM TOP OF ROOT BALL BEFORE BACKFILLING AROUND BALL IS COMPLETED

ALL TREES WHICH ARE SMOOTH BARKED AT THE TIME OF PLANTING AND HAVE MORE THAN 2' OF CLEAR TRUNK SHALL BE WRAPPED

ALL TREE WRAPPING SHALL EXTEND FROM THE TOP OF THE BACKFILL TO THE LOWERMOST TREE BRANCHES

4 TREE PLANTING AND STAKING DETAIL
NTS

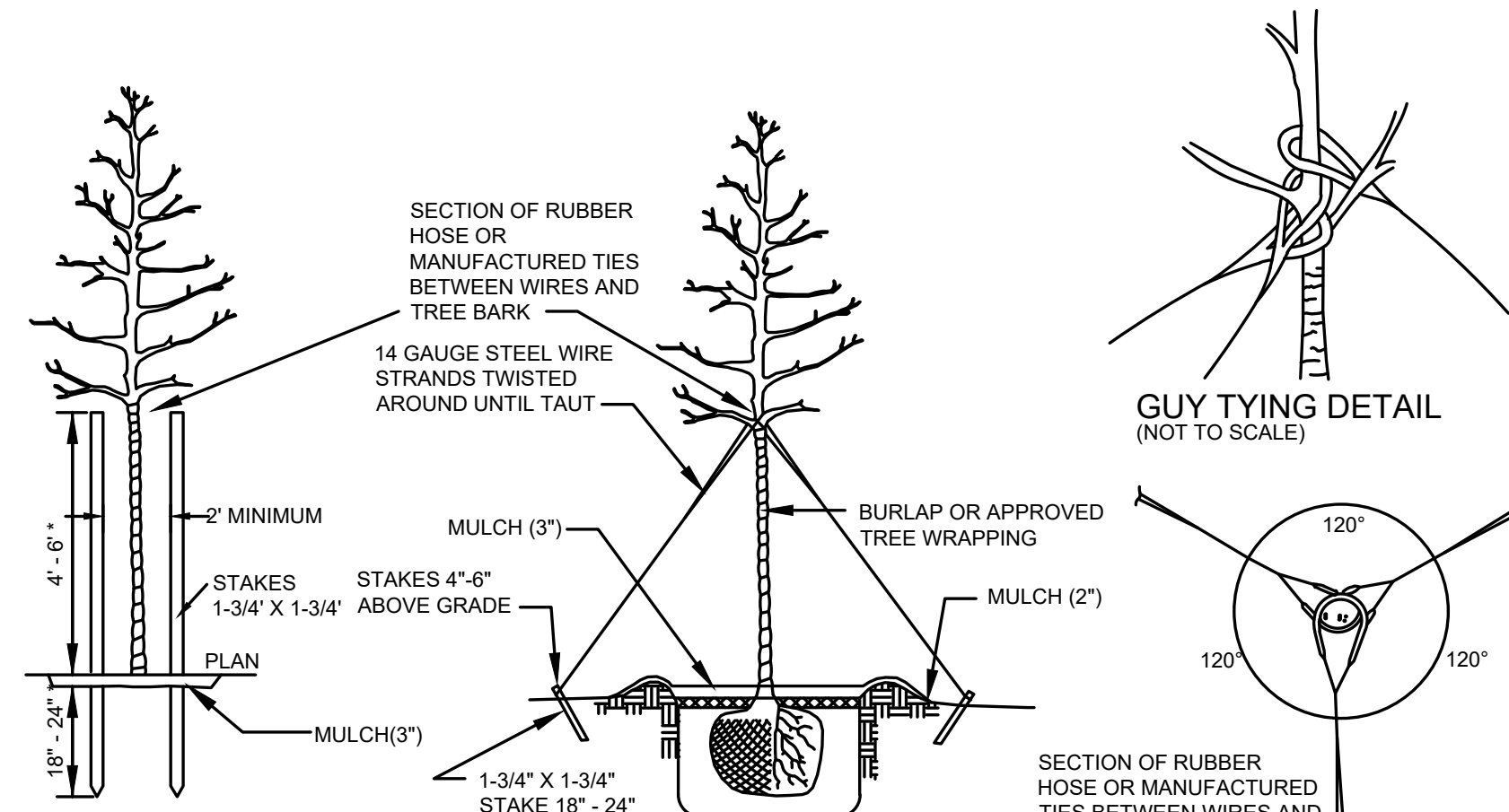

STAKING DIAGRAM
FOR TREES 6' TO 10' LARGER
(NOT TO SCALE)

TREE GUYING DIAGRAM
FOR TREES 10' OR LARGER
(NOT TO SCALE)

GUY SPACING DETAIL
(NOT TO SCALE)

5 TREE STAKING DETAIL
NTS

GENERAL LANDSCAPING NOTES:

- LANDSCAPE CONTRACTOR SHALL HAVE ALL UNDERGROUND UTILITIES LOCATIONS LOCATED PRIOR TO INSTALLING PLANT MATERIAL.
- CONTRACTOR SHALL COMPLY WITH SIZING AND GRADING STANDARDS OF THE LATEST EDITION OF THE "AMERICAN STANDARD FOR NURSERY STOCK" BY THE AMERICAN ASSOCIATION OF NURSERYMEN (AAN).
- CONTRACTOR SHALL NOT PLANT NEW PLANT MATERIAL IN CRITICAL ROOT ZONES OF EXISTING TREES TO BE SAVED AND PROTECTED ON SITE.
- LANDSCAPING STANDARDS HAVE BEEN APPLIED PER CHATHAM COUNTY DEVELOPMENT ORDINANCE.
- SHOULD FINAL CONDITIONS OF THE EXISTING VEGETATION NOT PROVIDE THE REQUIRED BUFFER OPACITY, THE APPLICANT UNDERSTANDS THAT SUPPLEMENTAL PLANTINGS WILL BE REQUIRED.
- CANOPY TREES SHALL BE PLANTED AT LEAST 30 FEET APART (40' MAX.).
- DECIDUOUS UNDERSTORY TREES SHALL BE PLANTED AT LEAST 12 FEET APART.
- THE SPACING BETWEEN CANOPY AND DECIDUOUS UNDERSTORY SHALL BE AT LEAST SIX FEET.
- SHRUBS SHALL NOT BE PLANTED CLOSER THAN THREE FEET ON CENTER.
- TREE PLANTING AND SITE LIGHTING SHALL BE SEPARATED BY A MINIMUM OF 10 FEET.
- WHERE EXISTING OR PROPOSED VEGETATION FAILS TO FUNCTION ADEQUATELY AS REQUIRED, THE CITY OF RALEIGH SITE INSPECTOR RESERVES THE RIGHT TO REQUIRE SUPPLEMENTAL PLANTINGS IN ADDITION TO THOSE SHOWN ON THE LANDSCAPE PLAN BASED ON ACTUAL FIELD CONDITIONS.
- THE SIZE OF THE PLANTING AREA AND OF PLANT MATERIAL AT MATURITY SHALL ALLOW FOR A TWO AND ONE-HALF FEET WIDE BUMPER OVERHANG MEASURED FROM THE BACK OF CURB.
- ALL PLANT MATERIAL INSTALLED WITHIN A SIGHT DISTANCE MAINTENANCE EASEMENT SHALL BE MAINTAINED AT A HEIGHT ABOVE SIX FEET OR BELOW TWO FEET.
- UPON ESTABLISHMENT OF FINISHED GRADES AND PRIOR TO BEGINNING INSTALLATION OF ANY TREES, A SOIL AMENDMENT SCHEDULE FOR ALL TREE PLANTINGS SHALL BE PREPARED BY THE CONTRACTOR AND APPROVED BY THE LANDSCAPE ARCHITECT.
- PRIOR TO THE ISSUANCE OF A CERTIFICATE OF OCCUPANCY, A CERTIFIED STATEMENT SHALL BE PROVIDED TO THE CITY OF RALEIGH SITE INSPECTOR ATTESTING TO THE FACT THAT THE SOIL AMENDMENT SCHEDULE WAS FOLLOWED AS SPECIFIED IN THE APPROVED SITE AND/OR SUBDIVISION PLAN. THIS STATEMENT SHALL BE CERTIFIED BY A REGISTERED LANDSCAPE ARCHITECT, CERTIFIED ARBORIST, OR OTHER SPECIALIST AS DETERMINED ACCEPTABLE BY THE PLANNING DIRECTOR.
- WITHIN THE AREA OF ABOVE DEFINED SIGHT TRIANGLE, THERE SHALL BE NO SIGHT OBSTRUCTING OR PARTLY OBSTRUCTING WALL, FENCE, SIGN, FOLIAGE, BERMS, OR PARKED VEHICLES BETWEEN THE HEIGHTS OF 24 INCHES AND EIGHT FEET ABOVE THE CURB LINE ELEVATION OR THE NEAREST TRAVELED WAY IF NO CURBING EXISTS.
- PRESERVED TREE AREAS SHALL BE STRICTLY PROTECTED. NO SOIL OR TREE DISTURBING ACTIVITY SHALL TAKE PLACE WITHIN TREE PRESERVATION AREAS; INCLUDING: CHANGES TO VEGETATIVE COVER, STABILIZATION OF A STRUCTURE OR FENCE, ROAD OR WALKWAY CONSTRUCTION, TREE REMOVAL OR PRUNING, CHEMICAL OR BIOLOGICAL AGENT APPLICATION, PERMANENT OR TEMPORARY ENCROACHMENTS OF IMPERVIOUS SURFACES, VEHICLES, EQUIPMENT OR MATERIALS.

NO.	REVISIONS	DATE	BY
7			
6			
5			
4			
3			
2			
1			

COPYRIGHT © 2015 SUMMIT DESIGN AND ENGINEERING SERVICES
DRAWING ALTERATION
IT IS A VIOLATION OF LAW FOR ANY PERSON TO REPRODUCE, TRANSMIT, OR IN ANY MANNER DISSEMINATE THE CONTENTS OF THIS DOCUMENT IN ANY MANNER WITHOUT THE WRITTEN PERMISSION OF THE ORIGINAL AUTHOR. ANY VIOLATION OF THIS POLICY SHALL BE SUBJECT TO LEGAL ACTION.

PROJECT ENGINEER/ARCHITECT
MARY WILLIAM WRIGHT@SUMMITDE.COM
PROJECT MANAGER
MMP (MICK PARKER@SUMMITDE.COM)
DRAWN BY
FEW (FRANKIE WANG@SUMMITDE.COM)
FIRST ISSUE DATE
DATE OF SUBMITTAL

SUMMIT
DESIGN AND ENGINEERING SERVICES
State License #: 31-0339
320 Executive Court
Fayetteville, NC 27278
Voice: (919) 732-3883 Fax: (919) 732-4676
www.summitde.com

SITE SUBMISSION PLANS
FARRINGTON POINT ROAD
1780 FARRINGTON POINT RD
CHATHAM COUNTY, NC
LANDSCAPE DETAILS

PROJECT NO.
23-0070
DRAWING NAME:
23-0070_ls.dwg
SHEET NO.
LS-2



Know what's below.
Call before you dig.