

PLANT LIST

SYMBOL	COMMON NAME	BOTANICAL NAME	SIZE CLASSIFICATION (AT PLANTING)	QUANTITY
○	SUGAR MAPLE	ACER BARBATUM	2-1/2" CAL.	24
⊗	WHITE OAK	QUERCUS ALBA	2-1/2" CAL.	29
⊙	JAPANESE CEDAR	CRYPTOMERIA	5 GAL.	12
⊕	EASTERN RED CEDAR	JUNIPERUS VIRGINIANA	5 GAL.	10
⊖	YAUPON HOLLY	ILEX VOMITORIAN	5 GAL.	8
⊗	AMERICAN BEAUTY BERRY	CALICARPA AMERICANA	2 GAL.	28
⊕	OAK LEAF HYDRANGEA	HYDRANGEA QUERCIFOLIA	2 GAL.	15
⊖	ENGLISH BOXWOOD	BUXUS SEMPERVIRENS	2 GAL.	28

NOTES:

- PROPERTY LINES, TOPOGRAPHIC DATA, UTILITIES, 100 YEAR FLOOD ELEVATION, AND ROADWAY AND EDGE OF PAVEMENT ARE SHOWN PER FIELD SURVEY RECEIVED FROM SUMMEY ENGINEERING ASSOCIATES, PLLC 150 FAYETTEVILLE STREET ASHEBORO, NC 27203 PHONE: 336-328-0902.
- EXISTING TREELINES HAVE BEEN ESTIMATED BY AERIAL IMAGERY AND SITE PHOTOGRAPHY.
- TOTAL PARCEL SIZE: 1,471,674 Sq. Ft. = 33.78 ACRES
- CONTRACTOR TO SAVE ALL EXISTING TREES TO THE EXTENT POSSIBLE OVER THE ENTIRE PROPERTY.
- LIMITS OF DISTURBANCE SHOULD BE USED FOR SITE CLEARING LIMITS.
- TOTAL SPACES PROVIDED: 244 PARKING SPACES

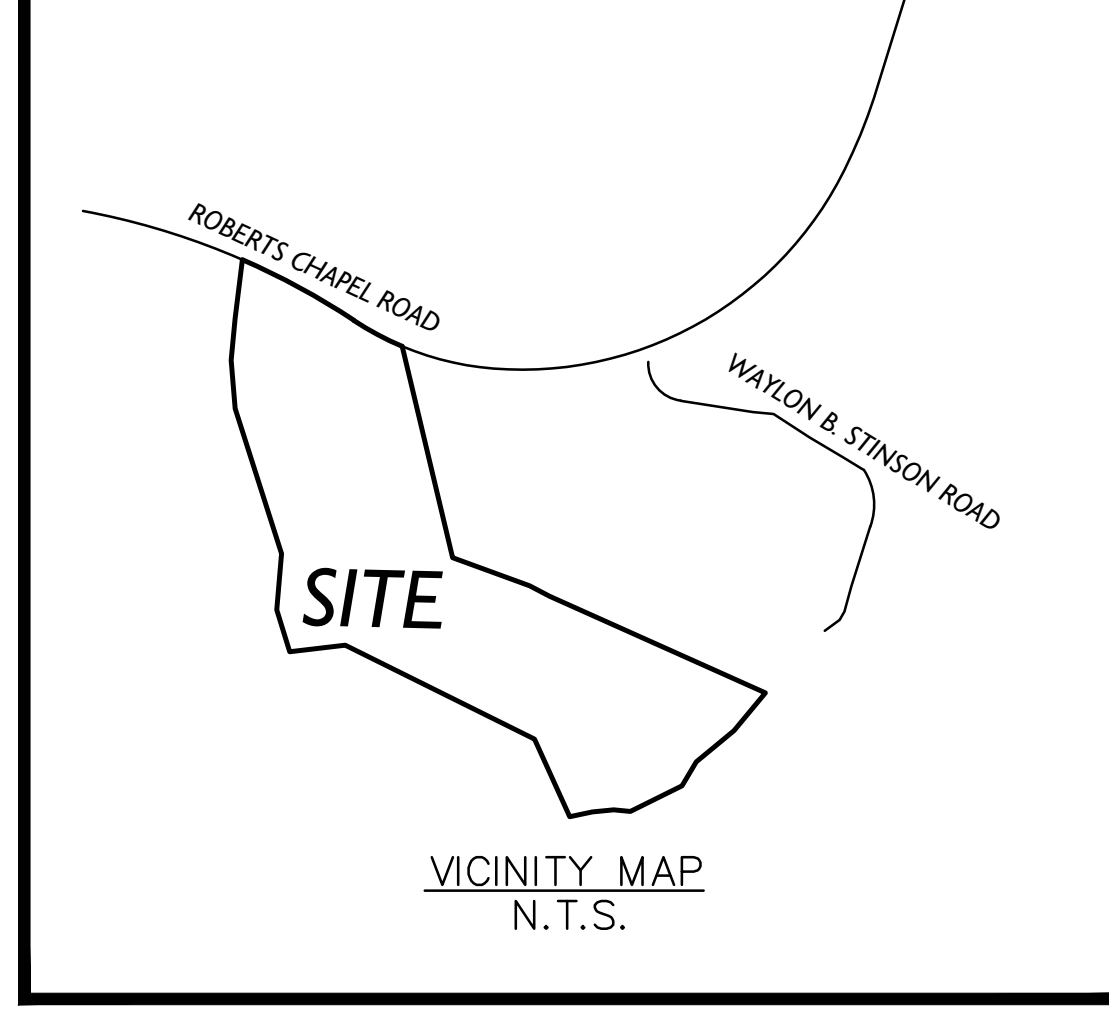

ROBERTS CHAPEL ROAD  
STREET YARD  
REQUIREMENT: APPROVED STREET YARD TREES SPACED AT 40' APART  
PROVIDED: TWO STAGGERED ROWS CONSISTING OF 13 SOUTHERN SUGAR MAPLES  
15 WHITE OAK.  
TREES TO BE AT LEAST A 2-1/2" CALIPER AT TIME OF PLANTING.

TYPICAL SCREENING FOR PARKING AREAS  
TO CONSIST OF JAPANESE CEDARS, EASTERN RED CEDARS AND YAUPON HOLLIES

LANDSCAPE NOTE:  
RETAIN AS MUCH NATURAL VEGETATION AS POSSIBLE.

20' SCREEN B BUFFER:  
REQUIREMENTS: SCREENING OF UNDESIRABLE ELEMENTS (IN THIS CASE PARKING LOTS)  
PROVIDED: HEAVY SCREENING FOR PARKING AREAS AND SECTIONS LIGHTER SCREENING FOR VIEWS THAT ARE MORE PASTORAL.

TYPICAL SCREENING FOR MORE PASTORAL AREAS  
WILL CONSIST OF AMERICAN BEAUTY BERRIES, OAK LEAF HYDRANGEAS AND BOXWOODS

BUA NOTES			
TOTAL SITE AREA	1,471,674.00	SF.	33.78 AC.
EXISTING IMPERVIOUS AREA	12,437.00	SF.	0.29 AC.
NET SITE AREA	1,459,237.00	SF.	33.50 AC.
PROPOSED IMPERVIOUS AREA	150,820.00	SF.	3.46 AC.
PROPOSED BUA	10.34		

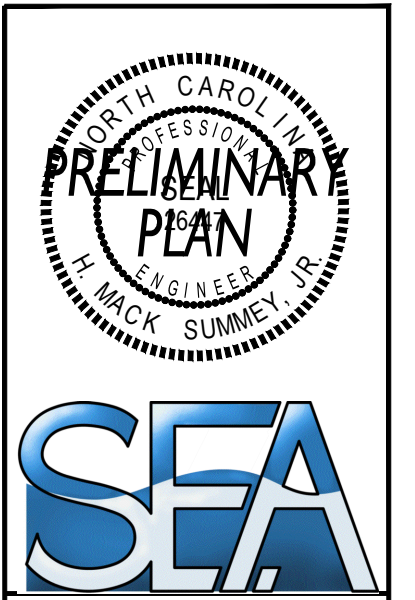

Summey Engineering Associates, PLLC  
Engineering - Consulting - Surveying  
PO Box 968  
Asheboro, NC 27204  
Phone: 336-328-0902 Fax: 336-328-0922  
E-mail: info@summeyengineering.com  
NC Professional Engineering Firm License No. E-01336

No.	Date	Description	By

PRELIMINARY SKETCH PLAN  
GOLDSTONS SPORTS  
ROBERTS CHAPEL ROAD  
CHATHAM COUNTY - NORTH CAROLINA

Scale:	AS NOTED
Date:	JAN. 2023
Drawn By:	DLP
Checked By:	HMSJ
Job No.:	E-871
Sheet No.:	01

