

## Robb Harrison

---

**From:** Robb Harrison [robb@searsdesigngroup.com]  
**Sent:** Thursday, December 1, 2022 4:32 PM  
**To:** 'ajackson@chatham.k12.nc.us'  
**Cc:** 'Dan Sears'  
**Subject:** Proposed Granville 43 Lot Subdivision - For Comments  
**Attachments:** 2022.10.13 Granville - Site Plan.pdf; Attachment 1\_VICINITY MAP 8.5x11.pdf

Dr. Jackson,

Per requirements of Chatham County Planning Department, we are writing to advise Chatham County Schools of a pending submittal for a 43 lot single-family subdivision which will adjoin Fearington Village in the northeast corner of the County; the goal is to see if Chatham County Schools has any comments related to the proposal. We have attached a plan and location map for your reference.

If there are comments we will pass along to Planning. Please let us know if you need any additional information.

Thank you,  
Robb

Robert G. Harrison, PLA, LEED AP, ASLA  
Sears Design Group, P.A.  
625 W. Jones Street  
Raleigh, NC 27603

---

**LEGEND**

- PHASE BOUNDARY
- - - RIGHT OF WAY LINE
- - - EASEMENT
- LOT LINE
- - - BUFFER
- - - STREAM BUFFER
- - - STREAM BANK
- - - TREE LINE
- - - PHASE LINE
- - - STREET LIGHTS
- - - OPEN SPACE FEATURE
- - - STORMWATER POND

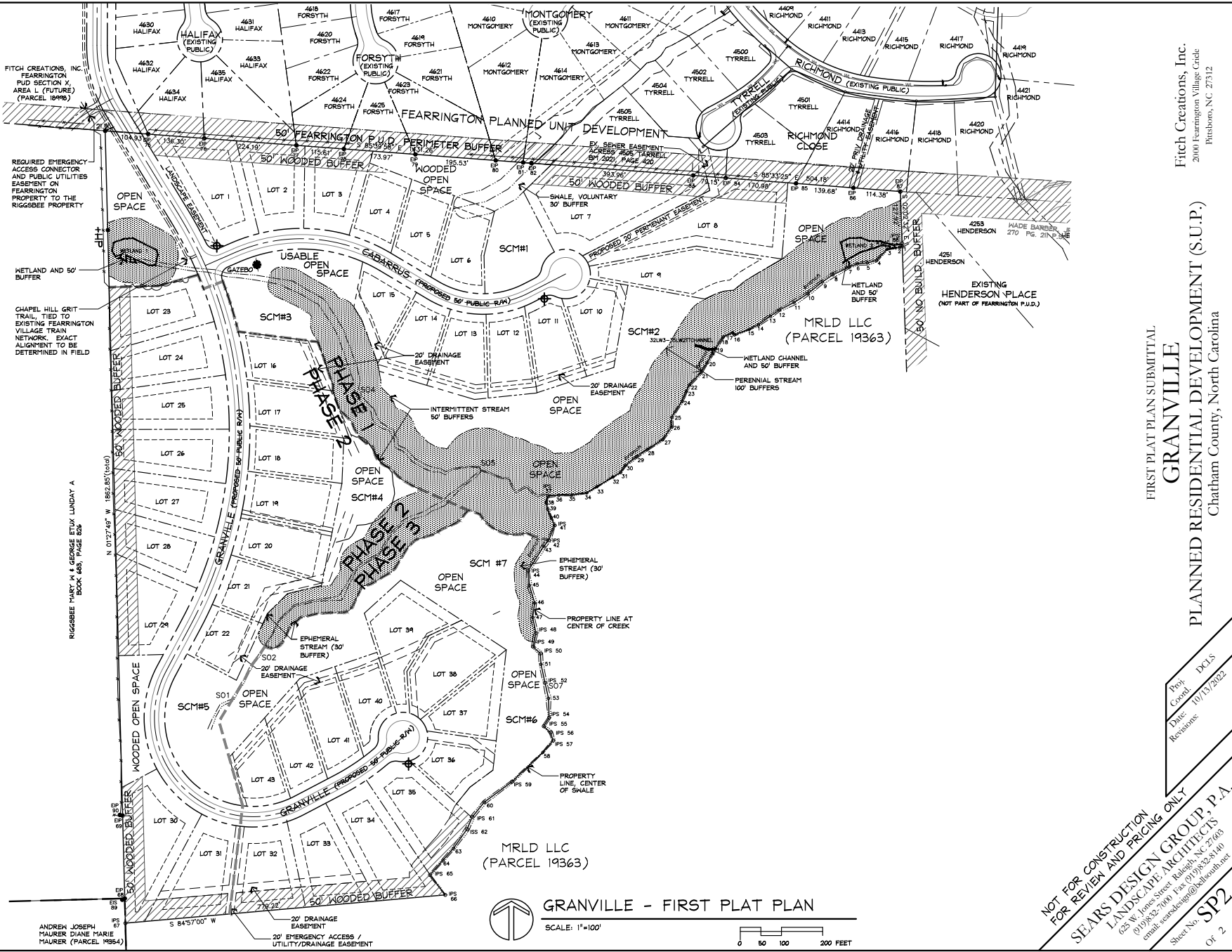

LINE	BEARING	DISTANCE
1	S 84°02'58" W	6.82'
2	S 81°46'48" W	25.86'
3	S 43°41'10" W	37.98'
4	S 74°46'38" W	22.53'
5	S 84°31'28" W	24.94'
6	S 89°27'25" W	22.23'
7	S 70°18'18" W	45.26'
8	S 74°46'38" W	45.26'
9	S 74°46'38" W	39.75'
10	S 74°46'38" W	26.38'
11	S 74°46'38" W	35.71'
12	S 64°20'01" W	25.02'
13	S 69°15'41" W	38.02'
14	N 37°28'12" W	6.79'
15	S 82°41'10" W	25.02'
16	S 33°24'06" W	34.67'
17	S 30°48'11" W	40.23'
18	S 31°59'23" W	27.99'
19	S 43°16'23" W	40.76'
20	S 23°33'43" W	16.63'
21	S 23°33'43" W	22.46'
22	S 23°33'43" W	23.75'
23	S 23°33'43" W	23.75'
24	S 23°33'43" W	23.75'
25	S 23°33'43" W	23.75'
26	S 23°33'43" W	23.75'
27	S 23°33'43" W	23.75'
28	S 23°33'43" W	23.75'
29	S 23°33'43" W	23.75'
30	S 23°33'43" W	23.75'
31	S 23°33'43" W	23.75'
32	S 23°33'43" W	23.75'
33	S 23°33'43" W	23.75'
34	S 23°33'43" W	23.75'
35	S 23°33'43" W	23.75'
36	S 23°33'43" W	23.75'
37	S 23°33'43" W	23.75'
38	S 23°33'43" W	23.75'
39	S 23°33'43" W	23.75'
40	S 23°33'43" W	23.75'
41	S 23°33'43" W	23.75'
42	S 23°33'43" W	23.75'
43	S 23°33'43" W	23.75'
44	S 23°33'43" W	23.75'
45	S 23°33'43" W	23.75'
46	S 23°33'43" W	23.75'
47	S 23°33'43" W	23.75'
48	S 23°33'43" W	23.75'

ANDREAN JOSEPH MAURER DIANE MARIE MAURER (PARCEL 19364)



**GRANVILLE - FIRST PLAT PLAN**

SCALE: 1"=100'

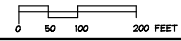

Fitch Creations, Inc.  
2000 Fearrington Village Circle  
Pittsboro, NC 27312

FIRST PLAT PLAN SUBMITTAL  
**GRANVILLE**  
PLANNED RESIDENTIAL DEVELOPMENT (S.U.P.)  
Chatham County, North Carolina

Prop: DCLIS  
Coord: DCLIS  
Date: 10/13/2022  
Revisions:

NOT FOR CONSTRUCTION  
FOR REVIEW AND PRICING ONLY  
SEARS DESIGN GROUP, P.A.  
625 W. Jones Street, Raleigh, NC 27603  
(919) 842-7000 Fax: (919) 842-4040  
email: searsdesign@searsdesign.com

Sheet No. **SP2**  
Of 2



# Chatham County Tax Map

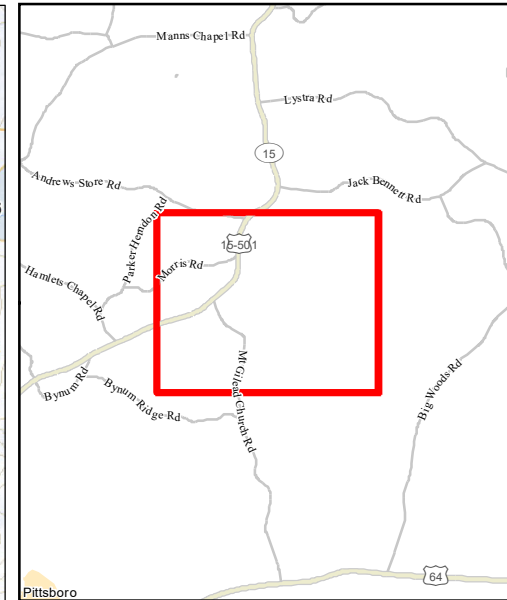
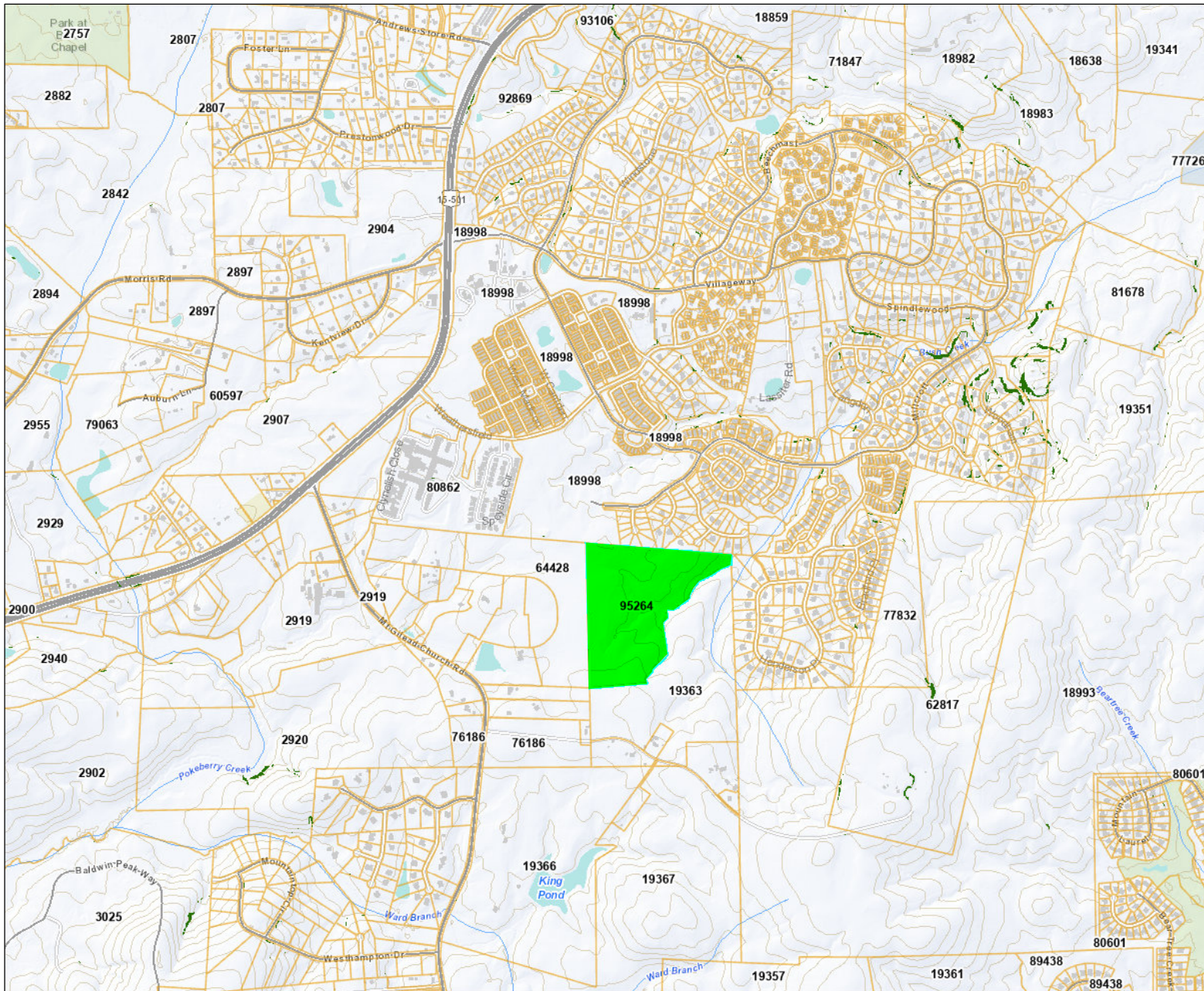

### Legend

Parcel Pop-Up	Local
RoadCenterlines_9K	Voluntary Ag Parcels
Freeway	Army Corps Land
Highway	<b>Slope</b>
Major Arterial	>25%
Minor Arterial	Parcels
Collector	

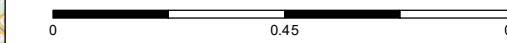

Service Layer Credits: Esri., Inc.,  
 City of Naperville, Illinois  
 Chatham County, Chatham County  
 GIS

Date: 3/16/2022  
 Time: 5:50:40 PM