



STATE OF NORTH CAROLINA
DEPARTMENT OF TRANSPORTATION

ROY COOPER
GOVERNOR

J. ERIC BOYETTE
SECRETARY

November 29, 2022

Granville Residential

Traffic Impact Analysis Review Report Congestion Management Section

TIA Project: SC-2022-339
Division: 8
County: Chatham



Nicholas C. Lineberger, P.E. Project Engineer
Madonna Saleh, Project Design Engineer

Mailing Address:
NC DEPARTMENT OF TRANSPORTATION
TRANSPORTATION MOBILITY & SAFETY DIVISION
1561 MAIL SERVICE CENTER
RALEIGH, NC 27699-1561

Telephone: (919) 814-5000
Fax: (919) 771-2745
Customer Service: 1-877-368-4968

Location:
750 N. GREENFIELD PARKWAY
GARNER, NC 27529

Website: www.ncdot.gov

Granville Residential

SC-2022-339

Pittsboro

Chatham County

Per your request, the Congestion Management Section (CMS) of the Transportation Mobility and Safety Division has completed a review of the subject site. The comments and recommendations contained in this review are based on data for background conditions presented in the sealed Traffic Impact Analysis (TIA) and are subject to the approval of the local District Engineer's Office and appropriate local authorities.

Date Initially Received by CMS	11/01/22	Date of Site Plan	10/13/22
Date of Complete Information	11/01/22	Date of Sealed TIA	11/01/22

Proposed Development

The TIA assumes the development is to be constructed by 2028 and is to consist of the following:

Land Use	Land Use Code	Size
Single-Family Detached Housing	210	44 units

Trip Generation - Unadjusted Volumes During a Typical Weekday			
	IN	OUT	TOTAL
AM Peak Hour	9	26	35
PM Peak Hour	29	17	46
Daily Trips			474

General Reference





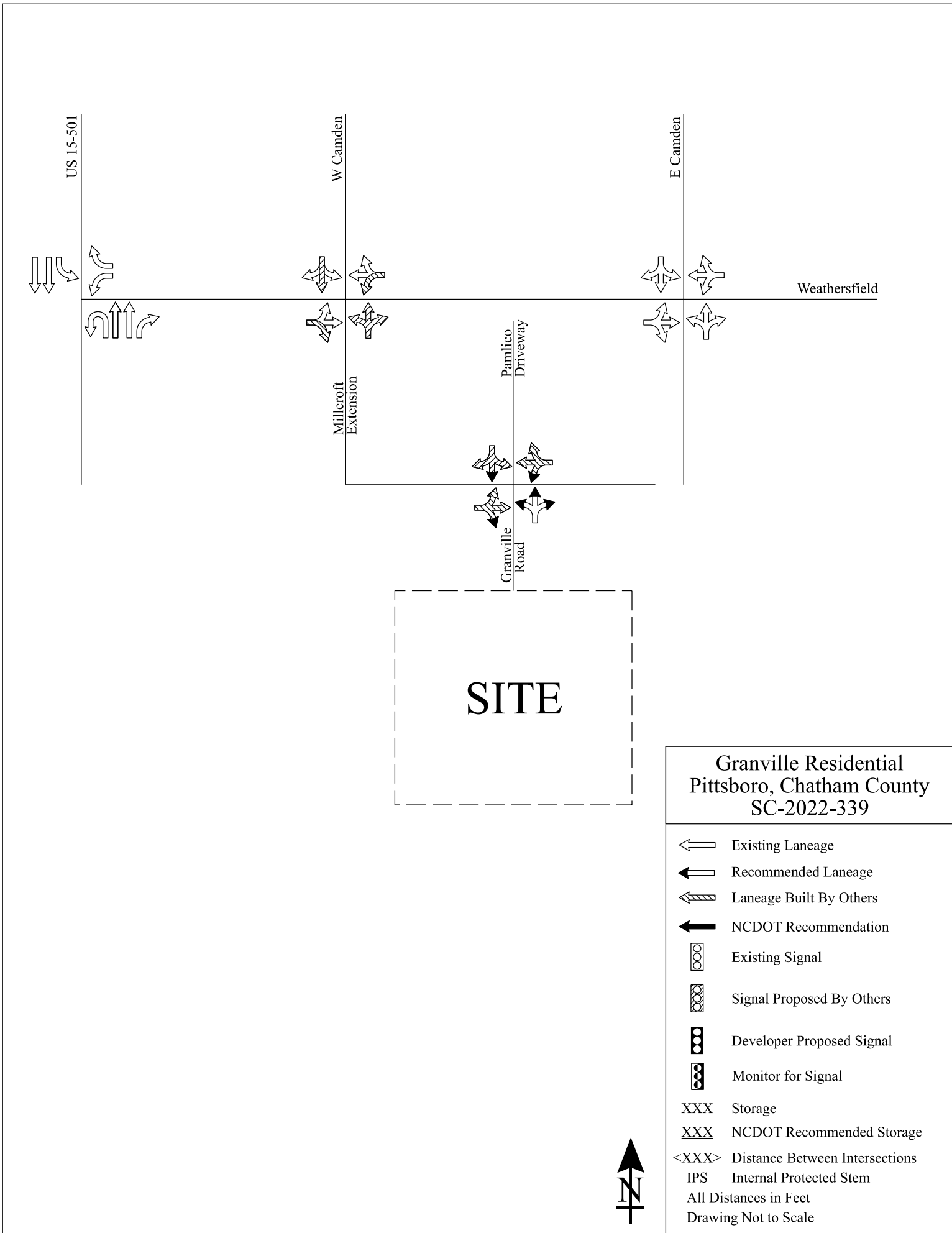



For reference to various documents applicable to this review please reference the following link: <http://www.ncdot.org/doh/preconstruct/traffic/tepl/Topics/C-37/C-37.html>

Once the driveway permit has been approved and issued, a copy of the final driveway permit requirements should be forwarded to this office. If we can provide further assistance, please contact the Congestion Management Section.



SITE

Granville Residential
 Pittsboro, Chatham County
 SC-2022-339

-  Existing Laneage
-  Recommended Laneage
-  Laneage Built By Others
-  NCDOT Recommendation
-  Existing Signal
-  Signal Proposed By Others
-  Developer Proposed Signal
-  Monitor for Signal
- XXX Storage
- XXX NCDOT Recommended Storage
- <XXX> Distance Between Intersections
- IPS Internal Protected Stem
- All Distances in Feet
- Drawing Not to Scale

