

ROBERTS CHAPEL ROAD
STREET YARD
REQUIREMENT: APPROVED STREET YARD TREES SPACED AT 40' APART
PROVIDED: TWO STAGGERED ROWS CONSISTING OF 13 SOUTHERN SUGAR MAPLES
15 LACEDARK ELMS.
TREES TO BE AT LEAST A 2-1/2" CALIPER AT TIME OF PLANTING.

TYPICAL SCREENING FOR PARKING AREAS
TO CONSIST OF JAPANESE CEDARS, EASTERN RED
CEDARS AND YAUPON HOLLIES

20' SCREEN B BUFFER:
REQUIREMENTS SCREENING OF UNDESIRABLE ELEMENTS
(IN THIS CASE PARKING LOTS)
PROVIDED: HEAVY SCREENING FOR PARKING AREAS AND
SECTIONS LIGHTER SCREENING FOR VIEWS THAT ARE MORE
PASTORAL.

TYPICAL SCREENING FOR MORE PASTORAL AREAS
WILL CONSIST OF AMERICAN BEAUTY BERRIES, OAK LEAF
HYDRANGEAS AND SPIREA

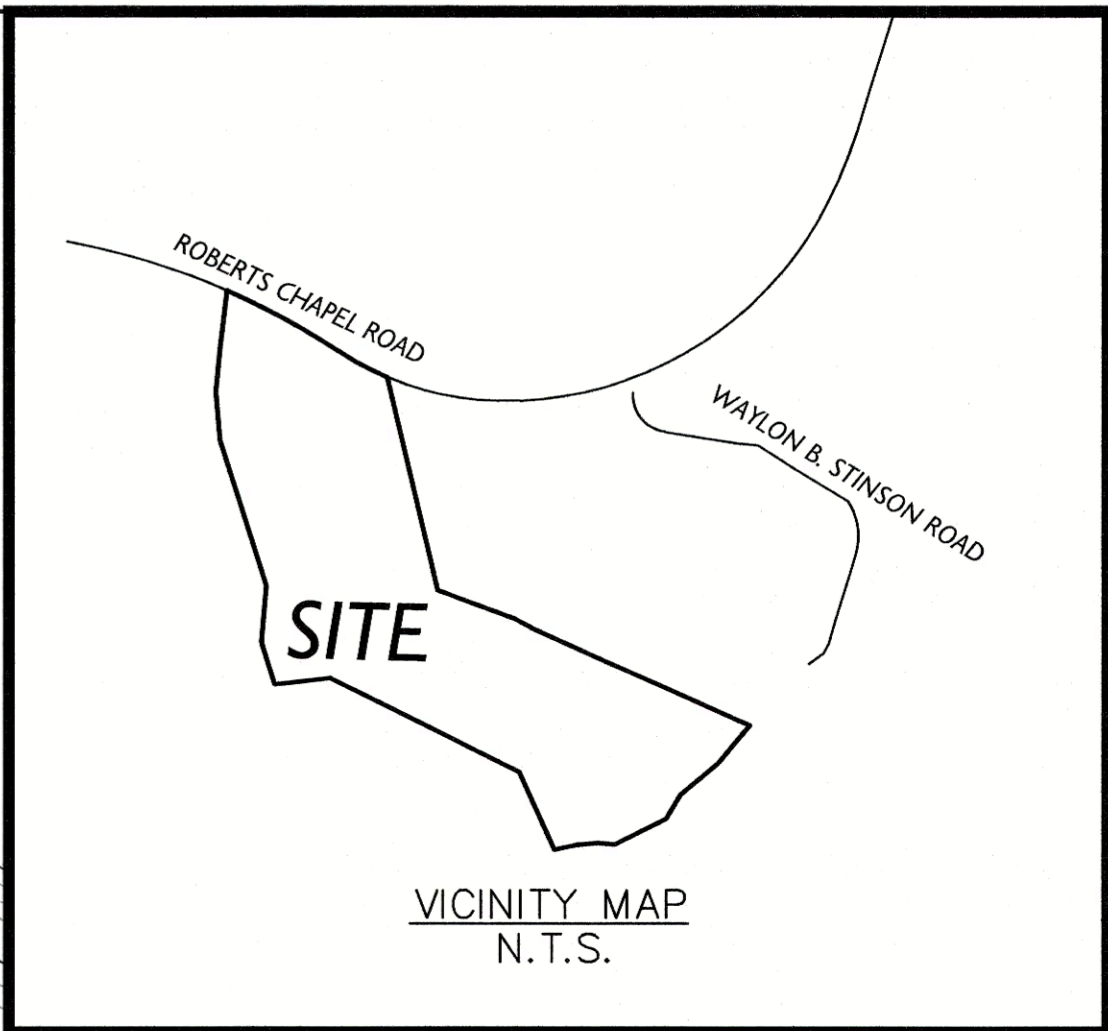
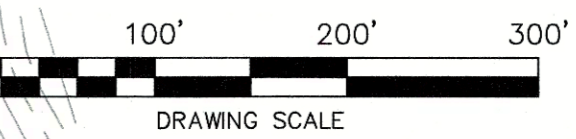

Summey Engineering Associates, PLLC
Engineering - Consulting - Surveying
Asheboro, NC 27209
PO Box 968
Phone: 336-526-0922 Fax: 336-526-0922
E-mail: info@summeyengineering.com
N.C. Professional Engineering Firm License No. P-03756

No.	Date	Description	By

PROPOSED LANDSCAPING PLAN
KIRAN ATHLETIC FIELDS
ROBERTS CHAPEL ROAD
CHATHAM COUNTY - GOLDSTON - NORTH CAROLINA

Scale:	AS NOTED
Date:	SEPTEMBER, 2022
Drawn By:	PPC
Checked By:	HMSJ
Job No.:	E-871

Sheet No.

NAD 83
GRID
NORTH

P:\E-871 Kiran Athletic Fields - Mike Perry - Roberts Chapel Church Road\DWG\Civil\Site\E-871 CRICKET FIELDS BASE - R 12-05-22.dwg, 12/6/2022 11:35:14 AM

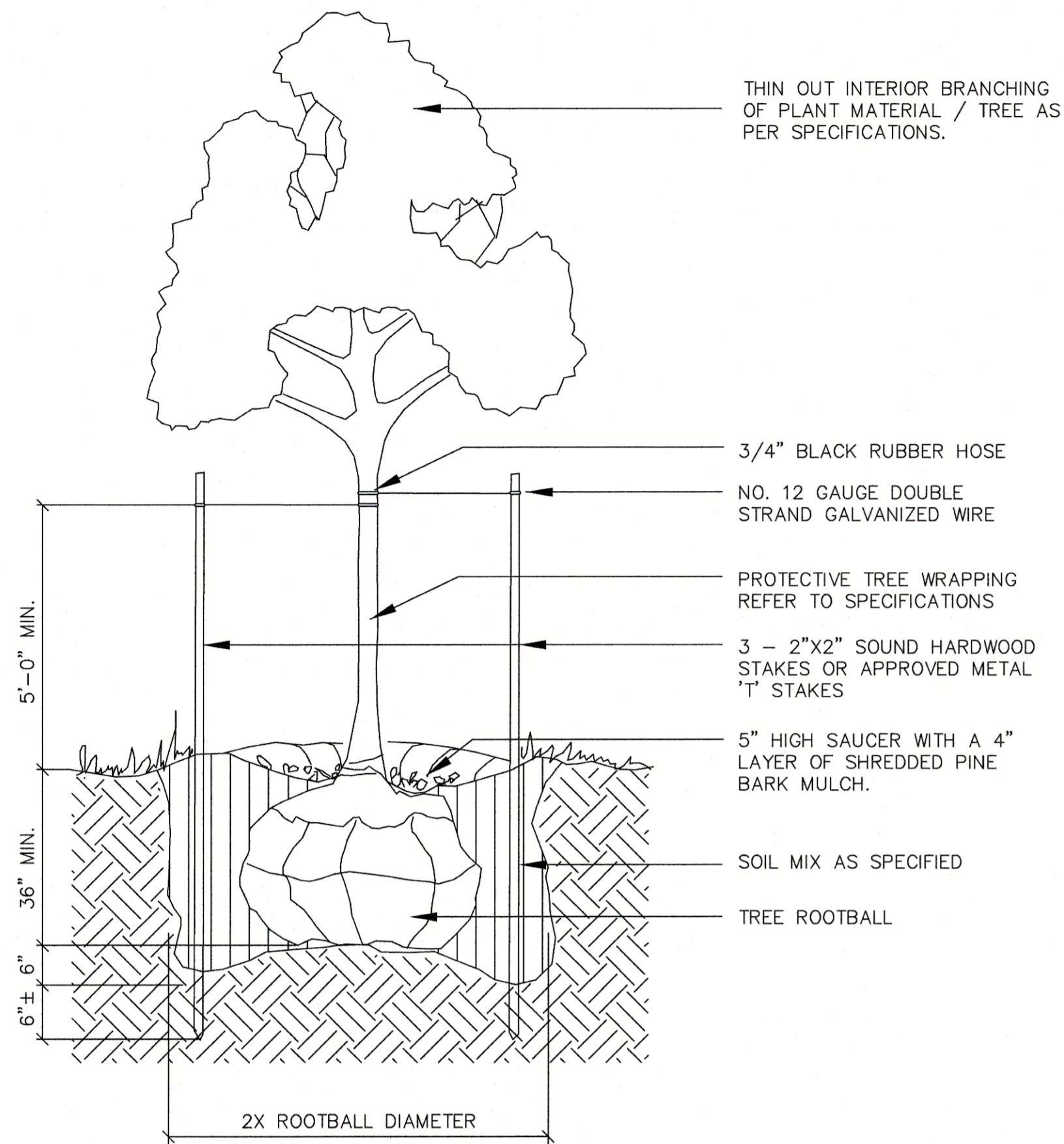

TYPICAL TREE PLANTING
N.T.S.

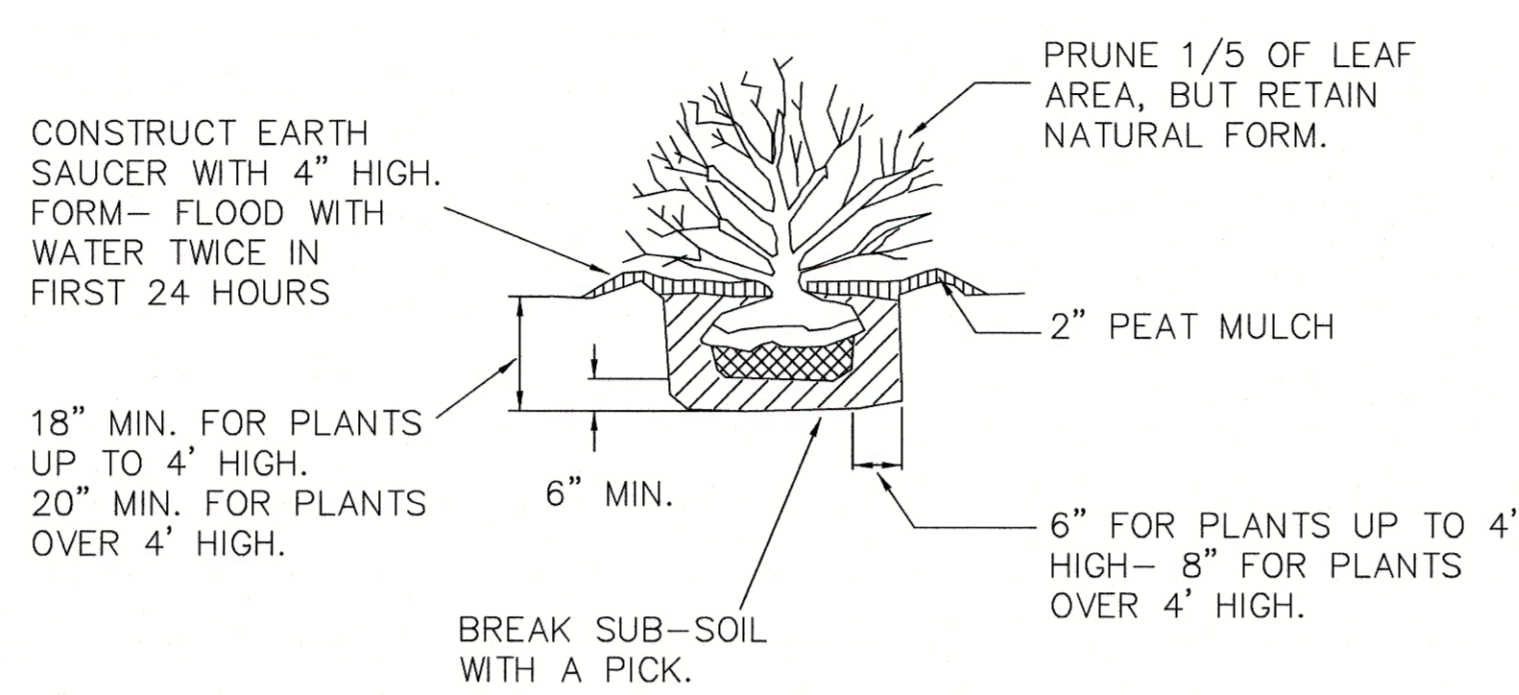

SHRUB PLANTING DETAIL
N.T.S.

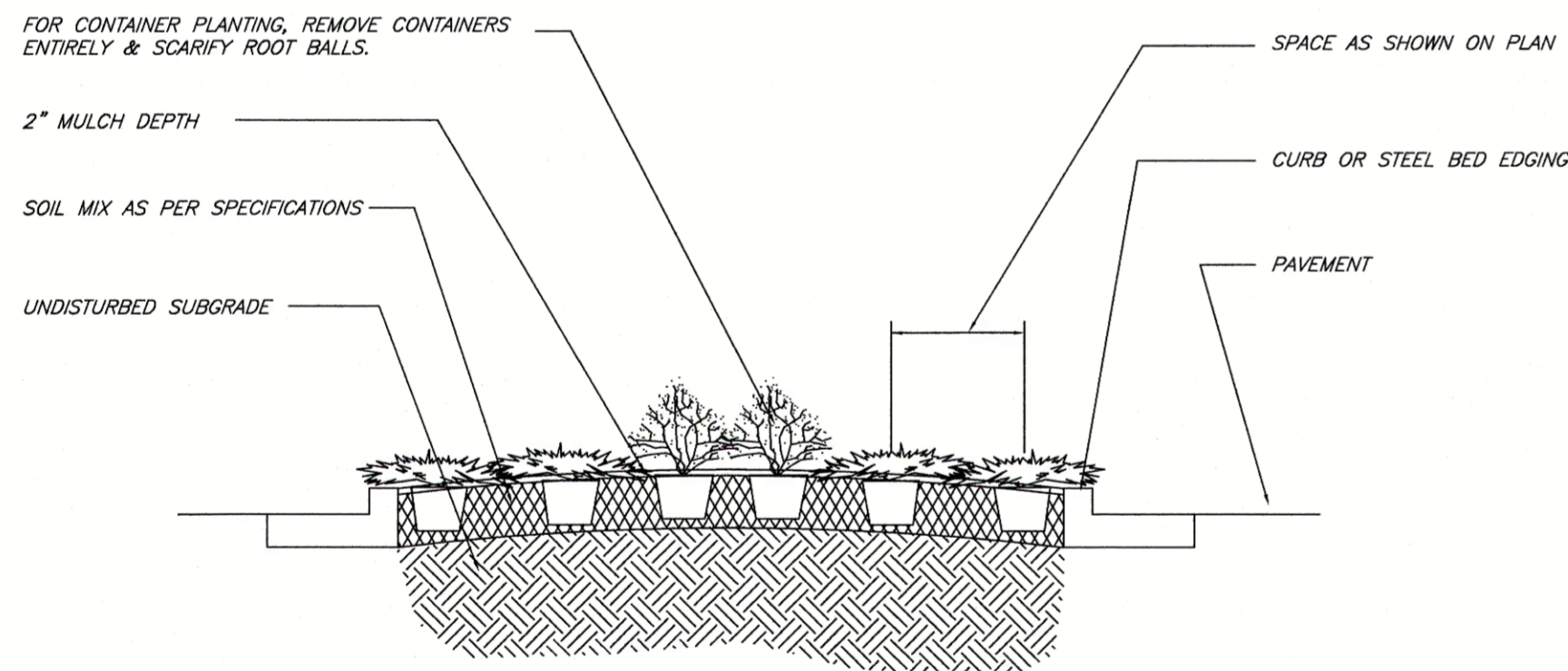

TYPICAL SECTION - SHRUB PLANTING
NOT TO SCALE

LANDSCAPE NOTES:

1. THE LANDSCAPE CONTRACTOR SHALL MAKE HIMSELF AWARE OF EXISTING UTILITIES. HE SHALL NOTIFY THE RESPECTIVE PUBLIC UTILITIES PRIOR TO BEGINNING CONSTRUCTION. CALL 811 FOR PUBLIC UTILITIES LOCATES PRIOR TO WORK
2. PLANTING BEDS AND PLANT LOCATIONS SHALL BE STAKED BY THE CONTRACTOR AND APPROVED BY THE OWNER OR OWNER'S REPRESENTATIVE PRIOR TO INSTALLATION.
3. PLANTING BEDS SHALL BE CLEARED OF ALL GRASS AND WEEDS PRIOR TO INSTALLATION OF PLANTS, AND SHALL BE CULTIVATED AS SHOWN ON THE PLANTING DETAILS.
4. ALL DISTURBED AREAS TO BE SEEDED UNLESS OTHERWISE NOTED.
5. PLANTING BEDS SHALL HAVE 2"-5" RIVER ROCK OVER WEED FABRIC. IN ENTIRE BED UNLESS OTHERWISE NOTED ON DRAWINGS.
6. ALL PLANTED AREAS SHALL BE TREATED WITH A WATER-SOLUBLE HERBICIDE FOR THE NON-SELECTIVE CONTROL OF ANNUAL AND PERENNIAL WEEDS PRIOR TO PLANTING.
7. ALL TREE AND SHRUB PITS SHALL BE BACKFILLED WITH A PLANTING SOIL MIXTURE OF 1 PART PEAT MOSS, 3 PARTS TOP SOIL AND 1 PART SAND, THOROUGHLY MIXED.
8. ALL PLANTED AREAS TO BE FERTILIZED WITH GRANULAR FERTILIZER. CONTRACTOR TO PROVIDE SOIL TEST AND FERTILIZER APPLICATION RATES IF REQUIRED FOR APPROVAL.
9. SPRAY TREES AND SHRUBS WITH AN ANTI-DESICCANT IF FOLIAGE IS PRESENT.
10. EVERGREEN TREES AND SHRUBS SHALL BE PLANTED THE SAME AS DECIDUOUS MATERIAL.
11. DO NOT PRUNE ANY MATERIAL UNTIL IT HAS BEEN VIEWED AND ACCEPTED BY THE OWNER OR OWNER'S REPRESENTATIVE.
12. ALL PLANT MATERIAL TO BE NURSERY GROWN AND TO COMPLY WITH AMERICAN STANDARD FOR NURSERY STOCK ANSI-Z60-1-1986.
13. ALL MATERIALS INSPECTED AT THE SITE AND FOUND NOT TO BE ACCEPTABLE SHALL BE REMOVED FROM THE SITE ON THE DAY OF REJECTION.
14. IMMEDIATELY AFTER A TREE IS PLANTED, IT SHOULD BE SUPPORTED WITH STAKES AND GUY WIRES TO FIRMLY HOLD IT IN PLACE. (SEE DETAIL-THIS SHEET) REMOVE STAKES AND TIES AFTER ONE YEAR.
15. THE LOWER TRUNKS OF NEW TREES SHOULD BE WRAPPED WITH BURLAP OR PAPER TO PREVENT EVAPORATION AND SUN SCALD. THE WRAPPING SHALL REMAIN ON THE TREE AT LEAST ONE YEAR.
16. PLANT ALL TREES AT LEAST 3 1/2 FEET FROM THE END OF HEAD-ON PARKING SPACES TO PREVENT DAMAGE FROM CAR OVERHANG.

PLANT LIST

SYMBOL	COMMON NAME	BOTANICAL NAME	SIZE CLASSIFICATION (AT PLANTING)	QUANTITY
	SUGAR MAPLE	ACER BARBATUM	2-1/2" CAL.	13
	LACEBARK ELM	ULMUS PARVIFOLIA	2-1/2" CAL.	15
	JAPANESE CEDAR	CRYPTOMERIA	5 GAL.	10
	EASTERN RED CEDAR	JUNIPERUS VIRGINIANA	5 GAL.	8
	YAUPON HOLLY	ILEX VOMITORIAN	5 GAL.	8
	AMERICAN BEAUTY BERRY	CALLICARPA AMERICANA	2 GAL.	26
	OAK LEAF HYDRANGEA	HYDRANGEA QUERCIFOLIA	2 GAL.	13
	SPIREA	SPIRAEA CVS	2 GAL.	26

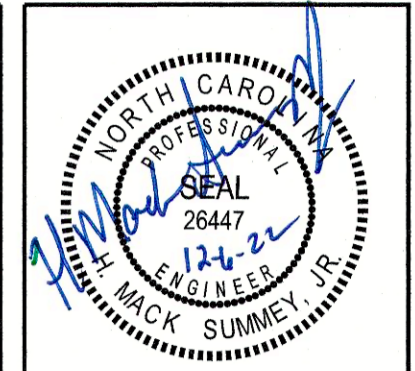

Summey Engineering Associates, PLLC
 Engineering - Consulting - Surveying
 Asheville, NC 27204
 Phone: 336-324-0902 Fax: 336-324-0922
 Email: info@summeyengineering.com
 NC Professional Engineering Firm License No. F-0956

No.	Date:	Description:	By:

LANDSCAPING DETAILS
 KIRAN ATHLETIC FIELDS
 ROBERTS CHAPEL ROAD
 CHATHAM COUNTY - GOLDSTON - NORTH CAROLINA

Scale:	AS NOTED
Date:	SEPTEMBER, 2022
Drawn By:	PPC
Checked By:	HWSJ
Job No.:	E-871

Sheet No. L-2