

Lot #	Area (SF)	Area (AC)	Lot #	Area (SF)	Area (AC)
A46	4639	0.11	B1	3313	0.08
A47	4580	0.11	B2	2729	0.06
A48	4561	0.10	B3	2729	0.06
A49	4542	0.10	B4	2729	0.06
A50	4524	0.10	B5	2729	0.06
A51	4505	0.10	B6	2729	0.06
A52	4486	0.10	B7	2729	0.06
A53	4468	0.10	B8	2729	0.06
A54	4462	0.10	B9	2729	0.06
A55	4472	0.10	B10	2729	0.06
A56	4486	0.10	B11	2729	0.06
A57	4499	0.10	B12	2729	0.06
A58	4512	0.10	B13	2729	0.06
A59	4526	0.10	B14	2729	0.06
A60	4539	0.10	B15	2729	0.06
A61	4552	0.10	B16	2729	0.06
A62	4746	0.11	B17	2729	0.06
A63	5306	0.12	B18	2729	0.06
A64	5199	0.12	B19	2729	0.06
A65	5247	0.12	B20	2729	0.06
A66	5593	0.13	B21	2729	0.06
A67	6283	0.14	B22	2729	0.06
A68	6283	0.14	B23	2729	0.06
A69	6283	0.14	B24	2729	0.06
A70	6283	0.14	B25	2729	0.06
A71	6284	0.14	B26	2729	0.06
A72	6283	0.14	B27	2729	0.06
A73	6284	0.14	B28	2729	0.06
A74	6283	0.14	B29	2729	0.06
A75	6283	0.14	B30	2631	0.06
A76	6363	0.15	B31	2520	0.06
A77	5735	0.13	B32	2522	0.06
A78	5823	0.13	B33	2575	0.06
A79	5428	0.12	B34	3260	0.07
A80	4921	0.11	Lot #	Area (SF)	Area (AC)
A81	4786	0.11	C1	4241	0.10
A82	4565	0.10	C2	3661	0.08
A83	4699	0.11	C3	3655	0.08
A84	6214	0.14	C4	3640	0.08
A85	7420	0.17	C5	3656	0.08
A86	7806	0.18	C6	3640	0.08
A87	7981	0.18	C7	3655	0.08
A88	7826	0.18	C8	4653	0.11
A89	7386	0.17	C9	5696	0.13
A90	6621	0.15	C10	3808	0.09
A91	4679	0.11	C11	3818	0.09
A92	4405	0.10	C12	3802	0.09
			C13	3818	0.09
			C14	3802	0.09
			C15	3821	0.09
			C16	4194	0.10

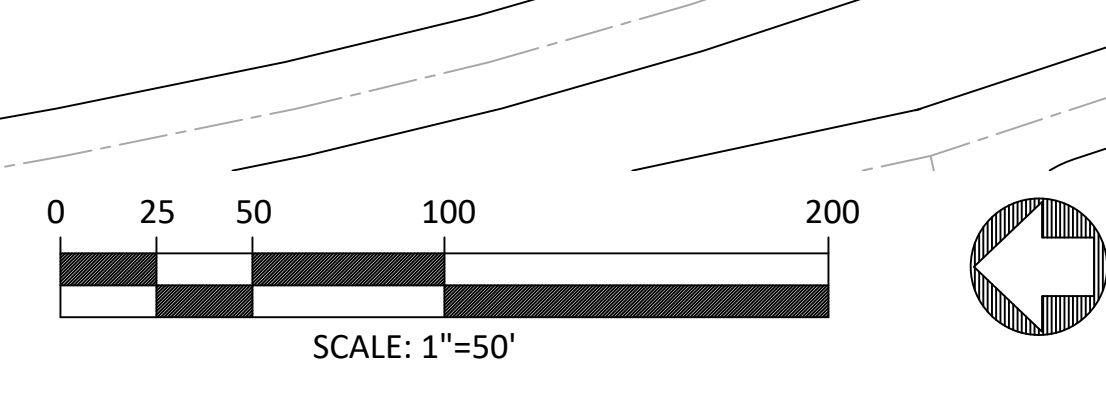
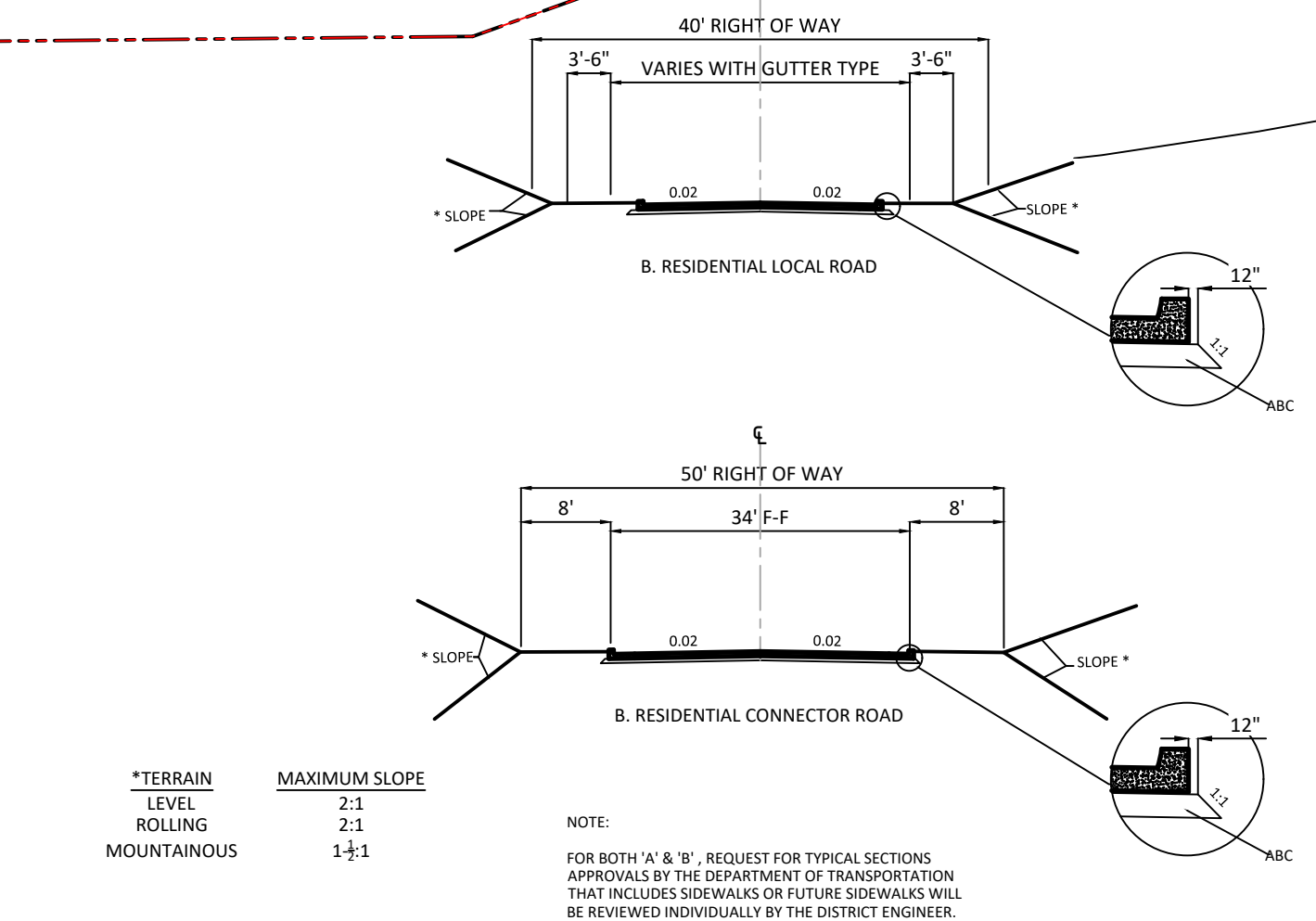
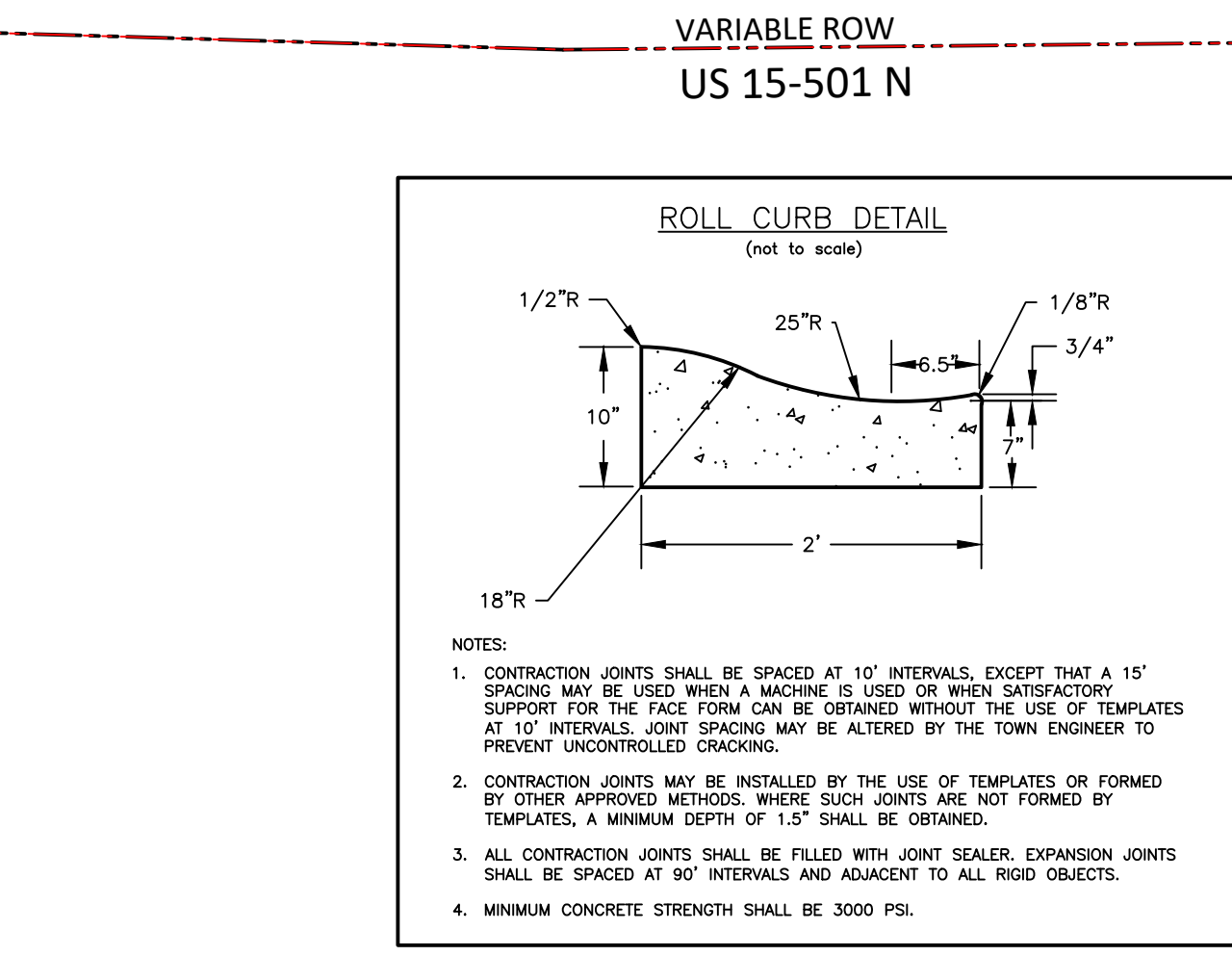
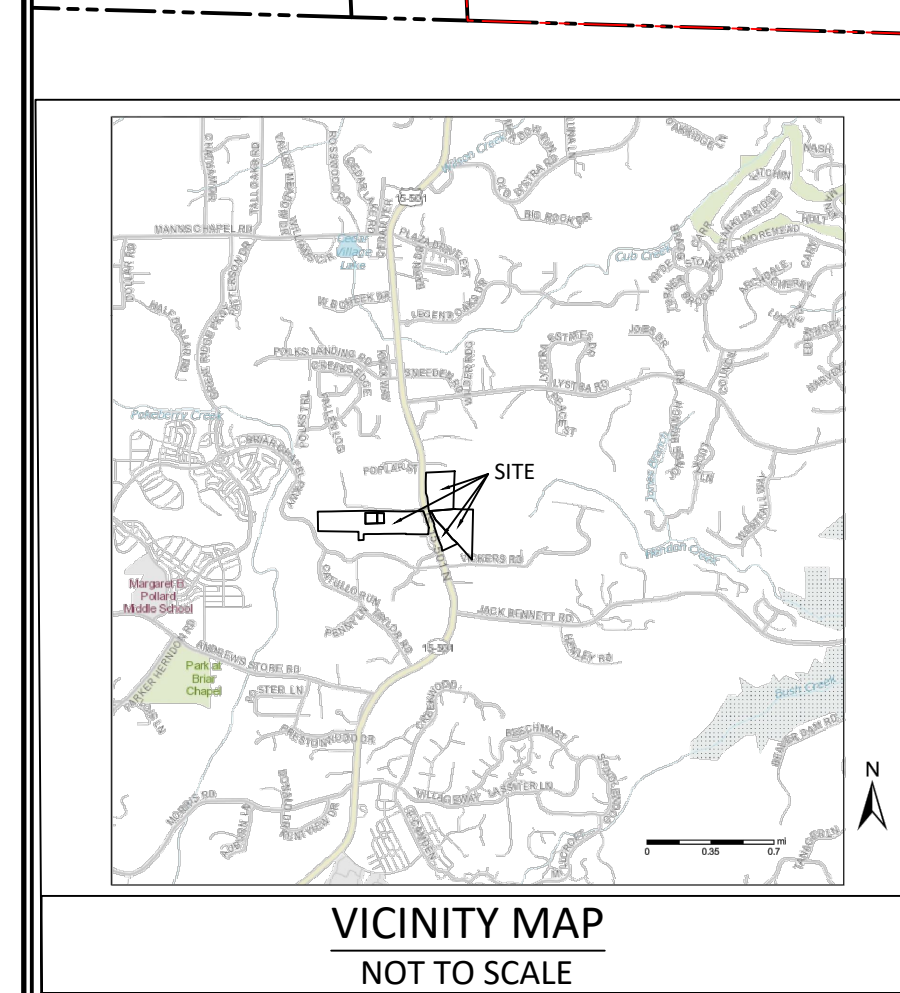

**SITE SUMMARY DATA**

PROJECT:	HERNDON FARMS
PROJECT ADDRESS:	US 15-501 N CHAPEL HILL, NC 27517
AKPAR:	18909, 18896, 18897, 2752
TOTAL SITE ACREAGE: (DEEDED)	68.36 ACRES
PUBLIC STREETS:	6,297 LF
PRIVATE STREETS:	1,435 LF
CURRENT ZONING:	R-1
WATERSHED:	WS-IV; NSW (PROTECTED)

SETBACKS:  
 FRONT 10 FEET  
 AGGREGATE FRONT/REAR 20 FEET  
 AGGREGATE SIDE YARD 10 FEET  
 CORNER SIDE 10 FEET

DEVELOPER: SAPROLITE DEVELOPMENT, LLC  
 1506 EAST FRANKLIN STREET, SUITE 300  
 CHAPEL HILL, NC 27514  
 TRAVIS BLAKE  
 (919) 260-4881

CONTACT: ARCADIA CONSULTING ENGINEERS, PLLC  
 P.O. BOX 2077  
 APEX, NC 27502  
 TRENTON D. STEWART, PE  
 (919) 363-1422  
 (919)363-1477

ARCADIA  
CONSULTING ENGINEERS

PO BOX 2077  
APEX, NC 27502  
TELEPHONE: 919 363-1422  
FACSIMILE: 919 363-1477

**HERNDON FARMS**

WILLIAMS TOWNSHIP CHATHAM COUNTY NORTH CAROLINA

DRAWN BY: KAH  
CHECKED BY: TDS  
DATE: 6/16/2021

REVISIONS

1	8/6/2021
---	----------

**SHEET TITLE**

NORTH TRACT - FIRST PLAT

**SHEET NUMBER**

B3.A

OF

1. CHATHAM COUNTY REVIEW COMMENTS