

VICKERS VILLAGE COMPACT COMMUNITY DEVELOPMENT PARCELS EXHIBIT

CHATHAM COUNTY, NC
JULY 2, 2021

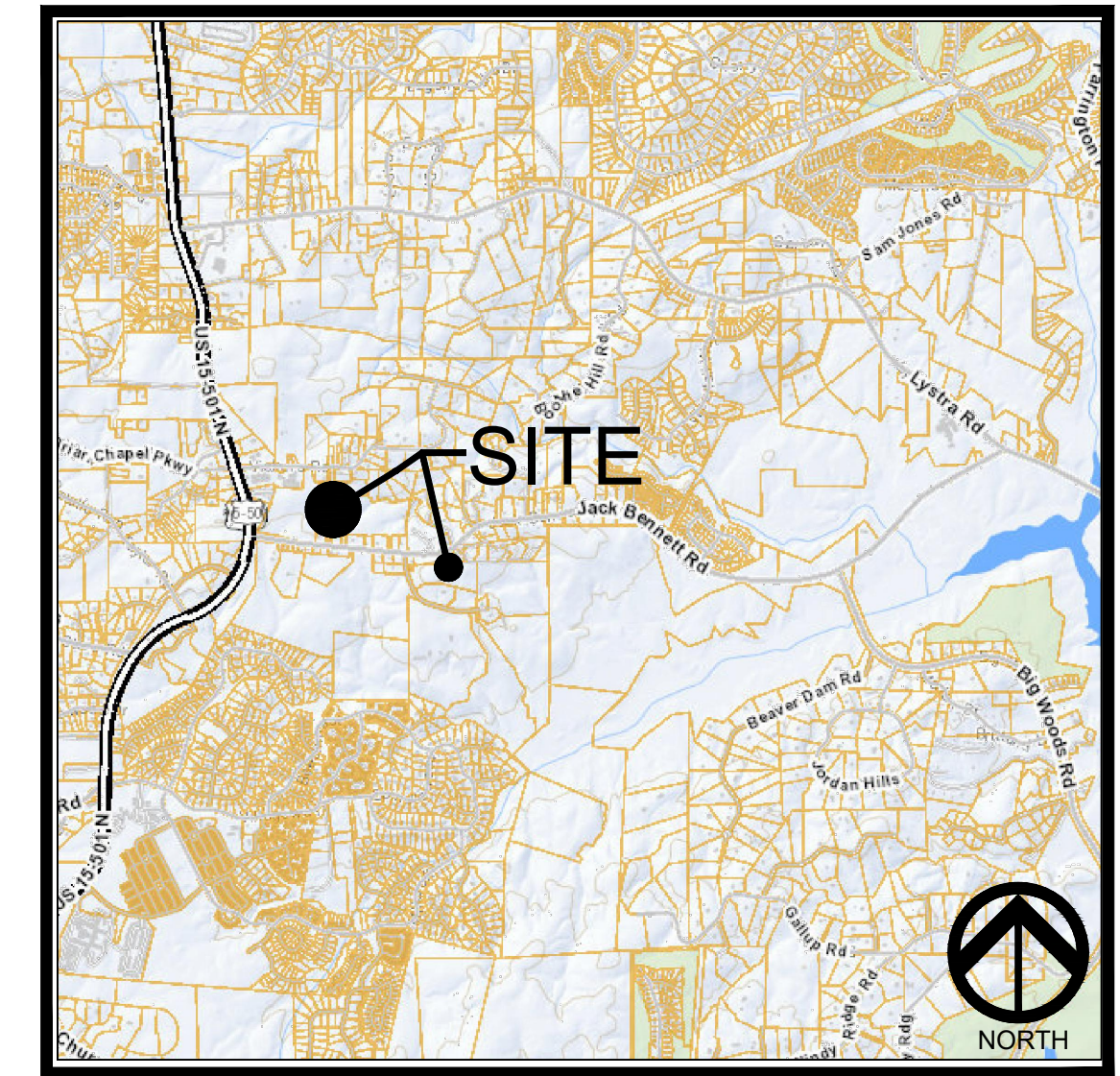

VICINITY MAP



CE GROUP

301 GLENWOOD AVE, 220
RALEIGH, NC 27603
PHONE: 919-367-8790
FAX: 919-322-0032

www.cegroupinc.com

License # C-1739

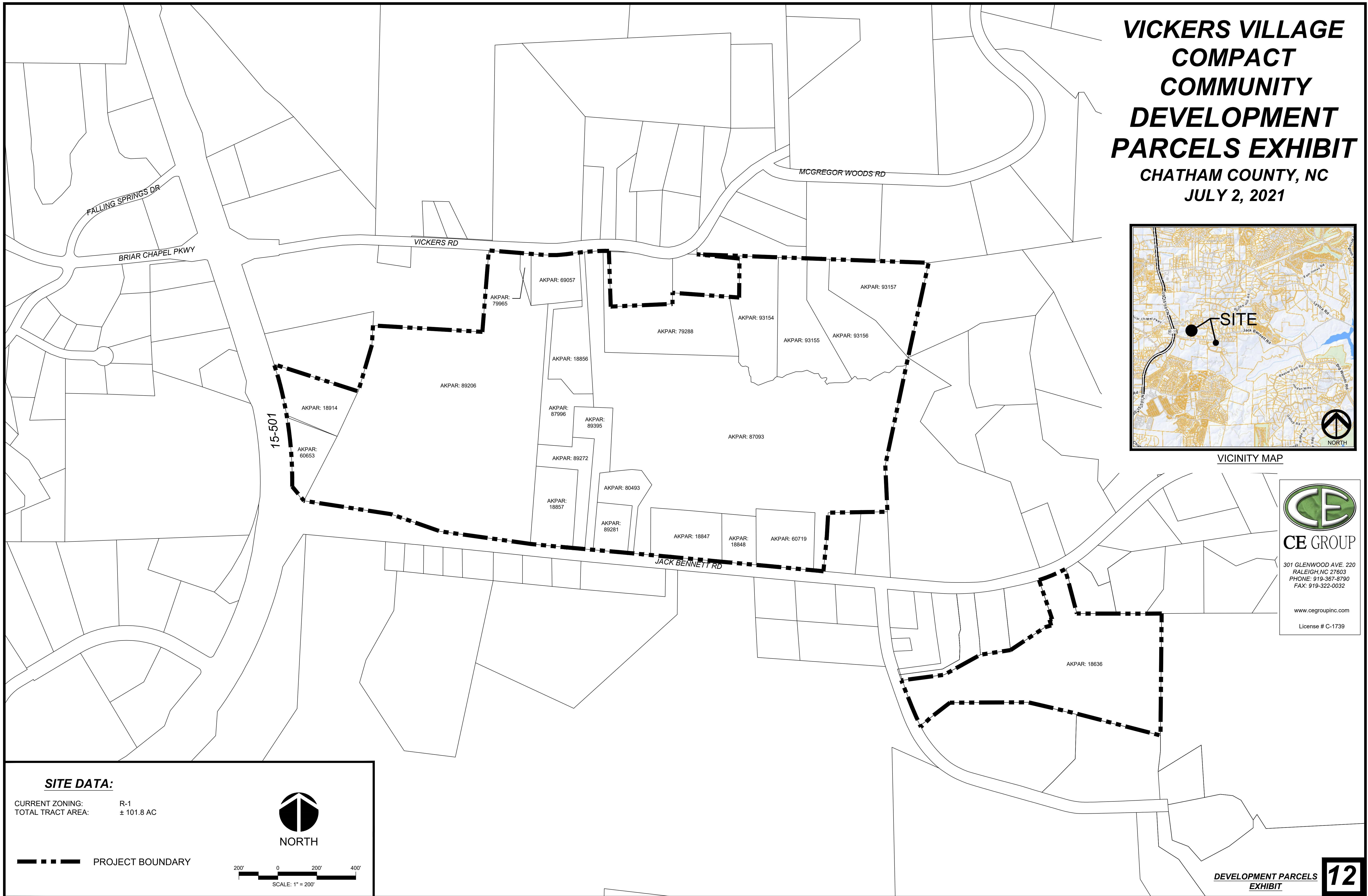

SITE DATA:

CURRENT ZONING: R-1
TOTAL TRACT AREA: ± 101.8 AC

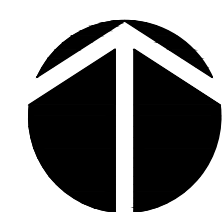

NORTH

--- PROJECT BOUNDARY

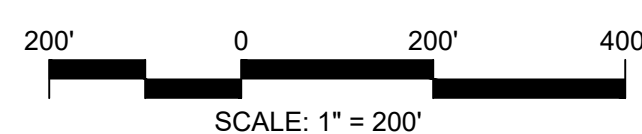

DEVELOPMENT PARCELS
EXHIBIT