

CONTRACT ROUTING FORM

1. Complete the information below BEFORE printing and completing items 2 through 7. Items in red are required.

Department: Environmental Quality

Department contract file name (use effective date): A&MConstruction_EQ_20210513

Project Code: Click here to enter text.

Contract type: Contract

Contracted Services/Goods: Paving and Site Work at Solid Waste Collection Centers

Contract Component: Master

Change Order Number/Addendum Number: Click here to enter text.

Vendor Name: A&M Construction Services, Inc.

Effective Date: 5/13/2021

Approved by: Commissioners

Commissioner Approval Date: 5/3/2021

Ending Date: 6/30/2021

Total Amount: \$165,628.10

Is this contract funded by federal dollars? Yes No

2. Department Head or his/her designee has read the contract in its entirety.

By: M. K. [Signature] (Department Head signature required)

3. County Attorney has reviewed and approved the contract

County Attorney has reviewed and rejects the contract Reason: _____

This is an automatic renewal and does not require approval from the County Attorney: Yes No



If this box is checked the County Attorney's Office has reviewed the contract but has not made needed changes to protect the County because the contract is a sole source contract and the services required by the County are not available from another vendor.

4. Technical/MIS Advisor has reviewed the contract if applicable. Yes No

5. Vendor has signed the contract. Yes No

6. A budget amendment is necessary before approval. Yes No

If budget amendment is necessary, please attach to this form.

7. Approval

Requires approval by the BOC - contracts over \$100,000.00, contracts longer than three years and leases longer than one year. Follow Board submission guidelines.

Requires approval by the Manager – contracts \$100,000 or less.

8. Submit to Clerk.

Clerk's Office Only

Finance Officer has signed the contract

The Finance Officer is not required to sign the contract

NORTH CAROLINA

AGREEMENT FOR GOODS AND/OR SERVICES

CHATHAM COUNTY

THIS AGREEMENT FOR GOODS AND/OR SERVICES (this "Agreement"), made and entered into by and between Chatham County ("County"), and A&M Construction Services, Inc. ("Contractor").

WHEREAS, Contractor has agreed to provide goods and/or services as hereinafter set forth in a professional manner in accordance with the standards of Contractor's business or industry; and

WHEREAS, the County wishes to enter into an Agreement with Contractor to provide the goods and/or services specified in Appendix 1, attached hereto and incorporated herein by reference and made an integral part of this Agreement.

NOW THEREFORE, in consideration of the premises and the mutual agreement described below, the parties agree as follows:

1. **Term of Agreement:** The term of this Agreement shall commence on May4, 2021 and end on June 30, 2021, unless terminated as hereinafter set forth. Reasonable time extension requests will be allowed if there are demonstrable delays due to adverse weather or material availability during the contract period.
2. **Scope of Service:** The Contractor shall provide to the County the goods and/or services (the "Services") set forth in the "Request for Bids: Chatham County Solid Waste & Recycling Collection Center Improvements" and associated construction drawings attached hereto as Appendix 1.
3. **Compensation:** As compensation for the Services to be provided by Contractor, the County shall pay the Contractor the sum of \$165,628.10, payable within thirty (30) days from receipt of proper invoice, or as otherwise set forth in Appendix 1.
4. **Insurance:** Contractor shall maintain insurance policies at all times with minimum limits as follows:

<u>Worker's Compensation</u>	<u>Automobile Liability</u>	<u>General /Professional Liability</u>
Statutory Limits	\$250,000 bodily injury per person \$100,000 property damage	\$100,000 bodily injury per person \$500,000 bodily injury per occurrence \$100,000 property damage

All insurance policies shall be issued by companies authorized to do business under the laws of the State of North Carolina and shall be rated not less than "A" by A.M. Best and Company. Contractor shall furnish Certificates of Insurance to the County, naming the County as an additional insured, prior to the commencement of operations. The certificates shall clearly indicate that Contractor has obtained insurance of the type, amount, and classification as required for strict compliance with this paragraph and that no material change or cancellation of the insurance shall be effective without thirty (30) days prior written notice to the County. Compliance with the foregoing requirements shall not relieve Contractor from any liability or obligations under this Agreement.

5. **Confidentiality:** All proprietary data and information, if any, furnished to Contractor by the County shall be regarded as confidential, shall remain the sole property of the County and shall be held in confidence and safekeeping by Contractor for the sole use of the County and Contractor under the terms of this Agreement. Contractor agrees that its officers, employees, and agents will not disclose to any person, firm, or entity other than the County or its designated legal counsel, accountants, or practice management consultants any confidential information about the County. Contractor agrees to carry out its obligations to the County in compliance with all privacy and security regulations required by law.
6. **Intellectual Property owned by Contractor:** This Agreement is subject to the North Carolina public records law, and may be released upon request. Not all "Trade Secrets" will qualify as protected under N.C.G.S. §132-1.2 and 66-152. Contractor should consult legal counsel before signing this document if Contractor is unsure of its intellectual property status under these statutes.

7. Status of Parties: Nothing contained in this Agreement shall be construed as establishing a partnership or joint venture relationship between Contractor and the County. Contractor and its employees and representatives are independent contractors, solely responsible for its or their performance under this Agreement and shall have no legal authority to bind the County.

8. Assignment and Subcontracting: Neither this Agreement nor any rights or obligations hereunder shall be subcontracted, assigned, or delegated by Contractor without prior written consent of the County, which consent may be withheld in the County's sole discretion.

9. Binding Effect: This Agreement shall be binding upon the parties hereto, their heirs, administrators, executors, successors and assigns, if such assignment has been approved by the County.

10. Notices: Any notice or other communication required or permitted under this Agreement shall be in writing and shall be deemed to have been given on the date delivered personally or deposited in the United States Postal Service, certified mail, return receipt requested, with adequate postage affixed, addressed as follows:

Chatham County
Attn: Dan LaMontagne, County Manager
Post Office Box 1809
Pittsboro, North Carolina 27312
919-542-8200

A&M Construction Services, Inc.
Attn: Anthony Brady
PO Box 4277
Asheboro, NC 27204
Phone: 336-498-0046
anthony@amconstructionservice.com

Either party may change its address for notices under this Agreement by giving written notice of such change to the other party in accordance with the provisions of this paragraph.

11. Governing Law: This Agreement and the rights and obligations to the parties hereunder shall be construed and governed by the laws of the State of North Carolina and venue for any proceedings arising hereunder shall be in the state court of appropriate jurisdiction located in Chatham County, North Carolina.

12. Modifications: This Agreement may be amended or modified only by the mutual written consent of the parties. A modification is not enforceable against the County unless it is signed by the County Manager, Purchasing Agent, or other duly authorized official.

13. Entire Agreement: This Agreement contains the entire agreement between the parties pertaining to the subject matter of this Agreement. With respect to that subject matter, there are no promises, agreements, conditions, inducements, warranties or understandings, written or oral, expressed or implied, between the parties, other than as set forth or referenced in this Agreement.

14. Waiver: A waiver of any provision of this Agreement must be in writing, designated as such, and signed by the party against whom enforcement of the waiver is sought. The waiver of a breach of any provision of this Agreement shall not operate or be construed as a waiver of any subsequent or other breach thereof.

15. Termination: This Agreement may be terminated as follows:

- (i) Cause: If the services provided by Contractor under this Agreement are not performed as specified herein, this Agreement may be terminated by the County for cause. Grounds for termination for cause shall include, but not be limited to, the following:
 - (a) Failure to respond to reasonable requests from the County to provide the Services covered by this Agreement.
 - (b) Failure to keep and maintain any equipment required for the performance of this Agreement in good working order and in compliance and with all laws.
 - (c) Failure to properly recycle any electronic equipment as specified in Article 9, Chapter 130A of the North Carolina General Statute, or failure to comply with any statutory requirement included in the formal bid request, as provided in the bid packet, which bid packet is incorporated herein by reference.
 - (d) Failure to maintain the insurance required by this Agreement.
 - (e) Charging rates or fees in excess of those permitted under in this Agreement.
 - (f) Inefficient, or unsafe practices in providing Services.
 - (g) The material breach of any provision of this Agreement.

- (ii) Convenience: The County reserves the right to terminate this Agreement upon thirty (30) days prior written notice to Contractor for any reason deemed by the County to serve the public interest. This termination for convenience will not be made when termination is authorized under any other provision of this Agreement. In the event of such termination the County shall pay the Contractor its costs directly attributable to those Services received by the County prior to termination that meet the requirements of this Agreement. Provided, however, that no costs will be paid to the Contractor which are recoverable in the Contractor's normal course of doing business. The County is not liable for the loss of any profits anticipated to be made hereunder, nor for any special, consequential or similar damage.

16. Annual Appropriations and Funding: This Agreement is subject to the annual appropriation of funds by the Chatham County Board of Commissioners. Notwithstanding any provision herein to the contrary, in the event that funds are not appropriated for this Agreement, the County shall be entitled to immediately terminate this Agreement, without penalty or liability, except the payment for all Service satisfactorily provided under this Agreement up to and through the Contractor's receipt of notice of termination.

17. Indemnity: Contractor agrees to indemnify and hold harmless the County, its officers, agents, servants, and employees from any and all claims, actions, lawsuits, losses, damages, expenses, judgments, or liabilities of any kind whatsoever (including without limitation, cost of defense and attorney fees) suffered by the County and proximately caused by an act or omission of Contractor, its subcontractors, agents, or employees.

18. County Policy: The County opposes discrimination on the basis of race and sex and requires all of its contractors to provide a fair opportunity for minorities and women to participate in their work force and as subcontractors and vendors under County contracts.

19. State and Federal Requirements; County Terms and Conditions: By signing this Agreement, Contractor certifies that (if applicable) Contractor, and any of Contractor's subcontractors are in compliance with State and Federal laws, including any divestment list by the NC State Treasurer, and Federal or State debarment or suspension lists. The County Terms and Conditions are incorporated herein and made an integral part of this Agreement and may be found at the County's web site: <http://www.chathamnc.org/finance>. A hard copy of the Terms and Conditions is available upon request.

20. Controlling Document: In the event of any conflict between this Agreement and any document, instrument, or other agreement prepared or provided by Contractor (including, without limitation, Contractor's purchase orders, invoices and warranties), the terms of this Agreement shall control.

IN WITNESS WHEREOF, the parties have executed this Agreement in their official capacities with legal authority to do so.

Chatham County

By: 
Dan LaMontagne, County Manager

Contractor

By: 
Name: Anthony Brady
Title: Project Manager/Vice President

This instrument has been pre-audited in the manner required by the Local Government Budget and Fiscal Control Act.

Hope Tally, Finance Director

APPENDIX 1

Scope of Work: See attached documentation for the work to be done at the following sites and alternates.

Hadley
Crutchfield Crossroads
Asbury
Siler City

Alternate 1: Hadley driveway 95 sy full depth repair
Alternate 2: Crutchfield Crossroads - driveway 60 sy full depth repair
Alternate 3: Crutchfield Crossroads - overlay driveway

Request for Bids
Chatham County Solid Waste & Recycling Collection Center Improvements

Purpose

The Chatham County Solid Waste & Recycling Division is requesting bids from qualified, licensed contractors to perform site improvements at four (4) collection centers. The work will include installing concrete pads, asphalt pavement resurfacing and repair, and miscellaneous site work. All trade permits shall be obtained by the Contractor if needed.

Scope of Work

The County is seeking the services of a qualified, licensed contractor to provide site improvements at the properties listed below:

Name	Street Address
Asbury	34 Mt. View Church Rd., Moncure, NC
Crutchfield Crossroads	4030 Silk Hope-Liberty Rd, Snow Camp, NC
Hadley	65 East Perry Rd, Pittsboro, NC
Siler City	135 Silk Hope Rd, Siler City, NC

A full Scope of Work is provided in Attachment B and construction drawings are provided in Attachment C. The County will select one firm to perform the work.

The County is asking for lump sum pricing to be submitted with the bid. All work shall commence within the schedule and timeframe agreed upon by both parties and will be established at scope review and time of award. It is expected that all work shall be completed within 45 days after Notice to Proceed.

Bid Instructions

- A. **Bids Deadline:** Must be received by Chatham County no later than **Thursday, April 22, 2021, at 2:00 PM EST**. A public bid open will take place promptly at 2:00 PM EST at the Chatham County Agriculture and Conference Center, 1192 US HWY 64 Business West, Pittsboro, NC 27312.

- B. **Submission of Bids:** Vendors must submit **one hard copy** with all attachments, including signatory pages, which must be received by the deadline above. Each sealed envelope containing a BID must be plainly marked on the outside as **BID for SW&R Improvements** and the envelope should bear on the outside the BIDDER'S name, address, and the name of the project for which the BID is submitted. If forwarded by mail, the sealed envelope containing the BID must be enclosed in another envelope addressed to one of the following delivery addresses:
 - Postal Address: Kevin Lindley, Chatham County Solid Waste and Recycling
P. O. Box 1550, Pittsboro, NC 27312 (all postal delivery)
 - Street Address: Kevin Lindley, Chatham County Solid Waste and Recycling

28 County Services Rd, Pittsboro, NC 27312 (land delivery only)

- C. **Withdrawal of Bids:** Proposing vendors may withdraw their bids any time before the deadline for submission on **Thursday, April 22, 2021, at 2:00 PM EST**, but the withdrawal must be submitted in writing and signed by the proposing vendor.
- D. **Inquiries and Corrections:** All inquiries relating to this request should be in writing and addressed to:

Kimberly Johnson, Chatham County Finance Office
P.O. Box 608, Pittsboro, NC 27312

They also may be faxed to 919-542-8272 or emailed to: purchasing@chathamcountync.gov

If a proposing vendor finds discrepancies in or omissions from the specifications or should require additional clarification of any part, a written request for interpretation shall be submitted to the County's purchasing agent listed above. Any interpretation of or changes made to the RFB will be made by written addendum to each proposing consultant and shall become part of the request for any contract awarded. The County will not be responsible for the accuracy of any other oral explanations, interpretations, or representations. All inquiries must be submitted by **12:00 PM EST on Thursday, April 15, 2021**. It shall be the responsibility of each proposing organization or individual to verify that every addendum has been received prior to submitting bids.

- E. **Vendor Certification:** The submission of bids shall be deemed a representation and certification that the proposing vendor:
- Has carefully read and fully understands the information provided by Chatham County in this RFB;
 - Is financially solvent and has the capability to successfully undertake and complete the responsibilities and obligations of the bids submitted;
 - Represents that all of the information contained in the submitted bids is true and correct;
 - Did not in any way collude or conspire with any other parties, directly or indirectly, in regard to the amount, terms or conditions of this bid;
 - Acknowledges that Chatham County has the right to make any inquiry it deems appropriate to substantiate or supplement information provided by proposing vendors and hereby grants Chatham County permission to make these inquiries; and
 - Acknowledges that bids cannot be modified after submission for any reason.
- F. **Format & Deadline of Bids:** Late bids will not be accepted under any circumstance and will not be opened or reviewed. We will not accept bids by fax or any method other than is outlined under item B of Bids Instructions. The sender must allow ample delivery time for the selected shipment or transmission methods.
- G. **Bid Bond:** The County formal limit of \$300,000 requires the 5% Bid Bond, which must be included with the bid submittal for any bid in the formal range only.

H. **Definition and Context:** Unless otherwise specified in this document, all words shall have a common meaning unless the context in which they are used clearly requires a different meaning. Words in the singular number include the plural, and in the plural include the singular.

RFB Schedule

- The deadline for submitting questions in writing (mail, email, or fax) is **12:00 PM EST on Thursday, April 15, 2021.**
- The deadline for receipt of bids by the county is: **2:00 PM EST on Thursday, April 22, 2021.**

Insurance and Legal Requirements

Chatham County requires selected contractors and any subcontractors to obtain and maintain at their own expense, all insurance required by state and federal law. If requested, the selected organization agrees to provide Chatham County with evidence of required policies, certificates, and/or endorsements upon the award of the contract. As a minimum, contractors and subcontractors are required to have the following coverages related to any contract work for Chatham County:

- Workers compensation as required by the State of North Carolina.
- Professional liability, including errors and omissions, malpractice (if applicable) and negligent performance—at least \$1 million for all damages.
- Comprehensive general liability, including personal injury, broad form property damage blanket contractual and fire legal liability--\$1 million combined limit for bodily injury and property damage.

The County shall be named as an additional insured on both the professional liability and comprehensive general liability coverage. Contractor shall furnish copies of all such policies and all renewals, terminations, and alterations to the County on a current basis.

Bid Bond or Bid Deposit

Any bid which meets the Chatham County Formal Range of \$300,000 or more, must be accompanied by a Bid Bond at the time of submission, executed by a corporate surety licensed under the laws of North Carolina to execute such bonds, conditioned that the surety will, upon demand forthwith make payment to the Owner if the bidder fails to execute the Contract. The Bid Bond shall be in the amount of five (5%) percent of the total bid plus all the alternates. The Bid Bond shall be valid for a minimum of sixty (60) calendar days. In lieu of a Bid Bond, a deposit equal to five (5%) percent of the total bid plus all of the alternates in the form of a Cashier's Check or Certified Check on some bank or trust company insured by the Federal Deposit Insurance Corporation and payable to County of Chatham. The purpose of the Bid Deposit or Bid Bond is to ensure that the bidder will enter into a Contract with the Owner with the terms stipulated in the Bid Proposal and the bidder guarantees that a Performance, Labor & Material Bond will be executed, which is required for bids in the Chatham County Formal Range. If the Contractor fails to execute a Contract, the Bid Bond or Bid Deposit shall be seized.

E-Verify

Effective September 4, 2013 North Carolina local government units are prohibited from entering into certain contracts unless the contractor and the contractor's subcontractors, if any, comply with the

requirements of N.C. Gen. Stats. §64-26(a). Prior to providing any services hereunder, Contractor and Contractor's subcontractors, if any, are subject to the provisions of N.C. Gen. Stats. §64-26(a). Contractor agrees to fully comply with such statute and require Contractor's subcontractors, if any, to fully comply with such statute.

Iran Divestment Act

Effective October 1, 2015 North Carolina local government units are prohibited from entering into certain contracts unless the contractor and the contractor's subcontractors, if any, comply with the requirements of §143C-6A-5. Contractor agrees to fully comply with such statute and require Contractors subcontractors, if any, to fully comply with such statute.

Requirement To Recycle Certain Electronic Equipment

If applicable, Contractor's failure to properly recycle any electronic equipment as specified in Article 9, Chapter 130A of the North Carolina General Statute or failure to comply with any statutory requirement within the formal bid request, as provided in the bid packet, incorporated herein by reference, shall be grounds for immediate termination of this Agreement.

Divestment from Companies That Boycott Israel

Contractor certifies that (a) it is not identified on the Israel Boycott List or any other list created by the NC State Treasurer pursuant to NC G.S. 147-86.80 et al, and (b) it will not take any action causing it to appear on any such list during the term of the Contract Agreement.

County Conditions

- All proposing firms or individuals shall comply with all conditions, requirements, and specifications contained herein, with any departure constituting sufficient cause for rejection of the bids. However, Chatham County reserves the right to change the conditions, requirements, and specifications as it deems necessary.
- The bids must be signed by a duly authorized official of the proposing organization or individual submitting the bids.
- No bids will be accepted from any person or organization that is in arrears for any obligation to Chatham County, or that otherwise may be deemed irresponsible or unresponsive by county staff, the Chatham County Board of Commissioners, or the Chatham County Economic Development Corporation.
- Chatham County is not obligated to enter into any contract as a result of the RFB.
- All prices quoted must be firm for a period of 90 (ninety) days following the bid deadline.
- Chatham County reserves the right to reject any and all bids or any part thereof and to select the most responsive bid that is deemed in the best interest of Chatham County.
- Chatham County may approve or disapprove the use of specific proposed subcontractors in any bids.

- Chatham County reserves the right to enter into an agreement with another proposing vendor in the event that the originally selected vendor fails to execute a contract with the County or defaults on their contract.
- All bids shall be prepared in a comprehensive manner as to content, but we do not require specific types of binders or promotional material for submissions. Promotional material will not be considered part of the bids and will not affect the evaluation of bids.
- Chatham County reserves the right to negotiate with any, none, or all of the proposing vendors.
- All costs, including travel and expenses, incurred in the preparation of this bids will be borne solely by the proposing company.
- The County will not return bids materials to those submitting bids.
- No agreements with any selected vendor shall be binding until a contract is approved, signed, and executed by the authorized County Official and authorized representatives of the vendor.
- Chatham County will follow all applicable local, state, and federal procurement requirements when expending federal funds and require all contractors to comply in full.
- Details of all terms and conditions for purchase orders and contracts can be found at <https://www.chathamnc.org/government/departments-programs/county-manager-finance-office/finance/purchasing>.

Chatham County is an Equal Opportunity Employer and does not discriminate on the basis of sex, marital status, race, color, creed, national origin, sexual orientation, gender identity, age or disability.



Attachment A:

Vendor Information & Signature Form

Name of Vendor:	
Contractor License #	
Contact Person(s)	
Street Address with City, State & Zip Code	
Mailing Address (if different than above)	
Phone #	
Fax #	
Email	
Proposer will do the work as:	<input type="checkbox"/> Individual <input type="checkbox"/> Joint Venture <input type="checkbox"/> Partnership <input type="checkbox"/> Corporation
Date & state of incorporation	Date State
Name of partnership or joint venture	

By signing below, the submission of qualifications shall be deemed a representation and certification by the Proposing Consultant that it has investigated all aspects of the RFB, and it has read and understands the RFB.

Bidder Signature:	
Date Signed:	
Title of Signatory:	

Attachment B:

Scope of Work and Pricing

Scope of Work:

The Scope of Work expected at each location is provided below and detailed in the drawings provided in Attachment C.

Hadley:

- Install one 10'x37' concrete pad as shown on drawing. The pad should have a base layer of ABC type stone at least 8" thick compacted. The concrete shall be 8" thick, 5000 psi with #5 rebar at 12" on center. Pad shall be formed and poured so that it matches grade of the new asphalt overlay.
- Repair the crack in the corner of the concrete ramp in front of both the oil shed and the swap shop. Clean the crack and fill with a flexible sealant designed for use on concrete. Use backer rod as necessary to pre-fill crack before installing sealant.
- Perform full-depth pavement repair at locations indicated to repair dips, breaks or holes in the existing pavement. The existing pavement specification was 8" compacted ABC base with 2" I-2 pavement. Saw-cut and remove asphalt from full depth repair areas and prepare base layer of ABC to ensure at least 8" of compacted stone. Install 2" I-2 or equivalent on prepared base layer. Full depth repair shall match grade with existing pavement.
- Mill existing pavement at edges of all new and existing concrete pads and pavement to allow proper tie-in of new asphalt.
- Apply tar and gravel layer over entire asphalt area to limits shown prior to overlay.
- Overlay entire asphalt area to limits shown with 1.5" 9.5B overlay. Any full-depth repairs done outside of overlay limits will not be overlaid.
- In the central island near the waste compactor, remove soil, fines and existing gravel to allow for installation of 4" of #57 stone over filter fabric. Finish grade of stone shall match the grade of the overlay pavement.
- In areas shown on the drawing in the central island, remove existing material to allow installation of 4" of white marble stone over a geotextile layer, Mirafi 140N, or equivalent. Finish grade of stone shall match the grade of the overlay pavement.
- Install eight (8) Blue Junipers, one gallon size, around the perimeter of the white marble stone area. The geotextile should be cut where the plants are installed them to be planted in the soil.
- Install metal edging around the perimeter of the central island, between the pavement and newly installed stone. Install a metal divider between the #57 stone and white marble stone.
- Grade soil at the edge of pavement to facilitate drainage off-site, as needed. Seed and straw any disturbed areas.
- Maintain control of erosion and sediment to prevent sediment from leaving site.
- Remove from site and properly dispose of milled or removed asphalt, concrete, aggregate, soil or other construction generated debris.

Crutchfield Crossroads:

- Install one 10'x37' concrete pad as shown on drawing. The pad should have a base layer of ABC at least 8" thick compacted. The concrete shall be 8" thick, 5000 psi with #5 rebar at 12" on center. Pad shall be formed and poured so that it matches grade of the new asphalt overlay.
- Remove and dispose of existing concrete ramps and wooden railing in front of the oil shed. Cut existing asphalt to install a concrete access ramp leading up to each shed, approximately 8" high (to match grade with the shed slab), 10' long and 14' wide. The concrete ramp shall be reinforced and a minimum of 4" thick and 4,000 psi. The ramp shall be formed and poured so the low end matches the grade of the asphalt overlay. There is a ramp installed already at the swap shop shed and at both sheds at the Hadley collection center if the contractor would like to see an example. New ramps must be ADA compliant and will require a building permit. There will be no cost for the permit since it is for a County facility, but the contractor will be responsible for obtaining the permit and scheduling inspections. It is not expected that a railing will be necessary, since they were not required for the previous ramps.
- Repair the crack in the corner of the concrete ramp in front of the swap shop. Clean the crack and fill with a flexible sealant designed for use on concrete. Use backer rod as necessary to pre-fill crack before installing sealant.
- Perform full-depth pavement repair at locations indicated to repair dips, breaks or holes in the existing pavement. The existing pavement specification was 8" compacted ABC base with 2" I-2 pavement. Saw-cut and remove asphalt from full depth repair areas and prepare base layer of ABC to ensure at least 8" of compacted stone. Install 2" I-2 or equivalent on prepared base layer. Full depth repair shall match grade with existing pavement.
- Mill existing pavement at edges of all new and existing concrete pads and pavement to allow proper tie-in of new asphalt.
- Apply tar and gravel layer over entire asphalt area to limits shown prior to overlay.
- Overlay entire asphalt area to limits shown with 1.5" 9.5B overlay. Any full-depth repairs done outside of overlay limits will not be overlaid.
- In the central island near the waste compactor, remove soil, fines and existing gravel to allow for installation of 4" of #57 stone over filter fabric. Finish grade of stone shall match the grade of the overlay pavement.
- In areas shown on the drawing in the central island, remove existing material to allow installation of 4" of white marble stone over a geotextile layer, Mirafi 140N, or equivalent. Finish grade of stone shall match the grade of the overlay pavement.
- Install eight (8) Blue Junipers, one gallon size, around the perimeter of the white marble stone area. The geotextile should be cut where the plants are installed them to be planted in the soil.
- Install metal edging around the perimeter of the central island, between the pavement and newly installed stone. Install a metal divider between the #57 stone and white marble stone.
- Grade soil at the edge of pavement to facilitate drainage off-site, as needed. Seed and straw any disturbed areas.
- Maintain control of erosion and sediment to prevent sediment from leaving site.
- Remove from site and properly dispose of milled or removed asphalt, concrete, aggregate, soil or other construction generated debris.

Asbury

- Install one 10'x37' concrete pad as shown on drawing. The pad should have a base layer of ABC at least 8" thick compacted. The concrete shall be 8" thick, 5000 psi with #5 rebar at 12" on center. Pad shall be formed and poured so that it matches grade of the existing asphalt.
- Remove and dispose of existing concrete ramps and wooden railing in front of the oil shed and swap shop. Cut existing asphalt to install a concrete access ramp leading up to each shed, approximately 8" high (to match grade with the shed slab), 10' long and 14' wide. The concrete ramp shall be reinforced and a minimum of 4" thick and 4,000 psi. The ramp shall be formed and poured so the low end matches the grade of the existing asphalt. New ramps must be ADA compliant and will require a building permit. There will be no cost for the permit since it is for a County facility, but the contractor will be responsible for obtaining the permit and scheduling inspections. It is not expected that a railing will be necessary, since they were not required for the previous ramps.

Siler City

- Remove and replace existing concrete trough and drain grate located at the junction between the compactor and its receiving bin. Saw cut existing concrete around the existing drain trough at the existing expansion joint on the compactor side and approximately 12" on the bin side. Care must be taken when cutting the concrete close to the existing compactor's base to maintain the integrity of the concrete into which the base retaining bolts are attached.
- The frame and grate shall be East Jordan Iron Works V-7361 heavy duty trench grate and frame, or approved equal.
- Install #5 rebar dowels at 12" on center to tie the new concrete to the existing slabs. Extend dowels at least 4" into existing slab and secure with concrete epoxy. Dowels shall be installed to tie into the middle of the depth of the newly poured slab. Where the new slab meets the old slab, use expansion joint material and concrete epoxy to seal the joint. Areas of the existing slab on the compactor slab that are damaged should be cleaned and sealed with concrete epoxy to prevent water intrusion and further surface layer spalling.
- Pour new 6" concrete slab with 6x6-W2.9xW2.9 welded wire fabric reinforcement placed 3" from the bottom of slab. Concrete shall be 5000 psi. There shall be 10" compacted ABC under the 6" concrete slab. Verify in the field that the existing ABC layer is of specified depth.
- The 6" drain trough shall be formed into the newly poured concrete. The frame for the heavy duty grate shall be set into the edges of the newly formed trough.
- Verify the integrity of the existing Schedule 40 4" PVC trough drain pipe after the existing drain trough concrete has been removed. Repair any damage to the drain pipe prior to pouring the new concrete. Replace the existing drain cap with a new drain cap suitable for corrosive environments. The drain cap shall be set so the top of the cap is flush with the bottom of the newly poured concrete trough.
- Perform full depth repair to the pavement indicated on the drawing at the entrance to the center. Use pavement specifications listed above for Crutchfield Crossroads and Hadley collection centers. Final grade of repair shall match the existing grade of surrounding asphalt.

General Notes:

1. Three of these sites are closed on Wednesday. Siler City collection center is open seven days per week. It is expected that work which requires the center to be closed, such as overlay paving, will be scheduled on Wednesdays. Other work will have to be staged so it can safely take place while the center is open. The Siler City site will be closed for the drain repair and driveway paving to be done safely. The center can only be closed on a Tuesday, Wednesday or Thursday and the closing must be scheduled well in advance to allow for notice to the public.
2. Contractor is responsible for ensuring the new asphalt and other site work does not interfere with site drainage. New work shall not create ponding of water on site.
3. Square yard estimates of the full depth repairs have been provided by the County and will be used as the basis for the bid. The actual amount of full depth repair will be field determined and mutually agreed upon by the contractor and the County before the work is completed. The final contract amount will be adjusted by using the square yard price for full depth repair provided in the bid.
4. Removed asphalt and other inert construction debris may be brought to the Chatham County Solid Waste main facility located at 28 County Services Rd, Pittsboro, NC. There will be no charge to the contractor for inert debris brought to the Chatham County Solid Waste main facility. All other construction debris must be disposed of at an approved construction and demolition (C&D) facility. Disposal costs are the responsibility of the contractor.
5. The County will negotiate final Scope of Work with the selected contractor.
6. Documentation of the specifications for the concrete and asphalt used will be a required part of the closeout documents.
7. There shall be a one-year replacement warranty on the living plants. This will begin on the date of substantial completion.
8. All work performed shall have a one-year warranty for labor and materials that begins on the date of substantial completion.
9. Contractor shall notify Chatham County 24 hours in advance of checking the condition of the existing aggregate base so the County can determine whether additional base course is needed.

Pricing:

Contractor shall provide Lump Sum prices for each Center to complete the Scope of Work provided above and detailed on the Drawings.

Hadley:	\$_____
Crutchfield Crossroads:	\$_____
Asbury:	\$_____
Siler City:	\$_____
TOTAL ALL 4 CENTERS	\$_____

Provide the cost for providing and installing one ton of ABC stone	\$_____ /ton
Provide the unit cost for full depth pavement repair	\$_____ /sy
Add Alternate 1: Hadley driveway 95 sy full depth repair	\$_____
Add Alternate 2: Crutchfield Crossroads - driveway 60 sy full depth repair	\$_____
Add Alternate 3: Crutchfield Crossroads - overlay driveway	\$_____

Drawings

The site detail drawings are attached to the Bids and Opportunity Page as a separate file within the Announcement for this project.

<http://www.chathamcountync.gov/government/current-bid-proposal-opportunities>

ATTACHMENT C

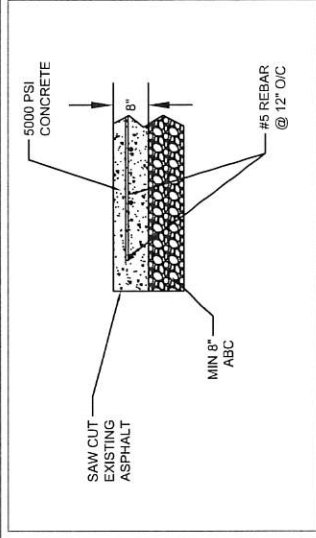
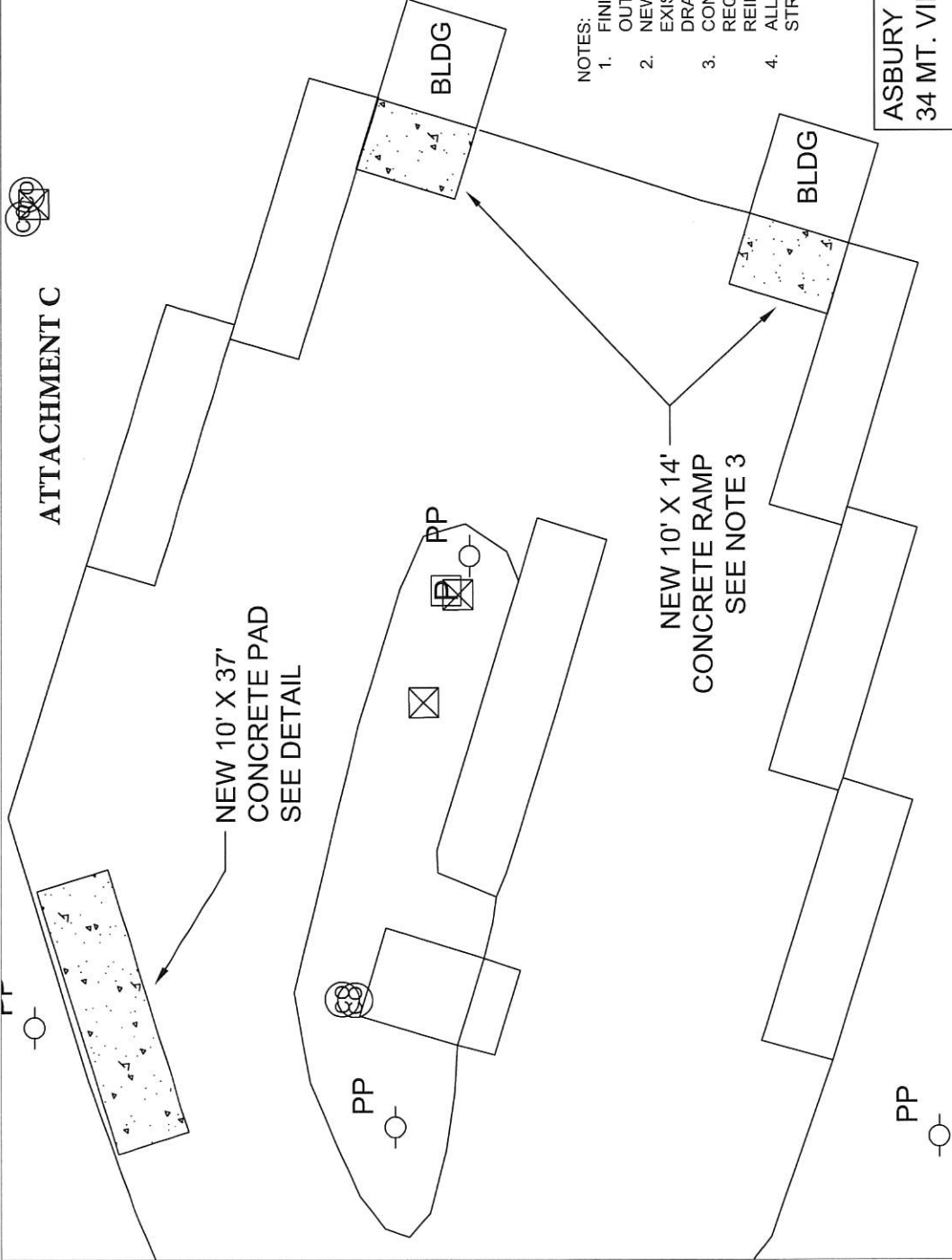

NEW CONCRETE PAD SECTION
NTS

- NOTES:
1. FINISHED ELEVATIONS SHALL PROVIDE POSITIVE DRAINAGE TO OUTSIDE EDGE OF PAVEMENT.
 2. NEW CONCRETE PAD AND RAMPS SHALL BE POURED TO MATCH EXISTING GRADE AND SHALL NOT INTERFERE WITH SITE DRAINAGE OR POND WATER.
 3. CONCRETE RAMP AT SHED SHALL BE ADA COMPLIANT AND WILL REQUIRE A BUILDING PERMIT. CONCRETE SHALL BE REINFORCED AND A MINIMUM OF 4" THICK AND 4000 PSI.
 4. ALL DISTURBED GRASSY AREAS WILL BE SEEDED AND STRAWED WITH AN APPROPRIATE SEED MIX FOR THE SEASON.

ASBURY COLLECTION CENTER
34 MT. VIEW CHURCH RD, MONCURE, NC
CHATHAM COUNTY SOLID WASTE & RECYCLING
28 COUNTY SERVICES RD, PITTSBORO, NC 27312
 DATE: 3/10/2021 DRAWN BY: RKL

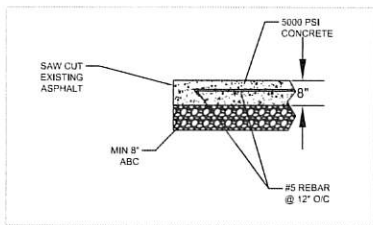

NEW CONCRETE PAD SECTION
NTS

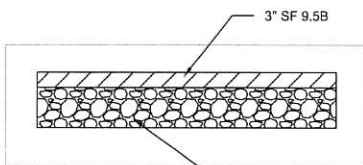

NEW AND FULL DEPTH REPAIR PAVEMENT SECTION
NTS

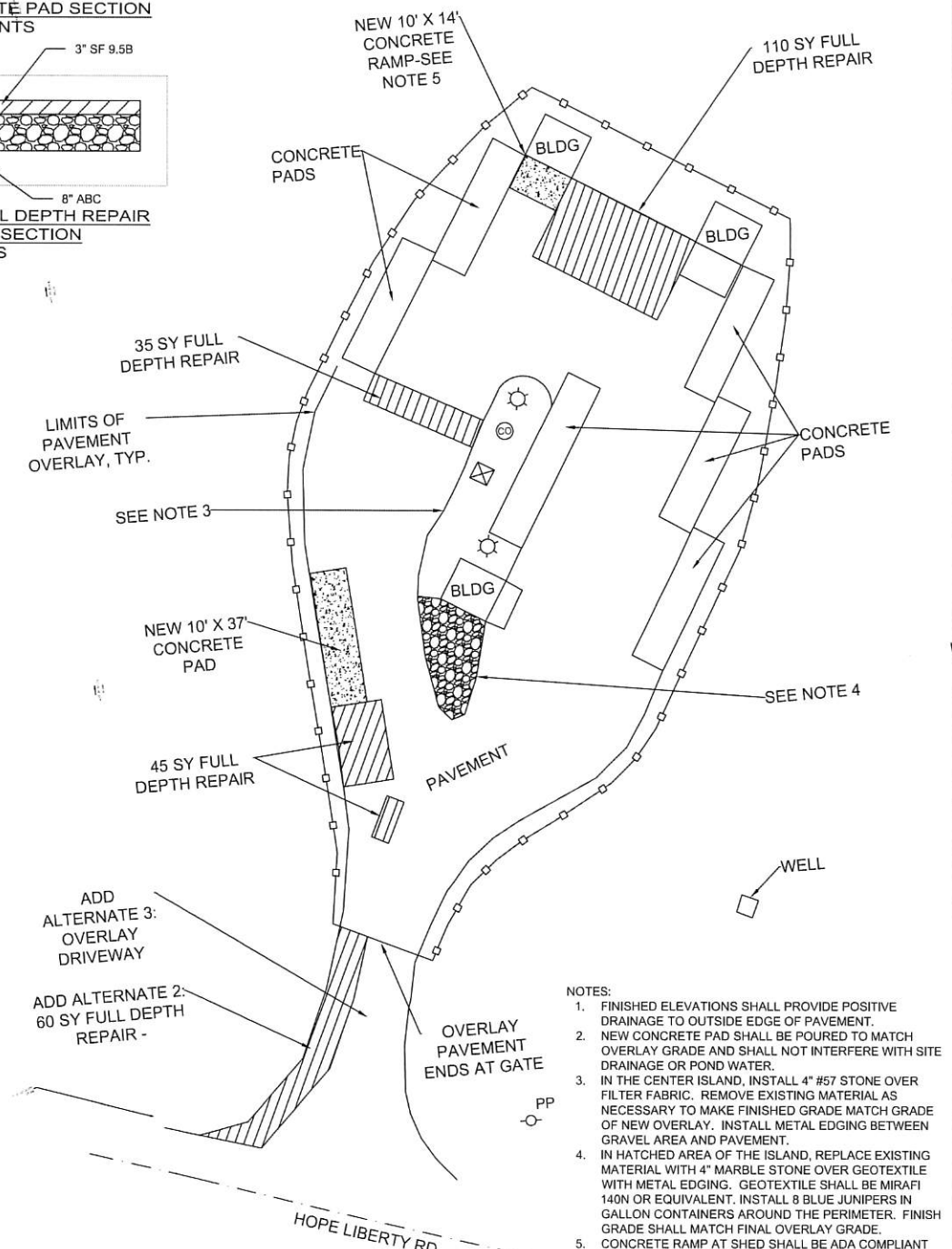

- NOTES:**
1. FINISHED ELEVATIONS SHALL PROVIDE POSITIVE DRAINAGE TO OUTSIDE EDGE OF PAVEMENT.
 2. NEW CONCRETE PAD SHALL BE POURED TO MATCH OVERLAY GRADE AND SHALL NOT INTERFERE WITH SITE DRAINAGE OR POND WATER.
 3. IN THE CENTER ISLAND, INSTALL 4" #57 STONE OVER FILTER FABRIC. REMOVE EXISTING MATERIAL AS NECESSARY TO MAKE FINISHED GRADE MATCH GRADE OF NEW OVERLAY. INSTALL METAL EDGING BETWEEN GRAVEL AREA AND PAVEMENT.
 4. IN HATCHED AREA OF THE ISLAND, REPLACE EXISTING MATERIAL WITH 4" MARBLE STONE OVER GEOTEXTILE WITH METAL EDGING. GEOTEXTILE SHALL BE MIRAFI 140N OR EQUIVALENT. INSTALL 8 BLUE JUNIPERS IN GALLON CONTAINERS AROUND THE PERIMETER. FINISH GRADE SHALL MATCH FINAL OVERLAY GRADE.
 5. CONCRETE RAMP AT SHED SHALL BE ADA COMPLIANT AND WILL REQUIRE A BUILDING PERMIT. CONCRETE SHALL BE REINFORCED AND A MINIMUM OF 4" THICK AND 4000 PSI.
 6. ALL DISTURBED GRASSY AREAS WILL BE SEEDED AND STRAWED WITH AN APPROPRIATE SEED MIX FOR THE SEASON.

LEGEND	
PP	POWER POLE
⊙	LIGHT POLE
⊠	CONCRETE SEPTIC LID
⊙	CLEANOUT
●	IRON PIPE (IPF) / NAILSET/IRON PIPE (NSIPF)
—○—○—	FENCE
—	ROAD CENTERLINE
—	STORM DRAIN
NP	NAIL FOUND
NS	NAIL SET
IPF	IRON PIPE FOUND
IRF	IRON ROD FOUND

CRUTCHFIELD CROSSROADS COLLECTION CENTER
4030 SILK HOPE-LIBERTY RD, SNOW CAMP, NC

CHATHAM COUNTY SOLID WASTE AND RECYCLING
28 COUNTY SERVICES RD, PITTSBORO, NC 27312

DATE: 3/2/2020 DRAWN BY: RKL

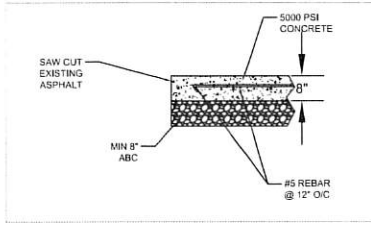

NEW CONCRETE PAD SECTION
NTS

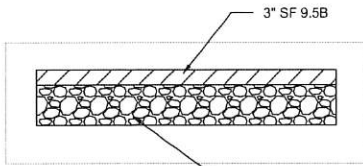

NEW AND FULL DEPTH REPAIR
PAVEMENT SECTION
NTS

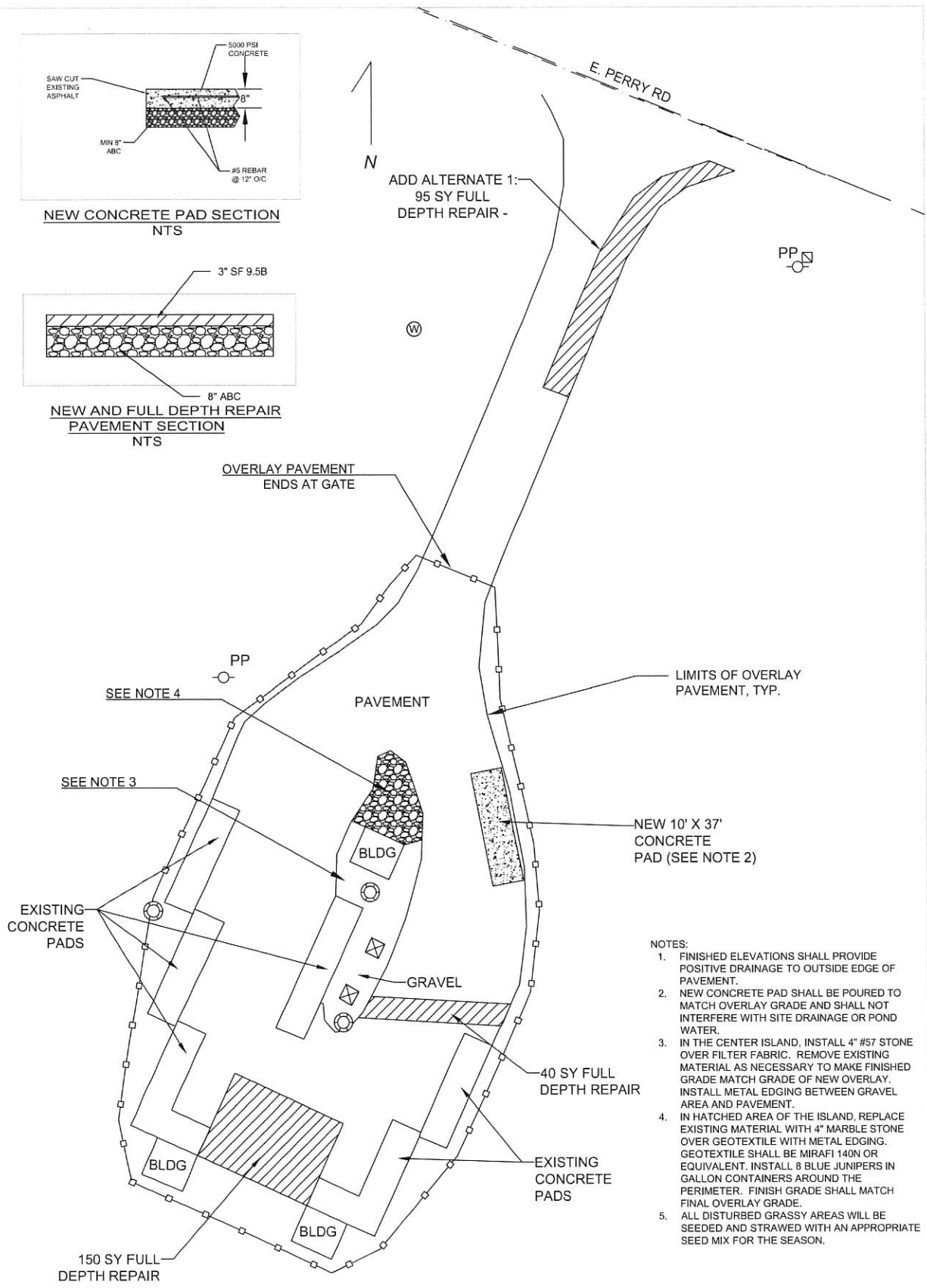

ADD ALTERNATE 1:
95 SY FULL
DEPTH REPAIR -

OVERLAY PAVEMENT
ENDS AT GATE

LIMITS OF OVERLAY
PAVEMENT, TYP.

NEW 10' X 37'
CONCRETE
PAD (SEE NOTE 2)

40 SY FULL
DEPTH REPAIR

EXISTING
CONCRETE
PADS

150 SY FULL
DEPTH REPAIR

- NOTES:
1. FINISHED ELEVATIONS SHALL PROVIDE POSITIVE DRAINAGE TO OUTSIDE EDGE OF PAVEMENT.
 2. NEW CONCRETE PAD SHALL BE POURED TO MATCH OVERLAY GRADE AND SHALL NOT INTERFERE WITH SITE DRAINAGE OR POND WATER.
 3. IN THE CENTER ISLAND, INSTALL 4" #57 STONE OVER FILTER FABRIC. REMOVE EXISTING MATERIAL AS NECESSARY TO MAKE FINISHED GRADE MATCH GRADE OF NEW OVERLAY. INSTALL METAL EDGING BETWEEN GRAVEL AREA AND PAVEMENT.
 4. IN HATCHED AREA OF THE ISLAND, REPLACE EXISTING MATERIAL WITH 4" MARBLE STONE OVER GEOTEXTILE WITH METAL EDGING. GEOTEXTILE SHALL BE MIRAFI 140N OR EQUIVALENT. INSTALL 8 BLUE JUNIPERS IN GALLON CONTAINERS AROUND THE PERIMETER. FINISH GRADE SHALL MATCH FINAL OVERLAY GRADE.
 5. ALL DISTURBED GRASSY AREAS WILL BE SEEDED AND STRAWED WITH AN APPROPRIATE SEED MIX FOR THE SEASON.

LEGEND	
PP	POWER POLE
W	LIGHT POLE
⊗	CONCRETE SEPTIC LID
⊠	CLEANOUT
⊞	TELEPHONE PEDESTAL
□-□-□	FENCE
---	ROAD CENTERLINE
—	NAIL SET
—	IRON PIPE FOUND
—	DEED REFERENCE

HADLEY COLLECTION CENTER
65 EAST PERRY RD, PITTSBORO, NC

CHATHAM COUNTY SOLID WASTE & RECYCLING
28 COUNTY SERVICES RD, PITTSBORO, NC 27312

DATE: 2/26/2020 DRAWN BY: RKL

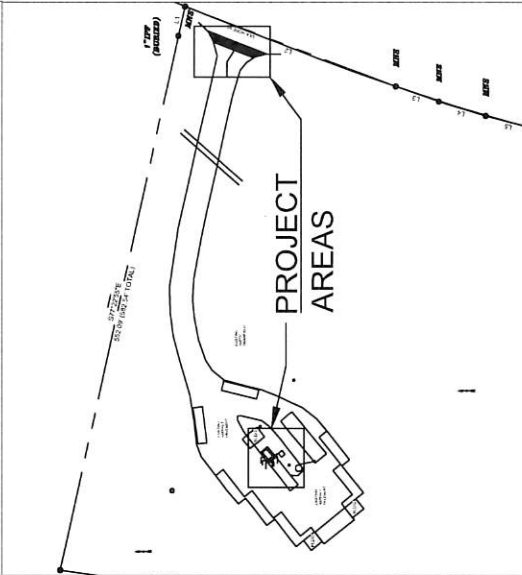
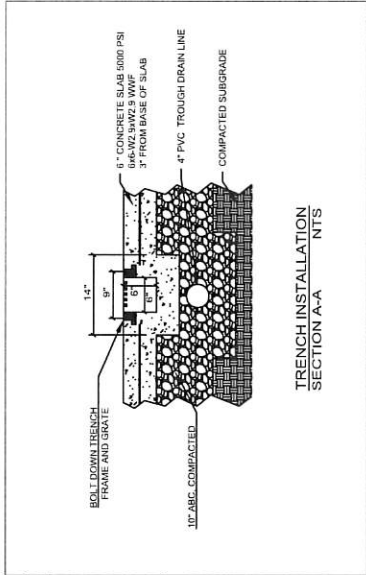
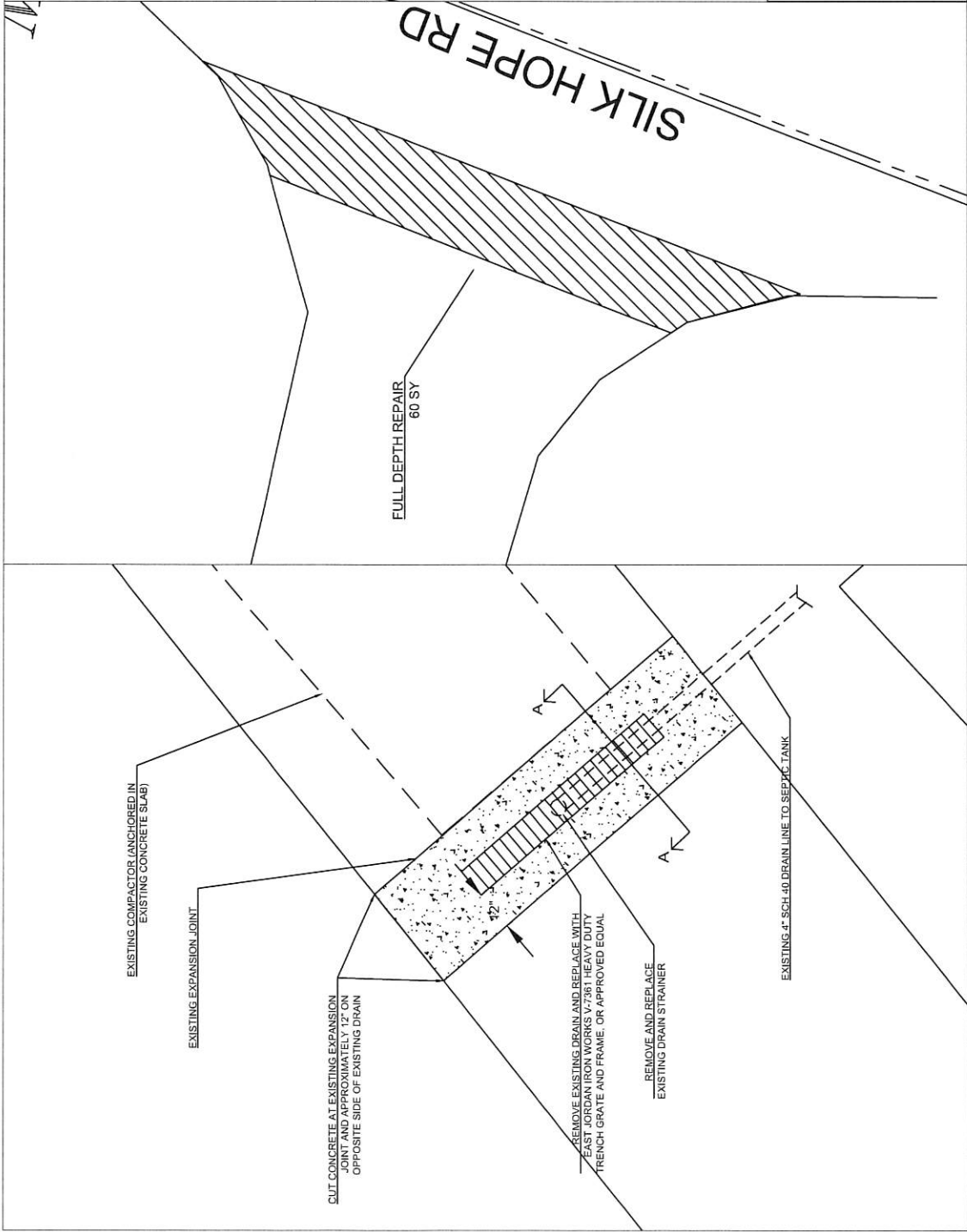

COMPACTOR DRAIN AND PAVEMENT REPAIR
 SILER CITY COLLECTION CENTER
 135 SILK HOPE ROAD, SILER CITY, NC 27312
 CHATHAM COUNTY SOLID WASTE AND RECYCLING
 28 COUNTY SERVICES RD, PITTSBORO, NC 27312
 DATE: 3/10/2021 DRAWN BY: RKL



DATE: March 26, 2021

TO: Firms Interested in the RFB Improvements to Solid Waste and Recycling Collection Centers

FROM: Kim Johnson, Chatham County Procurement Manager
Kevin Lindley, Environmental Quality Director

SUBJECT: Addendum No. 1– RFB Improvements SW&R Collection Centers

This addendum is issued to provide answers to questions submitted at the pre-bid meeting on March 24th and by email.

Please Note: Updated Pricing Sheet and photos of the Siler City Drain are posted on the Bid Posting.

Also, note the Scope of Work states 2" topping and site plan shows 3" topping. The full depth repair shall be a base layer of 8" compacted ABC with 3" SF 9.5B pavement.

1. What is the plan for the corners of the concrete slabs in front of the sheds at the centers?
1a) Contractor will remove the broken concrete corners and repour.
2. What kind of grading do you want on the outer sides of the pavement?
2a) Grade soil at the edge of pavement to facilitate drainage off-site, as needed. Seed and straw any disturbed areas.
3. How will the location for the concrete pad be marked?
3a) Owner and contractor will field determine the specific location prior to cutting of the pavement.
4. Will the shrubs be removed by the County or is that part of the contract?
4a) Removal of the existing shrubs will be the responsibility of the contractor.
5. Are there any spec requirements on the marble stone?
5a) There are no specific requirements. The stone should be white and approximately the size of #57 stone to match what has been used at other sites.
6. Does the soil under the full depth repairs need to be tested by a third party geotechnical firm?

6a) No, the assumption will be that the soil has sufficient bearing capacity for the expected use. Contractor will verify correct depth of existing ABC layer and adjust by undercutting and adding additional compacted ABC if necessary, to achieve the correct depth before new pavement is placed.

7. Can you please clarify for Crutchfield Crossroads scope of work are you requesting 4,000 or 5,000 psi for the concrete ramp and concrete pad.

7a) The ramps will be 4000 psi concrete and the concrete pads will be 5000 psi concrete.

8. When do you anticipate the project start date and completion date?

8a) This contract will have to be approved by the Chatham County Board of Commissioners (BOC). The contract is expected to go before the BOC on April 19, 2021. Assuming BOC approval, work would not be able to begin until Tuesday, April 20, 2021. The County prefers the project be fully completed by June 30, 2021. If there are substantial weather delays, the project finish date can be extended.

9. Would the contractor be allowed to work at night?

9a) This could be a possibility and would be negotiated with the winning contractor on a case-by-case basis.

10. Should the contractor use high early strength concrete for the drain repair?

10a) Yes, the contractor shall bid the Siler City drain repair concrete as high early strength to limit the amount of time the compactor will be out of service. High early strength concrete is not required for any other concrete work in this project.

11. There is a drainage issue at the back of Hadley Recycling Center. Is that to be addressed?

11a) No, adjusting the grade at the back of the Hadley site is not part of this contract.

12. At the Crutchfield site, will the contractor be required to grade the soil on the west side of the driveway to promote sheet flow to the ditch on that side?

12a) Yes, for the area outside the gate and west of the driveway, contractor will grade the existing soil to promote sheet flow from the driveway to the existing drainage ditch.

13. Are the contractors allowed to work at multiple sites at the same time?

13a) Yes, contractors will be allowed to work at multiple locations at the same time.

14. How long is it currently taking to get inspections?

14a) Permitting is currently three weeks out and inspections are running about 4 days out.

15. Within the specs the E-Verify, Iran Divestment Act, Requirement to Re-cycle Certain Electronic Equipment and Divestment from Companies that Boycott Israel are all listed however copies of those forms to fill out were not included. Can you clarify?

15a) These are State and Federal Guidelines and are not a part of the scope of work and are listed separately. This will be part of the contract agreement.

16. Will each center require their own permit?

16a) Each new ramp will require its own permit, because they each lead to separate structures. The broken ramp corner repairs will not require permitting.

17. Will a performance bond be required?

17a) Page 3 of RFB - The purpose of the Bid Deposit or Bid Bond is to ensure that the bidder will enter into a Contract with the Owner with the terms stipulated in the Bid Proposal and the bidder guarantees that a Performance, Labor & Material Bond will be executed, which is required for bids in the Chatham County Formal Range.

18. Will the project be awarded based on the total of all 4 sites or will each site be awarded separately? The bid form has no line for a total bid.

18a) The project will be awarded based on all four sites. An updated Pricing List is posted on the website, please use the updated form for your Bid.

Bids are due at 10:00 AM on 4/01/2021.



Attachment A:

Vendor Information & Signature Form

Name of Vendor:	A&M Construction Services Inc.
Contractor License #	Nc#41447 Sc# 100512
Contact Person(s)	Anthony Brady
Street Address with City, State & Zip Code	739 S Main Street Randleman, NC 27317
Mailing Address (if different than above)	P.O. BOX 4277 Asheboro ,NC 27204
Phone #	336-498-0046
Fax #	336-498-0049
Email	ANTHONY@AMCONSTRUCTIONSERVICE.COM
Proposer will do the work as:	<input type="checkbox"/> Individual <input type="checkbox"/> Joint Venture <input type="checkbox"/> Partnership <input checked="" type="checkbox"/> X Corporation
Date & state of incorporation	Date <i>MARCH</i> State NC <i>1998</i>
Name of partnership or joint venture	

By signing below, the submission of qualifications shall be deemed a representation and certification by the Proposing Consultant that it has investigated all aspects of the RFB, and it has read and understands the RFB.

Bidder Signature: <i>Anthony Brady</i>
Date Signed: 3/31/2021
Title of Signatory: PROJECT MANAGER/ VP

Pricing:

Contractor shall provide Lump Sum prices for each Center to complete the Scope of Work provided above and detailed on the Drawings.

Hadley:	\$ <u>60,482.00</u>	
Crutchfield Crossroads:	\$ <u>63,630.00</u>	
Asbury:	\$ <u>10,291.00</u>	
Siler City:	\$ <u>13,477</u>	
Provide the cost for providing and installing one ton of ABC stone		\$ <u>79.95</u> /ton
Provide the unit cost for full depth pavement repair		\$ <u>112.00</u> /sy
Add Alternate 1: Hadley driveway 95 sy full depth repair		\$ <u>8,186.11</u>
Add Alternate 2: Crutchfield Crossroads - driveway 65 sy full depth repair		\$ <u>5,169.25</u>
Add Alternate 3: Crutchfield Crossroads - overlay driveway		\$ <u>4,392.71</u>

Drawings

The site detail drawings are attached to the Bids and Opportunity Page as a separate file within the Announcement for this project.

<http://www.chathamcountync.gov/government/current-bid-proposal-opportunities>



CONSTRUCTION SERVICES, INC.

P.O. BOX 4277 • ASHEBORO, NC 27204-4277 • PH: 336-498-0046 • FAX: 336-498-0049

BID# 24-208

APRIL 1, 2021
CHATHAM COUNTY
28 COUNTY SERVICE RD
PITTSBORO, NC 27312

ATTN: KEVIN LINDLEY
KIMBERLY JOHNSON

RE: CC SOLID WASTE & RECYCLING COLLECTION CENTER IMPROVEMENTS

DEAR SIR:

WE ARE PLEASED TO QUOTE A BUDGET FOR FURNISHING THE LABOR, MATERIALS, EQUIPMENT, INSURANCE AND TAXES NECESSARY TO:

(BASE BID SCOPE) : ASBURY

- *INSTALL ONE 10'x37' CONCRETE PAD AS SHOWN ON DRAWING. PAD SHALL BE FORMED AND PLACED SO THAT IT MATCHES GRADE OF THE NEW ASPHALT OVERLAY.*
- *REMOVE AND DISPOSE OF EXISTING CONCRETE RAMPS AND WOODEN RAILING IN FRONT OF THE OIL SHED AND SWAP SHOP SHED.*
- *CUT EXISTING ASPHALT TO INSTALL A CONCRETE ACCESS RAMP LEADING UP TO EACH SHED, APPROXIMATELY 8" HIGH (TO MATCH GRADE WITH THE SHED SLAB), 10' LONG AND 14' WIDE. THE CONCRETE RAMP SHALL BE REINFORCED AND A MINIMUM OF 4" THICK AND 4,000 PSI. THE RAMP SHALL BE FORMED AND PLACED SO THE LOW END MATCHES THE GRADE OF THE ASPHALT OVERLAY.*
- *EROSION AND SEDIMENT CONTROL AS NEEDED.*
- *REMOVAL AND DISPOSAL OF MILLED OR DEMO-ED ASPHALT.*

MATERIALS.....	\$ 3,738.00
LABOR.....	\$ 5,298.00
EQUIPMENT.....	\$ 1,255.00
TOTAL.....	\$ 10,291.00

(BASE BID SCOPE CRUTCHFIELD CROSSROADS):

- *INSTALL ONE 10'x37' CONCRETE PAD AS SHOWN ON DRAWING. PAD SHOULD BE FORMED AND PLACED SO THAT IT MATCHES GRADE OF THE NEW ASPHALT OVERLAY.*
- *REMOVE AND DISPOSE OF (1)EXISTING CONCRETE RAMP AND WOODEN RAILING IN FRONT OF THE OIL SHED.*
- *CUT EXISTING ASPHALT TO INSTALL A CONCRETE ACCESS RAMP LEADING UP TO EACH SHED, APPROXIMATELY 8" HIGH (TO MATCH GRADE WITH THE SHED SLAB), 10' LONG AND 14' WIDE. THE CONCRETE RAMP SHALL BE REINFORCED AND A MINIMUM OF 4" THICK AND 4,000 PSI. THE RAMP SHALL BE FORMED AND PLACED SO THE LOW END MATCHES THE GRADE OF THE ASPHALT OVERLAY.*
- *MILL PAVEMENT AT EDGES OF ALL NEW AND EXISTING CONCRETE PADS AND PAVEMENT TO ALLOW PROPER TIE-IN OF NEW ASPHALT.*
- *APPLY TAR AND GRAVEL LAYER TO ENTIRE ASPHALT AREA TO LIMITS SHOWN PRIOR TO OVERLAY.*
- *OVERLAY ENTIRE ASPHALT AREA TO LIMITS SHOWN WITH 1.5" 9.5B OVERLAY.*
- *REPAIR THE CRACK IN THE CORNER OF THE CONCRETE RAMP IN FRONT OF THE SWAP SHOP. CLEAN THE CRACK AND*

FILL WITH A FLEXIBLE SEALANT DESIGNED FOR USE ON CONCRETE. USE BACKER ROD AS NECESSARY TO PRE- FILL CRACK BEFORE INSTALLING SEALANT.

- PERFORM FULL-DEPTH PAVEMENT REPAIR AT LOCATIONS INDICATED TO REPAIR DIPS, BREAKS OR HOLES IN THE EXISTING PAVEMENT. THE EXISTING PAVEMENT SPECIFICATION WAS 8" COMPACTED ABC BASE WITH 2" I-2 PAVEMENT. SAW-CUT AND REMOVE ASPHALT FROM FULL DEPTH REPAIR AREAS AND PREPARE BASE LAYER OF ABC TO ENSURE AT LEAST 8" OF COMPACTED STONE. INSTALL 2" I-2 OR EQUIVALENT ON PREPARED BASE LAYER. FULL DEPTH REPAIR SHALL MATCH GRADE WITH EXISTING PAVEMENT.
- MILL EXISTING PAVEMENT AT EDGES OF ALL NEW AND EXISTING CONCRETE PADS AND PAVEMENT TO ALLOW PROPER TIE-IN OF NEW ASPHALT.
- APPLY TAR AND GRAVEL LAYER OVER ENTIRE ASPHALT AREA TO LIMITS SHOWN PRIOR TO OVERLAY.
- OVERLAY ENTIRE ASPHALT AREA TO LIMITS SHOWN WITH 1.5" 9.5B OVERLAY. ANY FULL-DEPTH REPAIRS DONE OUTSIDE OF OVERLAY LIMITS WILL NOT BE OVERLAID.
- IN THE CENTRAL ISLAND NEAR THE WASTE COMPACTOR, REMOVE SOIL, FINES AND EXISTING GRAVEL TO ALLOW FOR INSTALLATION OF 4" OF #57 STONE OVER FILTER FABRIC. FINISH GRADE OF STONE SHALL MATCH THE GRADE OF THE OVERLAY PAVEMENT.
- IN AREAS SHOWN ON THE DRAWING IN THE CENTRAL ISLAND, REMOVE EXISTING MATERIAL INCLUDING 9 EXISTING SHRUBS, TO ALLOW INSTALLATION OF 4" OF WHITE MARBLE STONE OVER A GEOTEXTILE LAYER, MIRAFI 140N, OR EQUIVALENT. FINISH GRADE OF STONE SHALL MATCH THE GRADE OF THE OVERLAY PAVEMENT.
- INSTALL EIGHT (8) BLUE JUNIPERS, ONE GALLON SIZE, AROUND THE PERIMETER OF THE WHITE MARBLE STONE AREA. THE GEOTEXTILE SHOULD BE CUT WHERE THE PLANTS ARE INSTALLED THEM TO BE PLANTED IN THE SOIL.
- INSTALL METAL EDGING AROUND THE PERIMETER OF THE CENTRAL ISLAND, BETWEEN THE PAVEMENT AND NEWLY INSTALLED STONE. INSTALL A METAL DIVIDER BETWEEN THE #57 STONE AND WHITE MARBLE STONE.
- GRADE SOIL AT THE EDGE OF PAVEMENT TO FACILITATE DRAINAGE OFF-SITE, AS NEEDED. SEED AND STRAW ANY DISTURBED AREAS.
- FULL DEPTH PAVEMENT REPAIR, APPROXIMATELY 190 SQUARE YARDS, AT LOCATIONS INDICATED.
- GRADING OF SOIL AT THE EDGE OF PAVEMENT TO FACILITATE DRAINAGE, AS NEEDED.
- RESEEDING OF ANY DISTURBED AREAS
- EROSION AND SEDIMENT CONTROL AS NEEDED.
- REMOVAL AND DISPOSAL OF MILLED OR DEMO-ED ASPHALT.

MATERIALS.....	\$ 5,419.00
LABOR.....	\$ 10,109.00
EQUIPMENT.....	\$ 2,314.00
SUB.....	\$ 45,788.00
TOTAL.....	\$ 63,630.00

(BASE BID SCOPE HADLEY):

- INSTALL ONE 10'X37' CONCRETE PAD AS SHOWN ON DRAWING. PAD SHOULD BE FORMED AND PLACED SO THAT IT MATCHES GRADE OF THE NEW ASPHALT OVERLAY.
- MILL PAVEMENT AT EDGES OF ALL NEW AND EXISTING CONCRETE PADS AND PAVEMENT TO ALLOW PROPER TIE-IN OF NEW ASPHALT.
- APPLY TAR AND GRAVEL LAYER TO ENTIRE ASPHALT AREA TO LIMITS SHOWN PRIOR TO OVERLAY.
- OVERLAY ENTIRE ASPHALT AREA TO LIMITS SHOWN WITH 1.5" 9.5B OVERLAY.
- REPAIR THE CRACK IN THE CORNER OF THE CONCRETE RAMP IN FRONT OF THE SWAP SHOP. CLEAN THE CRACK AND FILL WITH A FLEXIBLE SEALANT DESIGNED FOR USE ON CONCRETE. USE BACKER ROD AS NECESSARY TO PRE- FILL CRACK BEFORE INSTALLING SEALANT.
- PERFORM FULL-DEPTH PAVEMENT REPAIR AT LOCATIONS INDICATED TO REPAIR DIPS, BREAKS OR HOLES IN THE EXISTING PAVEMENT. THE EXISTING PAVEMENT SPECIFICATION WAS 8" COMPACTED ABC BASE WITH 2" I-2

PAVEMENT. SAW-CUT AND REMOVE ASPHALT FROM FULL DEPTH REPAIR AREAS AND PREPARE BASE LAYER OF ABC TO ENSURE AT LEAST 8" OF COMPACTED STONE. INSTALL 2" 1-2 OR EQUIVALENT ON PREPARED BASE LAYER. FULL DEPTH REPAIR SHALL MATCH GRADE WITH EXISTING PAVEMENT.

- MILL EXISTING PAVEMENT AT EDGES OF ALL NEW AND EXISTING CONCRETE PADS AND PAVEMENT TO ALLOW PROPER TIE-IN OF NEW ASPHALT.
- APPLY TAR AND GRAVEL LAYER OVER ENTIRE ASPHALT AREA TO LIMITS SHOWN PRIOR TO OVERLAY.
- OVERLAY ENTIRE ASPHALT AREA TO LIMITS SHOWN WITH 1.5" 9.5B OVERLAY. ANY FULL-DEPTH REPAIRS DONE OUTSIDE OF OVERLAY LIMITS WILL NOT BE OVERLAID.
- IN THE CENTRAL ISLAND NEAR THE WASTE COMPACTOR, REMOVE SOIL, FINES AND EXISTING GRAVEL TO ALLOW FOR INSTALLATION OF 4" OF #57 STONE OVER FILTER FABRIC. FINISH GRADE OF STONE SHALL MATCH THE GRADE OF THE OVERLAY PAVEMENT.
- IN AREAS SHOWN ON THE DRAWING IN THE CENTRAL ISLAND, REMOVE EXISTING MATERIAL, TO ALLOW INSTALLATION OF 4" OF WHITE MARBLE STONE OVER A GEOTEXTILE LAYER, MIRAFI 140N, OR EQUIVALENT. FINISH GRADE OF STONE SHALL MATCH THE GRADE OF THE OVERLAY PAVEMENT.
- INSTALL EIGHT (8) BLUE JUNIPERS, ONE GALLON SIZE, AROUND THE PERIMETER OF THE WHITE MARBLE STONE AREA. THE GEOTEXTILE SHOULD BE CUT WHERE THE PLANTS ARE INSTALLED THEM TO BE PLANTED IN THE SOIL.
- INSTALL METAL EDGING AROUND THE PERIMETER OF THE CENTRAL ISLAND, BETWEEN THE PAVEMENT AND NEWLY INSTALLED STONE. INSTALL A METAL DIVIDER BETWEEN THE #57 STONE AND WHITE MARBLE STONE.
- GRADE SOIL AT THE EDGE OF PAVEMENT TO FACILITATE DRAINAGE OFF-SITE, AS NEEDED. SEED AND STRAW ANY DISTURBED AREAS.
- FULL DEPTH PAVEMENT REPAIR, APPROXIMATELY 190 SQUARE YARDS, AT LOCATIONS INDICATED.
- GRADING OF SOIL AT THE EDGE OF PAVEMENT TO FACILITATE DRAINAGE, AS NEEDED.
- RESEEDING OF ANY DISTURBED AREAS
- EROSION AND SEDIMENT CONTROL AS NEEDED.
- REMOVAL AND DISPOSAL OF MILLED OR DEMO-ED ASPHALT.

MATERIALS.....	\$ 5,419.00
LABOR.....	\$ 6,961.00
EQUIPMENT.....	\$ 2,314.00
SUB.....	\$ 45,788.00
TOTAL.....	\$ 60,482.00

(BASE BID SCOPE) : SILER CITY

- SAW CUT AND REMOVE A 10' SECTION OF CONCRETE APPROXIMATELY 3' WIDE INCLUDING EXISTING TRENCH DRAIN.
- INSTALL 10" ABC STONE COMPACTED UNDER DRAIN.
- EXCAVATE AND INSTALL REBAR REINFORCING FOR NEW TRENCH.
- FORM AND INSTALL JORDAN IRON WORKS PART #00695102. (8 WEEK LEAD TIME)
- PLACE 5,000 PSI CONCRETE AROUND NEW TRENCH DRAIN SECTION.
- FULL DEPTH PAVEMENT REPAIR, APPROXIMATELY 60 SQUARE YARDS, AT LOCATIONS INDICATED.
- EROSION AND SEDIMENT CONTROL AS NEEDED.
- REMOVAL AND DISPOSAL OF MILLED OR DEMO-ED ASPHALT.

MATERIALS.....	\$ 890.00
LABOR.....	\$ 3,616.00
EQUIPMENT.....	\$ 1,255.00
SUB.....	\$ 7,716.00
TOTAL.....	\$ \$13,477.00

UNIT COST : FOR PROVIDING AND INSTALLING ABC STONE. **\$79.75/TON**

UNIT COST : FOR FULL DEPTH REPAIR BEYOND WHAT'S SHOWN ON DRAWINGS. **\$112.00/SQUARE YARD**

ADD ALTERNATE 1: HADLEY DRIVEWAY 95 SY FULL DEPTH REPAIR	\$ 8,186.11
ADD ALTERNATE 2: CRUTCHFIELD CROSSROADS - DRIVEWAY 60 SY FULL DEPTH REPAIR	\$ 5,169.25
ADD ALTERNATE 3: CRUTCHFIELD CROSSROADS - OVERLAY DRIVEWAY 275 SY	\$ 4,392.71

QUALIFICATIONS:

- WORK IS PRICED FOR NORMAL WORKING HOURS.
- NO FIRE ALARM, TELEPHONE, SECURITY, AND ELECTRICAL (IF NEEDED WILL BE BY OWNER).
- PROPOSALS BASED ON MATCHING EXISTING GRADE AT EACH SITE, NOT TO RE-SLOPE ANY EXISTING GRADE.
- *NEW RAMPS TO BE ADA COMPLIANT AND WILL REQUIRE A BUILDING PERMIT. THERE WILL BE NO COST FOR THE PERMIT SINCE IT IS FOR A COUNTY FACILITY, BUT THE CONTRACTOR WILL BE RESPONSIBLE FOR OBTAINING THE PERMIT AND SCHEDULING INSPECTIONS.*
- **WE EXCLUDE THE FOLLOWING FROM THE ABOVE QUOTE:** TESTING, CONCRETE TESTING, LOCATING SERVICES, UTILITIES U.N.O., TEMPORARY UTILITIES, ENGINEERING, SHOP DRAWINGS U.N.O., SUBMITTALS, EXCESSIVE ROCK EXCAVATION, EXCESSIVE EXCAVATION DUE TO BAD OR CONTAMINATED SOILS. GEOTECHNICAL ENGINEERING; ACCELERATED SCHEDULE BEYOND FORTY HOURS PER WEEK. ANYTHING NOT SPECIFICALLY MENTIONED ABOVE.

WE APPRECIATE THE INVITATION TO BE OF SERVICE BY PROVIDING A BID ON THIS PROJECT. IF WE CAN BE OF FURTHER SERVICE ON THIS OR ANY OTHER PROJECT PLEASE LET ME KNOW.

SINCERELY



ANTHONY BRADY
PROJECT MANAGER

THANK YOU FOR THE OPPORTUNITY TO ASSIST WITH YOUR PROJECT!