

**PRELIMINARY**  
DO NOT USE FOR CONSTRUCTION

CALL N.C. ONE  
CALL CENTER  
BEFORE YOU DIG  
**STOP**  
1-800-632-4949  
AVOID UTILITY  
DAMAGE



NORTH

REV.	DATE	DESCRIPTION
A	2020.10.20	CHATHAM COUNTY APPEARANCE COMMITTEE

SEAL

PRELIMINARY PLAN  
FOR REVIEW PURPOSES  
ONLY



1730 Varsity Drive, Suite 500  
Raleigh, North Carolina 27606  
Phone: (919)233-8091, Fax: (919)233-8031  
F-1222  
www.mckimcreed.com



COMMERCIAL PROPERTIES INC.  
BRIAR CHAPEL SD WEST  
CHATHAM COUNTY, NORTH CAROLINA

EXISTING CONDITIONS PLAN

DATE: OCTOBER 20, 2020	SCALE: HORIZONTAL: 1"=40'	MSC FILE NUMBER: C0.X
MCE PROJ. #: 00741-0011	VERTICAL: N/A	DRAWING NUMBER: C0.1
DRAWN: ENS		
DESIGNED: DJB		
CHECKED: DJB		
PROJ. MGR.: GCA		
STATUS: PRELIMINARY LAYOUT NOT TO BE USED FOR CONSTRUCTION	REVISION: A	



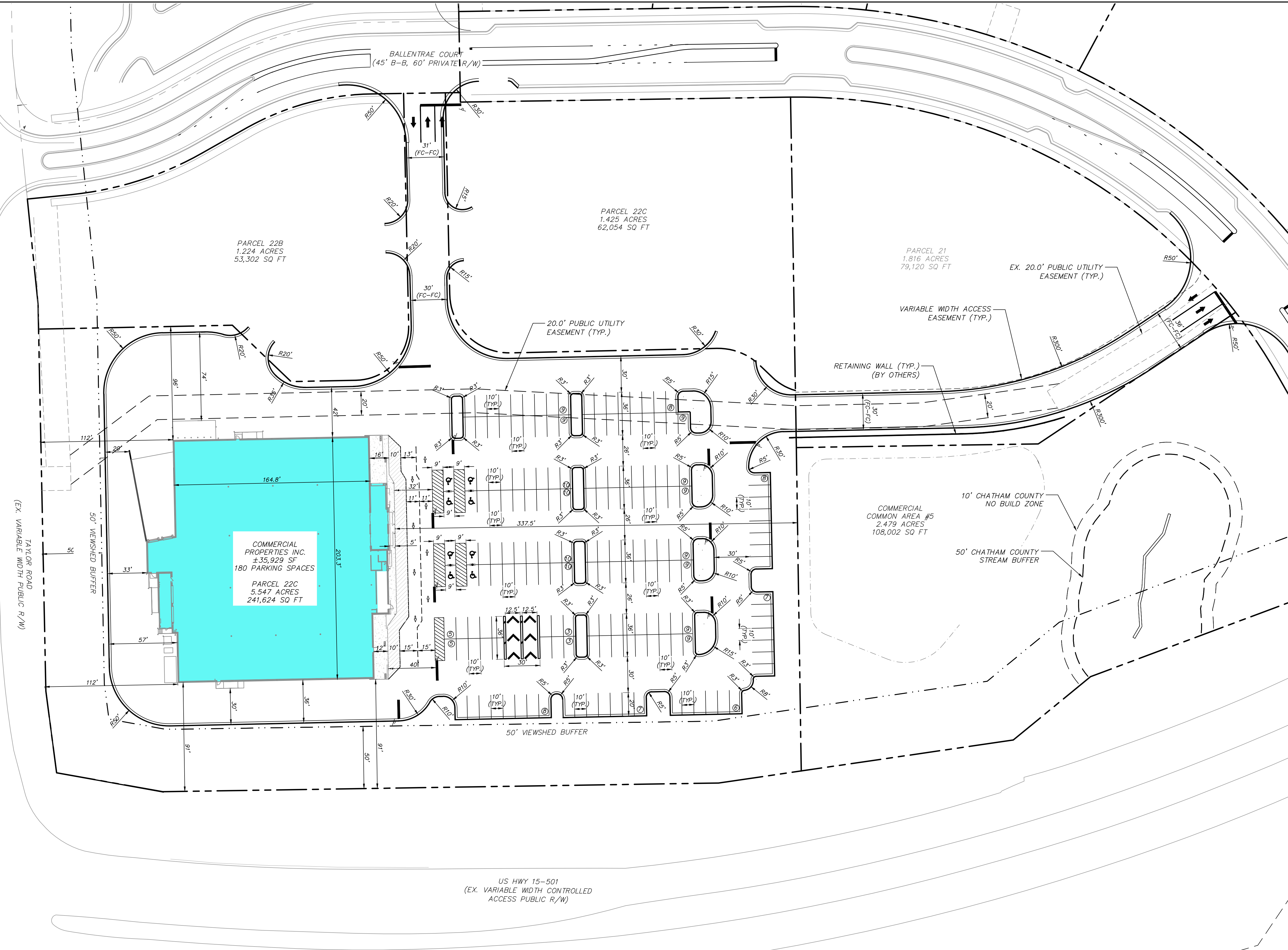
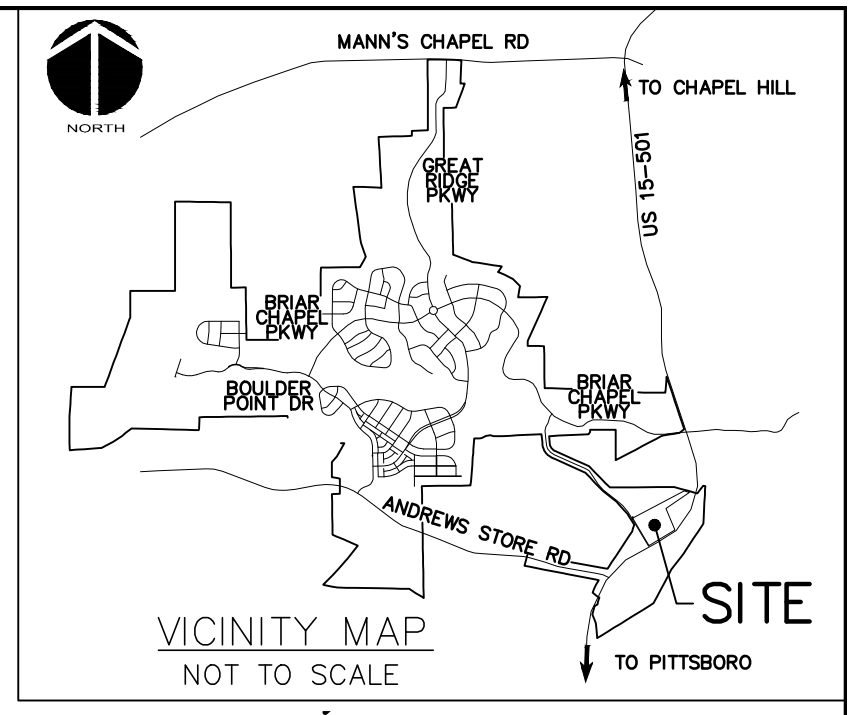

**SITE DATA TABLE:**

- AKPAR NUMBER:  
93299
- TOTAL SITE AREA:  
8.11 AC
- PARKING SPACES:  
PARKING REQUIRED:  
1 SPACE / 1,000 SF  
35,929 SF / 1,000 \* 5 = 180 SPACES  
ADA SPACES REQUIRED:  
ADA SPACES: 6  
VAN ACCESSIBLE SPACES: 1  
PARKING PROVIDED: 173 SPACES  
8 ADA SPACES (TOTAL)  
TOTAL SPACES: 181 SPACES

CALL N.C. ONE CALL CENTER BEFORE YOU DIG  
**STOP**  
1-800-632-4949  
AVOID UTILITY DAMAGE

**NORTH**

40' 0 40' 80'  
SCALE: 1"=40' (Horiz.)

**PRELIMINARY**  
DO NOT USE FOR CONSTRUCTION

REV. NO.	DESCRIPTION	DATE
A	CHATHAM COUNTY APPEARANCE COMMITTEE	2020.10.20
	REVISIONS	

SEAL

SEAL

PRELIMINARY PLAN  
FOR REVIEW PURPOSES ONLY

**MCKIM & CREED**

1730 Varsity Drive, Suite 500  
Raleigh, North Carolina 27606  
Phone: (919)233-8091, Fax: (919)233-8031  
F-1222

www.mckimcreed.com

**CP** commercial properties, inc.

COMMERCIAL PROPERTIES INC.  
BRIAR CHAPEL SD WEST  
CHATHAM COUNTY, NORTH CAROLINA

**SITE PLAN**

DATE: OCTOBER 20, 2020	SCALE: HORIZONTAL: 1"=40'	MISC. FILE NUMBER: C1.X
MCE PROJ. #: 00741-0011	VERTICAL: N/A	DRAWING NUMBER: C1.0
DRAWN: ENS		
DESIGNED: DJB		
CHECKED: DJB		
PROJ. MGR.: GCA		
STATUS: PRELIMINARY LAYOUT NOT TO BE USED FOR CONSTRUCTION		REVISION: A



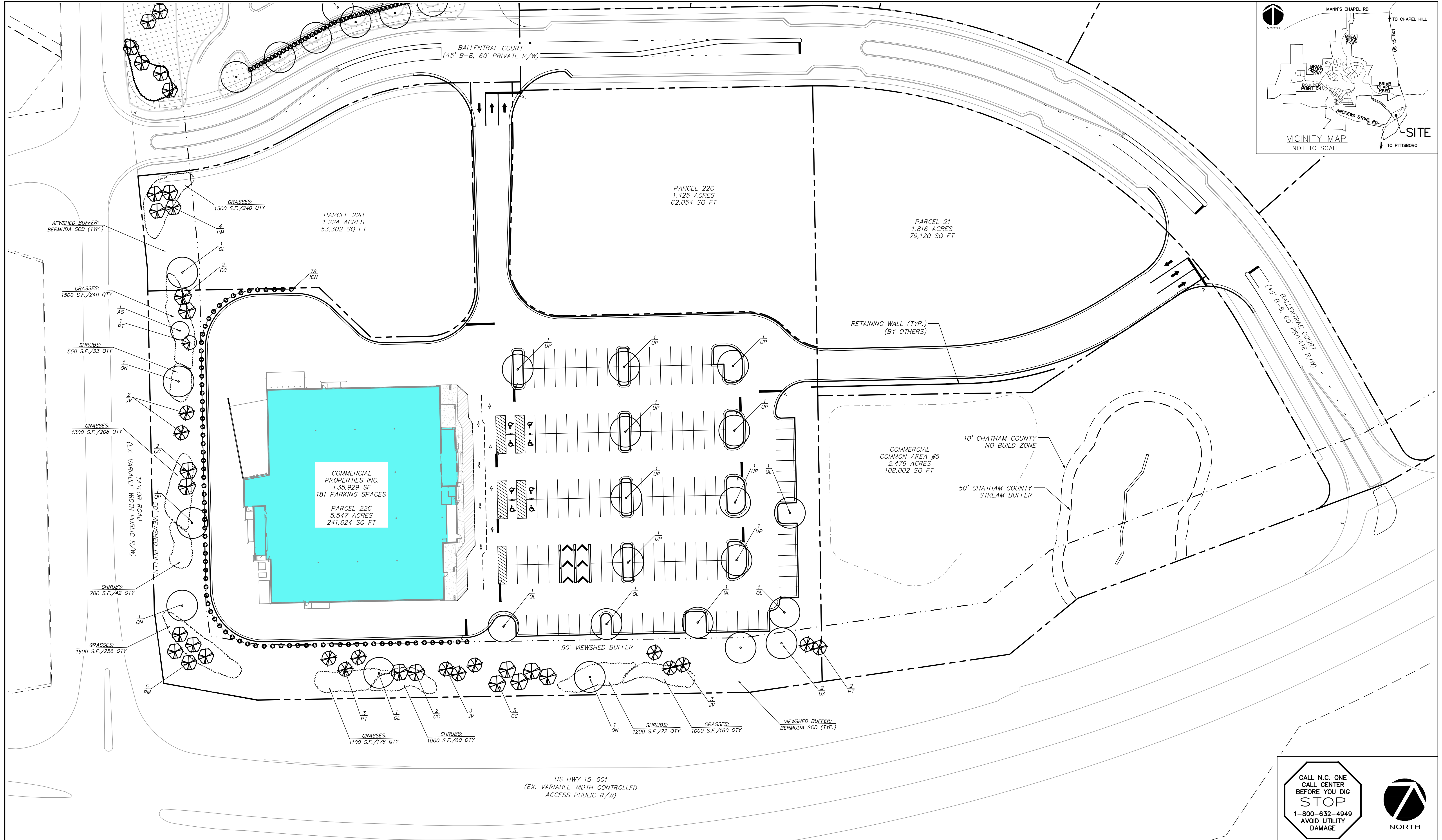
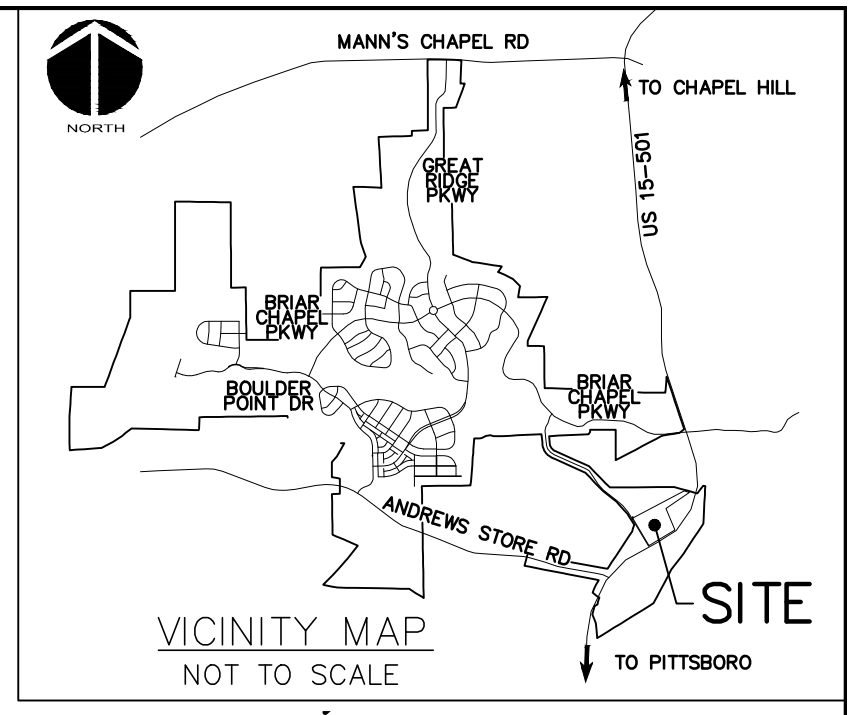

**PRELIMINARY**  
DO NOT USE FOR CONSTRUCTION

CALL N.C. ONE CALL CENTER BEFORE YOU DIG  
**STOP**  
 1-800-632-4949  
 AVOID UTILITY DAMAGE

NORTH

40' 0 40' 80'  
 SCALE: 1"=40' (Horiz.)

REV. NO.	DESCRIPTION	DATE
A	CHATHAM COUNTY APPEARANCE COMMITTEE	2020.10.20
	REVISIONS	

SEAL

SEAL

PRELIMINARY PLAN  
FOR REVIEW PURPOSES ONLY

**MCKIM & CREED**

1730 Varsity Drive, Suite 500  
 Raleigh, North Carolina 27606  
 Phone: (919)233-8091, Fax: (919)233-8031  
 F-1222

www.mckimcreed.com

**CP** commercial properties, inc.

COMMERCIAL PROPERTIES INC.  
 BRIAR CHAPEL SD WEST  
 CHATHAM COUNTY, NORTH CAROLINA

LANDSCAPING PLAN

DATE: OCTOBER 20, 2020	SCALE: HORIZONTAL: 1"=40'	MSC. FILE NUMBER: L1.X
MCE PROJ. # 00741-0011	DRAWN: ENS	DRAWING NUMBER: L1.0
DESIGNED: DJB	CHECKED: DJB	PROJ. MGR.: GCA
STATUS: PRELIMINARY LAYOUT NOT TO BE USED FOR CONSTRUCTION	REVISION: A	



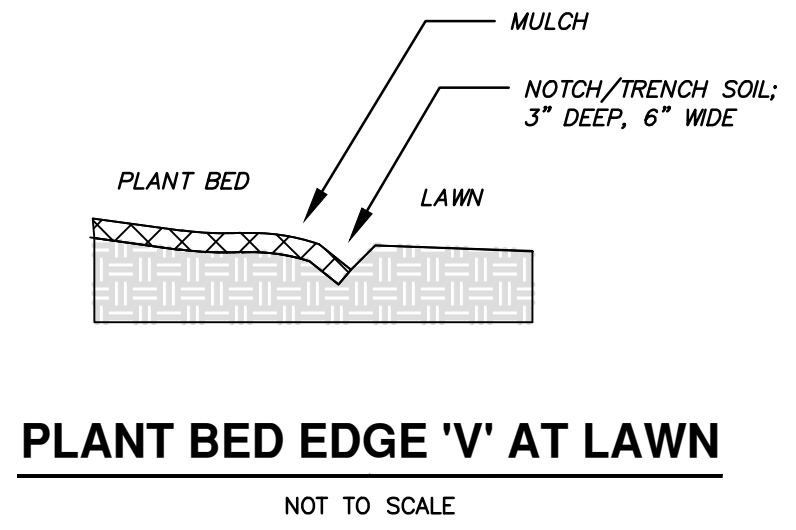
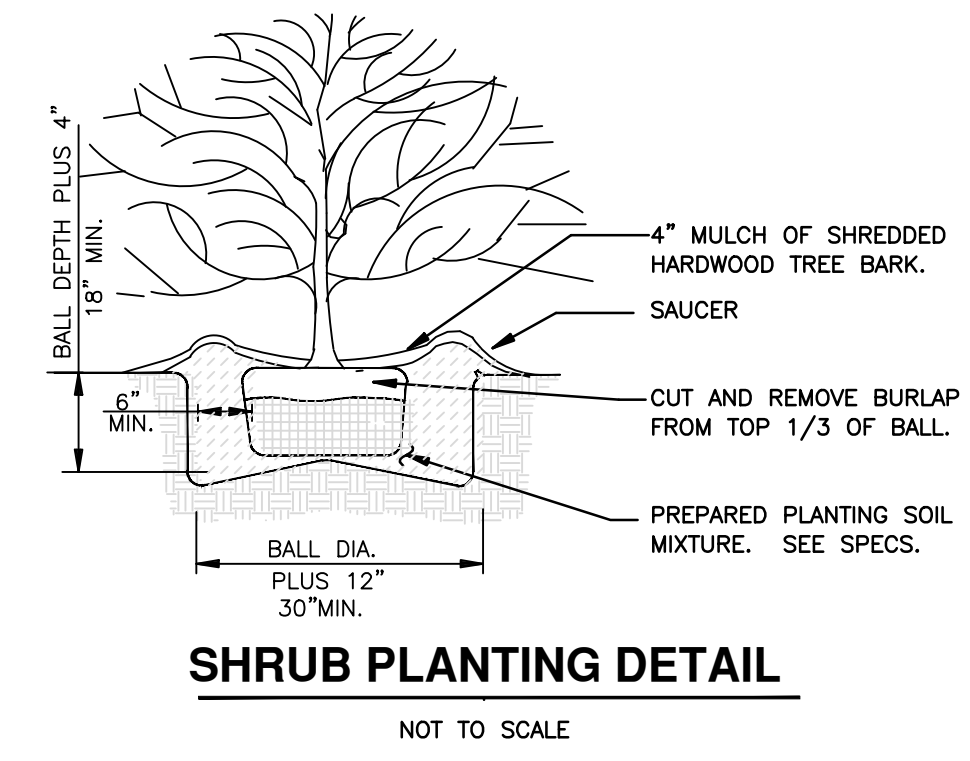
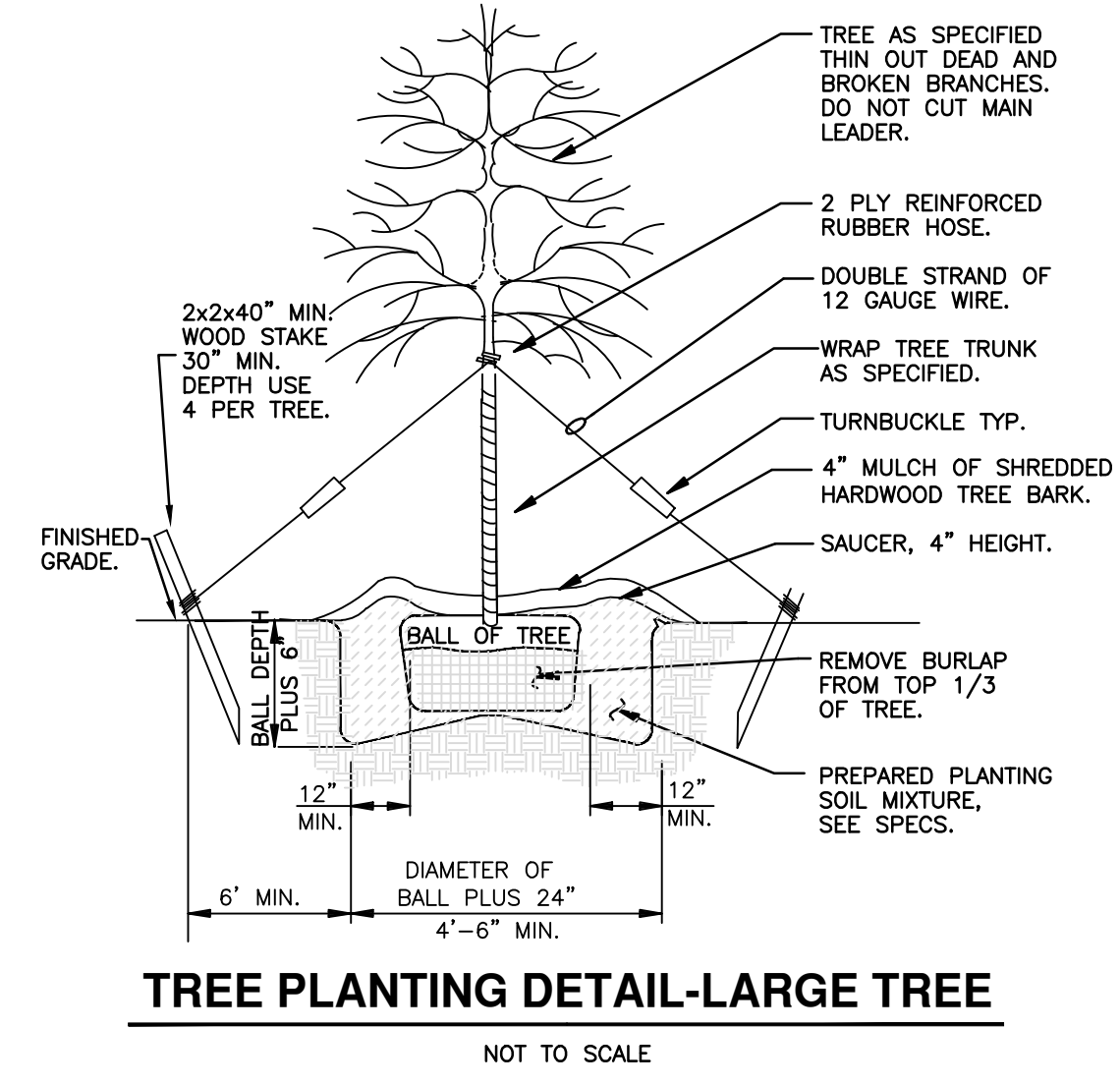
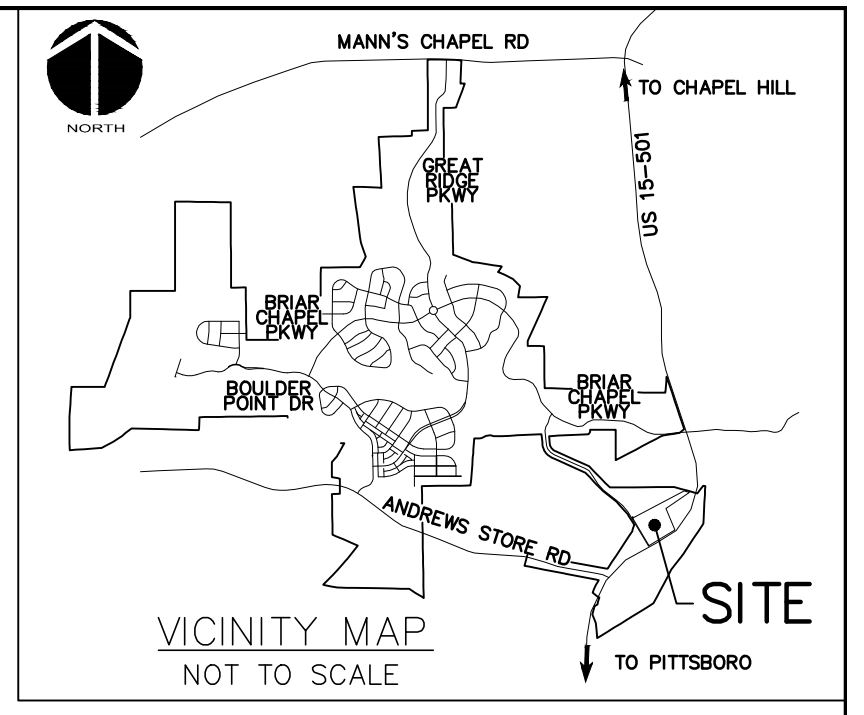

Code	Botanical Name	Common Name	Qty.	Root	Caliper	Height	Spread	Comments
<b>Trees</b>								
AS	Amelanchier	Common Serviceberry	1	B&B	2"	8'	6'	Evenly branched, multi stem
CC	Cercis canadensis	Eastern Redbud	11	B&B	2"	8-10'	4'	Evenly branched, single stem
JV	Juniperus virginia	Eastern Red Cedar	8	B&B	-----	8'	5'	Full to ground
PT	Pinus palustris	Longleaf Pine	6	B&B	-----	8'	4'	Full to ground
PM	Prunus mume	Flowering Apricot	9	B&B	2"	8-10'	4'	Evenly branched, single stem
QL	Quercus lyrata	Overcup Oak	7	B&B	3"	12-14'	6'	Strong central straight leader, evenly branched, limbed up to 6'
QN	Quercus nuttallii	Nuttall Oak	4	B&B	3"	12-14'	6'	Strong central straight leader, evenly branched, limbed up to 6'
QP	Quercus phellos 'Hightower'	Hightower Willow Oak	1	B&B	3"	12-14'	6'	Strong central straight leader, evenly branched, limbed up to 6'
UA	Ulmus americana 'Princeton'	Princeton American Elm	2	B&B	3"	12-14'	6'	Strong central straight leader, evenly branched, limbed up to 6'
UP	Ulmus parvifolia	Lacebark Elm	9	B&B	3"	12-14'	6'	Strong central straight leader, evenly branched, limbed up to 6'
<b>Shrubs</b>								
IVJ	Ilex verticillata 'Jim Dandy'	Jim Dandy	57	cont.	-----	18"	18"	60" on center full, dense, mass in plant bed in 50' viewshed buffer
IV	Ilex verticillata 'Red Sprite'	Red Sprite Winterberry	57	cont.	-----	18"	18"	60" on center full, dense, mass in plant bed in 50' viewshed buffer
IVS	Itea virginica	Virginia Sweetspire	67	cont.	-----	20"	18"	48" on center full, dense, mass in plant bed in 50' viewshed buffer
ICN	Ilex cornuta 'Dwarf Burford'	Dwarf Burford Holly	78	cont.	-----	24"	18"	48" on center full, dense
OF	Osmanthus fragrans	Sweet Osmanthus	16	cont.	-----	42"	24"	60" on center full, dense, mass in plant bed in 50' viewshed buffer
<b>Ornamental Grasses</b>								
AG	Andropogon gerardii 'Red October'	Big Blue Stem	320	plugs	-----	-----	15" - 18"	30" on center, mass in plant bed in 50' viewshed buffer
MC	Muhlenbergia capillaris 'White Cloud'	White Cloud Muhly Grass	320	plugs	-----	-----	15" - 18"	30" on center, mass in plant bed in 50' viewshed buffer
PV	Panicum virgatum 'Shenandoah'	Switch Grass	320	plugs	-----	-----	15" - 18"	30" on center, mass in plant bed in 50' viewshed buffer
SN	Sorghastrum nutans 'Indian Steel'	Indian Grass	320	plugs	-----	-----	15" - 18"	30" on center, mass in plant bed in 50' viewshed buffer

**PLANTING NOTES:**

- EXISTING UTILITIES SHOWN ARE APPROXIMATE AND SHALL BE VERIFIED IN THE FIELD PRIOR TO BEGINNING WORK. CONTRACTOR SHALL CONTACT NC ONE CALL CENTER AT 1-800-632-4949 FOR LOCATION OF EXISTING UTILITIES PRIOR TO BEGINNING CONSTRUCTION. THE CONTRACTOR SHALL EXERCISE CAUTION WHEN WORKING AROUND EXISTING UTILITIES TO REMAIN.
- PLANT LIST IS PROVIDED FOR CONVENIENCE ONLY. IN THE CASE OF DISCREPANCIES BETWEEN THE PLAN AND PLANT LIST QUANTITIES, THE PLAN SHALL TAKE PRECEDENCE.
- AFTER THE SITE IS STABILIZED AND FREE OF SEDIMENTATION, THE CONTRACTOR SHALL REMOVE ALL TEMPORARY EROSION CONTROL DEVICES, SILT, RIP RAP, AND TEMPORARY STONE STAGING AREAS FOR REPLACEMENT WITH PLANTING SOIL. PROVIDE PLANTING ACCORDING TO THE LANDSCAPE PLAN.
- TEMPORARY EROSION CONTROL SEED MUST BE FULLY REMOVED PRIOR TO PREPARATION OF PERMANENT SEED, SOD OR LANDSCAPE BEDS.
- UNLESS OTHERWISE NOTED IN THE PLANT LIST, THE CONTRACTOR SHALL OBTAIN AND INSTALL ONLY PLANT MATERIAL THAT IS GROWN ON ITS OWN. ROOT-GRAFTED OR BUDDED PLANT MATERIAL WILL BE REJECTED.
- ALL TREES SHALL BE OBTAINED FROM THE NURSERY WITH EXPOSED ROOT CROWNS. BALLED AND BURLAPPED MATERIAL DELIVERED TO SITE WITH BURIED OR RECENTLY BURIED ROOT CROWNS WILL BE REJECTED.
- CONTRACTOR SHALL NOTIFY ENGINEER OR LANDSCAPE ARCHITECT OF PLANT SUBSTITUTIONS IN ANY MEASUREMENT OR SPECIES INDICATED FOR APPROVAL. SEE SPECIFICATIONS FOR FULL NOTIFICATION REQUIREMENTS.
- DO NOT PLANT IN STORM WATER CONVEYANCE SWALES OR PROVIDE FINE GRADING THAT DISRUPTS FLOW OR CHANGES LONGITUDINAL SLOPES.
- PLANT THE OUTER EDGES OF EACH PLANTING GROUP FOLLOWING THE BED OUTLINE ACCORDING TO THE PLAN. ONCE A SATISFACTORY MATCHED OUTER SHAPE IS OBTAINED, FILL THE CENTER OF EACH AREA WITH PLANTS ACCORDING TO THE PLAN AND SPACING NOTES.
- THE PLANTING LAYOUT WITHIN PLANTING BEDS SHOULD BE SHIFTED TO MINIMIZE CONFLICTS WITH EXISTING TREE ROOTS.
- DISTURBED EARTH AREAS BEYOND PROJECT LIMITS THAT ARE DIRECTLY CAUSED BY CONTRACTOR MEANS AND METHODS SHALL BE RESTORED WITH TURF SOD, UNLESS OTHERWISE NOTED.
- PARKING LOT ISLANDS ARE MULCHED WITH 4" DEEP HARDWOOD MULCH.
- REFER TO PROJECT MANUAL FOR ADDITIONAL REQUIREMENTS.

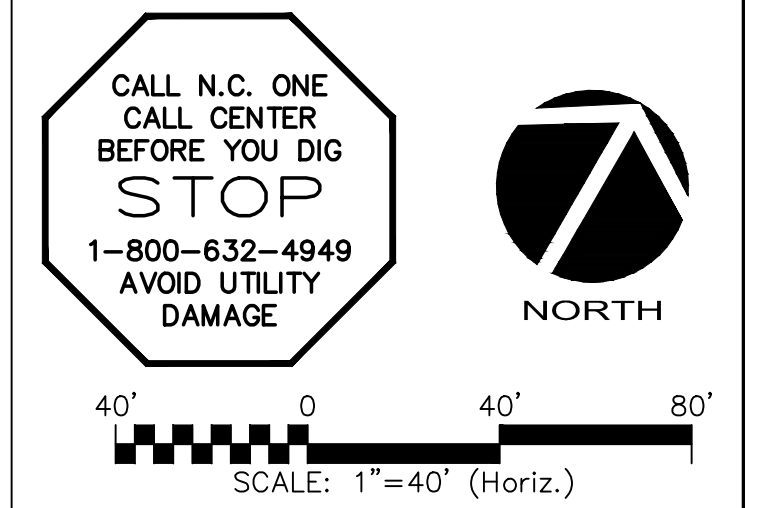

**PRELIMINARY**  
DO NOT USE FOR CONSTRUCTION

REV. NO.	DESCRIPTION	DATE
A	CHATHAM COUNTY APPEARANCE COMMITTEE	2020.10.20

SEAL

PRELIMINARY PLAN  
FOR REVIEW PURPOSES ONLY

COMMERCIAL PROPERTIES INC.  
BRIAR CHAPEL SD WEST  
CHATHAM COUNTY, NORTH CAROLINA

**LANDSCAPING PLAN**

DATE: OCTOBER 20, 2020	SCALE: L1.X	MISC. FILE NUMBER: L1.2
MCE PROJ. # 00741-0011	HORIZONTAL: 1"=40'	REVISION: A
DRAWN: ENS	VERTICAL: N/A	
DESIGNED: DJB		
CHECKED: DJB		
PROJ. MGR.: GCA		

STATUS: PRELIMINARY LAYOUT NOT TO BE USED FOR CONSTRUCTION





PLANTING BED: 2100 SF  
SHRUBS: 750 SF/ 80 QTY  
GRASSES: 1350SF/ 240 QTY

PLANTING BED: 1950 SF  
SHRUBS: 750 SF/ 80 QTY  
GRASSES: 1200SF/ 216 QTY

PLANTING BED: 1450 SF  
SHRUBS: 750 SF/ 80 QTY  
GRASSES: 700SF/ 126 QTY

PLANTING BED: 1900 SF  
SHRUBS: 550 SF/ 60 QTY  
GRASSES: 1350SF/ 240 QTY

LAWN  
15 FLOWERING TREES

PLANTING BED: 1300 SF  
SHRUBS: 550 SF/ 60 QTY  
GRASSES: 800SF/ 150 QTY

PLANTING BED: 1300 SF  
SHRUBS: 550 SF/ 60 QTY  
GRASSES: 800SF/ 150 QTY

PLANTING BED: 1600 SF  
SHRUBS: 550 SF/ 60 QTY  
GRASSES: 1050SF/ 190 QTY

2 CANOPY TREES  
3 EVERGREEN TREES  
PINES  
CEDARS  
13 FLOWERING TREES

PLANTING BED: 1900 SF  
SHRUBS: 550 SF/ 60 QTY  
GRASSES: 1350SF/ 240 QTY

LAWN

PLANTING BED: 1800 SF  
SHRUBS: 450 SF/ 50 QTY  
GRASSES: 1350SF/ 240 QTY

5 CANOPY TREES

PLANTING BED: 2200 SF  
SHRUBS: 850 SF/ 100 QTY  
GRASSES: 1350SF/ 240 QTY

PLANTING BED: 1500 SF  
SHRUBS: 750 SF/ 80 QTY  
GRASSES: 750SF/ 130 QTY

PLANTING BED: 1200 SF  
SHRUBS: 750 SF/ 80 QTY  
GRASSES: 450SF/ 85 QTY

PLANTING BED: 1200 SF  
SHRUBS: 450 SF/ 50 QTY  
GRASSES: 750SF/ 130 QTY

1 CANOPY TREE

LAWN  
3 EVERGREEN TREES  
PINES  
CEDARS

14 FLOWERING TREES  
3 EVERGREEN TREES  
PINES  
CEDARS

14 EVERGREEN TREES  
PINES  
CEDARS

LAWN

7 FLOWERING TREES

PLANTING BED: 2000 SF  
SHRUBS: 650 SF/ 70 QTY  
GRASSES: 1350SF/ 240 QTY

PLANTING BED: 1800 SF  
SHRUBS: 450 SF / 50 QTY  
GRASSES: 1350SF/ 240 QTY

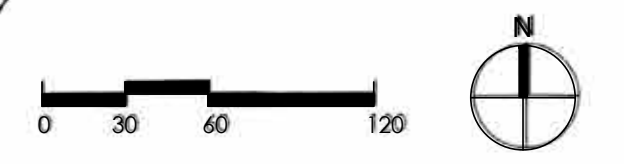



CONSULTANTS

REGISTRATION

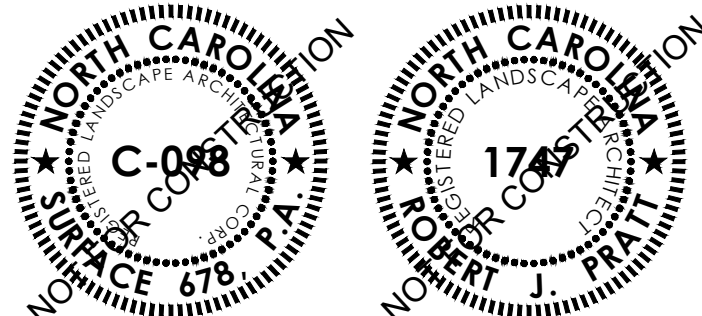

CLIENT



VIEWSHED CORRIDOR

15/501 BRIAR CHAPEL  
SD WEST  
COMMERCIAL

KEY MAP

NO.	REVISION	DATE

ISSUE:

PROJECT NO: A0000  
DATE: SEP 27, 2017  
DRAWN: BB, RP  
CHECKED: RP

PLANTING PLAN

L161

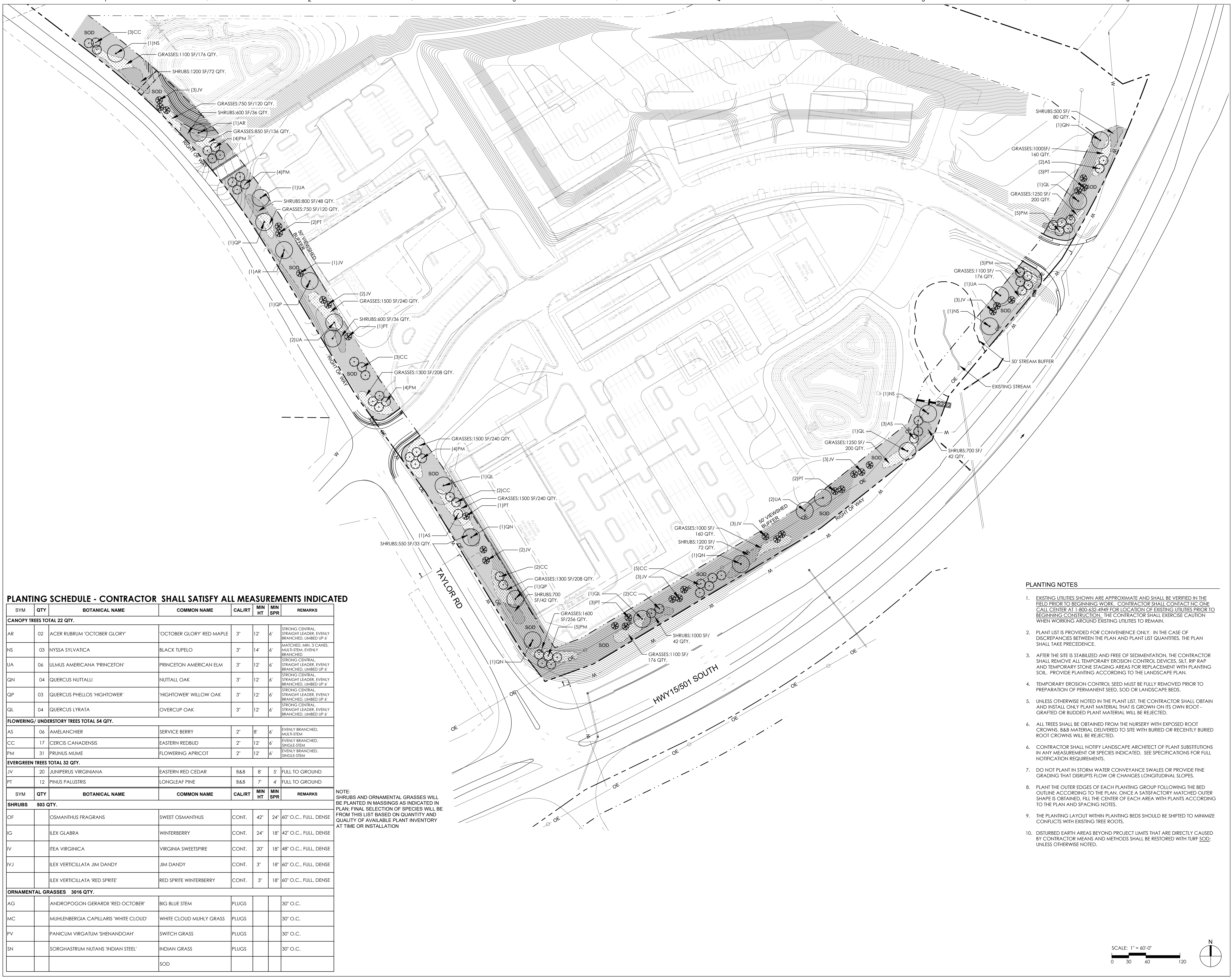

PLANTING SCHEDULE - CONTRACTOR SHALL SATISFY ALL MEASUREMENTS INDICATED

SYM	QTY	BOTANICAL NAME	COMMON NAME	CAL/RT	MIN HT	MIN SPR	REMARKS
<b>CANOPY TREES TOTAL 22 QTY.</b>							
AR	02	ACER RUBRUM 'OCTOBER GLORY'	'OCTOBER GLORY' RED MAPLE	3"	12'	6'	STRONG CENTRAL STRAIGHT LEADER, EVENLY BRANCHED, LIMBED UP 6'
NS	03	NYSSA SYLVATICA	BLACK TUPELO	3"	14'	6'	MATCHED, MIN. 3 CANES, MULTI-STEM, EVENLY BRANCHED
UA	06	ULMUS AMERICANA 'PRINCETON'	PRINCETON AMERICAN ELM	3"	12'	6'	STRONG CENTRAL STRAIGHT LEADER, EVENLY BRANCHED, LIMBED UP 6'
QN	04	QUERCUS NUTTALLI	NUTTALL OAK	3"	12'	6'	STRONG CENTRAL STRAIGHT LEADER, EVENLY BRANCHED, LIMBED UP 6'
QP	03	QUERCUS PHELLOS 'HIGHTOWER'	'HIGHTOWER' WILLOW OAK	3"	12'	6'	STRONG CENTRAL STRAIGHT LEADER, EVENLY BRANCHED, LIMBED UP 6'
QL	04	QUERCUS LYRATA	OVERCUP OAK	3"	12'	6'	STRONG CENTRAL STRAIGHT LEADER, EVENLY BRANCHED, LIMBED UP 6'
<b>FLOWERING/ UNDERSTORY TREES TOTAL 54 QTY.</b>							
AS	06	AMELANCHIER	SERVICE BERRY	2"	8'	6'	EVENLY BRANCHED, MULTI-STEM
CC	17	CERCIS CANADENSIS	EASTERN REDBUD	2"	12'	6'	EVENLY BRANCHED, SINGLE STEM
PM	31	PRINUS MUME	FLOWERING APRICOT	2"	12'	6'	EVENLY BRANCHED, SINGLE STEM
<b>EVERGREEN TREES TOTAL 32 QTY.</b>							
JV	20	JUNIPERUS VIRGINIANA	EASTERN RED CEDAR	B&B	8'	5'	FULL TO GROUND
PT	12	PINUS PALUSTRIS	LONGLEAF PINE	B&B	7'	4'	FULL TO GROUND
SYM	QTY	BOTANICAL NAME	COMMON NAME	CAL/RT	MIN HT	MIN SPR	REMARKS
<b>SHRUBS 503 QTY.</b>							
OF		OSMANTHUS FRAGRANS	SWEET OSMANTHUS	CONT.	42"	24"	60" O.C., FULL DENSE
IG		ILEX GLABRA	WINTERBERRY	CONT.	24"	18"	42" O.C., FULL DENSE
IV		ITEA VIRGINICA	VIRGINIA SWEETSPICE	CONT.	20"	18"	48" O.C., FULL DENSE
IVJ		ILEX VERTICILLATA 'JIM DANDY'	JIM DANDY	CONT.	3"	18"	60" O.C., FULL DENSE
		ILEX VERTICILLATA 'RED SPRITE'	RED SPRITE WINTERBERRY	CONT.	3"	18"	60" O.C., FULL DENSE
<b>ORNAMENTAL GRASSES 3016 QTY.</b>							
AG		ANDROPOGON GERARDII 'RED OCTOBER'	BIG BLUE STEM	PLUGS			30" O.C.
MC		MUHLENBERGIA CAPILLARIS 'WHITE CLOUD'	WHITE CLOUD MUHLY GRASS	PLUGS			30" O.C.
PV		PANICUM VIRGATUM 'SHENANDOAH'	SWITCH GRASS	PLUGS			30" O.C.
SN		SORGHASTRUM NUTANS 'INDIAN STEEL'	INDIAN GRASS	PLUGS			30" O.C.
		SOD					

NOTE: SHRUBS AND ORNAMENTAL GRASSES WILL BE PLANTED IN MASSINGS AS INDICATED IN PLAN. FINAL SELECTION OF SPECIES WILL BE FROM THIS LIST BASED ON QUANTITY AND QUALITY OF AVAILABLE PLANT INVENTORY AT TIME OF INSTALLATION

PLANTING NOTES

- EXISTING UTILITIES SHOWN ARE APPROXIMATE AND SHALL BE VERIFIED IN THE FIELD PRIOR TO BEGINNING WORK. CONTRACTOR SHALL CONTACT NC ONE CALL CENTER AT 1-800-432-4949 FOR LOCATION OF EXISTING UTILITIES PRIOR TO BEGINNING CONSTRUCTION. THE CONTRACTOR SHALL EXERCISE CAUTION WHEN WORKING AROUND EXISTING UTILITIES TO REMAIN.
- PLANT LIST IS PROVIDED FOR CONVENIENCE ONLY. IN THE CASE OF DISCREPANCIES BETWEEN THE PLAN AND PLANT LIST QUANTITIES, THE PLAN SHALL TAKE PRECEDENCE.
- AFTER THE SITE IS STABILIZED AND FREE OF SEDIMENTATION, THE CONTRACTOR SHALL REMOVE ALL TEMPORARY EROSION CONTROL DEVICES, SILT, RIP RAP AND TEMPORARY STONE STAGING AREAS FOR REPLACEMENT WITH PLANTING SOIL. PROVIDE PLANTING ACCORDING TO THE LANDSCAPE PLAN.
- TEMPORARY EROSION CONTROL SEED MUST BE FULLY REMOVED PRIOR TO PREPARATION OF PERMANENT SEED, SOD OR LANDSCAPE BEDS.
- UNLESS OTHERWISE NOTED IN THE PLANT LIST, THE CONTRACTOR SHALL OBTAIN AND INSTALL ONLY PLANT MATERIAL THAT IS GROWN ON ITS OWN ROOT - GRAFTED OR BUDDED PLANT MATERIAL WILL BE REJECTED.
- ALL TREES SHALL BE OBTAINED FROM THE NURSERY WITH EXPOSED ROOT CROWNS. B&B MATERIAL DELIVERED TO SITE WITH BURIED OR RECENTLY BURIED ROOT CROWNS WILL BE REJECTED.
- CONTRACTOR SHALL NOTIFY LANDSCAPE ARCHITECT OF PLANT SUBSTITUTIONS IN ANY MEASUREMENT OR SPECIES INDICATED. SEE SPECIFICATIONS FOR FULL NOTIFICATION REQUIREMENTS.
- DO NOT PLANT IN STORM WATER CONVEYANCE SWALES OR PROVIDE FINE GRADING THAT DISRUPTS FLOW OR CHANGES LONGITUDINAL SLOPES.
- PLANT THE OUTER EDGES OF EACH PLANTING GROUP FOLLOWING THE BED OUTLINE ACCORDING TO THE PLAN. ONCE A SATISFACTORY MATCHED OUTER SHAPE IS OBTAINED, FILL THE CENTER OF EACH AREA WITH PLANTS ACCORDING TO THE PLAN AND SPACING NOTES.
- THE PLANTING LAYOUT WITHIN PLANTING BEDS SHOULD BE SHIFTED TO MINIMIZE CONFLICTS WITH EXISTING TREE ROOTS.
- DISTURBED EARTH AREAS BEYOND PROJECT LIMITS THAT ARE DIRECTLY CAUSED BY CONTRACTOR MEANS AND METHODS SHALL BE RESTORED WITH TURF SOD, UNLESS OTHERWISE NOTED.

