

1
SS-1

SITE OVERVIEW

SCALE: 1" = 500'-0"

NO.	DATE	REVISION
90%	03/30/2020	90% SITE SKETCH
95%	04/01/2020	95% SITE SKETCH
100%	04/15/2020	100% SITE SKETCH

KCI
TECHNOLOGIES

4505 FALLS OF NEUSE RD.,
SUITE 400
RALEIGH, NORTH CAROLINA 27609
(919) 783-9214
ENGINEERS • PLANNERS • ECOLOGISTS

MOTOROLA SOLUTIONS

MOTOROLA SOLUTIONS, INC.
8720 RED OAK BLVD., SUITE 123
CHARLOTTE, NC 28217

CONTACT: HEATHER MASON
PHONE: (513) 470-6238

**CHATHAM COUNTY EMERGENCY
OPERATION CENTER TOWER**

COUNTY SERVICES RD.
PITTSBORO, NC 27312
CHATHAM COUNTY, NC

DATE OF ORIGATION : 03/01/2020

DRAWN BY : TNW APPROVED BY :

CHECKED BY : KCI# : 011904897_x



CHATHAM COUNTY, NC
PLANNING DEPARTMENT
80-A EAST STREET.
PITTSBORO, NC 27312
(919) 542-8204

SITE OVERVIEW

SS-1

SEAL:



COUNTY LANDFILL RD. / RENAISSANCE DR.

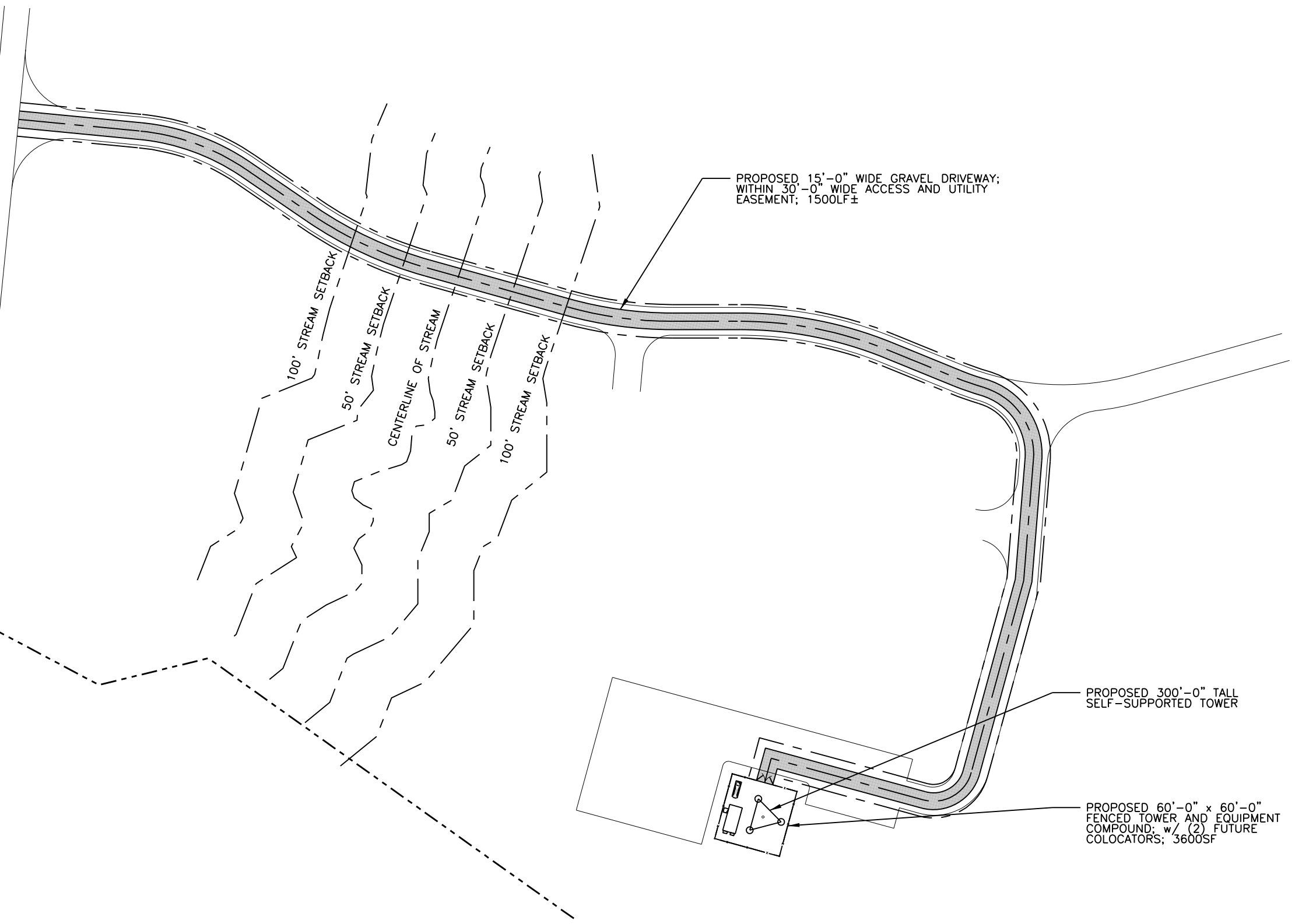

1
SS-2

SITE PLAN

SCALE: 1" = 100'-0"

NO.	DATE	REVISION
90%	03/30/2020	90% SITE SKETCH
95%	04/01/2020	95% SITE SKETCH
100%	04/15/2020	100% SITE SKETCH

KCI
TECHNOLOGIES

4505 FALLS OF NEUSE RD.,
SUITE 400
RALEIGH, NORTH CAROLINA 27609
(919) 783-9214
ENGINEERS • PLANNERS • ECOLOGISTS

MOTOROLA SOLUTIONS

MOTOROLA SOLUTIONS, INC.
8720 RED OAK BLVD., SUITE 123
CHARLOTTE, NC 28217

CONTACT: HEATHER MASON
PHONE: (513) 470-6238

**CHATHAM COUNTY EMERGENCY
OPERATION CENTER TOWER**

COUNTY SERVICES RD.
PITTSBORO, NC 27312
CHATHAM COUNTY, NC

DATE OF ORIGATION : 03/01/2020

DRAWN BY : TNW APPROVED BY :

CHECKED BY : KCI# : 011904897_x



CHATHAM COUNTY, NC
PLANNING DEPARTMENT
80-A EAST STREET.
PITTSBORO, NC 27312
(919) 542-8204

SITE PLAN

SS-2

SEAL:

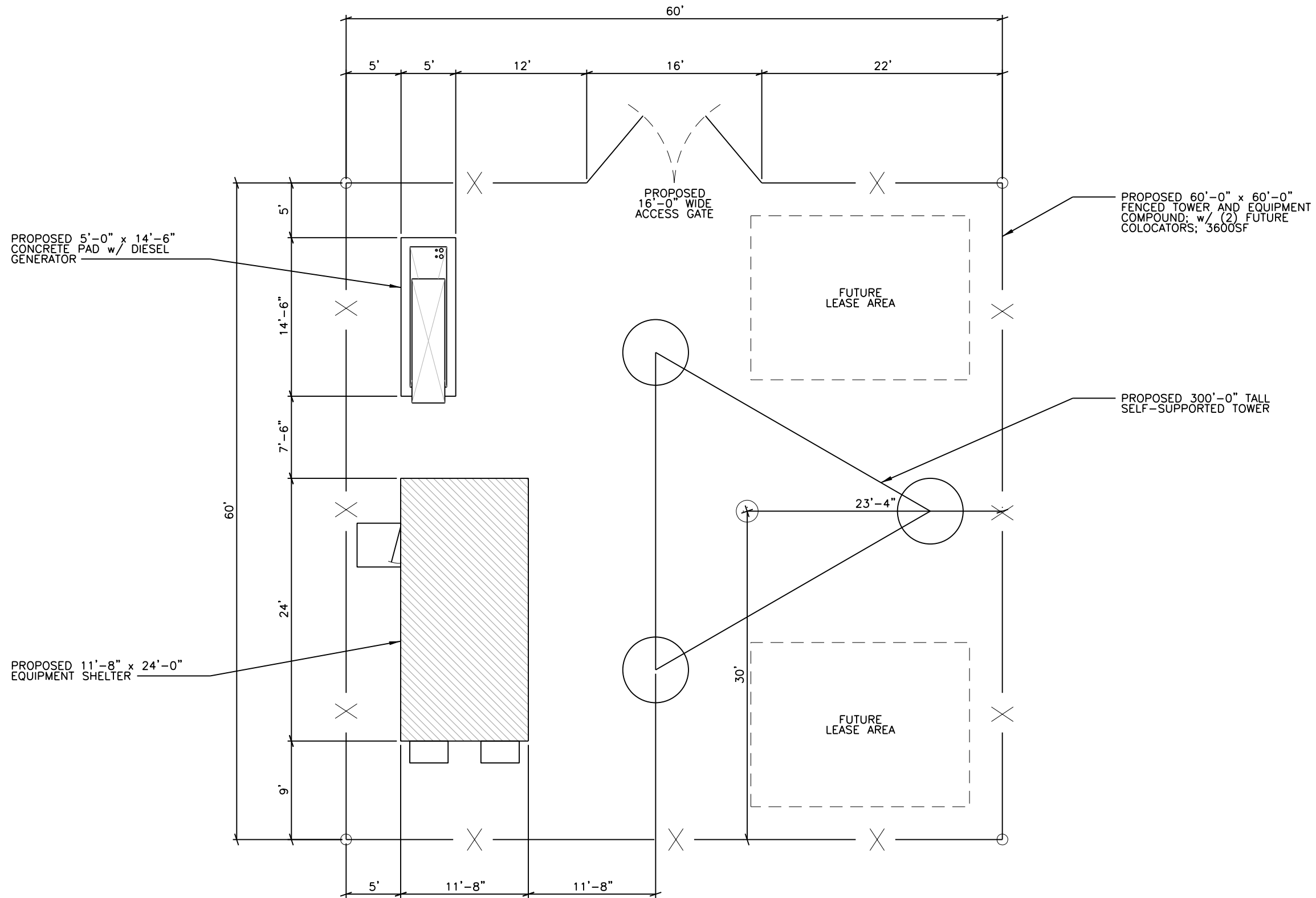

1
SS-3

SITE DETAIL

SCALE: 1" = 10'-0"

NO.	DATE	REVISION
90%	03/30/2020	90% SITE SKETCH
95%	04/01/2020	95% SITE SKETCH
100%	04/15/2020	100% SITE SKETCH

KCI
TECHNOLOGIES

4505 FALLS OF NEUSE RD.,
SUITE 400
RALEIGH, NORTH CAROLINA 27609
(919) 783-9214
ENGINEERS • PLANNERS • ECOLOGISTS

MOTOROLA SOLUTIONS

MOTOROLA SOLUTIONS, INC.
8720 RED OAK BLVD., SUITE 123
CHARLOTTE, NC 28217

CONTACT: HEATHER MASON
PHONE: (513) 470-6238

**CHATHAM COUNTY EMERGENCY
OPERATION CENTER TOWER**

COUNTY SERVICES RD.
PITTSBORO, NC 27312
CHATHAM COUNTY, NC

DATE OF ORIGATION : 03/01/2020

DRAWN BY : TNW APPROVED BY :

CHECKED BY : KCI# : 011904897_x



CHATHAM COUNTY, NC
PLANNING DEPARTMENT
80-A EAST STREET.
PITTSBORO, NC 27312
(919) 542-8204

SITE DETAIL

SS-3

SEAL: