

FINAL MASTER PLAN

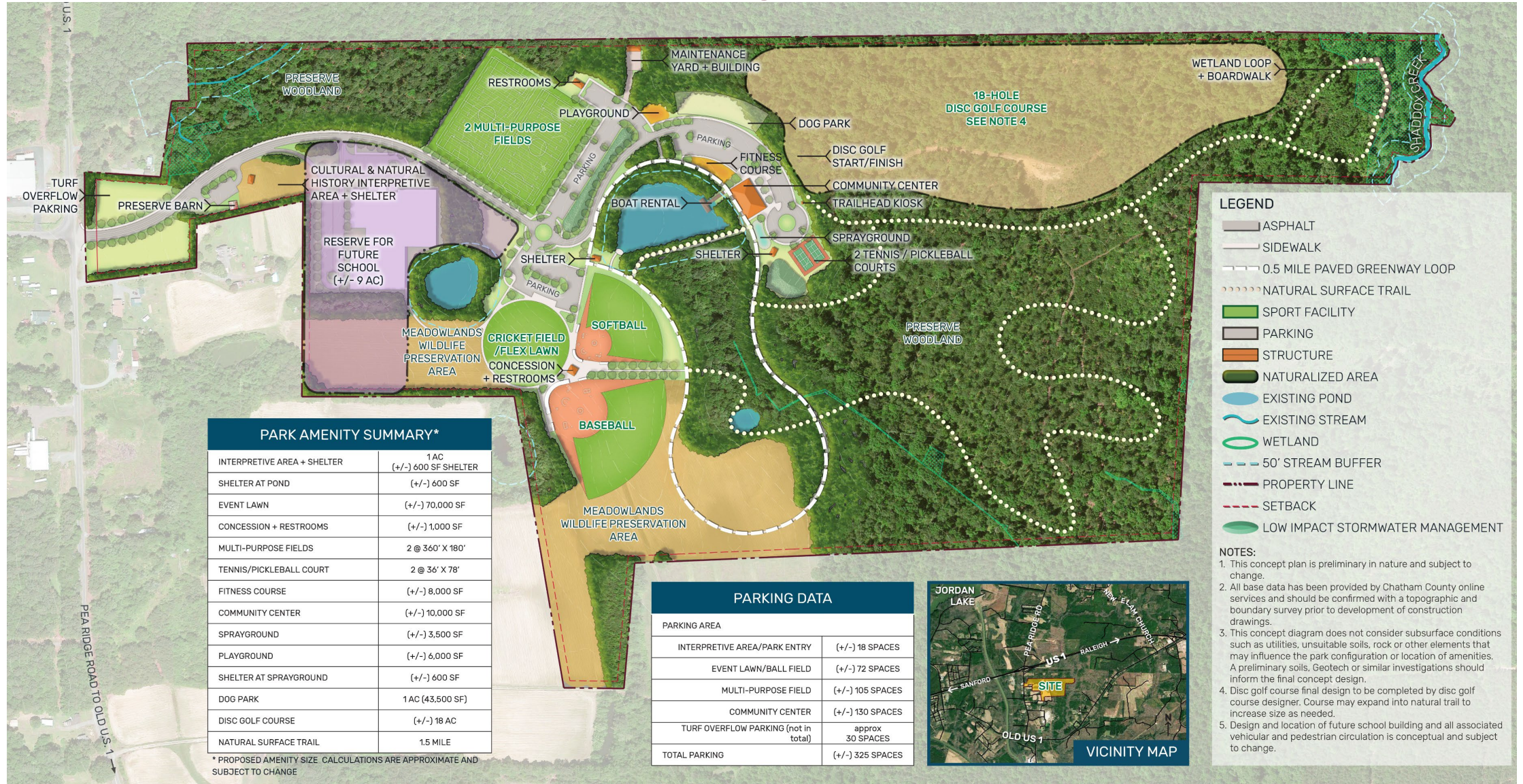

LEGEND

- ASPHALT
- SIDEWALK
- 0.5 MILE PAVED GREENWAY LOOP
- NATURAL SURFACE TRAIL
- SPORT FACILITY
- PARKING
- STRUCTURE
- NATURALIZED AREA
- EXISTING POND
- EXISTING STREAM
- WETLAND
- 50' STREAM BUFFER
- PROPERTY LINE
- SETBACK
- LOW IMPACT STORMWATER MANAGEMENT

PARK AMENITY SUMMARY*

INTERPRETIVE AREA + SHELTER	1 AC (+/-) 600 SF SHELTER
SHELTER AT POND	(+/-) 600 SF
EVENT LAWN	(+/-) 70,000 SF
CONCESSION + RESTROOMS	(+/-) 1,000 SF
MULTI-PURPOSE FIELDS	2 @ 360' X 180'
TENNIS/PICKLEBALL COURT	2 @ 36' X 78'
FITNESS COURSE	(+/-) 8,000 SF
COMMUNITY CENTER	(+/-) 10,000 SF
SPRAYGROUND	(+/-) 3,500 SF
PLAYGROUND	(+/-) 6,000 SF
SHELTER AT SPRAYGROUND	(+/-) 600 SF
DOG PARK	1 AC (43,500 SF)
DISC GOLF COURSE	(+/-) 18 AC
NATURAL SURFACE TRAIL	1.5 MILE

* PROPOSED AMENITY SIZE CALCULATIONS ARE APPROXIMATE AND SUBJECT TO CHANGE

PARKING DATA

PARKING AREA	
INTERPRETIVE AREA/PARK ENTRY	(+/-) 18 SPACES
EVENT LAWN/BALL FIELD	(+/-) 72 SPACES
MULTI-PURPOSE FIELD	(+/-) 105 SPACES
COMMUNITY CENTER	(+/-) 130 SPACES
TURF OVERFLOW PARKING (not in total)	approx 30 SPACES
TOTAL PARKING	(+/-) 325 SPACES



- NOTES:**
- This concept plan is preliminary in nature and subject to change.
 - All base data has been provided by Chatham County online services and should be confirmed with a topographic and boundary survey prior to development of construction drawings.
 - This concept diagram does not consider subsurface conditions such as utilities, unsuitable soils, rock or other elements that may influence the park configuration or location of amenities. A preliminary soils, Geotech or similar investigations should inform the final concept design.
 - Disc golf course final design to be completed by disc golf course designer. Course may expand into natural trail to increase size as needed.
 - Design and location of future school building and all associated vehicular and pedestrian circulation is conceptual and subject to change.