

Vicinity Map

NOTE:
BASE INFORMATION TAKEN FROM CHATHAM COUNTY GIS,
SAGE ECOLOGICAL SERVICES, INC - 919.335.6757,
AND A SURVEY BY:
MIKE CAIN SURVEYING
2509 PIEDMONT DR
SANFORD, NC 27330
919.774.4684

TITLED:
SURVEY FOR:
ROBERT E. MCLEAN AND WIFE,
WENDY MCLEAN AND
LINDA M. WALLS AND HUSBAND,
GRAY WALLS

DATED: 04/25/2003

RECORDED: BOOK 2003/PAGE 233
CHATHAM COUNTY REGISTER OF DEEDS

TALMAGE "MARK" HALL, ASLA ASSUMES NO RESPONSIBILITY
OR LIABILITY FOR THE ACCURACY OF THIS INFORMATION



SITE INFORMATION

1. OWNER: ROBERT E. MCLEAN & LINDA M. WALLS
6139 LOWER MONCURE RD
SANFORD, NC 27330

2. DEVELOPER/APPLICANT: HARRIS LAKE BOAT STORAGE, LLC
8712 HOLLY SPRINGS RD
APEX, NC 27539
(919) 363-8878

3. SITE ADDRESS: DICKENS RD & NC HWY 42
CHATHAM COUNTY, NC

4. PARCEL #: 0080765
5. P.L.N.: 0606 00 03 9766
6. TOTAL ACREAGE = ±15.52 AC ±676,051 SF
7. EXISTING ZONING: R-1
8. PROPOSED ZONING: CD-CB COMMUNITY BUSINESS
9. TOWNSHIP: CAPE FEAR
10. CURRENT USE: VACANT/WOODED
11. PROPOSED USE: INDOOR STORAGE FOR ANYTHING OTHER THAN ILLEGAL OR HAZARDOUS MATERIALS. OUTDOOR STORAGE FOR BOATS, RV'S, TRAILERS, CAMPERS, VEHICLES AND MOST ANYTHING ON WHEELS. OUTDOOR STORAGE FOR MOBILE STORAGE UNITS. FUTURE BUILDINGS WILL INCLUDE AN OFFICE FOR RETAIL SALES, UHAUL RENTALS AND SALES AND RENTALS OF BOATS.

12. THE SUBJECT PROPERTY IS NOT LOCATED IN A FLOOD HAZARD AREA AS PER FEMA FLOOD MAP # 3720060600K DATED 02/02/2007

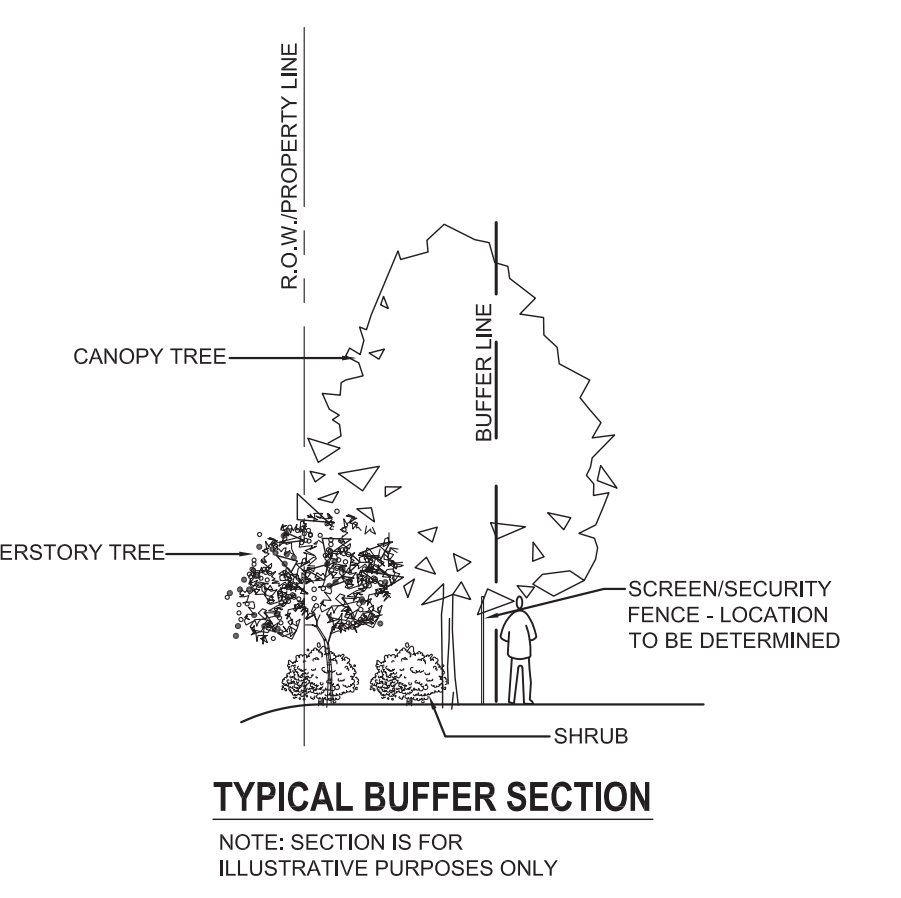
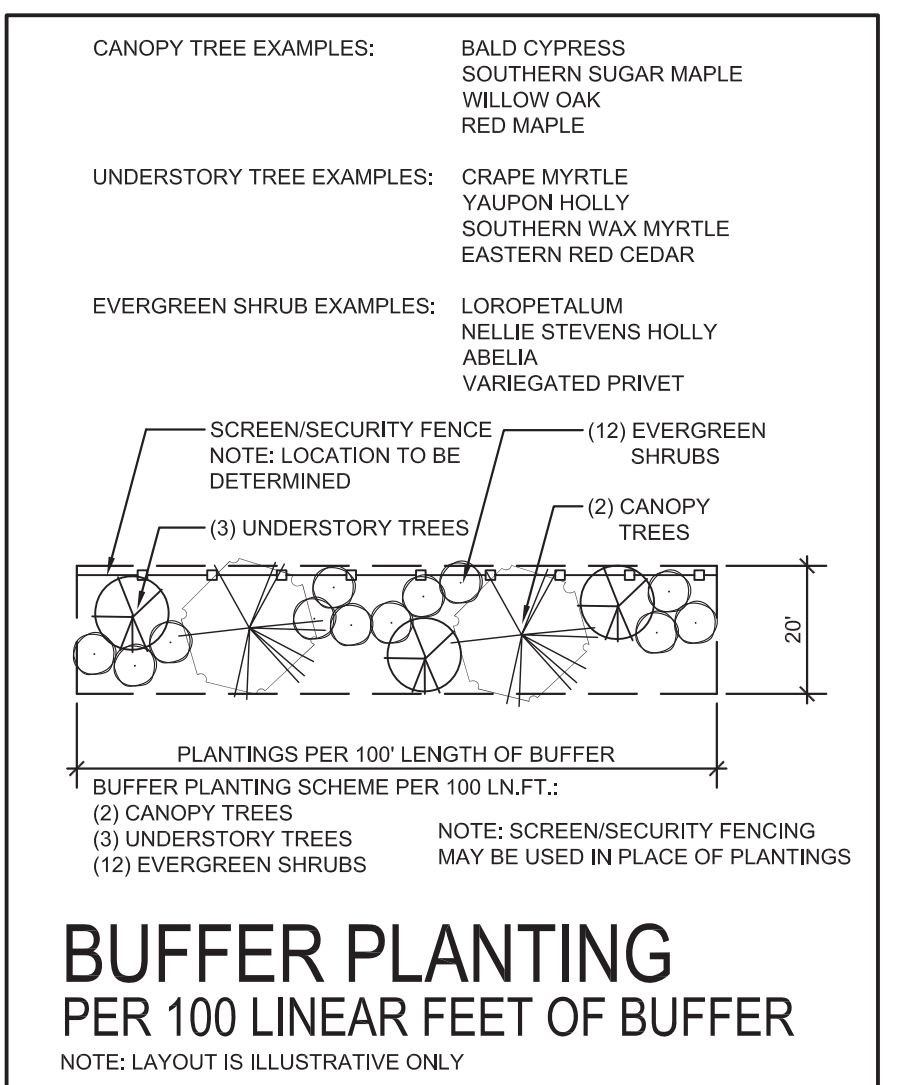

NOTE:
CONFIGURATION OF OUTDOOR PARKING/STORAGE MAY CHANGE BUT INGRESS/EGRESS TO THE SITE FOR EMERGENCY VEHICLES WILL BE MAINTAINED AS PER COUNTY STANDARDS & REQUIREMENTS

NOTE:
PHASE 1 WILL CONSIST OF THE BUILDING SHOWN WITH OUTDOOR PARKING/STORAGE IN IT'S IMMEDIATE VICINITY. FUTURE ADDITIONAL BUILDINGS WILL BE CONSTRUCTED AS NEEDED TO ACCOMMODATE DEMAND

EXHIBIT "A" CONCEPTUAL SITE PLAN

IMPERVIOUS SURFACES
BUILDING AREA: ±138,480 SQ.FT.
GRAVEL AREA: ±334,520 SQ.FT.
TOTAL IMPERVIOUS AREA: ±473,000 SQ.FT.
AREA OF TRACT: ±676,051 SQ.FT.
% OF IMPERVIOUS COVERAGE: ±70.00%

SCALE: 1" = 60'

TALMAGE "MARK" HALL, ASLA
PROFESSIONAL LANDSCAPE ARCHITECT
talmagemark@gmail.com

REZONING EXHIBIT "A"
HARRIS LAKE STORAGE SOUTH
CAPE FEAR TOWNSHIP, CHATHAM COUNTY, NC
HARRIS LAKE BOAT STORAGE, LLC

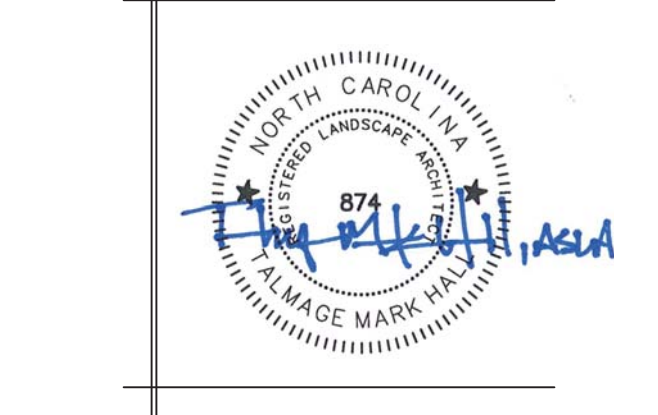

FOR REVIEW ONLY
NOT FOR
CONSTRUCTION

PROJECT:	DATE
CONCEPTUAL SITE	09.18.2019
ISSUE:	09.18.2019
REVISIONS:	
DRAWN BY:	TMH
CHECKED BY:	TMH
CONTENT:	EXHIBIT "A"
	CONCEPTUAL SITE PLAN

RZ01