

**HIGHWAY 64
BOAT AND RV STORAGE**
13144 US Hwy 64 E
Apex, NC 27502

Tract 28
AKPAR 17890
David S. Durham and
Warren D. Mitchell
DB 1788, P 686

Tract 29
AKPAR 17891
Space Station, Inc.
and
Warren D. Mitchell
DB 1852, P 368

E1

June 19, 2019
Scale: "1"=10'

**Highway 64 Boat and RV Storage
Existing Conditions**
Chatham County, North Carolina

REVISIONS



Warren D. Mitchell, PE
Civil Engineering
104 Amber Wood Run
CHAPEL HILL, NORTH CAROLINA 27516
warrendmitchellpe@gmail.com
P (919) 593-1916

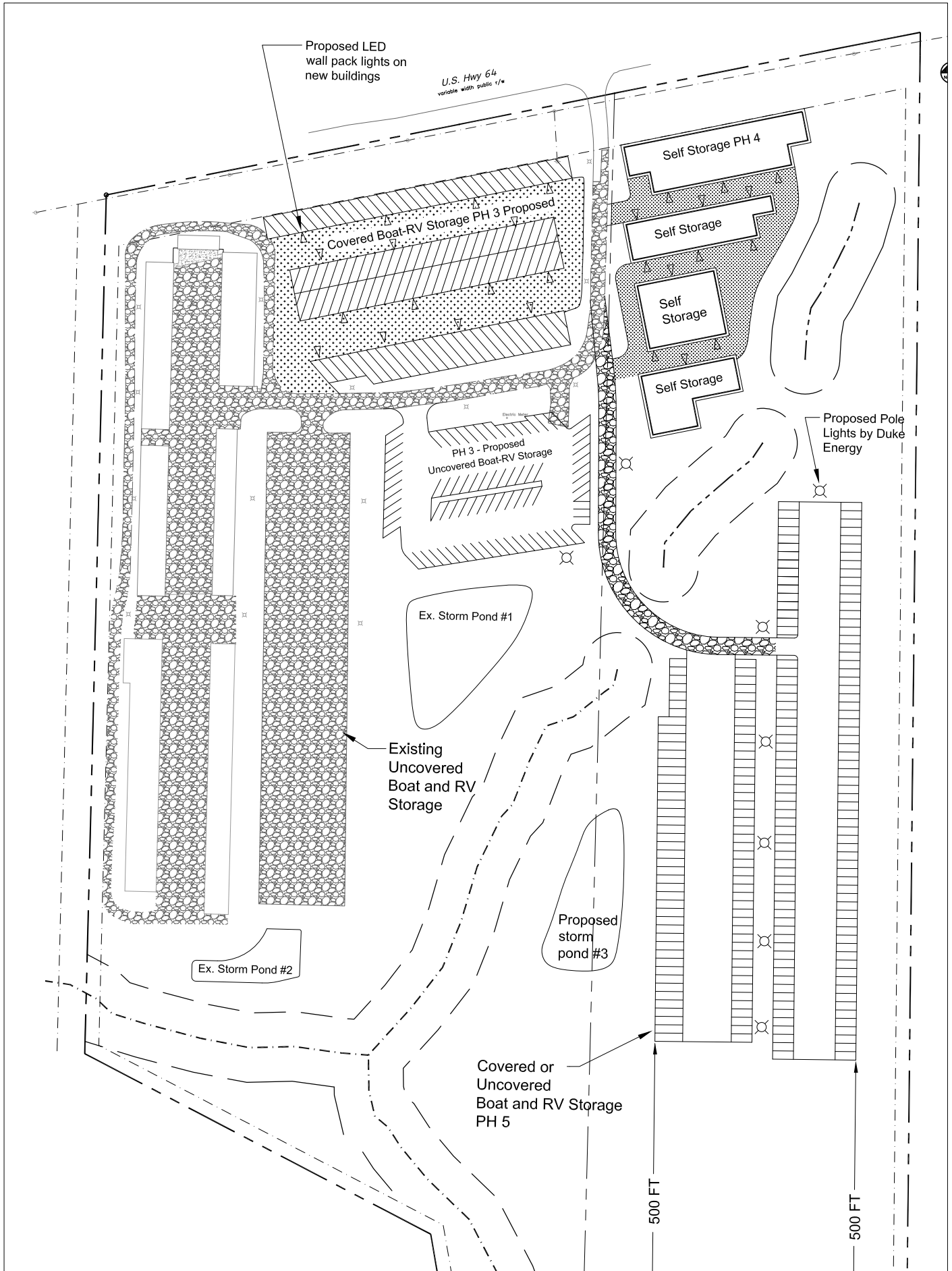

S2

Scale: T=30'
June 19, 2019

Highway 64 Boat and RV Storage Site Plan

Chatham County, North Carolina

REVISIONS

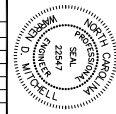

Warren D. Mitchell, PE
Civil Engineering
104 Amber Wood Run
CHAPEL HILL, NORTH CAROLINA 27516
warren@mitchellpe@gmail.com
P (919) 593-1916

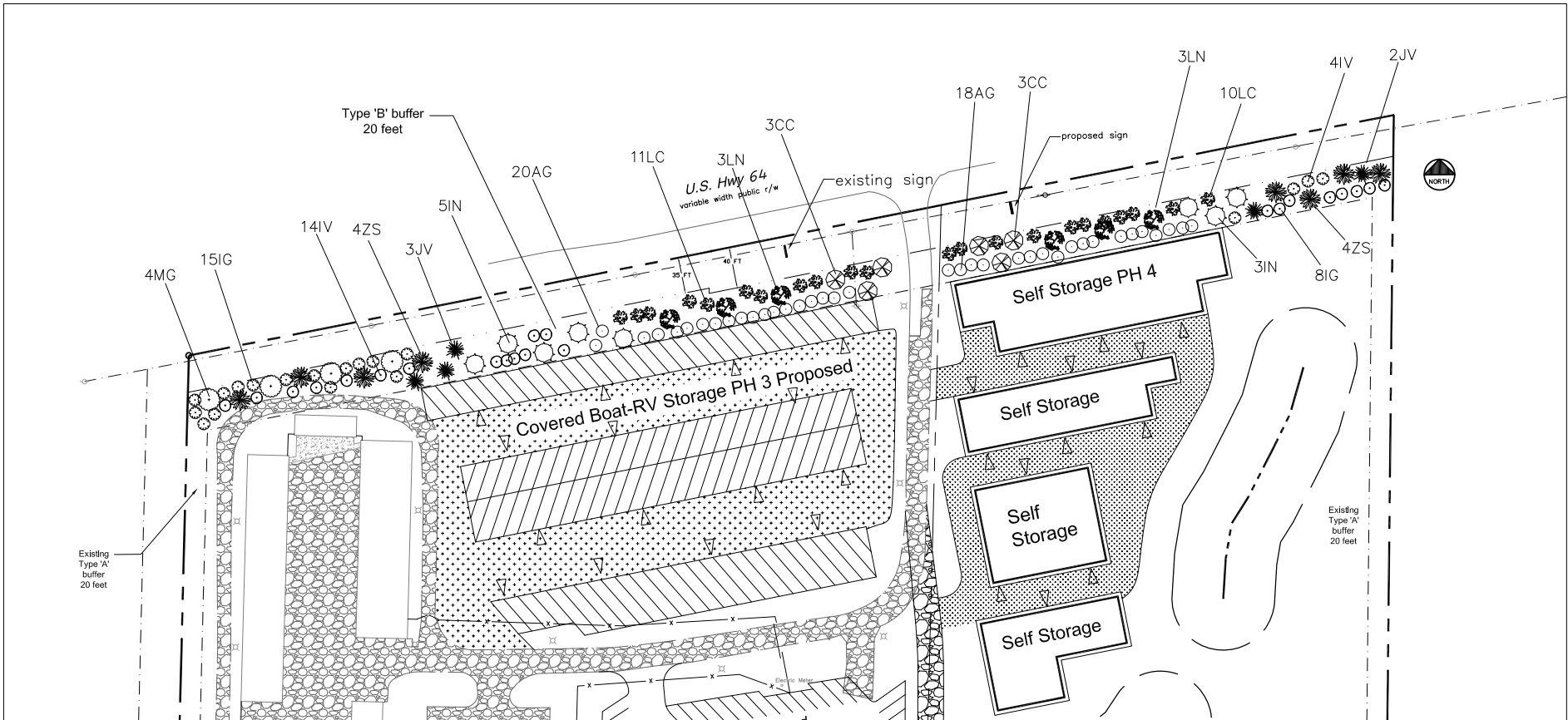

Warren D. Mitchell, PE
 Civil Engineering
 104 Amber Wood Run
 CHAPEL HILL, NORTH CAROLINA 27516
 warrenmitchellpe@gmail.com
 P (704) 398-1716



REVISIONS

Highway 64 Boat and RV Storage Landscape and Sign Plan

Chatham County, North Carolina

June 19, 2019
 Scale: 1"=50'

L3

PLANT LIST						
QTY.			BOTANICAL NAME	COMMON NAME	SIZE/CAL.	ROOT
TREES						
4	MG	☉	Magnolia Grandiflora	Southern Magnolia	10 gal/4'-6"ht	CONT
6	CC	⊗	Cercis Canadensis	Redbud	1-1/2" cal	CONT
5	JV	☀	Juniperus Virginiana	Red Cedar	10 gal/4'-6"ht	CONT
6	LN	☀	Lagerstoemia x 'Natchez'	Natchez Crape Myrtle	1-1/2" cal	CONT
8	IN	☉	Ilex Nellie R Stevens	Nellie Stevens Holly	10 gal/4'-6"ht	CONT
8	ZS	☀	Zelkova serrata	Japanese zelkova	10 gal/4'-6"ht	CONT
SHRUBS						
23	IG	☉	Ilex glabra compacta	Compact Inkberry Holly	5 gallon/24"ht	CONT
38	AG	☉	Abelia x grandiflora	Glossy Abelia	5 gallon/24"ht	CONT
21	LC	☀	Loropetalum chinensis	Chinese Fringe-flower	3 gallon/18"ht	CONT
18	IV	☉	Ilex vomitoria	Yaupon Holly	3 gallon/18"ht	CONT
BUFFER PLANTS (if necessary to supplement existing vegetation)						
20	VC	☉	Viburnum x 'Conoy'	Viburnum	5 gallon/24"ht	CONT
35	MC	☀	Myrica cerifera	Southern Waxmyrtle	5 gallon/24"ht	CONT
16	CJ	☀	Cryptomeria japonica	Japanese Cedar	5 gallon/24"ht	CONT

- Landscaping Notes:**
- Trees shall be spaced out 30 feet apart.
 - Shrubs shall be evenly distributed between trees as shown on plan.

- Lighting Notes:**
- Lighting will comply with all provisions of the Chatham County Lighting Ordinance. Specifically, the maximum light level shall be 0.5 maintained footcandle at any property line in a residential area.
- Site lights shall be wall pack style lights mounted on the storage buildings and will be full cutoff enclosed lights.
- Pole Lights will be by Duke Energy and designed by Duke Energy to meet Chatham County Lighting Ordinance.
- FIXTURES:**
- Wall packs on the one-story self-storage buildings will be mounted at a height of approximately 10 feet.
 - Wall packs mounted on the boat + RV storage buildings will be mounted at a height of 16 feet.

SIGNAGE DATA

Sign #2 (parcel B)

Signs will be internally Lit
 Frontage Length = 450 feet
 Maximum Total Sign Area = 900 SF (450 x 2)
 Freestanding Sign Area = 96 SF (8ft x 12ft)
 Freestanding Sign Height = 18 feet

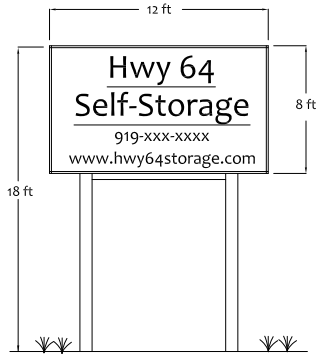

PROPOSED SIGN #2



**HWY 64
BOAT & RV**

STORAGE

www.highway64storage.com



www.hw
91

USED

**HWY 64
BOAT & RV
STORAGE**
www.highway64storage.com

**www.hv
91**

USED