



Proposed Rezoning of Parcel 65032

— Road Centerlines

Proposed Rezoning Class

-  Heavy Industrial
-  Light Industrial
-  Neighborhood Business

Prepared by the
Chatham County
Planning Department



GIS DATA DISCLAIMER
FOR CHATHAM COUNTY NC



Information contained herein is provided for informational purposes only. The County of Chatham provides geographic information systems (GIS) data, maps, and metadata with no claim as to the completeness, usefulness, or accuracy of its content, positional or otherwise. The user hereby acknowledges that the Geographic Information System (GIS) data contained on this site are subject to constant change and that its accuracy cannot be guaranteed. The County and its officials and employees make no warranty, express or implied, and assume no legal liability or responsibility for the ability of users to fulfill their intended purposes in accessing or using GIS data or metadata or for omissions in content regarding such data. The data on this site could include technical inaccuracies and typographical errors. Independent verification of all data contained herein should be obtained by users of the data. The data on this site is presented "as is," without warranty of any kind, including, but not limited to, the implied warranties of merchantability, fitness for a particular purpose, or non-infringement. Your use and browsing of information on this site is at your own risk. In providing this data or access to it, the County assumes no obligation to assist the user in the use of such data or in the development, use, or maintenance of any applications applied to or associated with the data or metadata.



Proposed Rezoning of Parcel 3416

— Road Centerlines

Proposed Rezoning Class

-  Heavy Industrial
-  Light Industrial
-  Neighborhood Business

Prepared by the
Chatham County
Planning Department



GIS DATA DISCLAIMER
FOR CHATHAM COUNTY NC



Information contained herein is provided for informational purposes only. The County of Chatham provides geographic information systems (GIS) data, maps, and metadata with no claim as to the completeness, usefulness, or accuracy of its content, positional or otherwise. The user hereby acknowledges that the Geographic Information System (GIS) data contained on this site are subject to constant change and that its accuracy cannot be guaranteed. The County and its officials and employees make no warranty, express or implied, and assume no legal liability or responsibility for the ability of users to fulfill their intended purposes in accessing or using GIS data or metadata or for omissions in content regarding such data. The data on this site could include technical inaccuracies and typographical errors. Independent verification of all data contained herein should be obtained by users of the data. The data on this site is presented "as is," without warranty of any kind, including, but not limited to, the implied warranties of merchantability, fitness for a particular purpose, or non-infringement. Your use and browsing of information on this site is at your own risk. In providing this data or access to it, the County assumes no obligation to assist the user in the use of such data or in the development, use, or maintenance of any applications applied to or associated with the data or metadata.



Proposed Rezoning of Parcel 8378

— Road Centerlines

Proposed Rezoning Class

 Heavy Industrial

 Light Industrial

 Neighborhood Business

Prepared by the
Chatham County
Planning Department



GIS DATA DISCLAIMER
FOR CHATHAM COUNTY NC



Information contained herein is provided for informational purposes only. The County of Chatham provides geographic information systems (GIS) data, maps, and metadata with no claim as to the completeness, usefulness, or accuracy of its content, positional or otherwise. The user hereby acknowledges that the Geographic Information System (GIS) data contained on this site are subject to constant change and that its accuracy cannot be guaranteed. The County and its officials and employees make no warranty, express or implied, and assume no legal liability or responsibility for the ability of users to fulfill their intended purposes in accessing or using GIS data or metadata or for omissions in content regarding such data. The data on this site could include technical inaccuracies and typographical errors. Independent verification of all data contained herein should be obtained by users of the data. The data on this site is presented "as is," without warranty of any kind, including, but not limited to, the implied warranties of merchantability, fitness for a particular purpose, or non-infringement. Your use and browsing of information on this site is at your own risk. In providing this data or access to it, the County assumes no obligation to assist the user in the use of such data or in the development, use, or maintenance of any applications applied to or associated with the data or metadata.

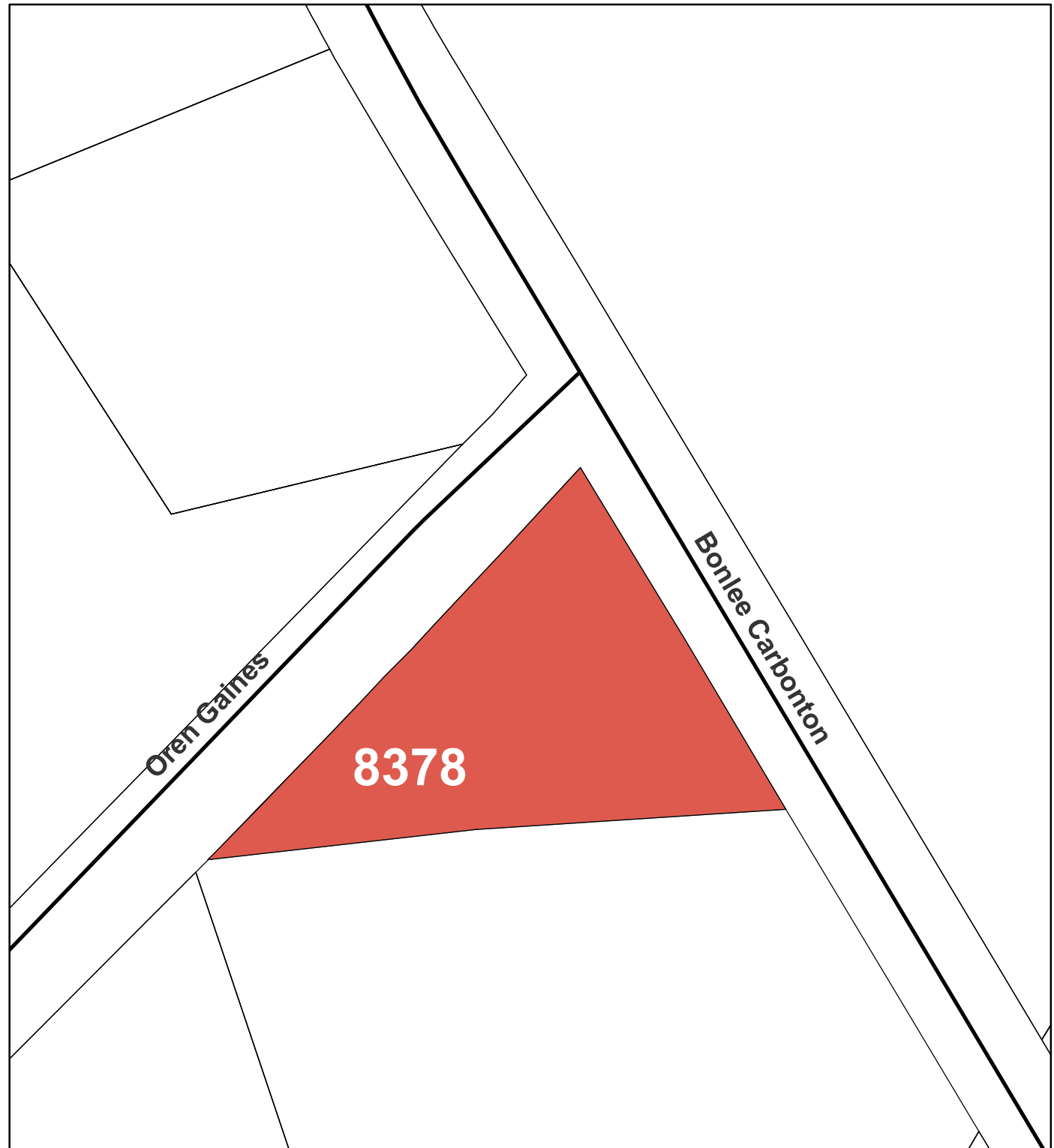

Proposed Rezoning of Parcels 73009/10670/78275

 Road Centerlines

Proposed Rezoning Class

 Heavy Industrial

 Light Industrial

 Neighborhood Business

Prepared by the
Chatham County
Planning Department



GIS DATA DISCLAIMER
FOR CHATHAM COUNTY NC



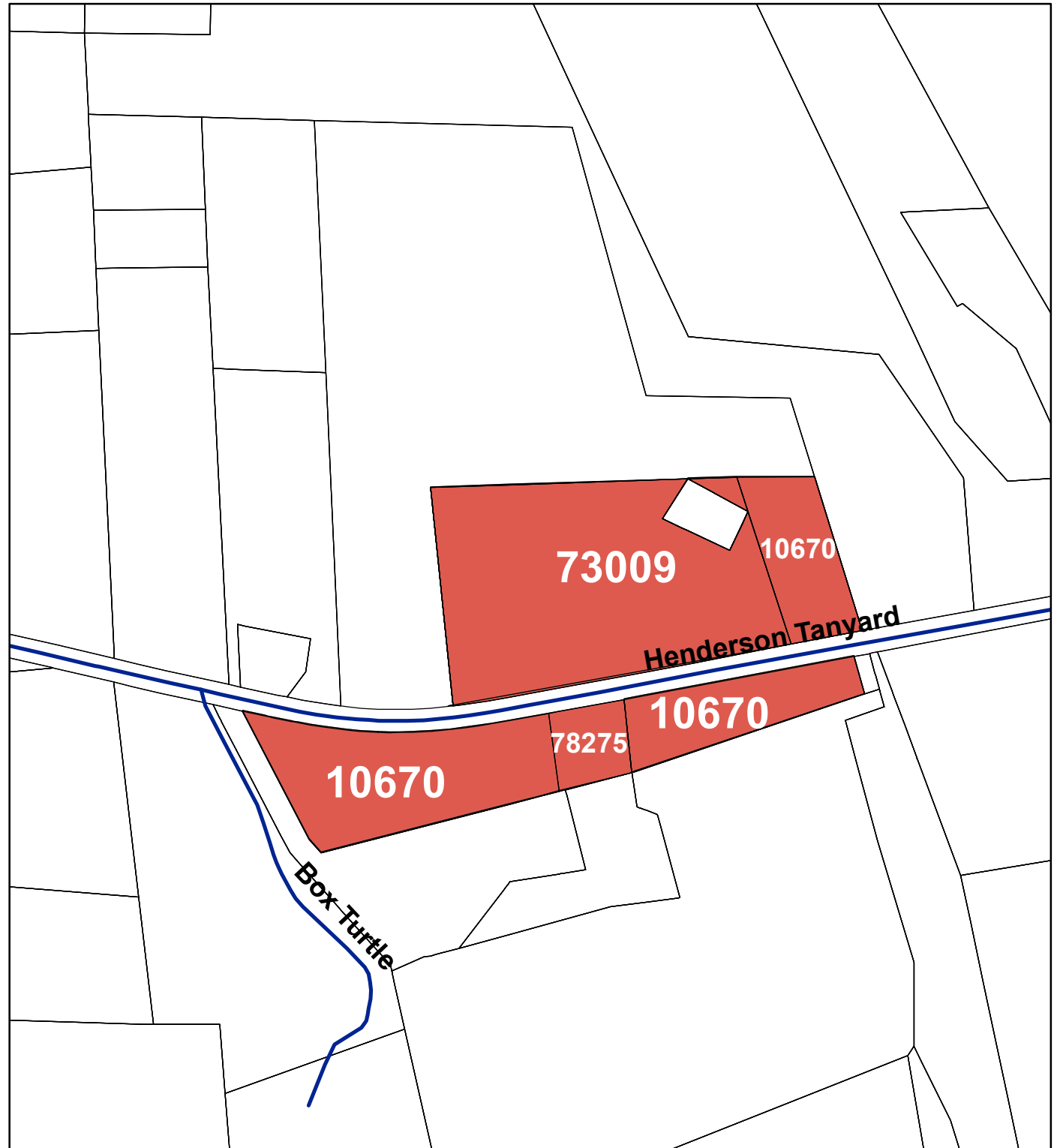

Information contained herein is provided for informational purposes only. The County of Chatham provides geographic information systems (GIS) data, maps, and metadata with no claim as to the completeness, usefulness, or accuracy of its content, positional or otherwise. The user hereby acknowledges that the Geographic Information System (GIS) data contained on this site are subject to constant change and that its accuracy cannot be guaranteed. The County and its officials and employees make no warranty, express or implied, and assume no legal liability or responsibility for the ability of users to fulfill their intended purposes in accessing or using GIS data or metadata or for omissions in content regarding such data. The data on this site could include technical inaccuracies and typographical errors. Independent verification of all data contained herein should be obtained by users of the data. The data on this site is presented "as is," without warranty of any kind, including, but not limited to, the implied warranties of merchantability, fitness for a particular purpose, or non-infringement. Your use and browsing of information on this site is at your own risk. In providing this data or access to it, the County assumes no obligation to assist the user in the use of such data or in the development, use, or maintenance of any applications applied to or associated with the data or metadata.



Proposed Rezoning of Parcel 14836

— Road Centerlines

Proposed Rezoning Class

-  Heavy Industrial
-  Light Industrial
-  Neighborhood Business

Prepared by the
Chatham County
Planning Department



GIS DATA DISCLAIMER
FOR CHATHAM COUNTY NC



Information contained herein is provided for informational purposes only. The County of Chatham provides geographic information systems (GIS) data, maps, and metadata with no claim as to the completeness, usefulness, or accuracy of its content, positional or otherwise. The user hereby acknowledges that the Geographic Information System (GIS) data contained on this site are subject to constant change and that its accuracy cannot be guaranteed. The County and its officials and employees make no warranty, express or implied, and assume no legal liability or responsibility for the ability of users to fulfill their intended purposes in accessing or using GIS data or metadata or for omissions in content regarding such data. The data on this site could include technical inaccuracies and typographical errors. Independent verification of all data contained herein should be obtained by users of the data. The data on this site is presented "as is," without warranty of any kind, including, but not limited to, the implied warranties of merchantability, fitness for a particular purpose, or non-infringement. Your use and browsing of information on this site is at your own risk. In providing this data or access to it, the County assumes no obligation to assist the user in the use of such data or in the development, use, or maintenance of any applications applied to or associated with the data or metadata.

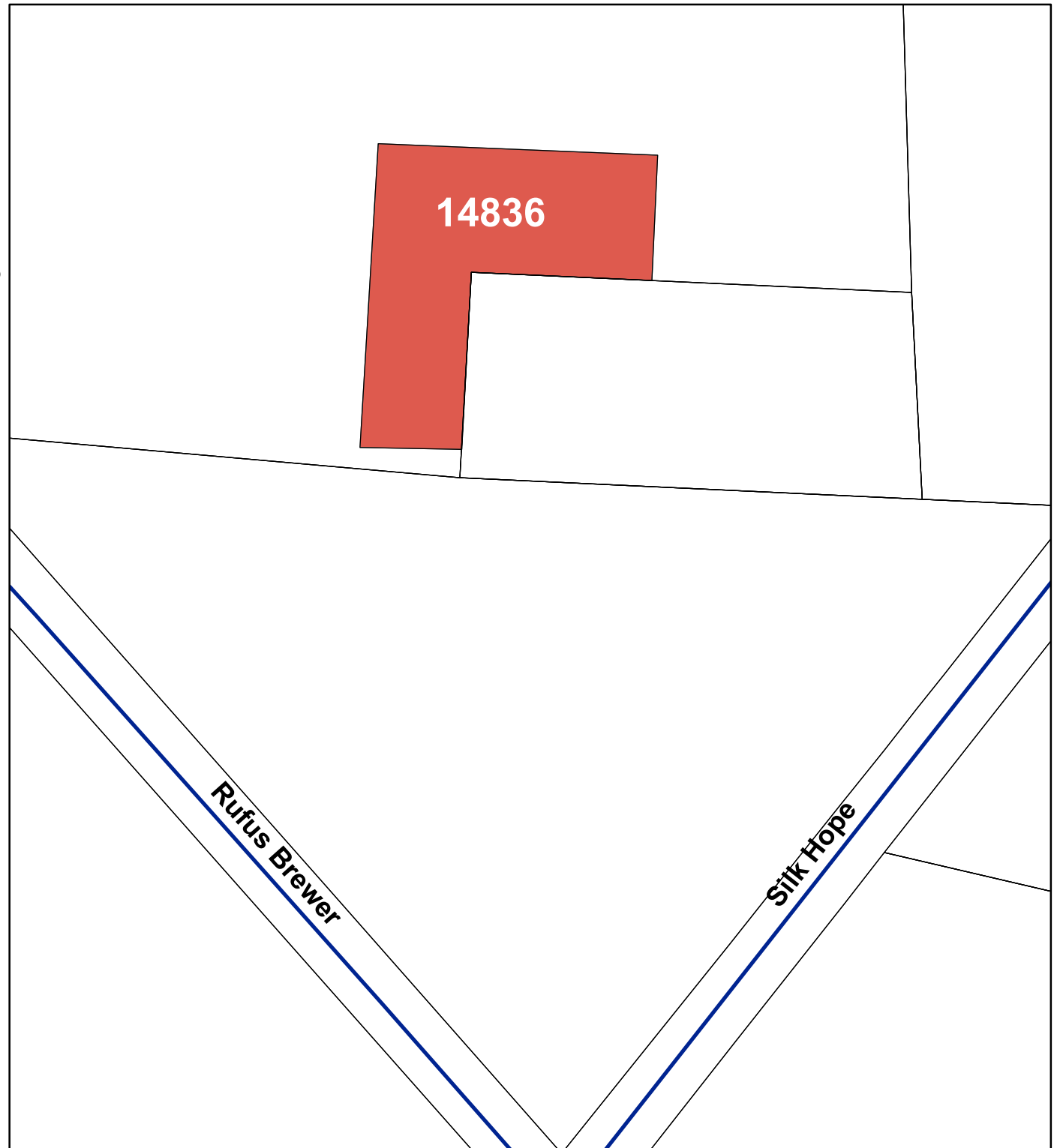

Proposed Rezoning of Parcel 18446

 Road Centerlines

Proposed Rezoning Class

 Heavy Industrial

 Light Industrial

 Neighborhood Business

Prepared by the
Chatham County
Planning Department



GIS DATA DISCLAIMER
FOR CHATHAM COUNTY NC



Information contained herein is provided for informational purposes only. The County of Chatham provides geographic information systems (GIS) data, maps, and metadata with no claim as to the completeness, usefulness, or accuracy of its content, positional or otherwise. The user hereby acknowledges that the Geographic Information System (GIS) data contained on this site are subject to constant change and that its accuracy cannot be guaranteed. The County and its officials and employees make no warranty, express or implied, and assume no legal liability or responsibility for the ability of users to fulfill their intended purposes in accessing or using GIS data or metadata or for omissions in content regarding such data. The data on this site could include technical inaccuracies and typographical errors. Independent verification of all data contained herein should be obtained by users of the data. The data on this site is presented "as is," without warranty of any kind, including, but not limited to, the implied warranties of merchantability, fitness for a particular purpose, or non-infringement. Your use and browsing of information on this site is at your own risk. In providing this data or access to it, the County assumes no obligation to assist the user in the use of such data or in the development, use, or maintenance of any applications applied to or associated with the data or metadata.

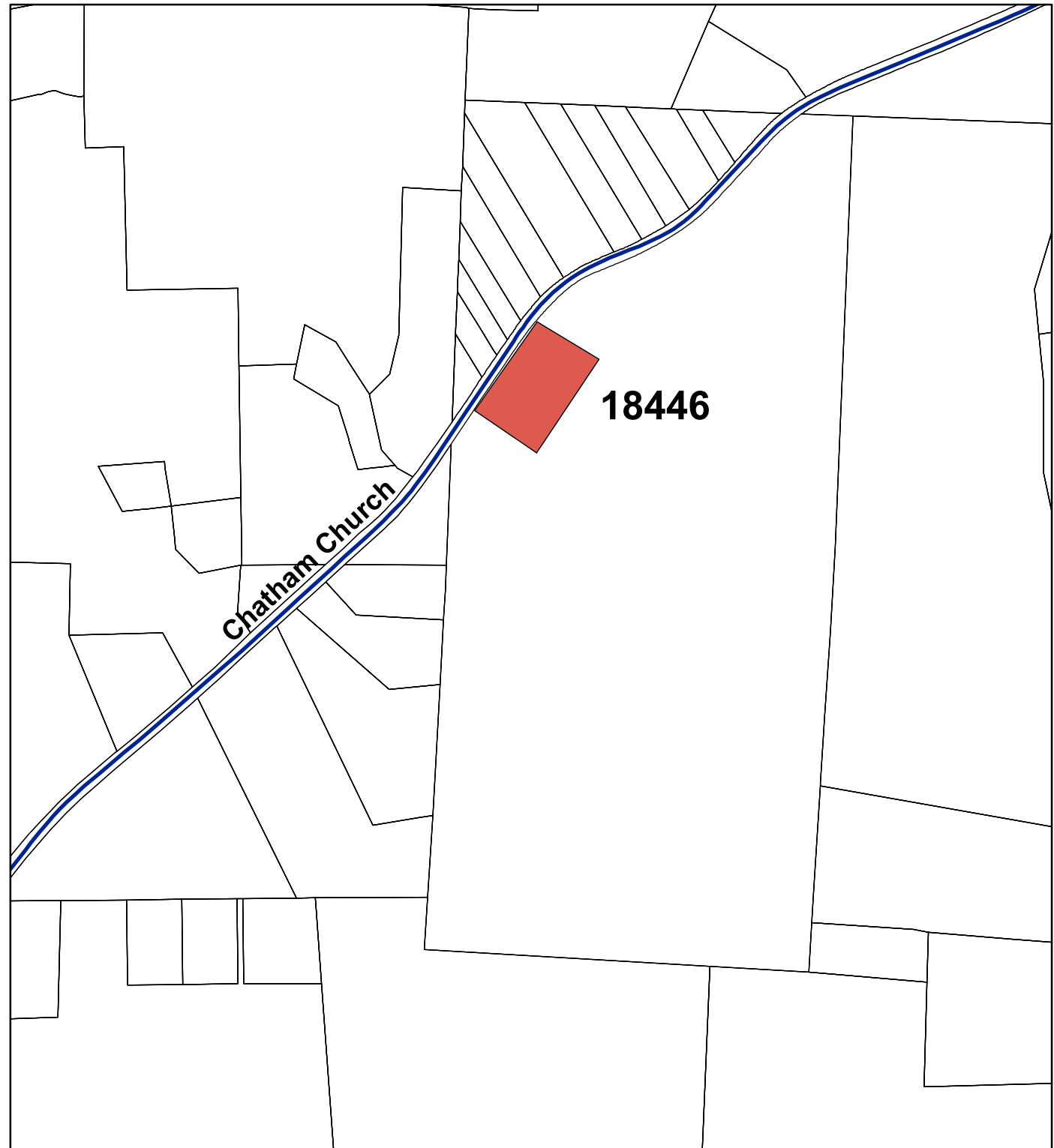

Proposed Rezoning of Parcel 3111

— Road Centerlines

Proposed Rezoning Class

-  Heavy Industrial
-  Light Industrial
-  Neighborhood Business

Prepared by the
Chatham County
Planning Department



GIS DATA DISCLAIMER
FOR CHATHAM COUNTY NC



Information contained herein is provided for informational purposes only. The County of Chatham provides geographic information systems (GIS) data, maps, and metadata with no claim as to the completeness, usefulness, or accuracy of its content, positional or otherwise. The user hereby acknowledges that the Geographic Information System (GIS) data contained on this site are subject to constant change and that its accuracy cannot be guaranteed. The County and its officials and employees make no warranty, express or implied, and assume no legal liability or responsibility for the ability of users to fulfill their intended purposes in accessing or using GIS data or metadata or for omissions in content regarding such data. The data on this site could include technical inaccuracies and typographical errors. Independent verification of all data contained herein should be obtained by users of the data. The data on this site is presented "as is," without warranty of any kind, including, but not limited to, the implied warranties of merchantability, fitness for a particular purpose, or non-infringement. Your use and browsing of information on this site is at your own risk. In providing this data or access to it, the County assumes no obligation to assist the user in the use of such data or in the development, use, or maintenance of any applications applied to or associated with the data or metadata.

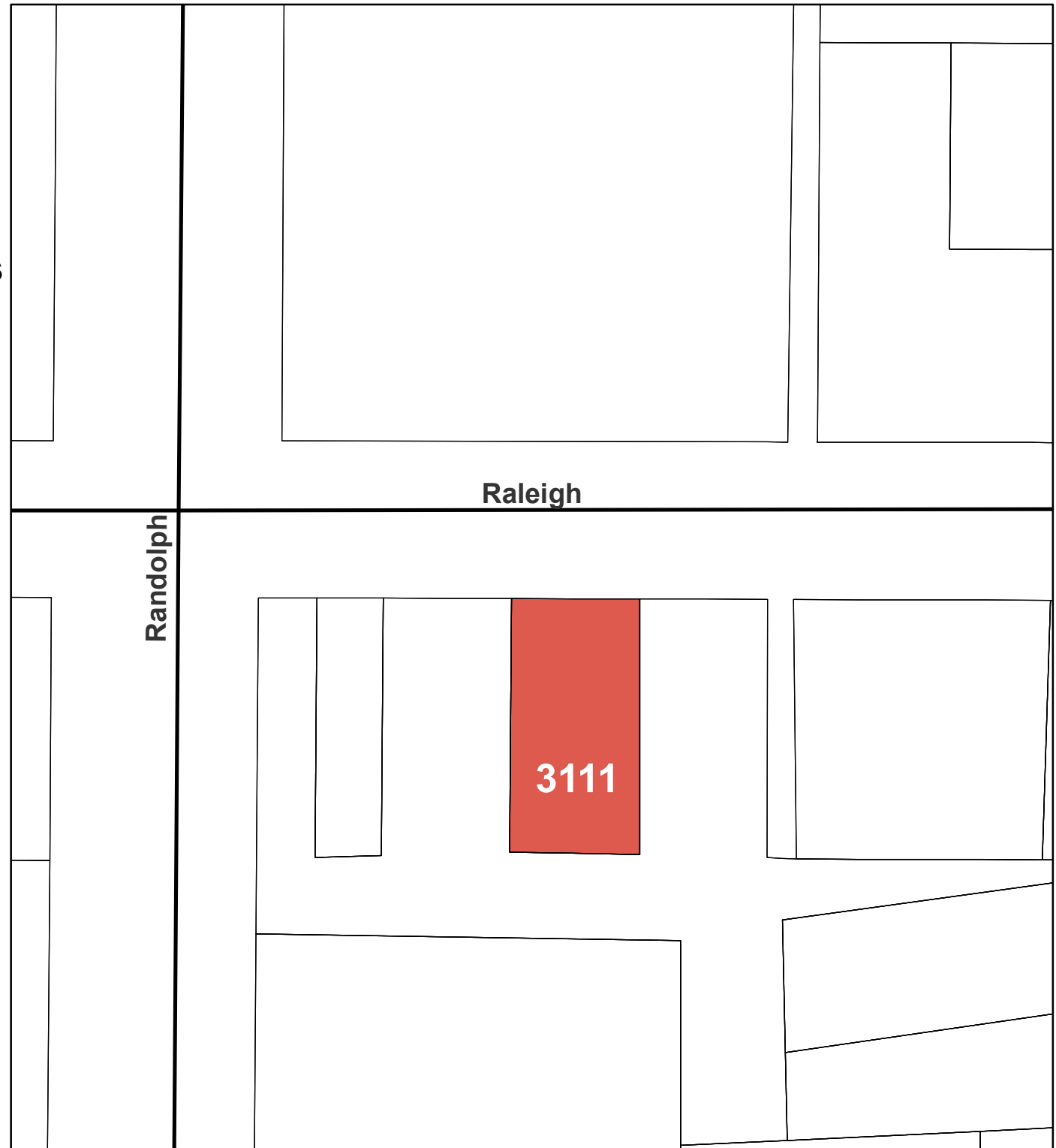

Proposed Rezoning of Parcels 3242/3243/3238

 Road Centerlines

Proposed Rezoning Class

 Heavy Industrial

 Light Industrial

 Neighborhood Business

Prepared by the
Chatham County
Planning Department



GIS DATA DISCLAIMER
FOR CHATHAM COUNTY NC



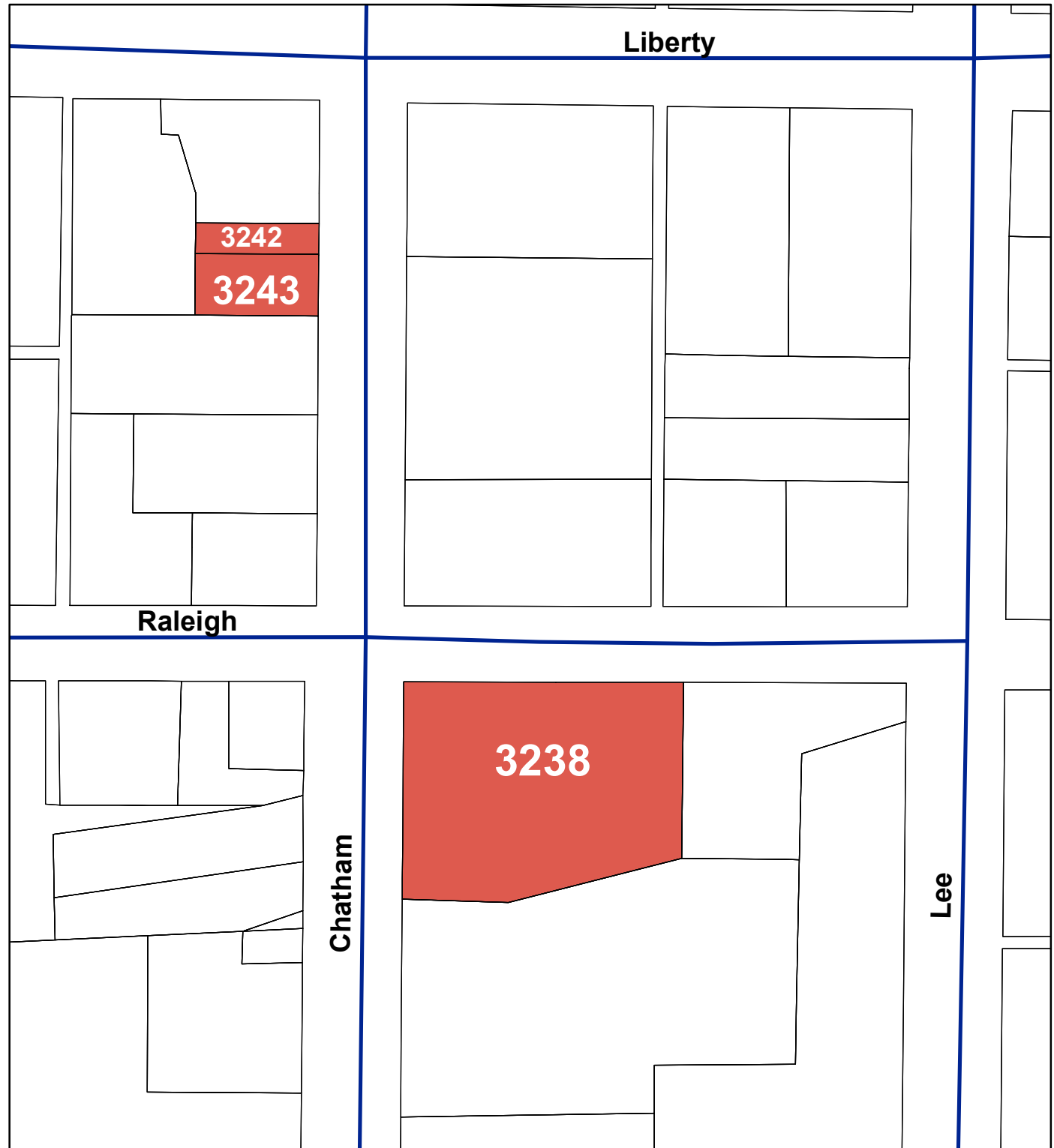

Information contained herein is provided for informational purposes only. The County of Chatham provides geographic information systems (GIS) data, maps, and metadata with no claim as to the completeness, usefulness, or accuracy of its content, positional or otherwise. The user hereby acknowledges that the Geographic Information System (GIS) data contained on this site are subject to constant change and that its accuracy cannot be guaranteed. The County and its officials and employees make no warranty, express or implied, and assume no legal liability or responsibility for the ability of users to fulfill their intended purposes in accessing or using GIS data or metadata or for omissions in content regarding such data. The data on this site could include technical inaccuracies and typographical errors. Independent verification of all data contained herein should be obtained by users of the data. The data on this site is presented "as is," without warranty of any kind, including, but not limited to, the implied warranties of merchantability, fitness for a particular purpose, or non-infringement. Your use and browsing of information on this site is at your own risk. In providing this data or access to it, the County assumes no obligation to assist the user in the use of such data or in the development, use, or maintenance of any applications applied to or associated with the data or metadata.



Proposed Rezoning of Parcels 60305 & 4794

— Road Centerlines

Proposed Rezoning Parcels REZONED

-  Heavy Industrial
-  Light Industrial
-  Neighborhood Business

Prepared by the
Chatham County
Planning Department



GIS DATA DISCLAIMER
FOR CHATHAM COUNTY NC



Information contained herein is provided for informational purposes only. The County of Chatham provides geographic information systems (GIS) data, maps, and metadata with no claim as to the completeness, usefulness, or accuracy of its content, positional or otherwise. The user hereby acknowledges that the Geographic Information System (GIS) data contained on this site are subject to constant change and that its accuracy cannot be guaranteed. The County and its officials and employees make no warranty, express or implied, and assume no legal liability or responsibility for the ability of users to fulfill their intended purposes in accessing or using GIS data or metadata or for omissions in content regarding such data. The data on this site could include technical inaccuracies and typographical errors. Independent verification of all data contained herein should be obtained by users of the data. The data on this site is presented "as is," without warranty of any kind, including, but not limited to, the implied warranties of merchantability, fitness for a particular purpose, or non-infringement. Your use and browsing of information on this site is at your own risk. In providing this data or access to it, the County assumes no obligation to assist the user in the use of such data or in the development, use, or maintenance of any applications applied to or associated with the data or metadata.

