

- RESIDENTIAL SUBDIVISION**
- NET AREA IN TRACT: 1,347,201 S.F. (30.945 AC.)
 - NUMBER OF LOTS: 25 + *Exempt* = 25
 - PROPOSED ROAD: PUBLIC PAVED 20' TRAVEL SURFACES; 50' R/W
 - WATER SUPPLY: CHATHAM COUNTY PUBLIC WATER
 - SEWERAGE: CHATHAM COUNTY SEWERAGE
 - LOT SIZE: 40,000 S.F. TO 1,000,000 S.F.; AVERAGE = 40,000 S.F.
 - PROPOSED STRIPBACKS: A) MANN'S CHAPEL; 40'; B) INTERIOR FRONT; 40'; C) REAR; 25'; D) SIDE; 25'
 - AREA IN PROPOSED PUBLIC STREET RIGHT-OF-WAY: 78,000 S.F.
- OTHER INFORMATION**
- STREAMS: INTERTITLED AND EPIHEMAL AS SHOWN
 - WETLANDS: ADJACENT TO STREAM AS SHOWN
 - FLOODPLAINS: NONE
 - ROCK OUTCROPS: NONE
 - CULTURAL & HISTORICAL RESOURCES: NONE
 - EXISTING LANDCOVER: HARDWOODS AND PINES EXCEPT AT EXISTING HOUSES
 - STREAM CROSSING DISTANCE: 180 TO 90 LF OF EXISTING CHANNEL
 - WATERSHED: JORDAN LAKE
- TRACT INFORMATION**
- PIN: 9796-02-0623; 9796-01-0728
 - APPLIC: 2024; 2033

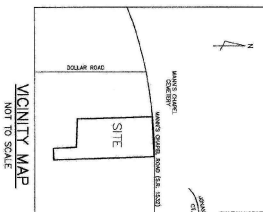

REVISIONS **2-9-2017**

SCALE 1"=100'

DRAWN BY: MOP

CHECKED BY: JBC

DATE: 2015-02-09

PROJECT NO. 520401

DRAWING NO. 98198K02

CONCEPT PLAN "K"

VICTORIAN HILLS SUBDIVISION

MANN'S CHAPEL ROAD

BALDWIN TWP. CHATHAM COUNTY, NC

PHILIP POST & ASSOCIATES

ENGINEERS PLANNERS SURVEYORS

401 Providence Road
Chapel Hill, NC 27514
(919)929-1173
401-2000 & 850-3662
822 North Elm Street
Greensboro, NC 27401
(919)273-7711