

# GRADING & EROSION CONTROL PLANS

FOR

## THE LEGACY

### PHASE 4A

CHATHAM COUNTY, NORTH CAROLINA

SEPTEMBER, 2014

(REVISED DECEMBER 12, 2014)

#### GENERAL CONSTRUCTION NOTES

- EXISTING UNDERGROUND STRUCTURES AND UTILITIES SHOWN ARE BASED ON FIELD SURVEYS AND BEST AVAILABLE RECORD DRAWINGS. THE HORIZONTAL AND VERTICAL LOCATION OF ALL UTILITIES PRIOR TO STARTING CONSTRUCTION AND NOTIFY THE ENGINEER OF ANY DISCREPANCIES.
- THE CONTRACTOR SHALL CONTACT NORTH CAROLINA ONE CALL AT 800-448-7243 PRIOR TO THE CONSTRUCTION SHALL CALL AT LEAST 48 HOURS PRIOR TO ANY CONSTRUCTION.
- ALL WATER UTILITY CONSTRUCTION SHALL CONFORM TO THE CHATHAM COUNTY STANDARDS AND SPECIFICATIONS.
- ALL SANITARY SEWER UTILITY CONSTRUCTION SHALL CONFORM TO LATEST EDITION OF NORTH CAROLINA STANDARDS AND SPECIFICATIONS.
- THE SUBJECT PROPERTY IS LOCATED IN A FLOOD HAZARD AREA PER FEMA PANEL 5782 MAP NUMBER 3709R200L DATED 02/02/07.
- AGUA PERSONNEL SHALL BE NOTIFIED 48 HOURS BEFORE CONSTRUCTION IS TO BEGIN. ANY TESTING IS SCHEDULED, OR BEFORE ANY PIPE IS COVERED.
- ALL WATER MAINS SHALL HAVE A MINIMUM OF 3.0' OF COVER AS MEASURED FROM FINISHED GRADE AT THE LOCATION WHERE INSALLED.
- ALL WATER MAINS SHALL BE OVER THE PRESSURE SEWER MAIN WITH A MINIMUM OF 18" SEPARATION.
- ALL WATER MAINS AND FORCE MAINS CROSSING UNDER STORM DRAINAGE PIPING SHALL BE CONSTRUCTED WITH ONE (1) JOINT OF DUCTILE IRON PIPE CENTERED ON THE STORM PIPE CROSSING.
- INSTREAM WORK SHALL BE PROHIBITED FROM MARCH 15 THROUGH JUNE 30 TO MINIMIZE IMPACTS TO SWIMMING FISH.
- TOPOGRAPHIC INFORMATION PROVIDED BY CE GROUP, INC. RALEIGH, NC AERIAL MAPPING.
- DISTURBANCE IS LIMITED TO NO MORE THAN 15 AC OF GRADE/UA SLOPED LAND AT ANY ONE TIME (0 - 14.9% SLOPE).
- DISTURBANCE IS LIMITED TO NO MORE THAN 10 AC OF MODERATELY SLOPED LAND AT ANY ONE TIME (15 - 24.9% SLOPE).

#### OWNER / DEVELOPER

F.L. LEGACY OWNER, LLC  
500 BOYLSTON ST., SUITE 1870  
BOSTON, MA 02116  
PHONE: 617.221.8400

#### SITE DATA

PIN # 9783 12 2842  
ZONING: R-1 (RESIDENTIAL)  
TOTAL TRACT AREA: 256.96 ACRES

PHASE 4A = 109 LOTS

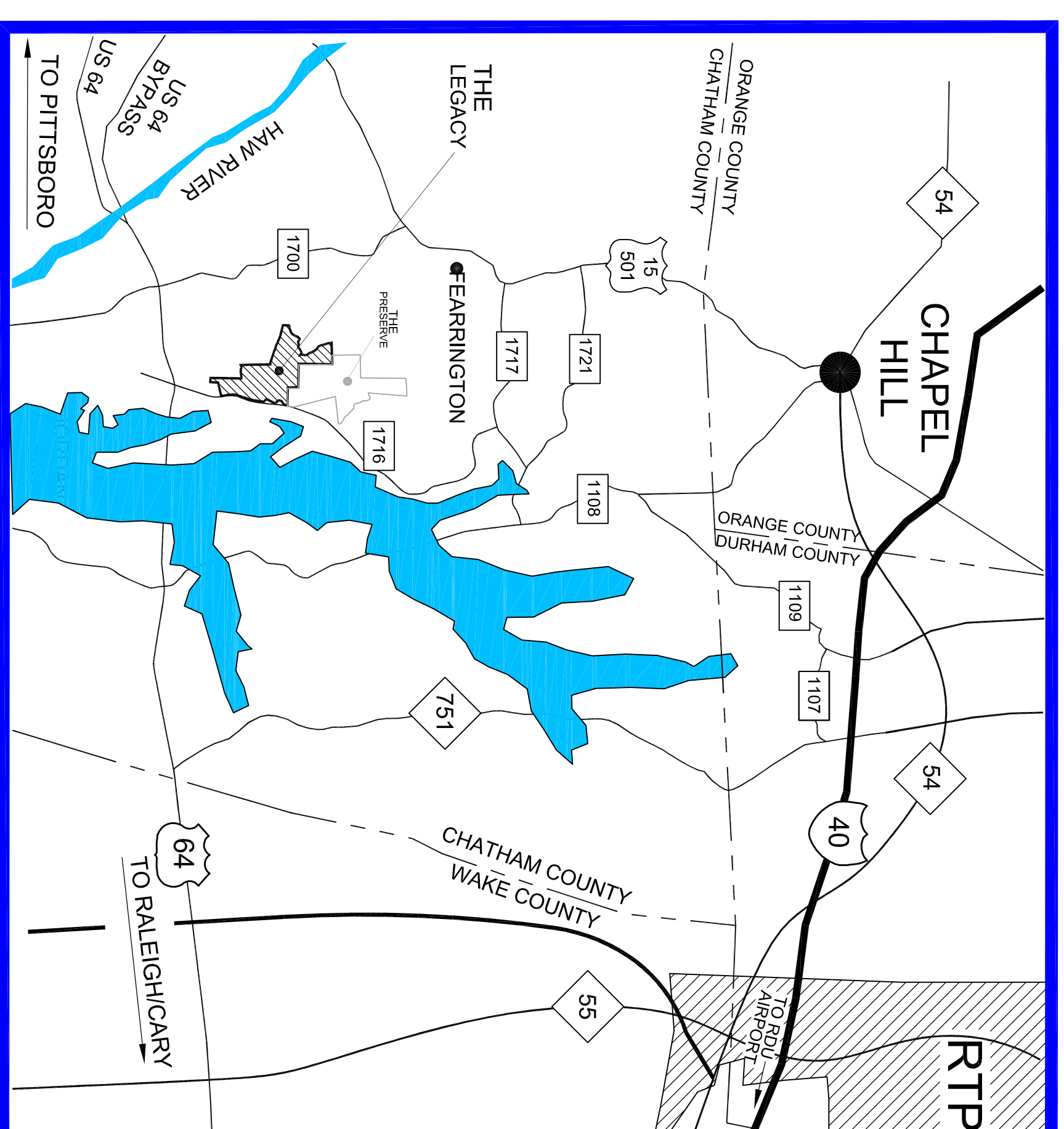

VICINITY MAP  
SCALE: 1 INCH = 10,000 FEET



#### EROSION CONTROL NOTES

- ALL CONSTRUCTION SHALL BE IN ACCORDANCE WITH STATE AND LOCAL REQUIREMENTS.
- SUFFICIENT EROSION CONTROL PRACTICES MUST BE INSTALLED AND MAINTAINED TO REMAIN SELEMENT WITHIN THE BOUNDARIES OF THE SITE PRIOR TO AND THROUGHOUT CONSTRUCTION. TEMPORARY GROUND COVER WILL BE INSTALLED ON ALL EXPOSED SLOPES IN 7 OR 14 DAYS. REINFORCEMENT SHALL BE INSTALLED WITHIN 14 DAYS OF EXPOSURE. EROSION CONTROL PRACTICES SHALL BE MAINTAINED THROUGHOUT CONSTRUCTION AND THROUGHOUT COMPLETION OF CONSTRUCTION OR DEVELOPMENT.
- MAINTENANCE: ALL EROSION AND SEDIMENT CONTROL PRACTICES TO BE INSPECTED WEEKLY AND AFTER EVERY RAINOFF PRODUCING RAINFALL EVENT. NEEDED REPAIRS WILL BE MADE IMMEDIATELY.
- MAXIMUM GRADED SLOPE SHALL NOT EXCEED THREE (3) TO ONE (1).
- THIS PHASE IS NOT LOCATED WITHIN 100 YEAR FLOOD PLAN ACCORDING TO FEMA MAP NUMBER 3709R200L DATED 02/07.
- SEE SHEETS 8 & 9 FOR EROSION CONTROL DETAILS.

THE DISTURBED ACREAGE IS 41.5 AC

#### INDEX OF DRAWINGS

COVER SHEET	1
EXISTING CONDITIONS PLAN	2
OVERALL LAYOUT PLAN	3
EROSION CONTROL PLAN STAGE 1	4
EROSION CONTROL PLAN STAGE 1	5
EROSION CONTROL PLAN STAGE 2	6
EROSION CONTROL PLAN STAGE 2	7
EROSION CONTROL DETAILS	8
EROSION CONTROL DETAILS	9



**CE GROUP**  
307 GLENWOOD AVE, SUITE 220  
RALEIGH, NC 27603  
PHONE: 919-367-8790  
www.cegroupinc.com

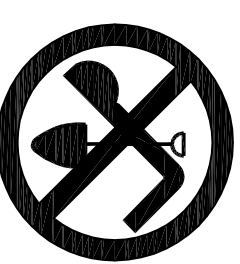

STOP!  
BEFORE YOU DIG CALL  
THE NC ONE CALL CENTER  
1-800-452-4949  
IT'S THE LAW!

**FINAL DESIGN**  
FOR REVIEW ONLY

NO.	REVISIONS	DATE
1.	REVISED PER CHATHAM COUNTY 1st REVIEW COMMENTS.	12/12/14

**CE GROUP**  
307 GLENWOOD AVE, 220  
RALEIGH, NC 27603  
PHONE: 919-367-8790  
FAX: 919-322-0032  
www.cegroupinc.com  
License # C-1739



**THE LEGACY  
PHASE 4A  
GRADING & EROSION CONTROL PLANS  
COVER  
CHATHAM COUNTY, NC**

Date:	SEPTEMBER, 2014
Scale:	N/A
Drawn:	CPM
Checked:	MPA
Project No.:	330-04
Computer Desig. Name:	330-04 P&I Owner 12/14

N/E  
DOUGLAS E. BROWN  
PIN: 9783-01-3139  
DB 950 PG. 893  
PB 96 PG. 147

N/E  
JESSE O. FEARRINGTON  
PIN: 9773-92-6496  
DB 1494 PG. 509  
PB 2003 PG. 32

N/E  
LEGACY AT JORDAN  
LAKE HOA INC.  
PIN: 9783-23-9346  
DB 1643 PG 814

N/E  
FRANK D. HAYES JR.  
PIN: 9773-95-0210  
DB 1645 PG. 1172

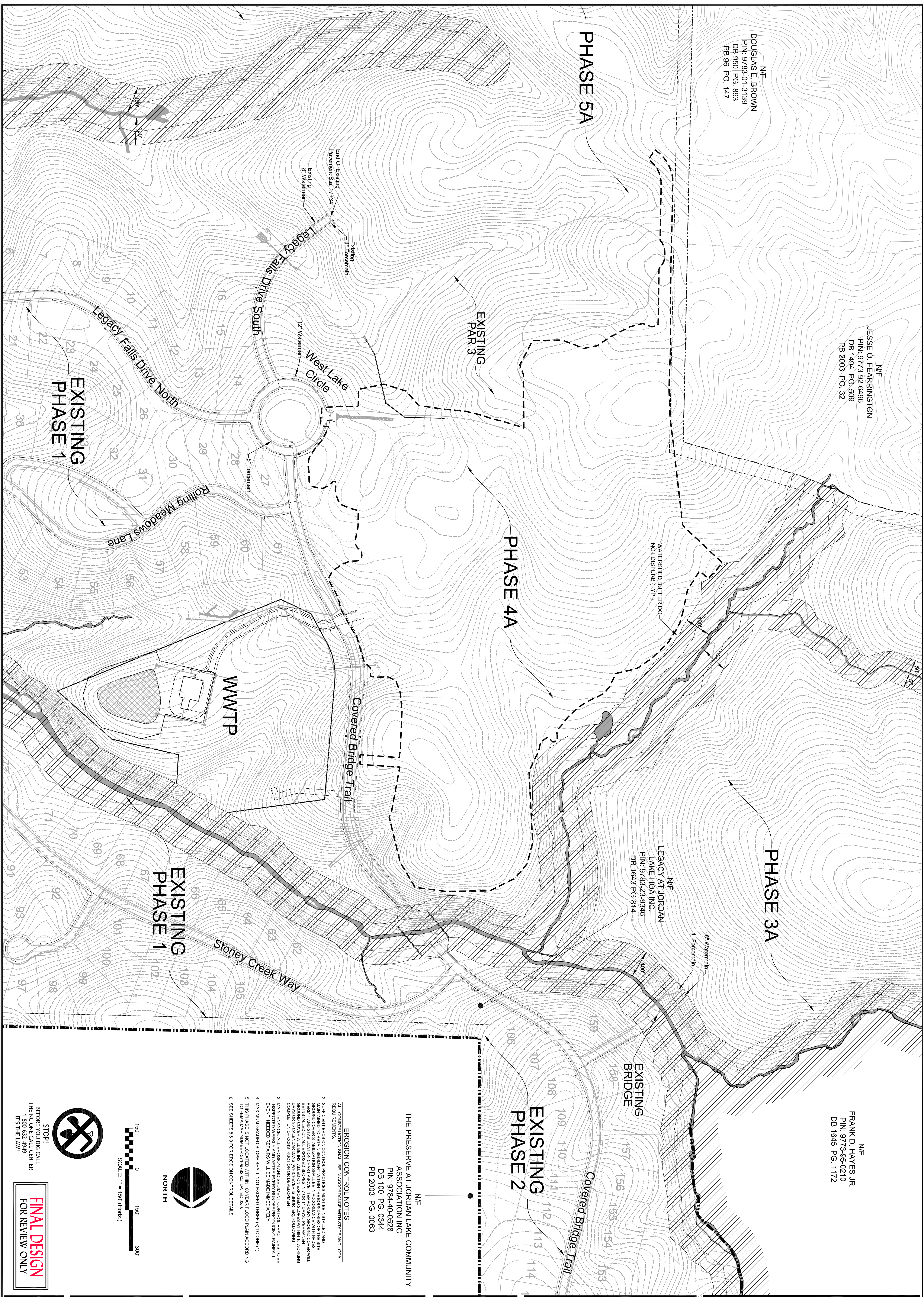

N/E  
THE PRESERVE AT JORDAN LAKE COMMUNITY  
ASSOCIATION INC  
PIN: 9784-40-0528  
DB 100 PG. 0344  
PB 2003 PG. 0063

**EROSION CONTROL NOTES**

1. ALL CONSTRUCTION SHALL BE IN ACCORDANCE WITH STATE AND LOCAL REQUIREMENTS.
2. SUFFICIENT EROSION CONTROL STRUCTURES MUST BE INSTALLED AND MAINTAINED TO RETAIN SEDIMENT WITHIN THE BOUNDARIES OF THE SITE. GROUND COVER STABILIZATION SHALL BE IN ACCORDANCE WITH NOTES BE INSTALLED ON ALL EXPOSED SLOPES IN 1 OR 4 DAYS. PERMANENT GROUND COVER WILL BE INSTALLED ON EXPOSED SLOPES WITHIN 15 WORKING DAYS OF COMPLETION OF CONSTRUCTION OR DEVELOPMENT.
3. MAINTENANCE: ALL EROSION AND SEDIMENT CONTROL PRACTICES TO BE INSPECTED WEEKLY AND AFTER EVERY RAINOFF PRODUCING RAINFALL EVENT. NEEDED REPAIRS WILL BE MADE IMMEDIATELY.
4. MAXIMUM GRADED SLOPE SHALL NOT EXCEED THREE (3) TO ONE (1).
5. THIS PHASE IS NOT LOCATED WITHIN 100 YARDS FROM ANY EROSION CONTROL PLAN ACCORDING TO FEMA MAP NUMBER 371097200L DATED 02/01.
6. SEE SHEETS 8 & 9 FOR EROSION CONTROL DETAILS.

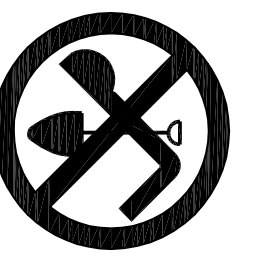
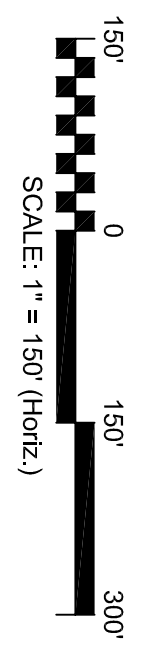

STOP!  
BEFORE YOU DIG CALL  
THE NC ONE CALL CENTER  
1-800-368-7469  
IT'S THE LAW!

**FINAL DESIGN**  
FOR REVIEW ONLY

NO.	REVISIONS	DATE
1.	REVISED PER CHATHAM COUNTY 1st REVIEW COMMENTS.	12/12/14



**CE GROUP**  
307 GLENWOOD AVE. 220  
RALEIGH, NC 27603  
PHONE: 919-367-8790  
FAX: 919-322-0032  
www.cegroupinc.com  
License # C-1739



**THE LEGACY  
PHASE 4A  
EROSION CONTROL PLANS**  
EXISTING CONDITIONS AND SUBPHASING  
CHATHAM COUNTY, NC

Date: SEPTEMBER, 2014  
Scale: N/A  
Drawn: CPM  
Checked: MPA  
Project No: 330-04  
Contract Doc. Name: 330-04-P&I-02-01.dwg  
Sheet No:

N/E  
DOUGLAS E. BROWN  
PIN: 9783-01-3139  
DB 950 PG. 893  
PB 96 PG. 147

N/E  
JESSE O. FEARRINGTON  
PIN: 9773-92-4496  
DB 1494 PG. 509  
PB 2003 PG. 32

N/E  
FRANK D. HAYES, JR.  
PIN: 9773-95-0210  
DB 1645 PG. 1172

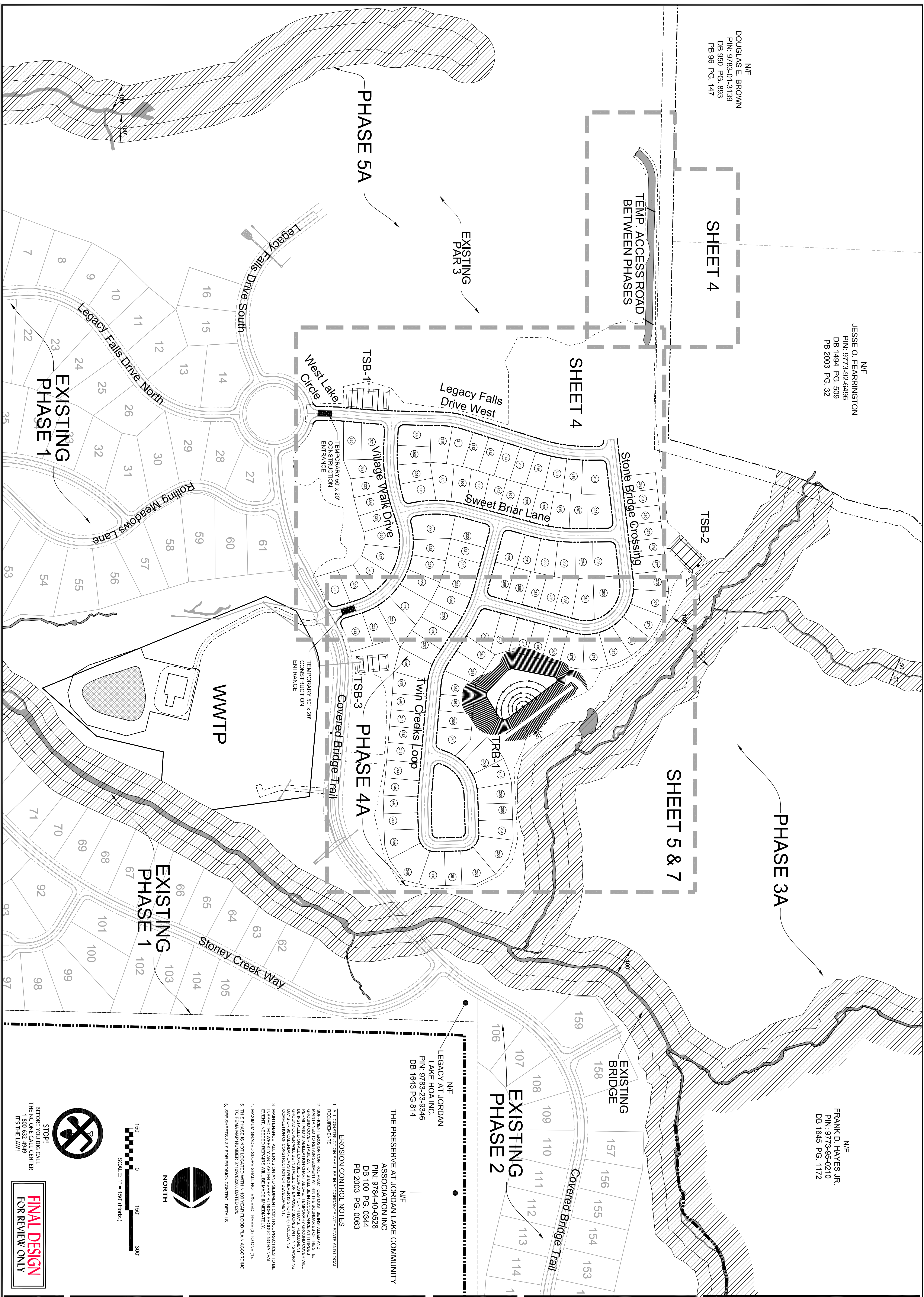

N/E  
LEGACY AT JORDAN  
LAKE HOA INC.  
PIN: 9783-23-9346  
DB 1643 PG 814

N/E  
THE PRESERVE AT JORDAN LAKE COMMUNITY  
ASSOCIATION INC  
PIN: 9784-40-0528  
DB 100 PG. 0344  
PB 2003 PG. 0063

**EROSION CONTROL NOTES**

1. ALL CONSTRUCTION SHALL BE IN ACCORDANCE WITH STATE AND LOCAL REQUIREMENTS.
2. SUFFICIENT EROSION CONTROL PRACTICES MUST BE INSTALLED AND MAINTAINED TO RETAIN SEDIMENT WITHIN THE BOUNDARIES OF THE SITE PRIOR TO ANY CONSTRUCTION. EROSION CONTROL PRACTICES SHALL BE PRINTED AND STABILIZATION CHART ABOVE. TEMPORARY GROUND COVER WILL BE INSTALLED ON ALL EXPOSED SLOPES IN 7 OR 14 DAYS. PERMANENT GROUND COVER SHALL BE INSTALLED ON ALL EXPOSED SLOPES IN 14 DAYS. PERMANENT GROUND COVER SHALL BE INSTALLED ON ALL EXPOSED SLOPES IN 14 DAYS. PERMANENT GROUND COVER SHALL BE INSTALLED ON ALL EXPOSED SLOPES IN 14 DAYS. PERMANENT GROUND COVER SHALL BE INSTALLED ON ALL EXPOSED SLOPES IN 14 DAYS. PERMANENT GROUND COVER SHALL BE INSTALLED ON ALL EXPOSED SLOPES IN 14 DAYS.
3. MAINTENANCE: ALL EROSION AND SEDIMENT CONTROL PRACTICES TO BE INSPECTED WEEKLY AND AFTER EVERY RAINFALL EXCEEDING 0.5 INCHES PER HOUR. EROSION AND SEDIMENT CONTROL PRACTICES SHALL BE MAINTAINED THROUGHOUT CONSTRUCTION AND THROUGHOUT THE 100 YEAR FLOOD PLAN ACCORDING TO FEMA MAP NUMBER 3718972D01 DATED 02/01.
4. MAXIMUM GRADED SLOPE SHALL NOT EXCEED THREE (3) TO ONE (1).
5. THIS PHASE IS NOT LOCATED WITHIN 100 YEAR FLOOD PLAN ACCORDING TO FEMA MAP NUMBER 3718972D01 DATED 02/01.
6. SEE SHEETS 8 & 9 FOR EROSION CONTROL DETAILS.

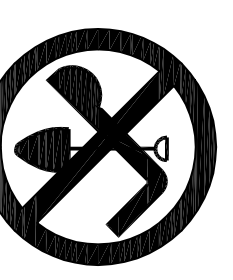

STOP!  
BEFORE YOU DIG CALL  
THE NC ONE CALL CENTER  
1-800-4-A-HEAD  
IT'S THE LAW!

**FINAL DESIGN  
FOR REVIEW ONLY**

NO.	REVISIONS	DATE
1.	REVISED PER CHATHAM COUNTY 1st REVIEW COMMENTS.	12/12/14

**C/E GROUP**

307 GLENWOOD AVE. 220  
RALEIGH, NC 27602  
PHONE: 919-367-8790  
FAX: 919-322-0032  
www.cegrp.com  
License # C-1739



**THE LEGACY  
PHASE 4A  
EROSION CONTROL PLANS  
OVERALL LAYOUT  
CHATHAM COUNTY, NC**

Date: SEPTEMBER, 2014  
Scale: 1" = 50'  
Drawn: CPM  
Checked: MPA  
Project No: 330-04  
Computer Draw Name: 330-04\_Plot\_03 overall layout

Sheet No: **3** Of **3**



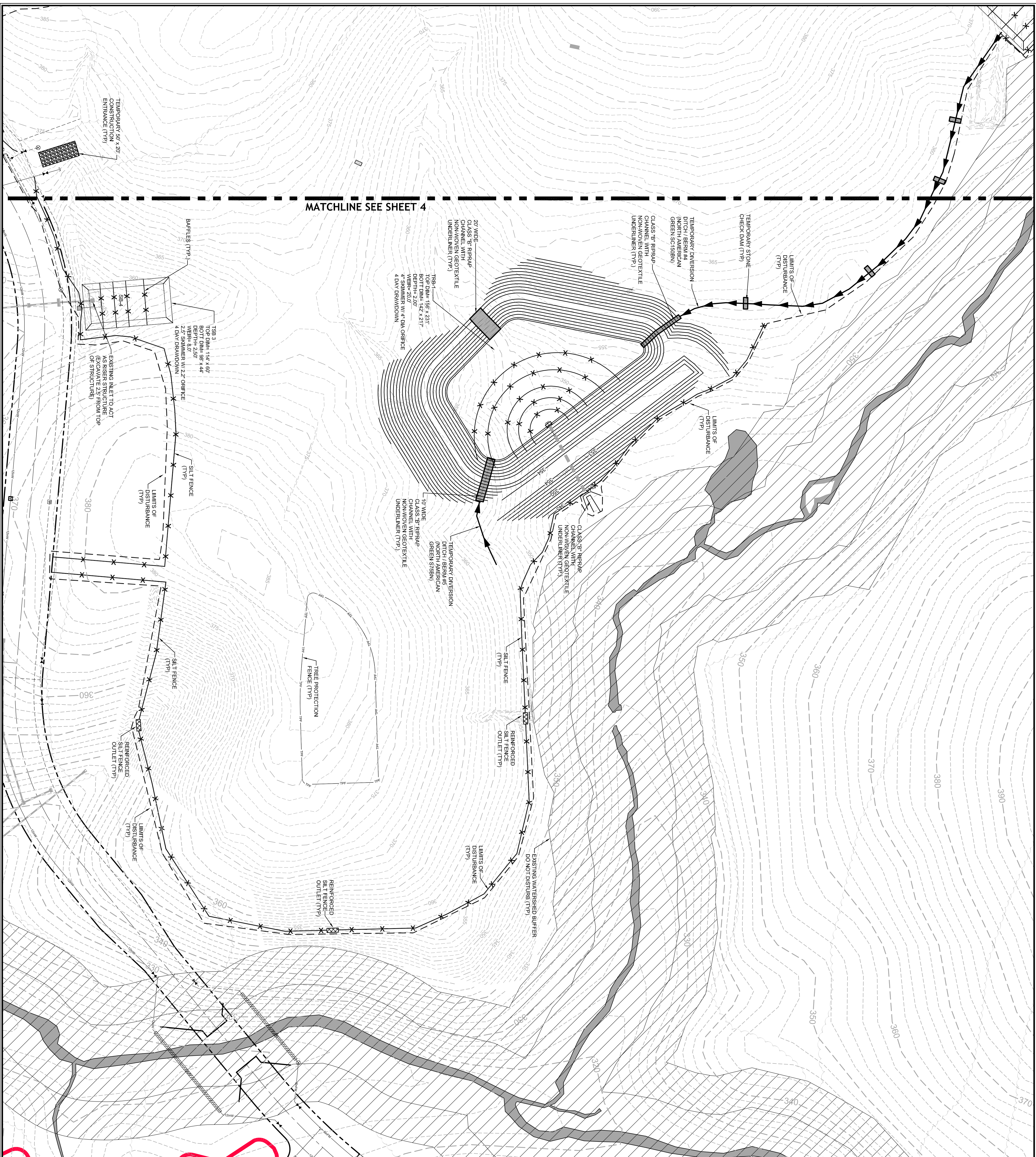

- EROSION CONTROL NOTES**
1. ALL CONSTRUCTION SHALL BE IN ACCORDANCE WITH STATE AND LOCAL REQUIREMENTS.
  2. SUFFICIENT EROSION CONTROL PRACTICES MUST BE INSTALLED AND MAINTAINED THROUGHOUT CONSTRUCTION. EROSION CONTROL PRACTICES SHALL BE INSTALLED AND MAINTAINED IN ACCORDANCE WITH THE PRELIMINARY EROSION CONTROL PLAN. TEMPORARY GROUND COVER WILL BE INSTALLED ON EXPOSED SLOPES WITHIN 15 WORKING DAYS OF SO EXCAVATION WORK BEING COMPLETED, FOLLOWING THE EROSION CONTROL PLAN. MAINTENANCE OF CONSTRUCTION SHALL BE AS FOLLOWS:
    3. MAINTENANCE: ALL EROSION AND SEDIMENT CONTROL PRACTICES TO BE MAINTAINED THROUGHOUT CONSTRUCTION AND SHALL BE MAINTAINED THROUGHOUT CONSTRUCTION.
    4. MAXIMUM GRADED SLOPE SHALL NOT EXCEED THREE (3) TO ONE (1).
    5. THIS PHASE IS NOT LOCATED WITHIN 100 YEAR FLOOD PLAIN ACCORDING TO FEMA MAP NUMBER 370992200L DATED 02/01.
    6. SEE SHEETS 8 & 9 FOR EROSION CONTROL DETAILS.

**LEGEND**

- TEMPORARY SEDIMENT TRAP / RISER BASIN
- TEMPORARY DIVERSION DITCH / BERM
- TEMPORARY SILT FENCE
- TEMPORARY STONE CHECK DAM
- CONSTRUCTION LIMITS

**GENERAL CONSTRUCTION NOTES**

1. EXISTING UNDERGROUND STRUCTURES AND UTILITIES SHOWN ARE BASED ON FIELD SURVEYS AND BEST AVAILABLE RECORD DRAWINGS. THE CONTRACTOR SHALL FIELD VERIFY CONDITIONS INCLUDING THE LOCATION AND DEPTH OF ALL UTILITIES PRIOR TO STARTING CONSTRUCTION AND NOTIFY THE ENGINEER OF ANY DISCREPANCIES.
2. THE CONTRACTOR SHALL CONTACT NORTH CAROLINA ONE CALL AT 1-800-368-5898. THE CONTRACTOR SHALL CALL AT LEAST 72 HOURS PRIOR TO ANY EXCAVATION.
3. ALL WATER UTILITY CONSTRUCTION SHALL CONFORM TO THE CHATHAM COUNTY 15 MINUTE AND 30 MINUTE STANDARDS.
4. ALL SANITARY SEWER UTILITY CONSTRUCTION SHALL CONFORM TO LATEST PRACTICE NORTH CAROLINA STANDARDS AND 30 MINUTE STANDARDS.
5. THE SUBJECT PROPERTY IS LOCATED IN A FLOOD HAZARD AREA PER FEMA PANEL 9782 MAP NUMBER 370992200L DATED 02/01/07.
6. AQUA RESPONSE SHALL BE NOTIFIED 48 HOURS BEFORE CONSTRUCTION IS TO BEGIN. ANY TESTING IS SCHEDULED OR BEFORE ANY PIPE IS COVERED.
7. ALL WATER MAINS SHALL HAVE A MINIMUM OF 3' OF COVER AS MEASURED FROM FINISHED GRADE AT THE LOCATION WHERE INSTALLED.
8. ALL WATER MAINS SHALL BE OVER THE PRESSURE SEWER MAIN WITH A MINIMUM OF 18' SEPARATION.
9. ALL WATER MAINS AND FORCE MAINS CROSSING UNDER STORM DRAINAGE PIPING SHALL BE CONSTRUCTED WITH ONE (1) JOINT OF DUCTILE IRON PIPE CENTERED ON THE STORM PIPE CROSSING.
10. INSTREAM WORK SHALL BE PROHIBITED FROM MARCH 15 THROUGH JUNE 30 TO MINIMIZE IMPACTS TO SPRAWLING FISH.
11. TOPOGRAPHIC INFORMATION PROVIDED BY CE GROUP, INC. (ALEIGH, NC. AERIAL MAPPING) FROM FIELD SURVEY BACKGROUND TOPOGRAPHY FROM AERIAL MAPPING.
12. DISTURBANCE IS LIMITED TO NO MORE THAN 15 AC OF GRADUAL SLOPES LAND AT ANY ONE TIME (0 - 14.9% SLOPE).
13. DISTURBANCE IS LIMITED TO NO MORE THAN 10 AC OF MODERATELY SLOPED LAND AT ANY ONE TIME (15 - 24.9% SLOPE).

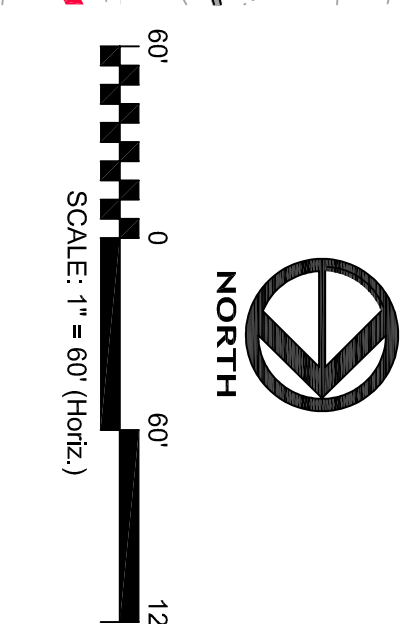
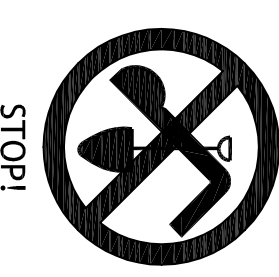

**FINAL DESIGN FOR REVIEW ONLY**

NO.	REVISIONS	DATE
1.	REVISED PER CHATHAM COUNTY 1st REVIEW COMMENTS.	12/12/14

**CE GROUP**

307 GLENWOOD AVE, 220  
RALEIGH, NC 27602  
PHONE: 919-367-8790  
FAX: 919-322-0032

www.cegroupinc.com  
License # C-1739



**THE LEGACY  
PHASE 4A  
EROSION CONTROL PLANS  
STAGE 1  
CHATHAM COUNTY, NC**

Date: SEPTEMBER, 2014  
Scale: 1" = 60'  
Drawn: CPM  
Checked: MPA  
Project No: 330-04  
Computer Draw Name: 330-04 03 ECP Plan Phase 1  
Sheet No: 5 of 5





GROUND STABILIZATION*	STABILIZATION TIME FRAME	STABILIZATION FRAME EXCEPTIONS
Swales, ditches	7 days	None
High Quality Zones (HQZ)	7 days	None
Slopes steeper than 3:1	7 days	If slopes are 10' or less in length and are not steeper than 2:1, 14 days allowed
Slopes 3:1 or flatter	14 days	7-day for slopes greater than 5:1 and 14 days for slopes flatter than 5:1
All other areas	14 days	None for perimeter and HMOZ Zones

\* Extension of time may be approved by the permitting authority based on weather or other site-specific conditions that make compliance impracticable. (Section III.B (2)(b))

#### NOCDER SELF-INSPECTION PROGRAM

THE SEDIMENTATION POLLUTION CONTROL ACT WAS AMENDED IN 2006 TO REQUIRE THAT PERSONS RESPONSIBLE FOR LAND-DEVELOPING ACTIVITIES INSPECT A PROJECT AFTER SEDIMENTATION CONTROL PLANS BEING COMPLETED.

RULES DETAILING THE DOCUMENTATION OF THESE INSPECTIONS TAKE EFFECT OCTOBER 1, 2010.

THE SELF-INSPECTION PROGRAM IS SEPARATE FROM THE VERTICALLY SELF-REGULATING PROGRAM. THE SELF-INSPECTION PROGRAM IS A REQUIREMENT OF THE PERMITTING AUTHORITY AND IS SEPARATE FROM THE SEDIMENTATION POLLUTION CONTROL ACT. THE PERMITTING AUTHORITY WILL REVIEW THE SELF-INSPECTION REPORT AND THE SEDIMENTATION CONTROL MEASURES ACCORDING TO THE APPROVED EROSION AND SEDIMENTATION CONTROL PLANS. THE PERMITTING AUTHORITY WILL NOT REVIEW THE SELF-INSPECTION REPORT FOR THE PROJECT. THE SELF-INSPECTION REPORT FORM IS AVAILABLE AS AN EXCEL SPREADSHEET FROM THE LAND QUALITY WEBSITE.

http://landquality.com/web/index.cfm

#### CONSTRUCTION SEQUENCE

1. OBTAIN GRADING PERMIT / FINAL APPROVAL FROM CHATHAM COUNTY ENVIRONMENTAL HEALTH.
2. CONTACT THE CHATHAM COUNTY EROSION CONTROL SECTION AT 919-444-4444 TO SET UP A PRE-CONSTRUCTION MEETING PRIOR TO ANY LAND DISTURBANCE WORK PERFORMED.
3. INSTALL, IN ORDER OF THIS SEQUENCE, DELINEATE THE PROPOSED PERMANENT EROSION CONTROL MEASURES AND PROPOSED SET BACKS FROM THE CONSTRUCTION ENTRANCE.
4. CONTRACTOR SHALL INSTALL THE PERMANENT WATER QUALITY / RIBBER BASIN AND SUMMER BASIN. CLEAR ONLY AS NECESSARY TO ACCESS MEASURES ARE INSTALLED. CLEAR ONLY AS REQUIRED TO INSTALL TEMPORARY DIVERSION BARRIERS, DITCHES AND GRAVEL DIVERSION DRAINS. TEMPORARY DIVERSION BARRIERS, DITCHES AND GRAVEL DIVERSION DRAINS SHALL BE INSTALLED AND OPERATIONAL. TEMPORARY SUMMER BASIN CAN BE REMOVED AND THE SLOPES STABILIZED. SEED COMPLETION OF ANY PHASE OF CONSTRUCTION.
5. ONCE CERTIFICATE OF COMPLIANCE IS OBTAINED BEGIN CLEANING AND FINISHING EXCAVATIONS. EXCAVATIONS SHALL BE APPROVED SUBSURFACE DRAINAGE AND UTILITIES. INSTALL ADDITIONAL INLET SUBSURFACE DRAINAGE. INSTALL AND OPERATIONAL TEMPORARY SUMMER BASIN. CAN BE REMOVED AND THE SLOPES STABILIZED. SEED COMPLETION OF ANY PHASE OF CONSTRUCTION.
6. REQUEST FINAL APPROVAL BY ENVIRONMENTAL INSPECTOR. IF THE INSPECTOR IS SATISFIED WITH USABLE PERMANENT GROUND COVER, BEGIN REMOVING TEMPORARY EROSION CONTROL MEASURES. REMOVE STABILIZATION HAS OCCURRED REMOVE SEDIMENT FROM RISER. BASHWATER QUALITY POND AND CONVERT TO PERMANENT STRUCTURE.
7. CONTRACTOR TO REINSTALL TEMPORARY DIVERSION SWALES AT THE END OF EACH DAY TO STABILIZE EXPOSURE TO THE PERMANENT STRUCTURE.

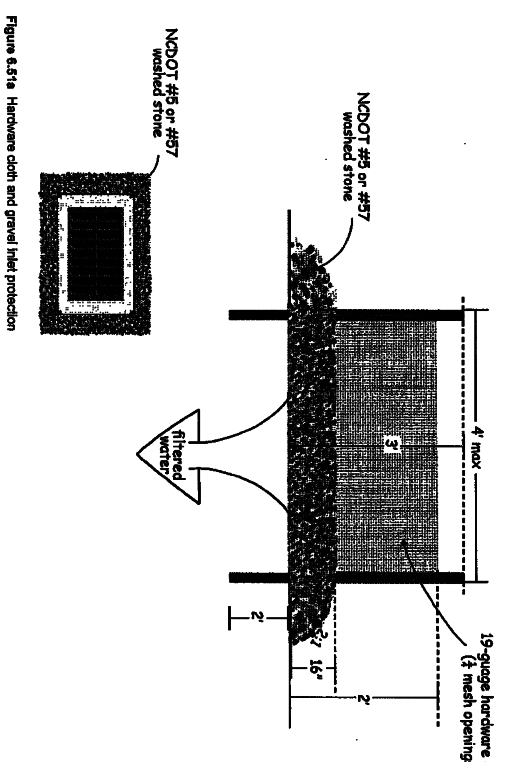

- Construction:**
1. Rip-rap apron shall be installed in accordance with the specifications.
  2. Rip-rap apron shall be installed in accordance with the specifications.
  3. Rip-rap apron shall be installed in accordance with the specifications.
  4. Rip-rap apron shall be installed in accordance with the specifications.
  5. Rip-rap apron shall be installed in accordance with the specifications.
  6. Rip-rap apron shall be installed in accordance with the specifications.
- Maintenance:**
1. Rip-rap apron shall be inspected and maintained in accordance with the specifications.
  2. Rip-rap apron shall be inspected and maintained in accordance with the specifications.
  3. Rip-rap apron shall be inspected and maintained in accordance with the specifications.
  4. Rip-rap apron shall be inspected and maintained in accordance with the specifications.
  5. Rip-rap apron shall be inspected and maintained in accordance with the specifications.
  6. Rip-rap apron shall be inspected and maintained in accordance with the specifications.
- References:**
- 1. NCSDER Self-Inspection Program
  - 2. NCSDER Self-Inspection Program
  - 3. NCSDER Self-Inspection Program
  - 4. NCSDER Self-Inspection Program
  - 5. NCSDER Self-Inspection Program
  - 6. NCSDER Self-Inspection Program

#### TEMPORARY INLET PROTECTION

#### Seeded Preparation:

1. Check completed areas and spread topsoil three inches deep over reverse soil conditions, if available.
2. Rip the entire area to six inches deep.
3. Remove all debris, rocks, and other obstructions leaving surface reasonably smooth and uniform.
4. Apply agricultural lime, fertilizer and superphosphate uniformly and mix with soil (see details).
5. Continue tillage until a well-aerated, firm reasonably uniform seedbed is prepared for grass seeding.
6. Apply seed, fertilizer, and superphosphate uniformly and mix with soil (see details).
7. Mow immediately after seeding and mow again.
8. Inspect all seeded areas and make necessary repairs for seedbeds within the planting season, if possible. If stand should be over 60% damaged.
9. Consult EFS Environmental Engineers on maintenance treatment and fertilization after permanent cover is established.

**Minimum Annual Linerstone:** 2 tons/acre (3 tons/acre in clay soils)  
**Fertilizer:** 500 lbs/acre - 20% analysis  
**Superphosphate:** 500 lbs/acre - 10-10-10  
**Agri-lime:** 500 lbs/acre - 20% analysis  
**Annual Erosion:** 500 lbs/acre at 300 gal/acre

#### Seeding Schedule

PERMANENT	Date	Type	Planting Rate
	Aug 15 - Nov 1	Tall Fescue	300 lbs/acre
	Nov 1 - Mar 1	Tall Fescue & Annual Ryegrass	300 lbs/acre
	Mar 1 - Apr 15	Tall Fescue	300 lbs/acre
	Apr 15 - Jun 30	Hardhead Common Bermudagrass	25 lbs/acre
	Jul 1 - Aug 15	Tall Fescue AND Browm Top Millet or Sorghum - Sudan Hybrids ...	125 lbs/acre (Tall Fescue); 35 lbs/acre (Browm Top Millet); 30 lbs/acre (Sorghum - Sudan Hybrids)

TEMPORARY	Date	Species	Planting Rate
	Mar 1 - Jun 1	Spartina Leptostachya (scalloped) and use the following combinations:	50 lbs/acre (Spartina Leptostachya)
	Mar 1 - Apr 15	Add Tall Fescue	120 lbs/acre
	Mar 1 - Jun 30	Or add Hybrid Common Bermudagrass	25 lbs/acre
	Jun 1 - Sep 1	Tall Fescue AND Browm Top Millet or Sorghum - Sudan Hybrids ...	120 lbs/acre (Tall Fescue); 35 lbs/acre (Browm Top Millet); 30 lbs/acre (Sorghum - Sudan Hybrids)
	Sep 1 - Mar 1	Spartina Leptostachya (unfilled - unscalloped) AND Tall Fescue	70 lbs/acre (Spartina Leptostachya); 120 lbs/acre (Tall Fescue)
	Nov 1 - Mar 1	And Annual Ryegrass	25 lbs/acre

Consult EFS Environmental Engineer for additional information concerning other alternatives for vegetation of seeded areas. The above vegetation rates are those which do well under location conditions; other seeding rate combinations are possible.

\*\* TEMPORARY: Re-seed according to optimum season for desired permanent vegetation. Do not allow temporary cover to grow over 12" in height before mowing; otherwise reseed may be needed out.

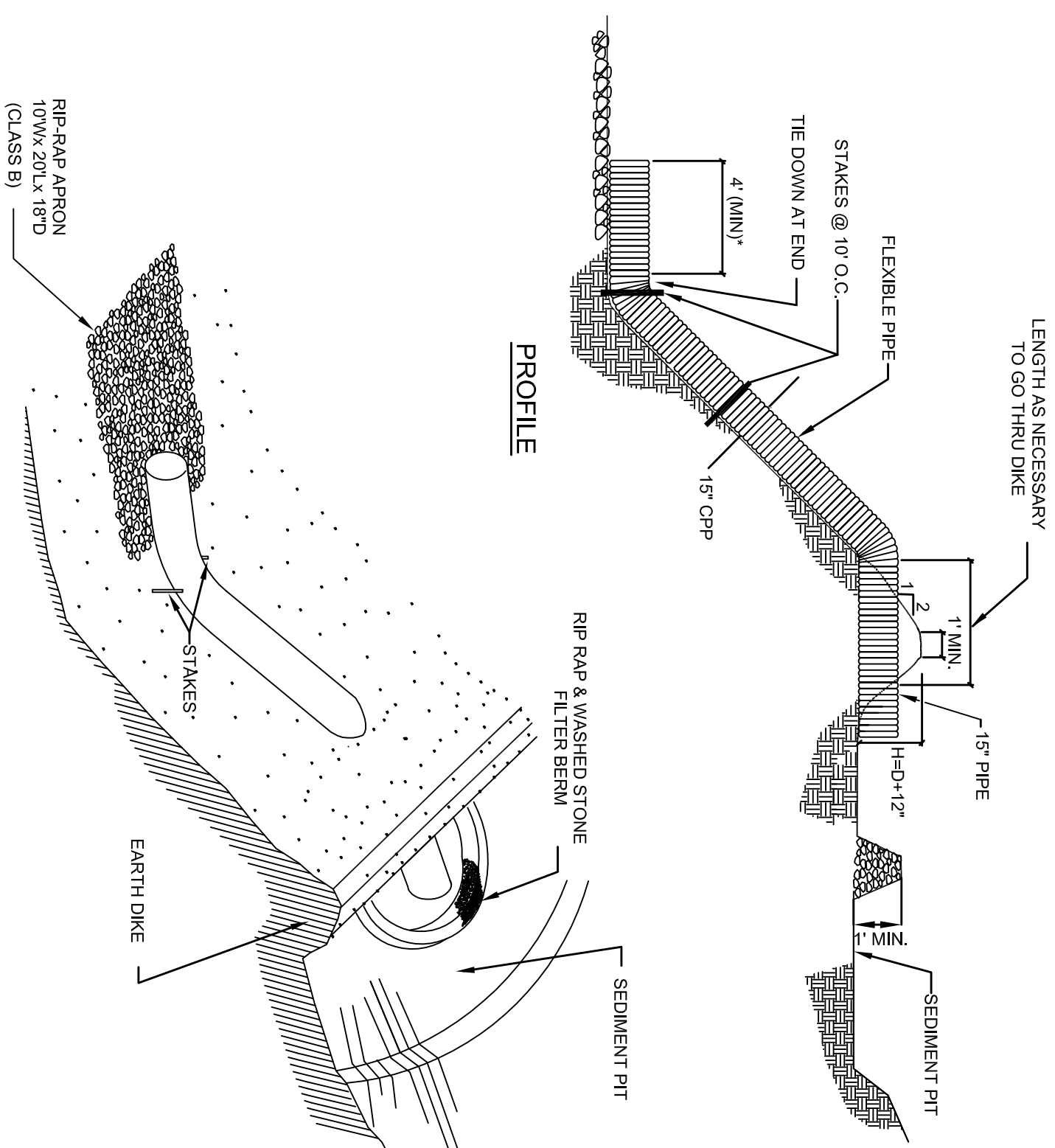

#### CONSTRUCTION SPECIFICATIONS:

1. THE TOP OF THE EARTH DIKE OVER THE INLET PIPE AND THOSE DIKES CARRYING WATER TO THE PIPE SHALL BE AT LEAST 1 FOOT HIGHER AT ALL POINTS THAN THE TOP OF THE INLET PIPE.
2. THE PIPE SHALL BE FLEXIBLE WITH WATER TIGHT CONNECTING JOINTS.
3. A RIP-RAP APRON SHALL BE PROVIDED AT THE OUTLET IF EMPTYING INTO A DISTURBED AREA.
4. THE SOIL AROUND AND UNDER THE INLET PIPE AND ENTRANCE SECTION SHALL BE HAND TAMPED IN 4" LIFTS TO THE TOP OF THE EARTH DIKE.
5. FOLLOW-UP INSPECTION AND ANY NEEDED MAINTENANCE SHALL BE PERFORMED AFTER EACH STORM.

#### TEMPORARY SLOPE DRAIN

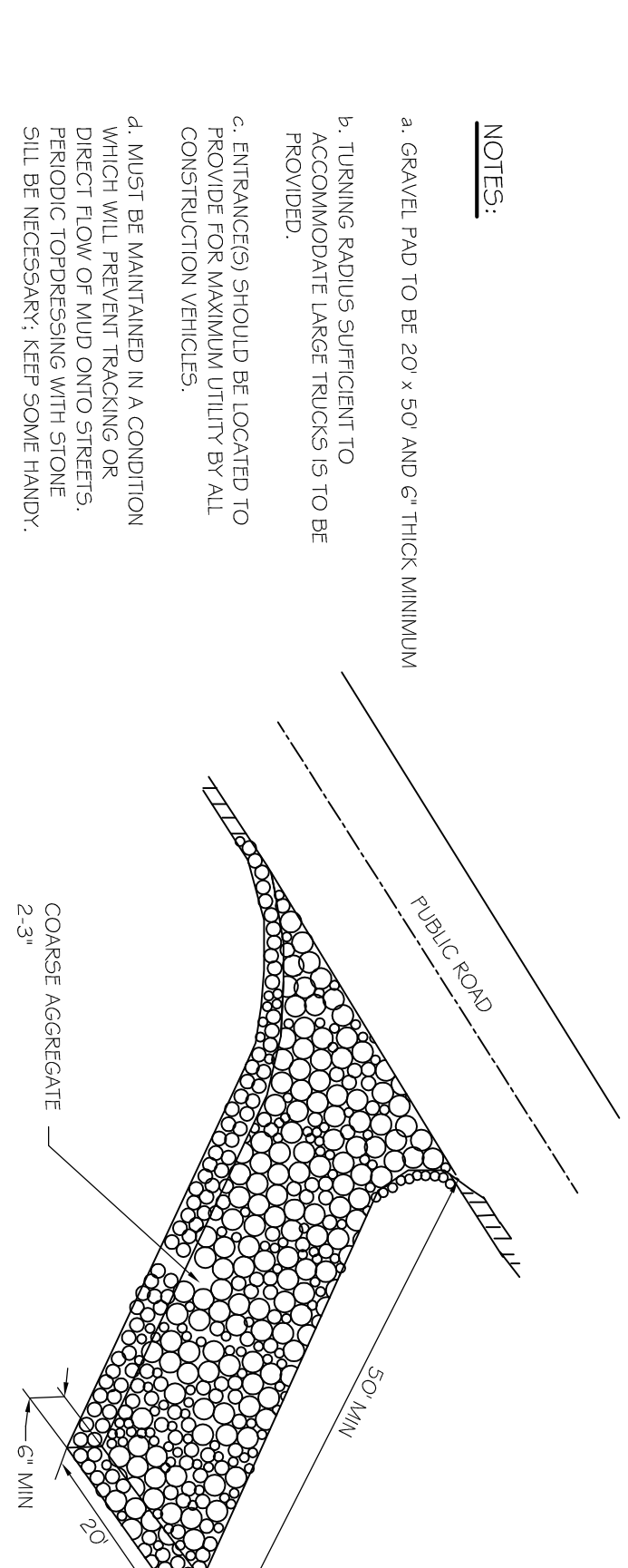

#### TEMPORARY CONSTRUCTION ENTRANCE

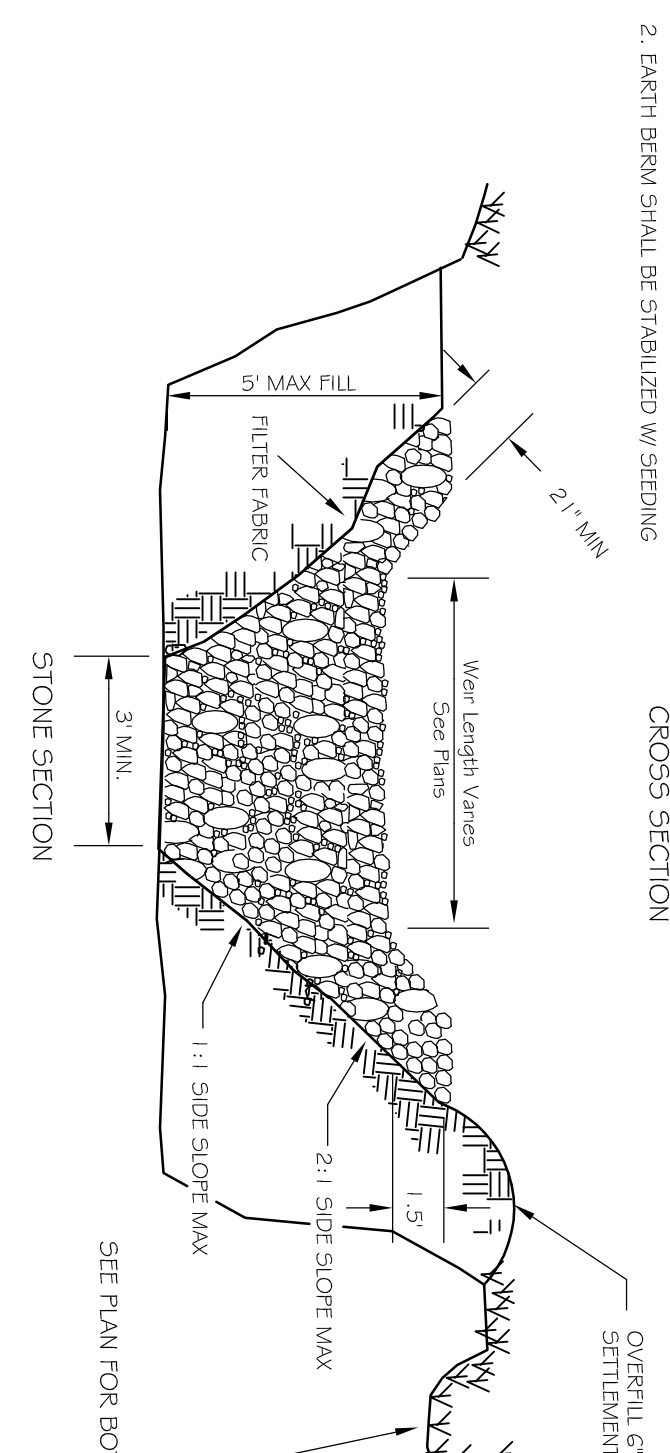
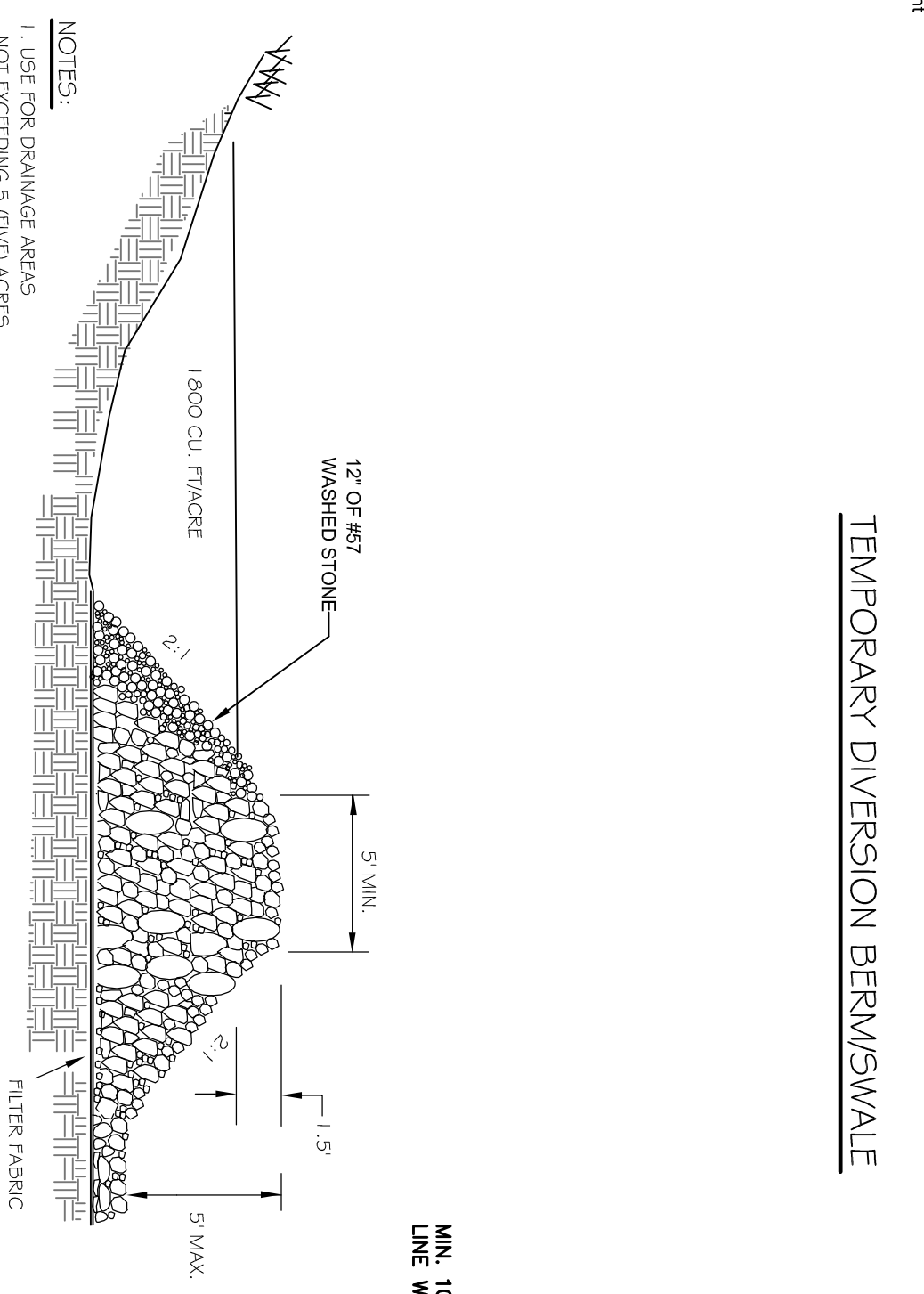
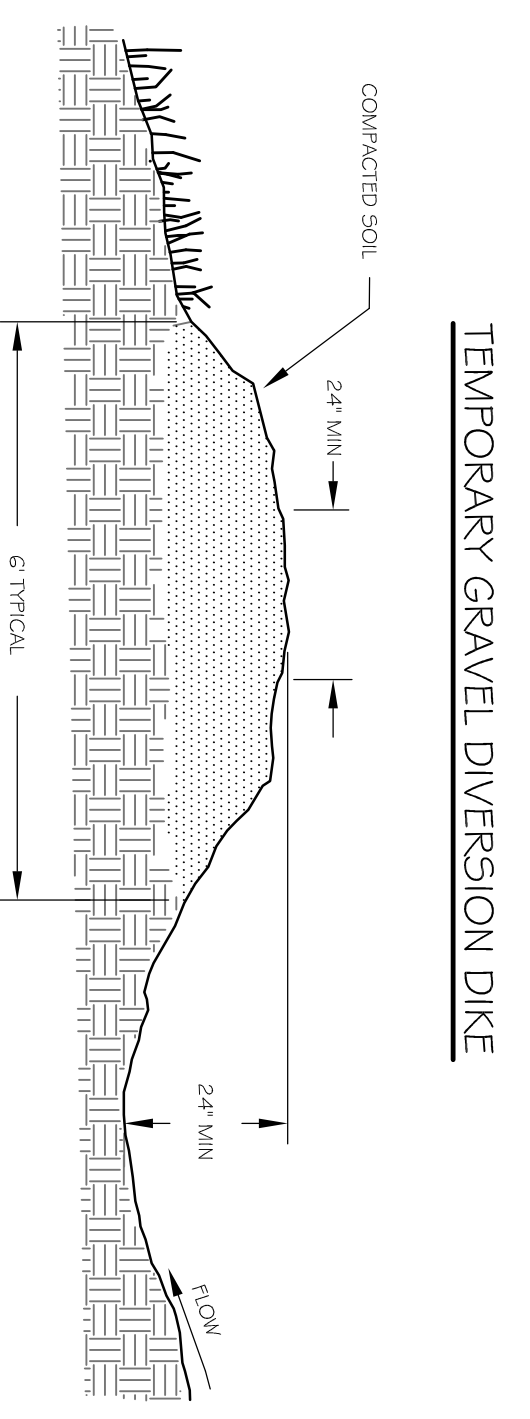
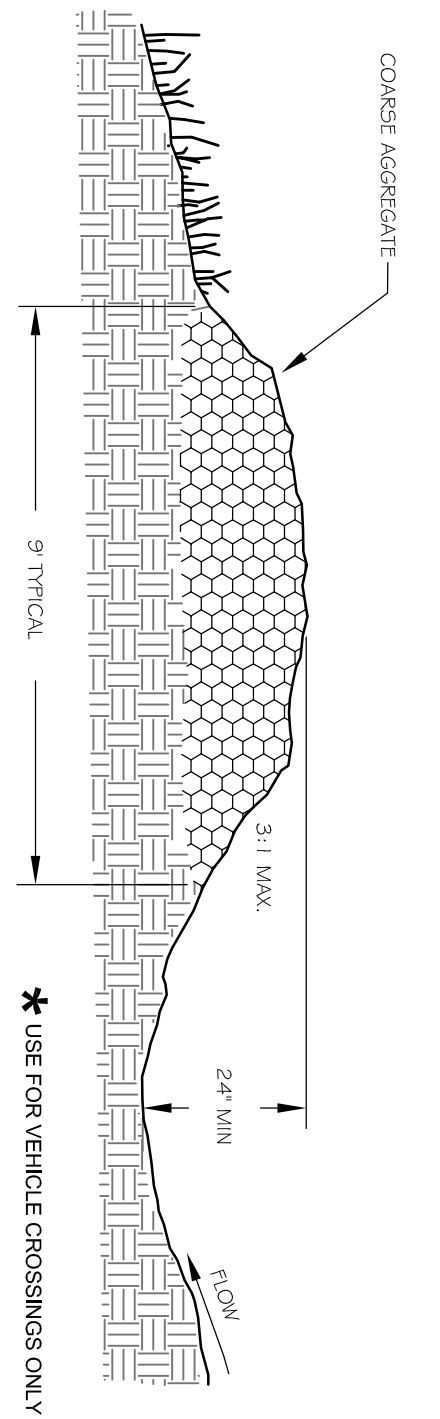

#### TEMPORARY SEDIMENT TRAP DETAIL

- NOTES:**
1. USE FOR DAMAGE AREAS NOT EXCEEDING 5' BY 5' FEET.
  2. DRAIN BERM SHALL BE STABILIZED W/ SEEDING.
- GROSS SECTION:**
1. USE FOR DAMAGE AREAS NOT EXCEEDING 5' BY 5' FEET.
2. DRAIN BERM SHALL BE STABILIZED W/ SEEDING.
3. MAX. FILL: 5'.
4. FILTER FABRIC: 2'.
5. WASHED STONE: 17' OF #47.
6. FILTER FABRIC: 2'.
7. OVERALL 6" FOR SETTLEMENT.
8. SEE PLAN FOR BOTTOM DIMENSIONS.
9. 2:1 SLOPE MAX.
10. 1:1 SLOPE MAX.
11. 3' MIN. WIDTH.
12. 2' MIN. HEIGHT.
13. 2' MIN. BASE WIDTH.
14. EMERGENCY 6" FILL TO TOP OF DAM.

#### STANDARD TEMPORARY SILT FENCE

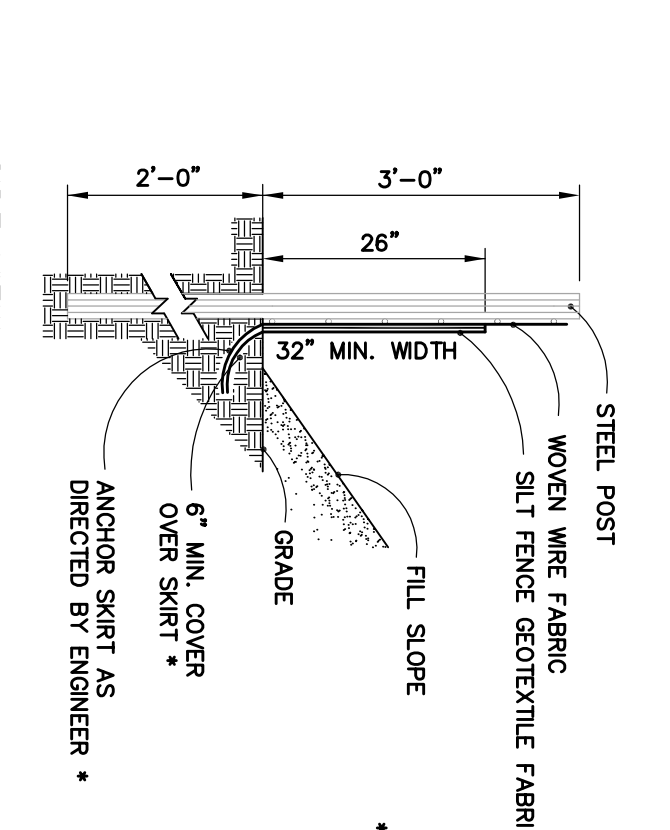

- NOTE:**
- USE SILT FENCE ONLY WHEN DRAINAGE AREA DOES NOT EXCEED 1000 SQ. FT. AND NEVER IN AREAS OF CONCENTRATED FLOW.
  - END OF SILT FENCE NEEDS TO BE TURNED UPHILL.

**FINAL DESIGN FOR REVIEW ONLY**

**THE LEGACY PHASE 4A EROSION CONTROL PLANS EROSION CONTROL DETAILS CHATHAM COUNTY, NC**

DATE: SEPTEMBER, 2014

SCALE: N/A

DRAWN: CPM

CHECKED: MPA

PROJECT NO: 330-04

CONTRACTOR: 3804 PHA. RD. DEWITT

**NOTARY SEAL**

18894

**C&E GROUP**

307 GLENWOOD AVE. 220 RALEIGH, NC 27602

PHONE: 919-367-8790

FAX: 919-322-0032

www.cegroupinc.com

License # C-1739

NO.	REVISIONS	DATE
1.	REVISED PER CHATHAM COUNTY 1st REVIEW COMMENTS.	12/12/14



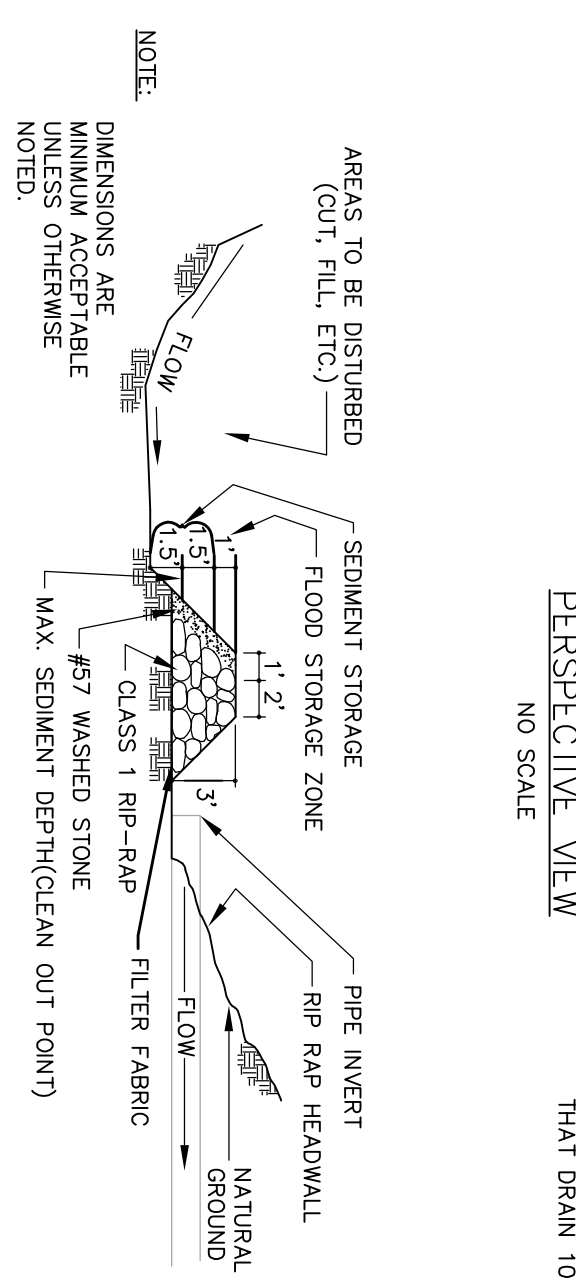
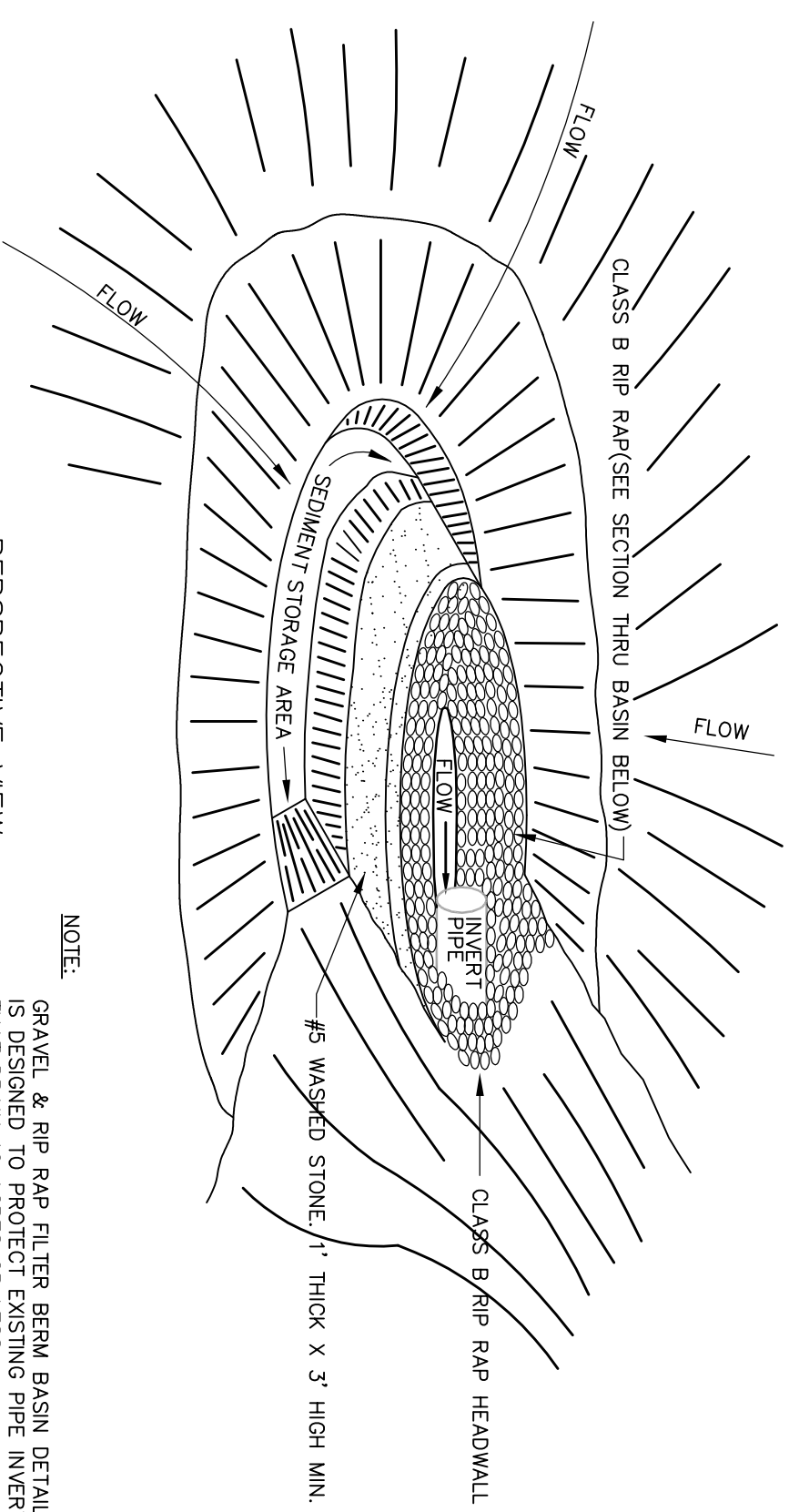

GRAVEL & RIPRAP HORSESHOE INLET BASIN  
NOT TO SCALE

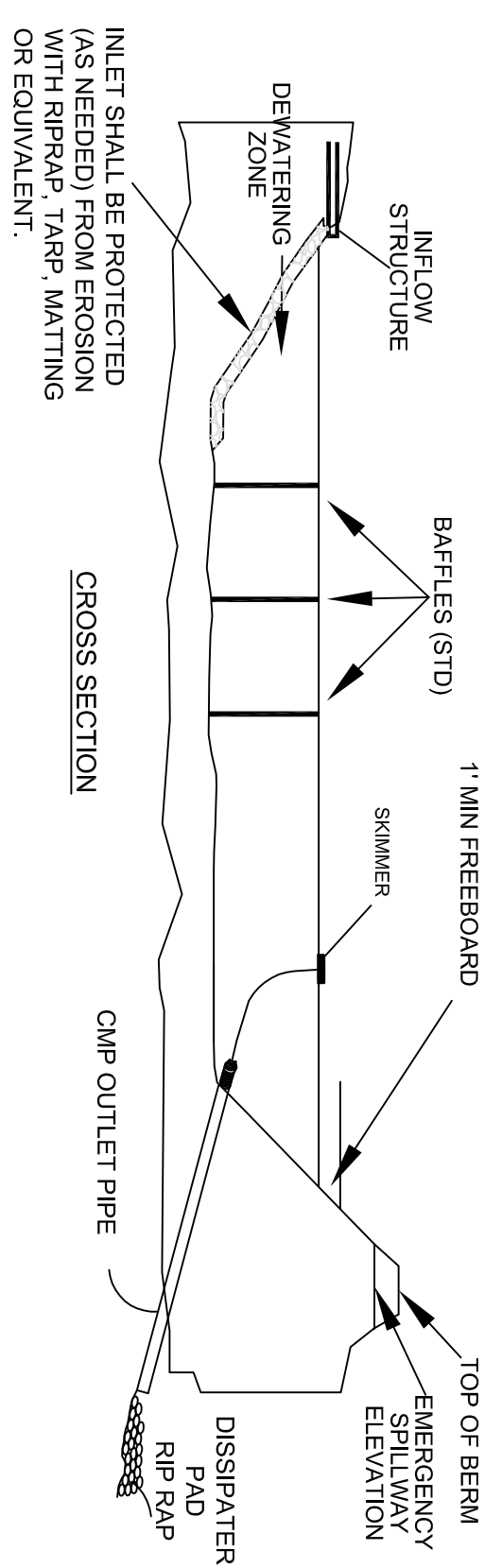
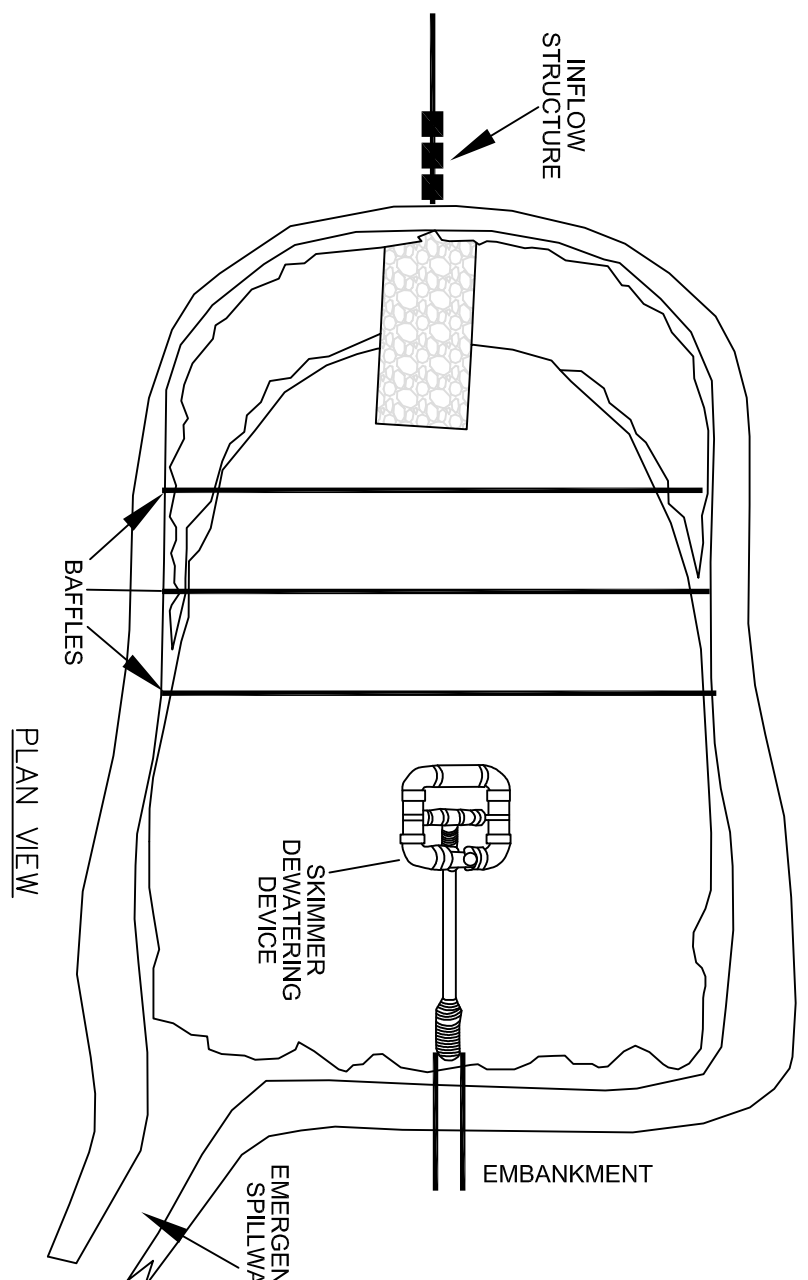

- NOTES:
1. BASIN SHOULD BE CLEANED OUT WHEN CAPACITY REACHES AN ELEVATION REPRESENTING THAT THE BASIN IS HALF FULL.
  2. THE TARP USED TO PROTECT THE WEIR SHALL BE THE WIDTH SPECIFIED. THE LENGTH OF THE TARP SHALL BE ACCORDING TO AVAILABLE SUPPLY. IF MULTIPLE TARPS ARE TO BE USED, THEN TARPS SHALL BE OVERLAPPED AT LEAST 12" THE OVERLAP.
  3. TARP SHALL OVERLAP THE DOWNSTREAM TARP. THE TARP SHALL BE 50 WML HEAVY DUTY SILVER TARP/VALUINS PROVIDED BY THE CONTRACTOR.
  4. BAFLE MATERIAL MUST BE SECURED AT THE BOTTOM AND SIDES USING STAPLES OR BY TRENCHING AS FOR A SILT FENCE.
  5. DURING THE SEDIMENT PHASE OF THE FIRST RAIN, THE SEDIMENT SHOULD BE REMOVED FROM THE BASIN FOR MAINTENANCE.
  6. DURING THE SEDIMENT PHASE OF THE FIRST RAIN, THE SEDIMENT SHOULD BE REMOVED FROM THE BASIN FOR MAINTENANCE.
  7. POND SHALL NOT BE CONVERTED FOR STORMWATER USE UNTIL APPROVED BY ENVIRONMENTAL ENGINEER.

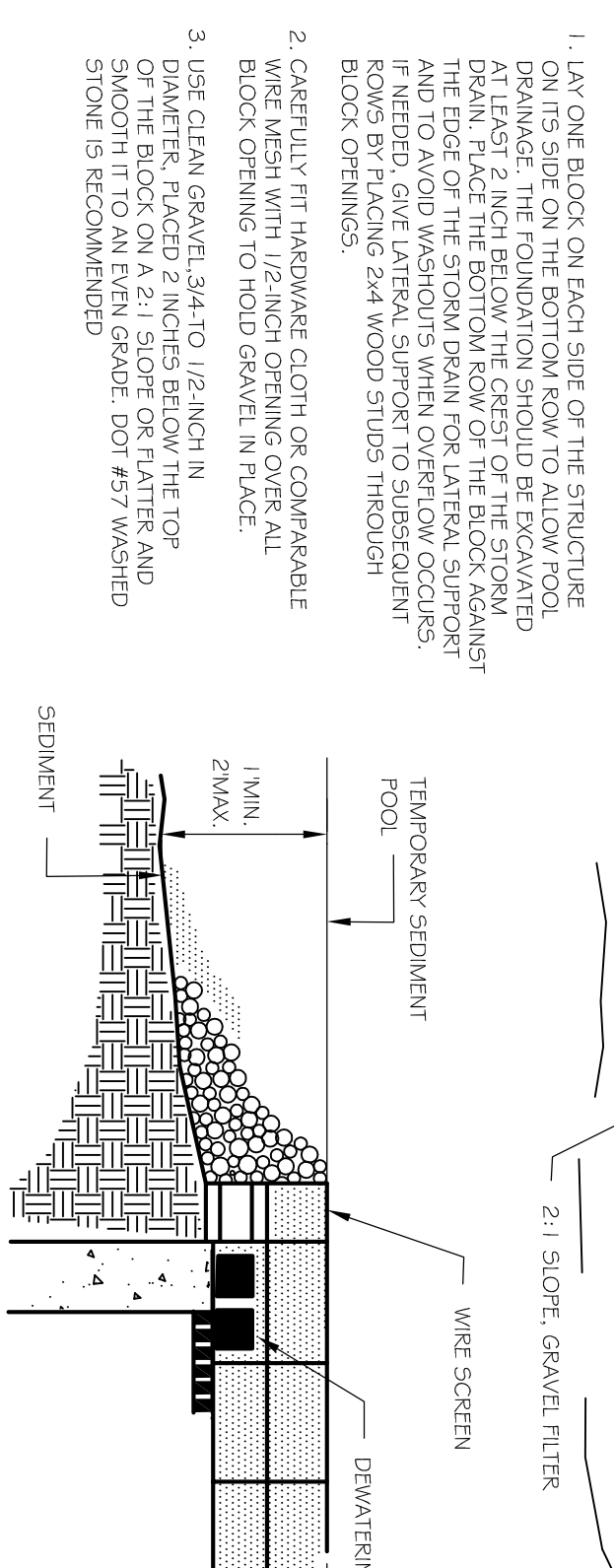
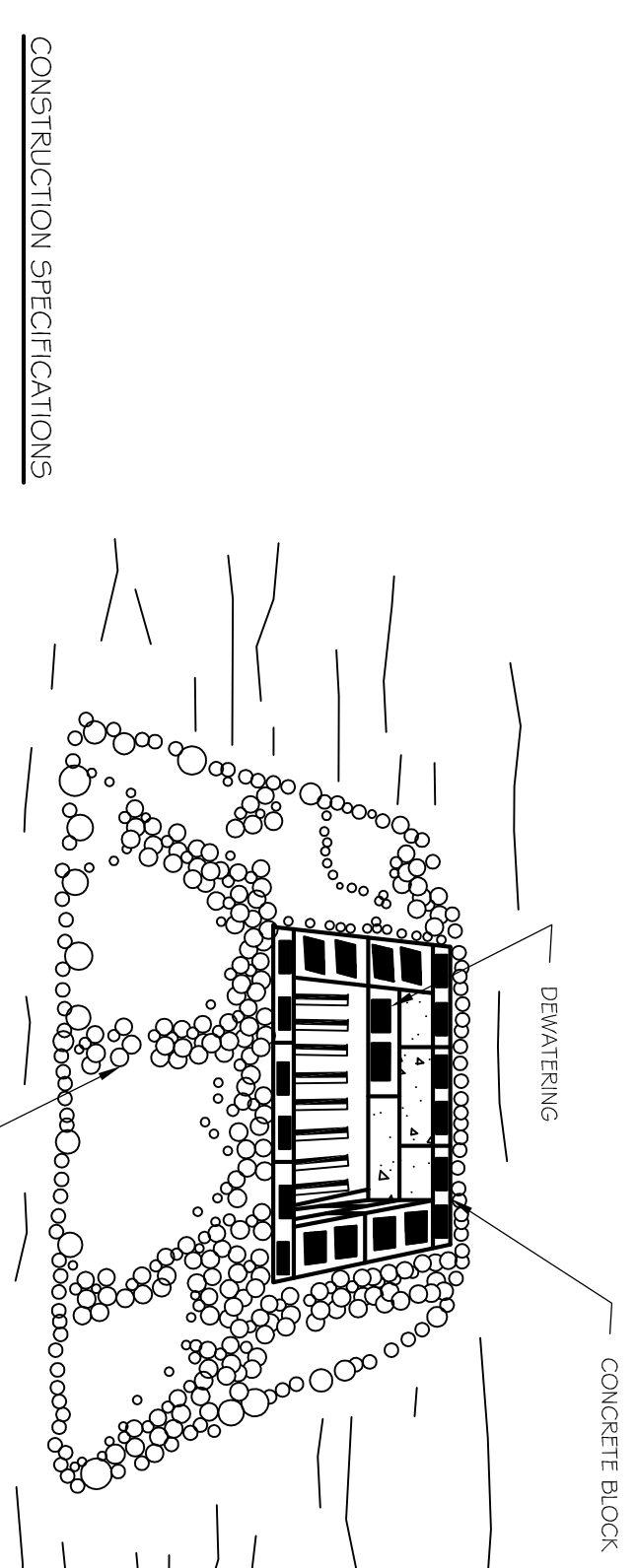
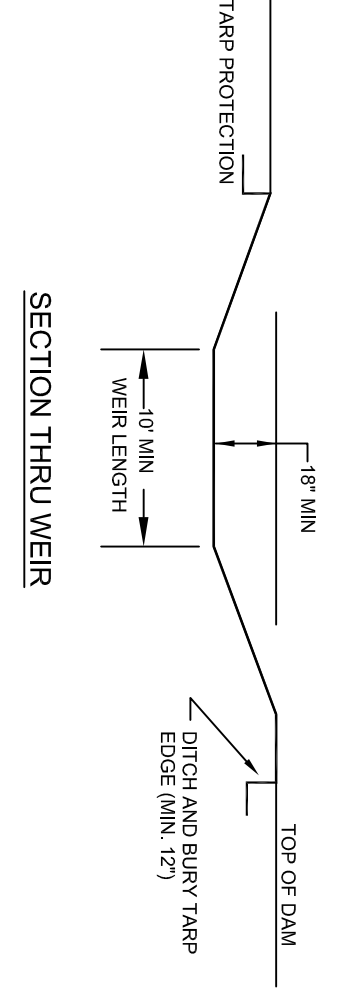

BLOCK AND GRAVEL INLET PROTECTION  
NOT TO SCALE

- CONSTRUCTION SPECIFICATIONS:
1. LAY ONE BLOCK ON EACH SIDE OF THE STRUCTURE ON ITS SIDE ON THE BOTTOM ROW TO ALLOW FOOT DRAG. PLACE THE BOTTOM ROW OF THE BLOCK AGAINST THE EXISTING STRUCTURE TO PREVENT OVERFLOW. IF NEEDED, GIVE LATERAL SUPPORT TO SUBSEQUENT ROWS BY TACKLING 2x4 WOOD STUDS THROUGH BLOCKS OR SIMILAR.
  2. CAREFULLY FIT HARDWARE CLOTH OR COMPARABLE BLOCK OPENING TO HOLD GRAVEL IN PLACE.
  3. USE CLEAN GRAVEL 3/4 TO 1/2 INCH IN SIZE. GRAVEL SHOULD BE PLACED IN THE TOP OF THE BLOCK ON A 2:1 SLOPE OR FLATTER AND SMOOTH FIT TO AN EVEN GRADE. DOT #57 WASHED BLOCK IS RECOMMENDED.

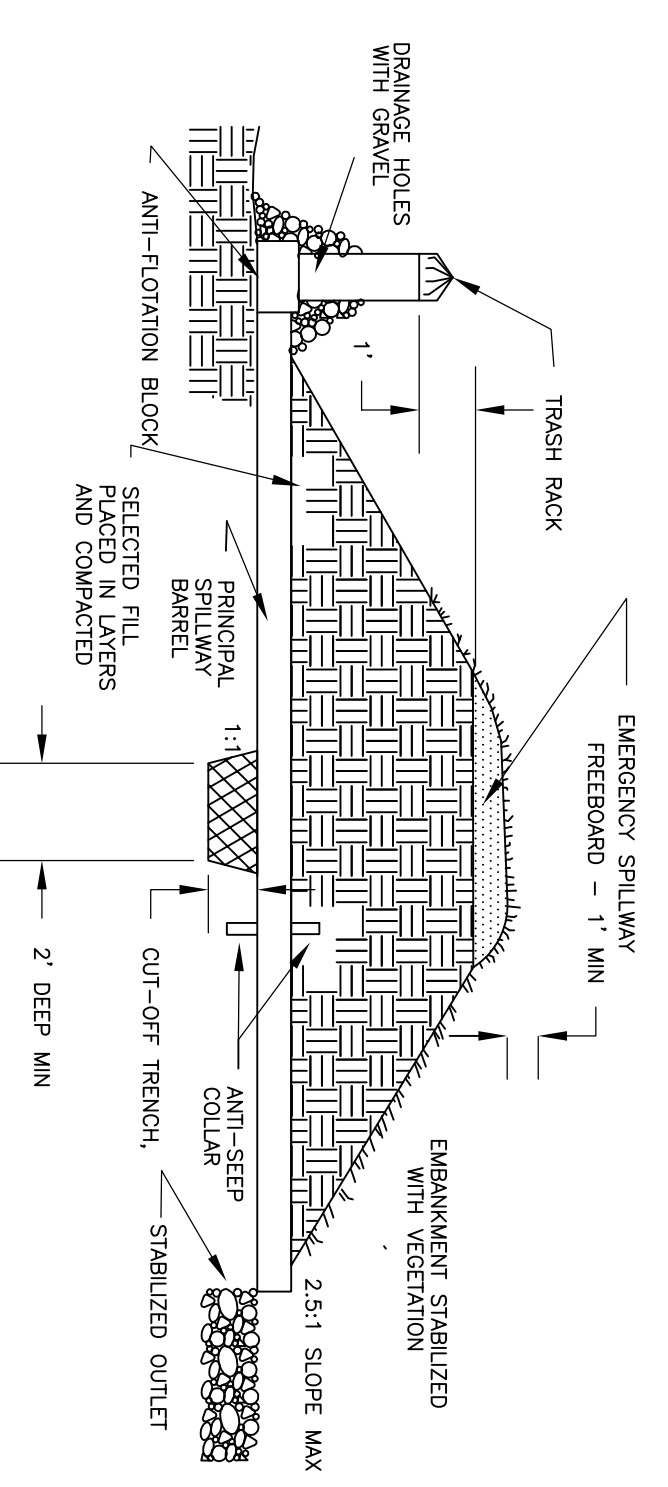

TEMPORARY RISER BASIN DETAIL  
NOT TO SCALE

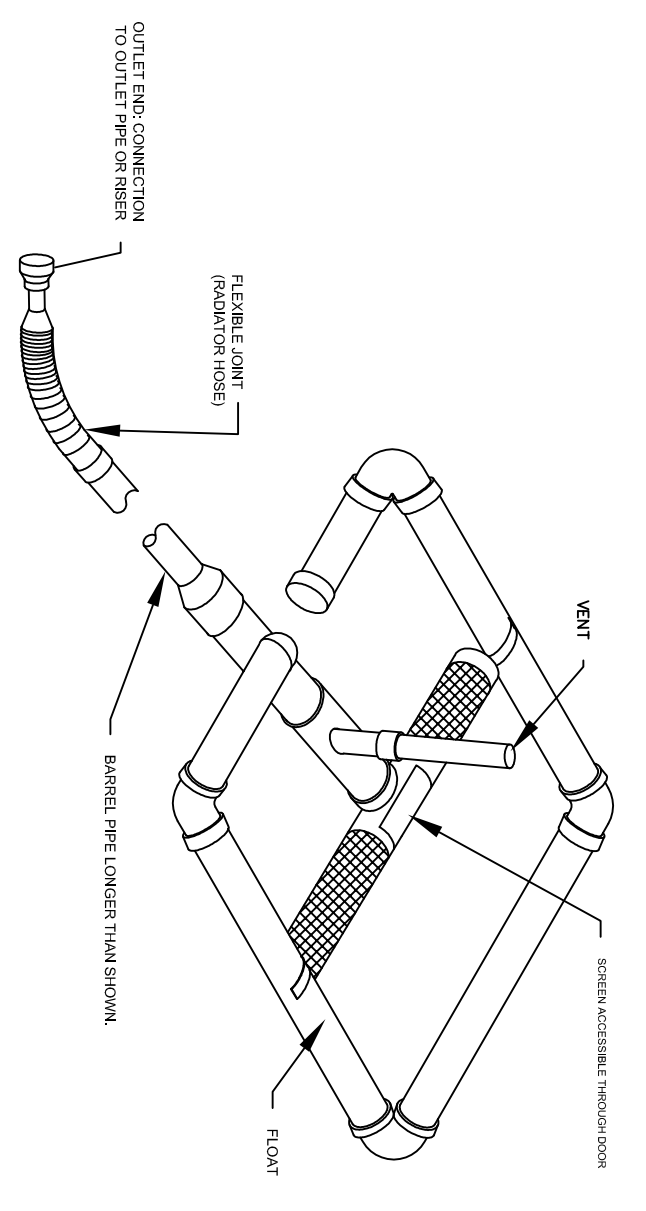

SKIMMER DETAIL

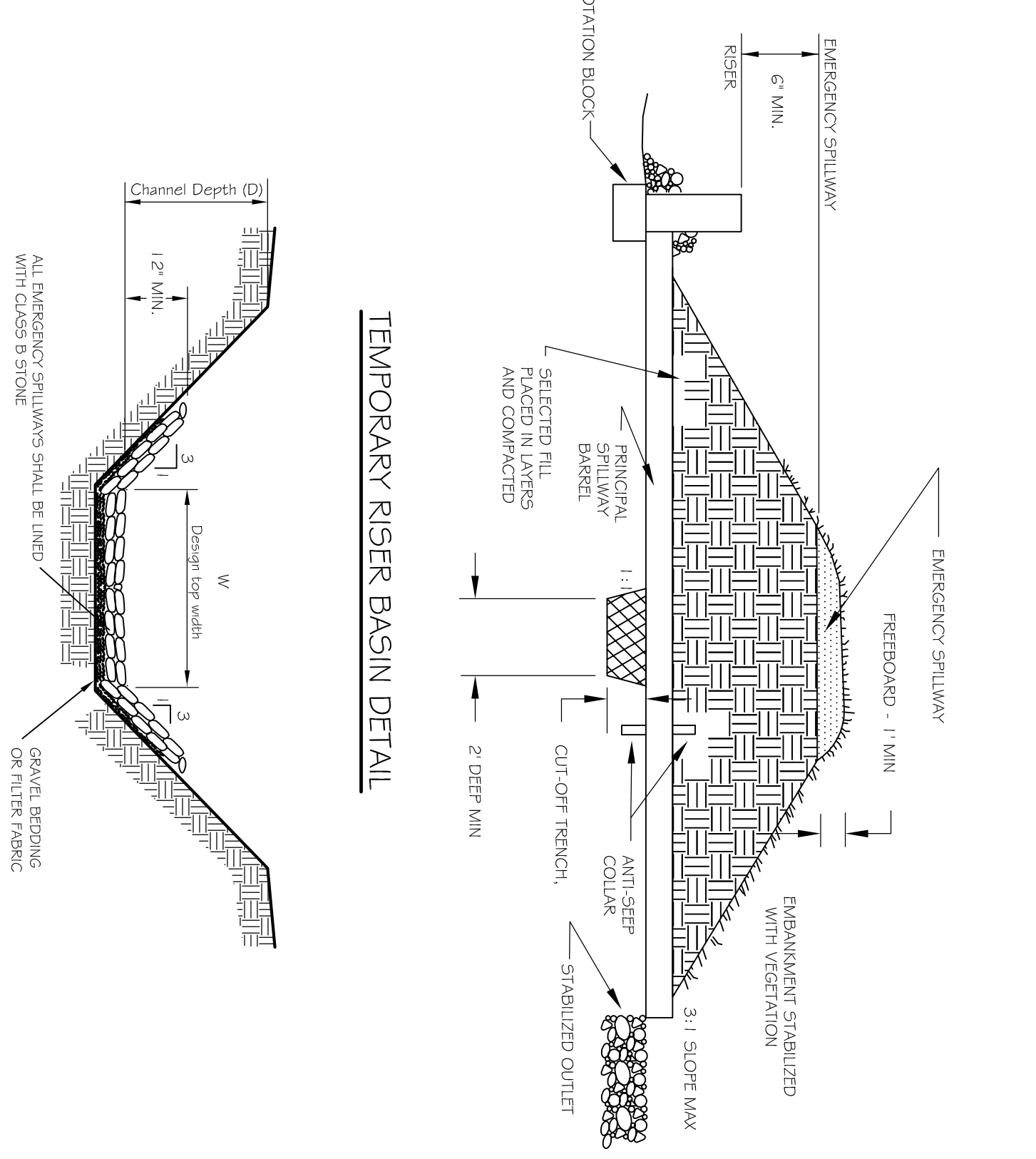

TEMPORARY RISER BASIN DETAIL

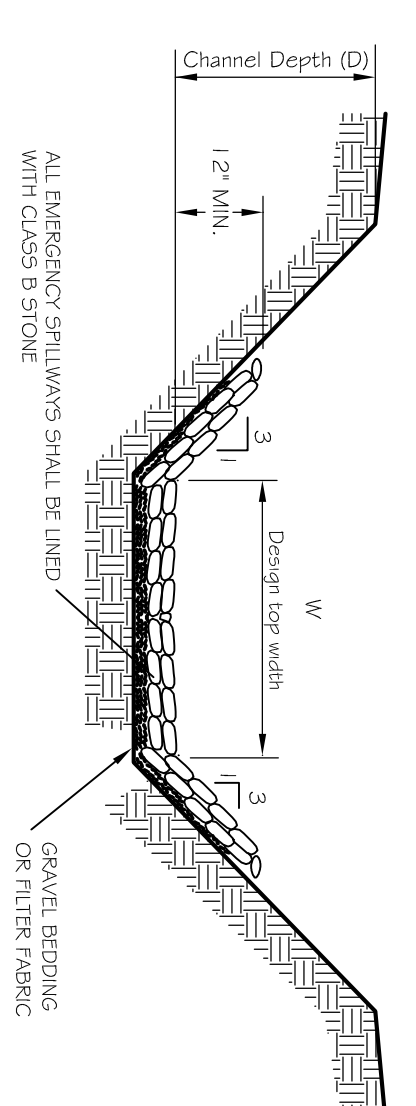

EMERGENCY SPILLWAY

Installation

NOTES: Sediment fences capture sediment by holding up water for longer deposition. It is relatively ineffective for filtration because it traps two times more sediment than a sediment pool behind the fence is very effective and traps sediment. The sediment pool behind the fence is very effective and traps sediment. The sediment pool behind the fence is very effective and traps sediment. The sediment pool behind the fence is very effective and traps sediment.

REINFORCED SILT FENCE OUTLET

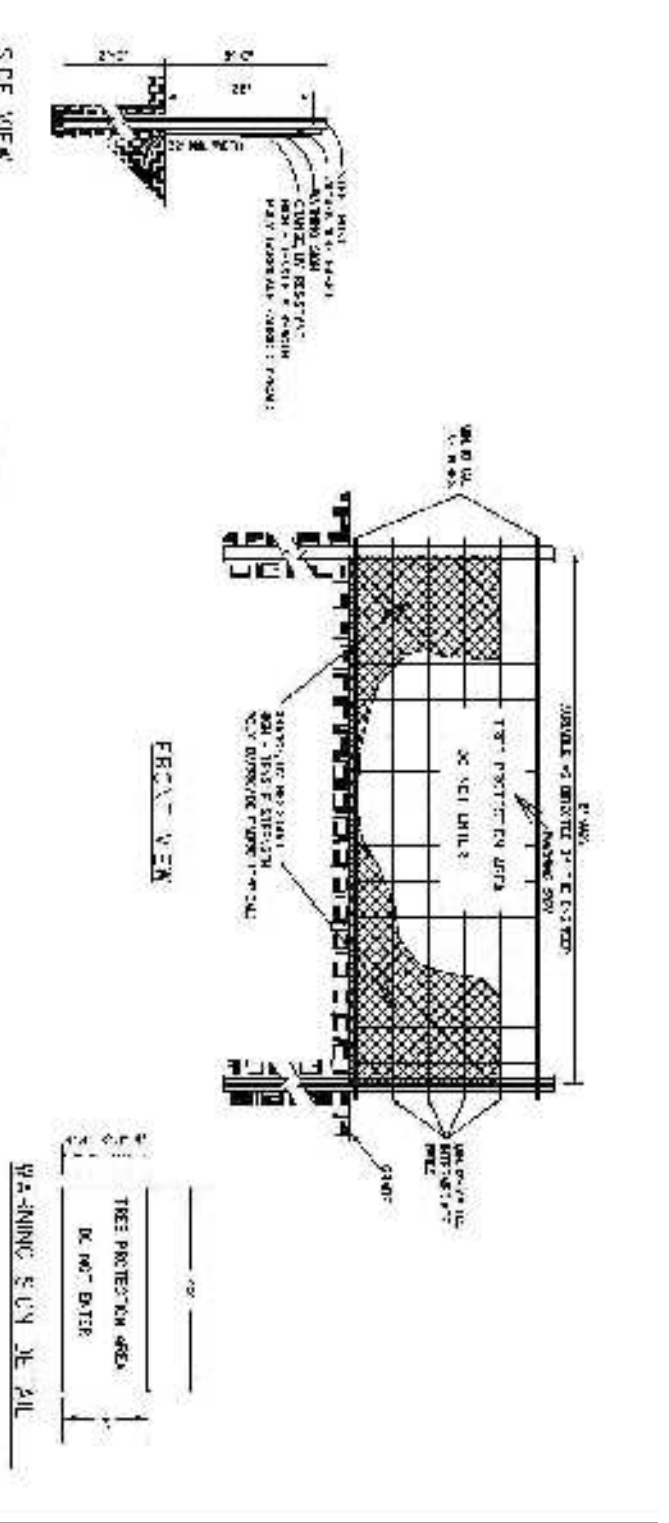

SEE VIEW

EROSION CONTROL PLAN  
CHATHAM COUNTY, NC  
18" x 24" PROJECTION DETAIL

DATE: SEPTEMBER, 2014  
SCALE: N/A  
DRAWN: CPM  
CHECKED: MPA  
PROJECT NO: 330-04  
CONTRACTOR: DAVIS BRIDGES  
3904 PHA 08 PER DETAILS

WARNING: SCALE DETAIL

FINAL DESIGN FOR REVIEW ONLY

9 OF 9

THE LEGACY PHASE 4A  
EROSION CONTROL PLANS  
EROSION CONTROL DETAILS  
CHATHAM COUNTY, NC

188904  
188904  
188904

C&E GROUP  
307 GLENWOOD AVE, 220  
RALEIGH, NC 27602  
PHONE: 919-367-8790  
FAX: 919-322-0032  
www.cegroupinc.com  
License # C-1739

NO.	REVISIONS	DATE
1.	REVISED PER CHATHAM COUNTY 1st REVIEW COMMENTS.	12/12/14